

NOTE:
 GUTTER GRADES AT INLET LOCATIONS AS SHOWN DO NOT INCLUDE INLET GUTTER DEPRESSION. THE PAVING CONTRACTOR SHALL WARP PAVEMENT IN THESE AREAS AS NECESSARY TO MEET INLET GUTTER DEPRESSIONS.

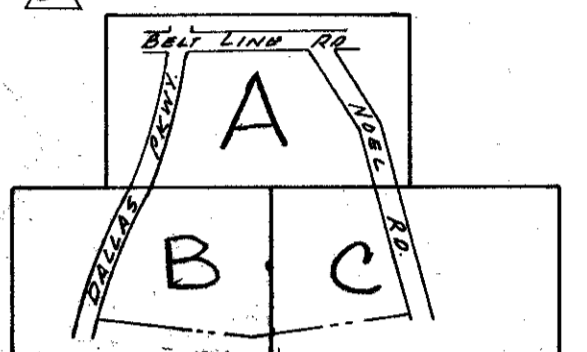

KEY MAP

LOT CORNER COORDINATES

#	Y	X
31	599.786	2448.241
32	716.143	2448.263
33	663.998	1632.055
34	779.394	1644.281
35	873.083	2072.684
36	1074.196	2072.684
37	1074.196	2199.684
38	863.092	2199.684
39	843.594	2448.286
40	845.835	2477.684
41	1074.196	2477.684
42	1074.196	1803.553
43	899.359	1738.696
44	1074.196	2604.684
45	895.717	2604.684
51	1201.196	2399.684
53	1201.196	2272.684
57	1201.196	1873.316
70	729.099	2143.765
71	624.456	2134.667
72	621.240	2175.541
73	736.883	2184.639
77	724.789	2558.702
78	609.142	2567.755
80	727.989	2599.577
81	729.165	2614.596
504	593.400	2610.113
505	733.150	2614.285

LEADING PLAN FOR 2ND INSTALLMENT
 ◆ INDICATES SOIL BORING
 B REVISSED SERVICE DRIVE LOCATION, SOUTH SIDE LOT C.
 C REVISSED SERVICE AREA GRADES AND LOCATION, SOUTH SIDE LOT F (10/30/78).
 18
 REVISSED BLDG. AND SERVICE AREA GRADES 9/7/78

BENCH MARK:
 Standard Water Dept. Bench mark
 Center Jct. Northwest Corner Bellline
 Rd. and Dallas Hwy.
 ELEV. 632.08

Change Order No. 5; 2-16-79 Revised
 Service Area North of Lot E. Revised
 Building Pads for Lot E.

Change Order No. 6; 3-12-79 Addition of
 Island & Spot Elevations, South side
 Lot C

GRADING PLAN
VILLAGE ON THE PARKWAY
VILLAGE PARKWAY VENTURE
 ALBERT H. HALFF ASSOCIATES, INC. - ENGINEERS
CITY OF ADDISON, TEXAS

DESIGN	DRAWN	DATE	SCALE	NOTES	FILE	NO.
A.H.H.	A.H.H.	June 78	1"=40'	6123		