

Prestonwood Junction  
 411Q 1960 Sh. 42, 48  
 ABST. 157  
 CITY OF ADDISON  
 MARY T. MENTRE KNIGHT  
 VOL. 7124 Page 155

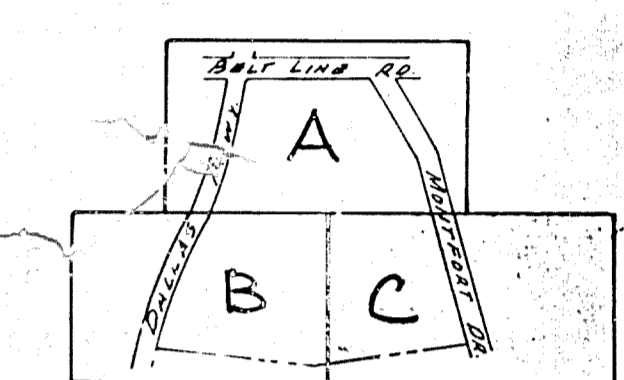
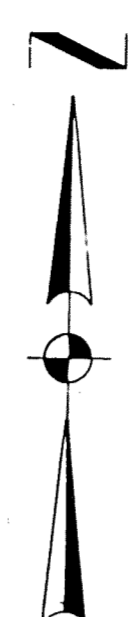

KEY MAP

WATER & SANITARY SEWER GENERAL NOTES

- ALL 12" AND SMALLER WATER LINES TO BE CLASS 51 D.I.
- ALL WATER LINES TO HAVE MINIMUM COVER AS FOLLOWS:  
 a. 8' OR LESS 4' BELOW APPROVED STREET GRADES OR AS REQUIRED TO CLEAR OTHER UTILITIES.  
 b. 12'-5' BELOW APPROVED STREET GRADES OR AS REQUIRED TO CLEAR OTHER UTILITIES.
- SANITARY SEWER LATERALS SHALL BE SIZED AND LOCATED AS SHOWN.
- DUE TO SOIL RESISTIVITY READINGS OF LESS THAN 2000 OHMS PER C.C., ALL D.I. PIPE SHALL HAVE 8 MIL POLYETHYLENE WRAP.
- WATER AND SANITARY SEWER ESMTS. SHALL INCLUDE ADDITIONAL AREA OF WORKING SPACE FOR CONSTRUCTION AND MAINTENANCE OF THE SYSTEM. ADDITIONAL ESMT. AREA ALSO CONVEYED FOR INSTALLATION AND MAINTENANCE OF MANHOLES, CLEANOUTS, FIRE HYDRANTS, SERVICES, LATERALS, METERS AND OTHER APPURTENANCES NECESSARY FOR PROPER OPERATION OF THE SYSTEM.
- EXTEND WATER SERVICES AND SANITARY SEWER LATERALS 2' BEYOND PROPOSED CURB.
- ALL WATER SERVICES TO BE SIZED AND LOCATED AS SHOWN.
- THE CONTRACTOR SHALL PROTECT ALL PUBLIC UTILITIES IN THE CONSTRUCTION OF THIS PROJECT. ALL MANHOLES, CLEANOUTS, VALVE BOXES, FIRE HYDRANTS, ETC., MUST BE ADJUSTED TO PROPER LINE AND GRADE BY THE DEVELOPER AND OR THE CONSTRUCTOR PRIOR TO AND AFTER PLACING OF PERMANENT PAVING. UTILITIES MUST BE MAINTAINED TO PROPER LINE AND GRADE DURING THE CONSTRUCTION OF THE PAVING FOR THE DEVELOPMENT.
- ALL FIRE HYDRANTS SHALL BE MUELLER CENTURY AS REQUIRED BY THE CITY OF ADDISON.
- ALL WATER SERVICES TO EXISTING MAINS SHALL BE INSTALLED BY CONTRACTOR.

LOT CORNER COORDINATES

#	Y	X
48	1201.196	2802.543

BENCH MARK:  
 STANDARD WATER DEPT. BENCH MARK  
 CENTER INLET - NORTHWEST CORNER  
 BELTLINE ROAD AND DALLAS PKWY.  
 ELEV: 632.08

LOCATION: VILLAGE ON THE PARKWAY - PHASE I  
 DESIGNED: DATE: 10-17-78  
 ALBERT H. HALFF ASSOCIATES, INC. ENGINEERS  
 R.O.W. APPROVED: H.L. TEE/ DATE 10-17-78  
 ENGINEER OF DESIGN: Dallas 10-17-78  
 DALLAS WATER UTILITIES DEPT.  
 CONTRACT No. 78-20178-262P - Shimon Sept. 25, 1978

NOTE: REFER TO SHEET 38 FOR 12 INCH WATER LINE PROFILE - MONTFORT DRIVE.  
 REFER TO SHEET 37 FOR SANITARY SEWER PROFILES.

36

WATER & SANITARY SEWER PLANS						
VILLAGE ON THE PARKWAY						
VILLAGE PARKWAY VENTURE						
ALBERT H. HALFF ASSOCIATES, INC. ENGINEERS						
CITY OF ADDISON, TEXAS DALLAS BRANCH						
DESIGN	DRAWN	DATE	SCALE	NOTES	FILE	NO.
AH/HB ASSOC.	T.P.	MAY 1978	1" = 40'	6145	6119	9960