

CITY OF ADDISON

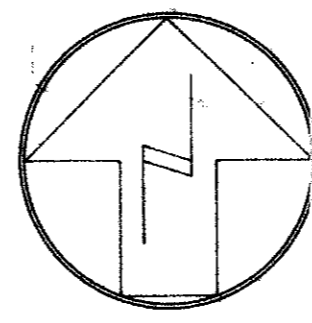

CITY OF ADDISON

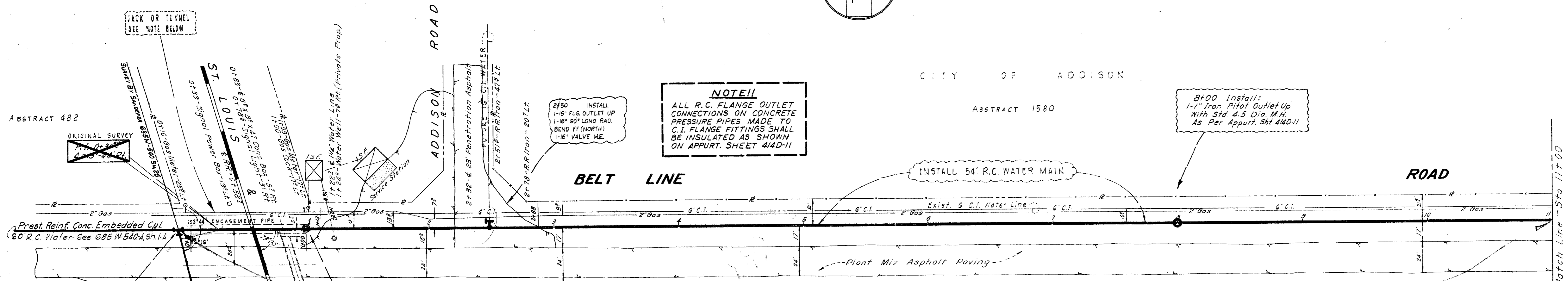

**NOTE!**  
 ALL R.C. FLANGE OUTLET CONNECTIONS ON CONCRETE PRESSURE PIPES MADE TO C.I. FLANGE FITTINGS SHALL BE INSULATED AS SHOWN ON APPURT. SHEET 414D-11

8100 Install:  
 1-1/2" Iron Pitot Outlet Up With Std. 4.5 Dia. M.H. As Per Appurt. Sht 414D-11

REVISION  
 0-01 east  
 1907.65 north  
 167.88 south  
 3195.42 West  
 Install: 1-60" x 54" 142 Wye

1+022 INSTALL 55" DIA. STD. MANHOLE AT END OF ENCASEMENT FOR ACCESS 18" FLG. OUTLET UP 18" BLIND FLANGE

CONTRACT NO 61-45

CITY OF ADDISON

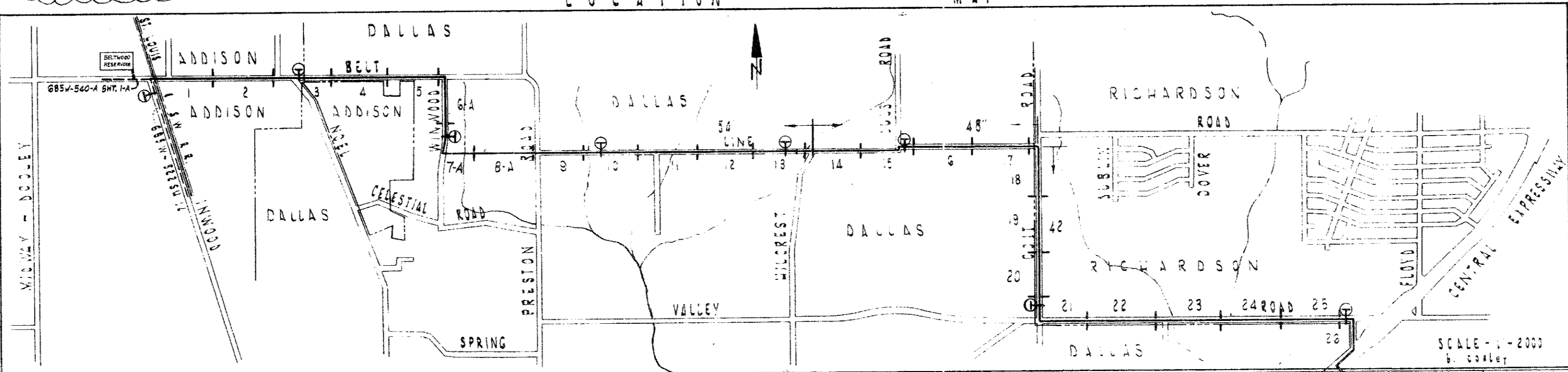

**NOTE!** BORINGS BY:  
 MASON-JOHNSTON & ASSOCIATES.  
 BORINGS B-1 & B-2 DRY AT 24-HR.  
 WATER CHECK. 30 NOV, 1960.

BENCH MARK:  
 Water Dept. C.I. on concrete  
 on side of S.W. 1st St. E. side  
 of Belt R.R. ELEV. 234.15  
 634.64

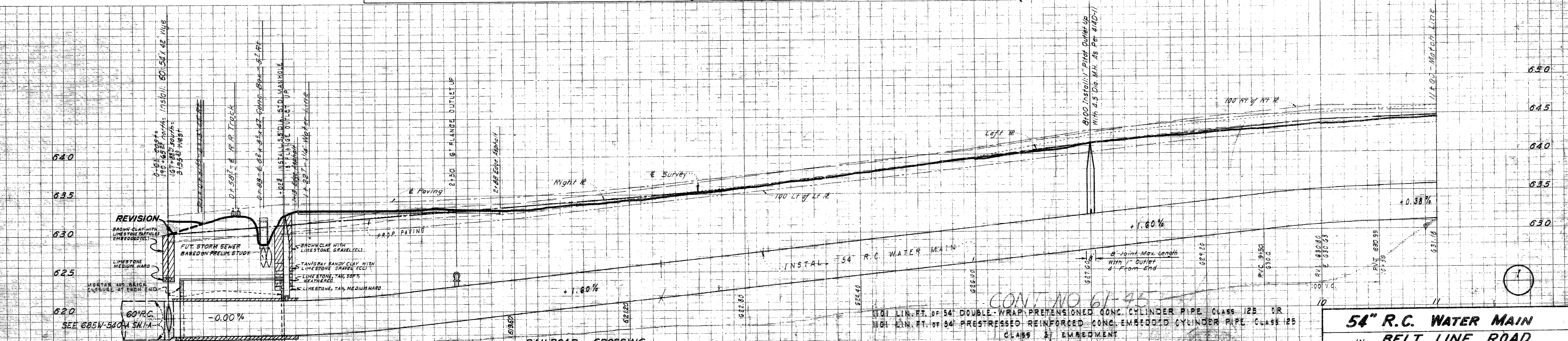

RAILROAD CROSSING

101 LIN. FT. OF 54" DOUBLE-WRAP PRESTRESSED CONC. CYLINDER PIPE CLASS 125 OR  
 100 LIN. FT. OF 54" PRESTRESSED REINFORCED CONC. EMBEDDED CYLINDER PIPE CLASS 125  
 CLASS 27 EMBEDMENT

**54" R.C. WATER MAIN**  
 IN BELT LINE ROAD  
 FROM INWOOD RD. TO DULLES RD.  
**DALLAS CITY WATERWORKS**  
 CITY OF DALLAS, TEXAS

DESIGN	DRAWN	DATE	SCALE	NOTES	FILE	NO.
C.L. MOON		May 60	1" = 50'			625-510

Designed by: *C.L. Moon*  
 C.L. MOON, Inc. Engineers  
 Approved by: *W.P.M. Dwyer*  
 Engineer of Design - Dallas City Waterworks

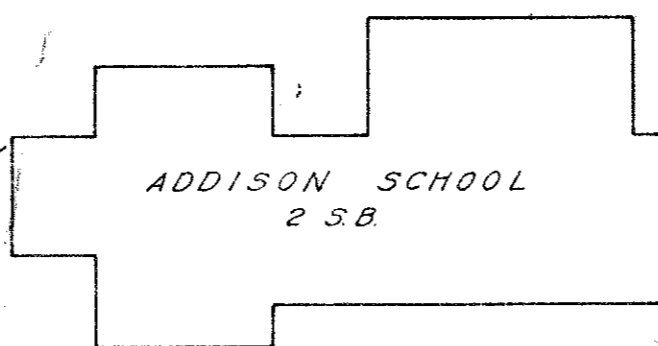
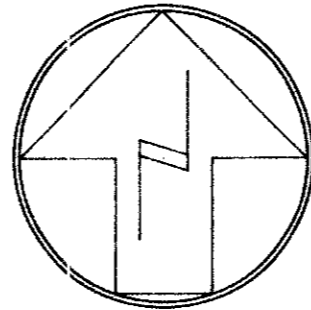

CITY OF ADDISON

ABSTRACT 1580

NOTE!  
THIS ENTRANCE AND EXIT  
DRIVEWAY TO THE ADDISON  
SCHOOL SHALL BE KEPT  
OPEN TO TRAFFIC AT ALL TIMES.

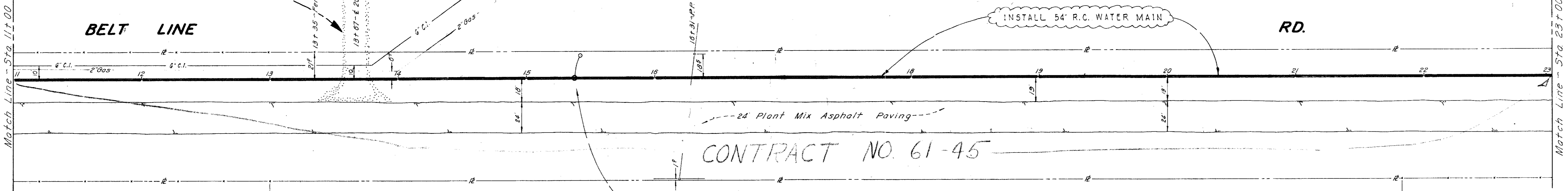

NOTE!!  
ALL R.C. FLANGE OUTLET  
CONNECTIONS ON CONCRETE  
PRESSURE PIPES MADE TO  
C.I. FLANGE FITTINGS, SHALL  
BE INSULATED, AS SHOWN  
ON APPURT. SHEET 414-D-11

15+38.5 INSTALL:  
18" FLANGE OUTLET UP  
TYPE II - 3" CRISPIN AIR VALVE  
INSTALLATION AS PER APPURT.  
SHEET 414-D-11

CITY OF ADDISON

ABSTRACT 157

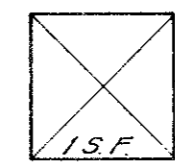

BENCH MARK:  
U.S.C. & G. bronze disc marked E 921-1946 set  
in face of brick wall at main entrance door of  
Addison School. ELEV. 450.61

NOTE! BORINGS BY:  
MASON-JOHNSTON & ASSOCIATES.  
BORINGS B-3 & B-4 Dry At 24-Hr.  
WATER CHECK. 30 Nov, 1960.

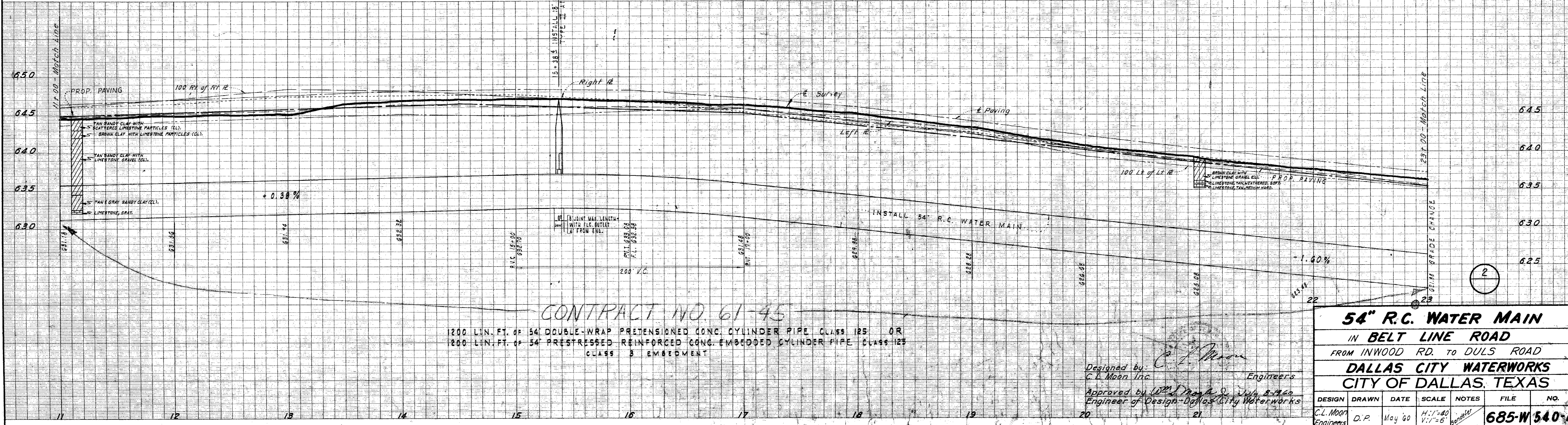

CONTRACT NO. 61-45

1200 LIN. FT. OF 54" DOUBLE-WRAP PRETENSIONED CONC. CYLINDER PIPE CLASS 125 OR  
1200 LIN. FT. OF 54" PRESTRESSED REINFORCED CONC. EMBEDDED CYLINDER PIPE CLASS 125  
CLASS B EMBEDMENT

Designed by:  
C.L. Moon, Inc. Engineers  
Approved by: [Signature] July 8-1960  
Engineer of Design - Dallas City Waterworks

54" R.C. WATER MAIN						
IN BELT LINE ROAD						
FROM INWOOD RD. TO DULS ROAD						
DALLAS CITY WATERWORKS						
CITY OF DALLAS, TEXAS						
DESIGN	DRAWN	DATE	SCALE	NOTES	FILE	NO.
C.L. MOON Engineers	D.P.	May 60	H:V = 40 V:1" = 5'			685-W 540-A

CITY OF ADDISON

BELT LINE

Estate Owner's: Rose Ann Julian Smith, John E. Julian Jr. & S.L. Christie (Agent Son) Merged Julian Christie - Dec. 8, 1975  
 15' Sanitary Sewer Easement Parallel With N. ROW of Adjacent To Belt Line Rd. From E. ROW of Dallas Hwy To W. ROW of Noel Rd.  
 Temp. Working Space Granted. CO - 75253 Pg. 014015 Date - Dec. 31, 1975

Prestonwood National Bank  
 Note: Polyethylene Wrap to be Used on all Prop. D.I. Water Pipes, D.I. Fittings and Fire Hydrant Bases.

City of Addison - Dec 5, 1975  
 Authorized Construction of Water & Sanitary Mains to Reach Prop. Prestonwood National Bank  
 C.T. Webster  
 A City Administrator  
 Also See Letter From County Director of Public Works. Dec. 1, 1975

Simons Land Co. - Acting Through President Herman Ruppel - Nov. 25, 1975  
 15' Sanitary Sewer Easement Adjacent To And Parallel With The N. ROW of Belt Line Rd. From E. ROW of Noel Rd. East To End of Esmt. 53  
 Temp. Working Space Granted. CO - 75253 Pg. 014015 Date - Dec. 31, 1975

Simons Land Co. 10-31-73  
 CITY OF ADDISON  
 CITY OF DALLAS Ordinance No. 15119, March 1, 1976  
 HOCKADAY SCHOOL, INC.

ABSTRACT 1580  
 CITY OF DALLAS  
 BLK. 8222

**NOTE!!**  
 ALL R.C. FLANGE OUTLET CONNECTIONS ON CONCRETE PRESSURE PIPES MADE TO C.I. FLANGE FITTINGS SHALL BE INSULATED AS SHOWN ON APPURT. SHEET 414D-11

CONTRACT NO. 61-45  
 See Also 1960-3147

Sanitary Sewer Survey Along N. Side of Belt Line Rd. From Noel Rd. West. Contract # 571-13  
 Scale: 1"=40' Plan 1"=6' Vert.

TEMP. BENCH MARK:  
 R.R. Spike in pole at S.W. corner of Belt Line Rd. and Noel Rd. Elev. 626.77

**NOTE!** BORINGS BY:  
 MASON-JOHNSTON & ASSOCIATES.  
 BORING B-5 DRY AT 24-HR.  
 WATER CHECK. 30 NOV, 1960.

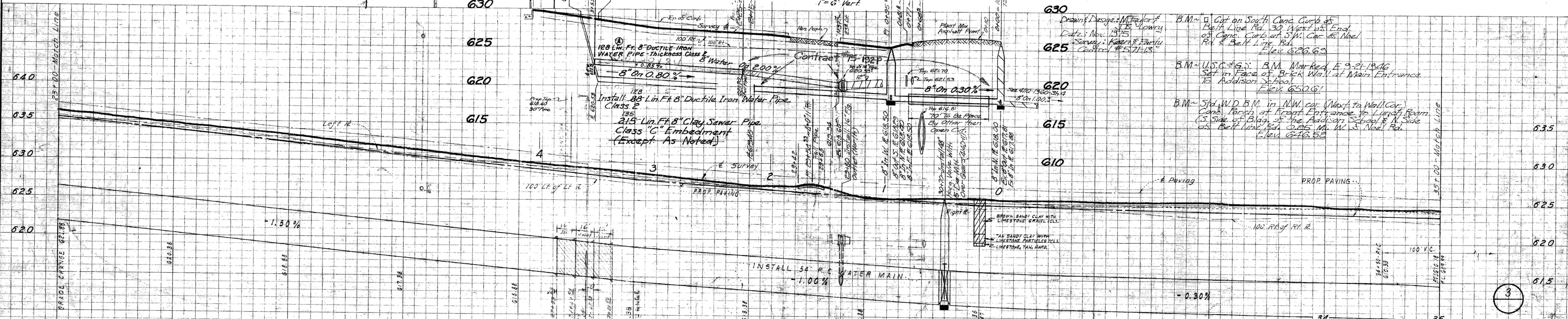

1200 LIN. FT. of 54" DOUBLE WRAP PRETENSIONED CONC. CYLINDER PIPE CLASS 125 OR  
 1240 LIN. FT. of 54" PRESTRESSED REINFORCED CONC. EMBEDDED CYLINDER PIPE CLASS 125  
 CLASS 3 EMBEDMENT

**54" R.C. WATER MAIN**  
 IN BELT LINE ROAD  
 FROM INWOOD RD. TO DULUS RD.  
**DALLAS CITY WATERWORKS**  
 CITY OF DALLAS, TEXAS

DESIGN	DRAWN	DATE	SCALE	NOTES	FILE	NO.
C.L. Moon Engineers	D.P.	May 60	1/4"=1'-6"	See notes	685-W	540-A

ROW Approved: [Signature] Date: 12-23-75  
 C.L. Moon Inc. Engineers  
 Approved By: [Signature] Date: 12-23-75  
 Engineer of Design: Dallas City Waterworks

**WATERS**  
**CITY OF DALLAS - 24" MAIN**  
**BELT LINE RD. WATERS - INWOOD RD DATE**

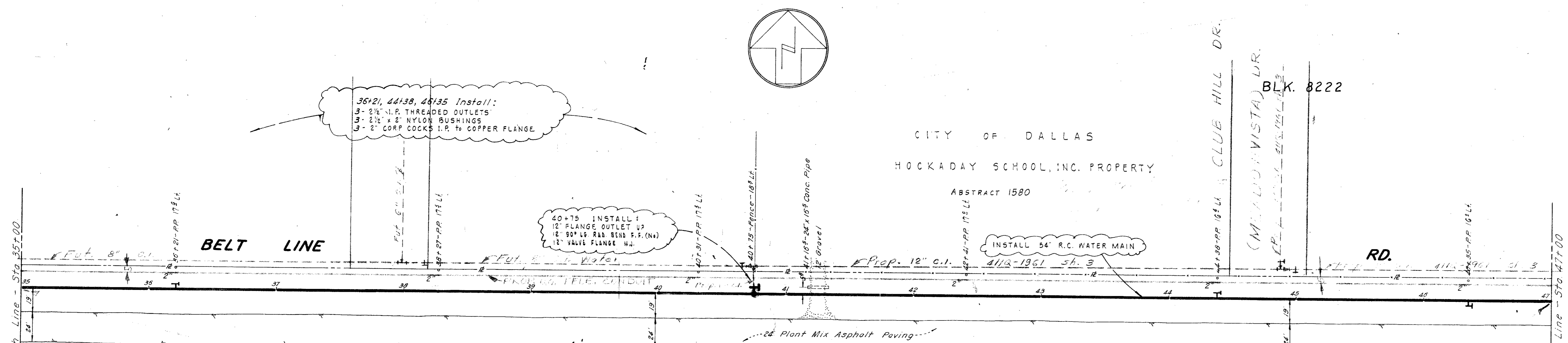

CITY OF DALLAS  
 HOCKADAY SCHOOL, INC. PROPERTY  
 ABSTRACT 1580

CLUB HILL DR.  
 (MADONVISTA) DR.  
 B.L.K. 8222

36+21, 44+38, 46+35 Install:  
 3 - 2 1/2" I.P. THREADED OUTLETS  
 3 - 2 1/2" x 2" NYLON BUSHINGS  
 3 - 2" CORP COCKS I.P. TO COPPER FLANGE

40+75 INSTALL:  
 12" FLANGE OUTLET UP  
 12" 90° LG. RAN BEND F.F. (N) 12"  
 12" VALVE FLANGE M.H.

INSTALL 54" R.C. WATER MAIN  
 411Q-1961 SH. 3

CONTRACT NO 61-45  
 Prep. 3" Water  
 411Q-1960 SH. 47

**NOTE!!**  
 ALL R.C. FLANGE OUTLET CONNECTIONS ON CONCRETE PRESSURE PIPES MADE TO C.I. FLANGE FITTINGS, SHALL BE INSULATED, AS SHOWN ON APPURT. SHEET 6140-II.

CITY OF ADDISON  
 M. S. MSENTIRE  
 ABSTRACT 157

Oaks North Add  
 411Q-1960 SH. 47, 48

BENCH MARK:  
 R.R. Spike in pole (no no) 4238'±  
 E. of Inwood Rd. & on N. side of  
 BELT LINE RD. ELEV. 599.08

**NOTE!** BORINGS BY:  
 MASON-JOHNSON ASSOCIATES  
 BORING B-6 DRY 24-HR.  
 WATER CHECK 10/24/1960.

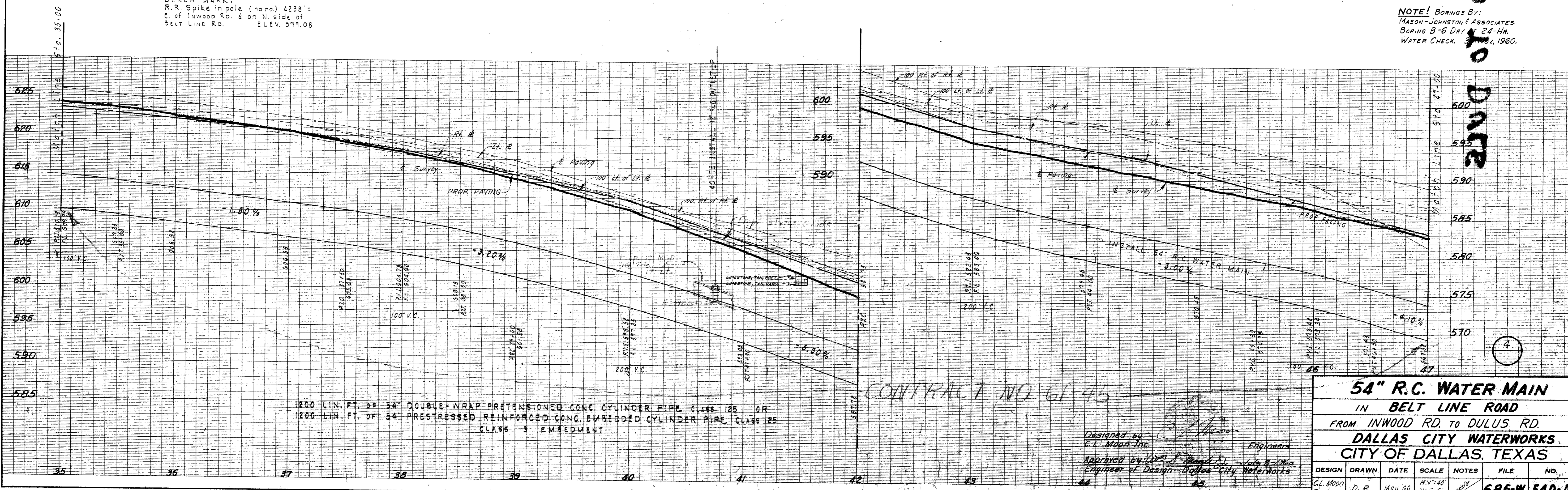

1200 LIN. FT. OF 54" DOUBLE-WRAP PRETENSIONED CONC. CYLINDER PIPE CLASS 125 OR  
 1200 LIN. FT. OF 54" PRESTRESSED REINFORCED CONC. EMBEDDED CYLINDER PIPE CLASS 25  
 CLASS 3 EMBEDMENT

CONTRACT NO 61-45

Designed by  
 C.L. Moon, Inc. Engineers  
 Approved by  
 Engineer of Design - Dallas City Waterworks

54" R.C. WATER MAIN						
IN BELT LINE ROAD						
FROM INWOOD RD. TO DULUS RD.						
DALLAS CITY WATERWORKS						
CITY OF DALLAS, TEXAS						
DESIGN	DRAWN	DATE	SCALE	NOTES	FILE	NO.
CL. Moon	D. R.	May 60	H.V. = 80 V.L. = 6			
						685-W 540-A

BELTWOOD RESERVOIR

CITY OF ADDISON

CITY OF ADDISON

S.T. LOUIS & SOUTHWESTERN RAILROAD

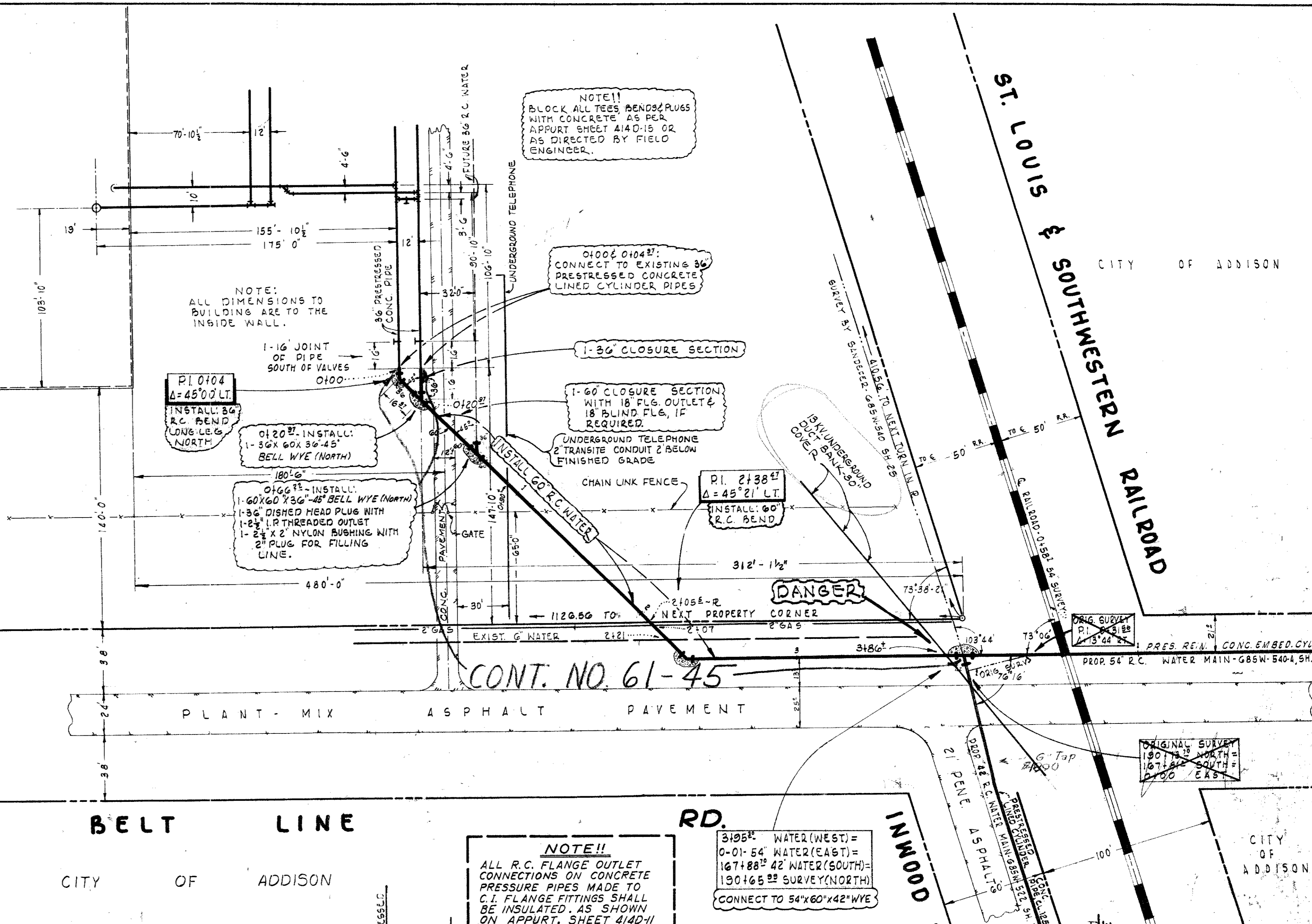

**NOTE!!**  
ALL R.C. FLANGE OUTLET CONNECTIONS ON CONCRETE PRESSURE PIPES MADE TO C.I. FLANGE FITTINGS SHALL BE INSULATED, AS SHOWN ON APPURT. SHEET 414D-11

3195' WATER (WEST) = 0-01' 54" WATER (EAST) = 167+88' 42" WATER (SOUTH) = 190+65' 22" SURVEY (NORTH)  
CONNECT TO 54" X 60" X 42" WYE

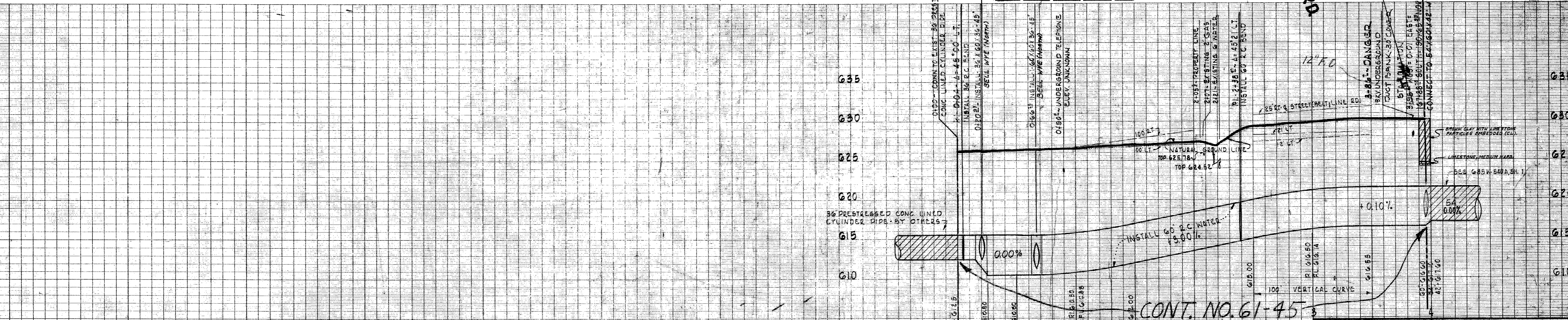

- 53 LINEAR FT. OF 36" PRESTRESSED CONCRETE LINED CYLINDER PIPE - CLASS 125
  - 4529 LINEAR FT. OF 54" DOUBLE WRAP PRETENSIONED CONCRETE CYLINDER PIPE - CLASS 115 OR
  - 4525 LINEAR FT. OF 54" PRESTRESSED REINFORCED CONCRETE EMBEDDED CYLINDER PIPE - CLASS 25
  - 393 LINEAR FT. OF 60" DOUBLE WRAP PRETENSIONED CONCRETE CYLINDER PIPE - CLASS 125 OR
  - 333 LINEAR FT. OF 60" PRESTRESSED REINFORCED CONCRETE EMBEDDED CYLINDER PIPE - CLASS 125
- CLASS 3' EMBEDEDMENT

BENCH MARK  
WATER DEPARTMENT DISK ON CONCRETE HEADWALL  
ON SOUTH SIDE OF BELT LINE ROAD ON EAST SIDE OF  
COTTEN BELT RAILROAD - ELEVATION = 634.13

**60" X 36" R. C. WATER MAIN**  
IN BELT LINE ROAD FROM BELT-  
WOOD RESERVOIR TO INWOOD ROAD  
DALLAS CITY WATERWORKS  
CITY OF DALLAS, TEXAS

DESIGN	DRAWN	DATE	SCALE	NOTES	FILE	NO.
CAMPBELL	LOVE	11-4-60	HOR. 1"=40' VERT. 1"=10'	ONLY TO 11-4-60		685W-540A