

CITY OF ADDISON

ABSTRACT 1580

NOTE!
THIS ENTRANCE AND EXIT DRIVEWAY TO THE ADDISON SCHOOL SHALL BE KEPT OPEN TO TRAFFIC AT ALL TIMES.

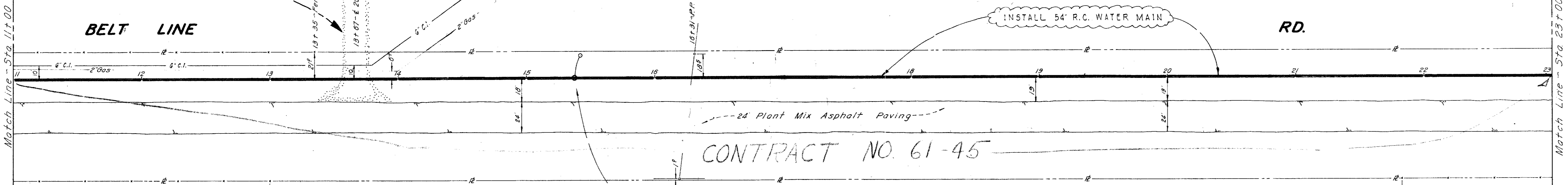

NOTE!!
ALL R.C. FLANGE OUTLET CONNECTIONS ON CONCRETE PRESSURE PIPES MADE TO C.I. FLANGE FITTINGS, SHALL BE INSULATED, AS SHOWN ON APPURT. SHEET 414-D-11

15+38.5 INSTALL:
18" FLANGE OUTLET UP
TYPE II - 3" CRISPIN AIR VALVE
INSTALLATION AS PER APPURT. SHEET 414-D-11

CITY OF ADDISON

ABSTRACT 157

BENCH MARK:
U.S.C. & G. bronze disc marked E 921-1946 set
in face of brick wall at main entrance door of
Addison School. ELEV. 450.61

NOTE! BORINGS BY:
MASON-JOHNSTON & ASSOCIATES.
BORINGS B-3 & B-4 DRY AT 24-HR.
WATER CHECK. 30 NOV, 1960.

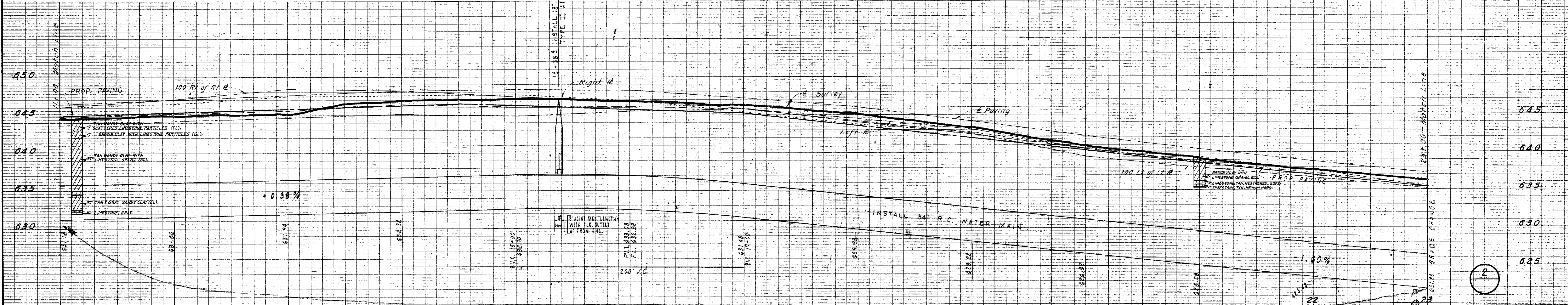

CONTRACT NO. 61-45

1200 LIN. FT. OF 54" DOUBLE-WRAP PRETENSIONED CONC. CYLINDER PIPE CLASS 125 OR
1200 LIN. FT. OF 54" PRESTRESSED REINFORCED CONC. EMBEDDED CYLINDER PIPE CLASS 125
CLASS B EMBEDMENT

Designed by:
C.L. Moon, Inc. Engineers
Approved by: [Signature] July 8-1960
Engineer of Design - Dallas City Waterworks

54" R.C. WATER MAIN
IN BELT LINE ROAD
FROM INWOOD RD. TO DULS ROAD
DALLAS CITY WATERWORKS
CITY OF DALLAS, TEXAS

DESIGN	DRAWN	DATE	SCALE	NOTES	FILE	NO.
C.L. MOON Engineers	D.P.	May 60	H:V = 40 V:V = 5			685-W 540-A