

**WATER**  
**CITY OF DALLAS - 24" MAIN**  
**BELT LINE RD. WATER - INWOOD RD**  
**TO DATE**

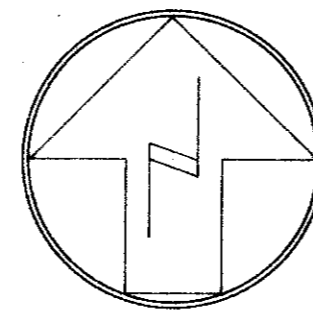

CITY OF DALLAS  
 HOCKADAY SCHOOL, INC. PROPERTY  
 ABSTRACT 1580

BLK. 8222  
 (MADONVISTA) DR.

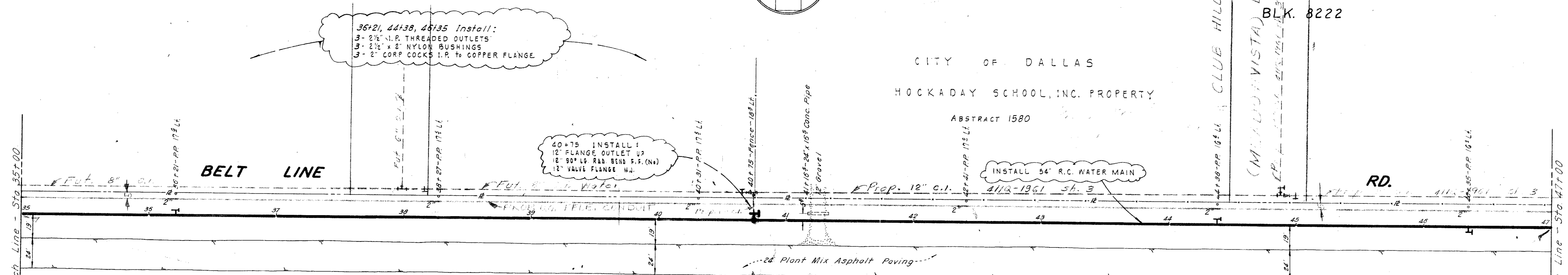

**NOTE!!**  
 ALL R.C. FLANGE OUTLET CONNECTIONS ON CONCRETE PRESSURE PIPES MADE TO C.I. FLANGE FITTINGS, SHALL BE INSULATED, AS SHOWN ON APPURT. SHEET 6140-II.

CONTRACT NO 61-45  
 Prop. 12" Water  
 411Q-1960 SH 47

CITY OF ADDISON  
 M. S. MSENTIRE  
 ABSTRACT 157

Oaks North Add  
 411Q-1960 SH 47, 48

BENCH MARK:  
 R.R. Spike in pole (no no) 4238'-  
 E. of Inwood Rd. & on N. side of  
 Belt Line Rd. ELEV. 599.08

**NOTE!** BORINGS BY:  
 MASON-JOHNSTON ASSOCIATES  
 BORING B-6 DRY 24-HR.  
 WATER CHECK 10/24/1960.

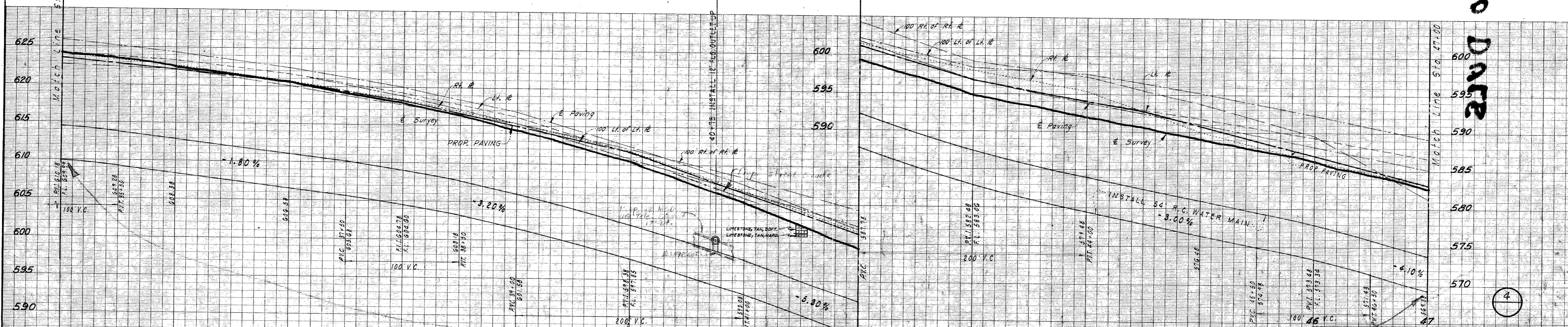

1200 LIN. FT. OF 54" DOUBLE-WRAP PRETENSIONED CONC. CYLINDER PIPE CLASS 125 OR  
 1200 LIN. FT. OF 54" PRESTRESSED REINFORCED CONC. EMBEDDED CYLINDER PIPE CLASS 25  
 CLASS 3 EMBEDMENT

CONTRACT NO 61-45

Designed by  
 C.L. Moon, Inc. Engineers  
 Approved by  
 Engineer of Design - Dallas City Waterworks

54" R.C. WATER MAIN						
IN BELT LINE ROAD						
FROM INWOOD RD. TO DULUS RD.						
DALLAS CITY WATERWORKS						
CITY OF DALLAS, TEXAS						
DESIGN	DRAWN	DATE	SCALE	NOTES	FILE	NO.
CL. Moon	D. R.	May 60	H <sub>v</sub> = 80 V <sub>v</sub> = 6			
						685-W 540-A