

FINAL PLAT & ENGINEERING PLANS FOR ADDISON TOWN CENTER SUBDIVISION ADDISON, TEXAS

SHEET INDEX

C-1	FINAL PLAT
C-2	FINAL PLAT
C-3	WATER AND SANITARY SEWER PLAN (PROFILE LN, A)
C-4	DRAINAGE AREA MAP
C-5	STORM SEWER PLAN & PROFILE (LINES D-1, D-2, D-3, & D-1.1)
C-6	54" RCP JUNCTION BOX DETAIL
C-7	SAN. SEW. LN. B PROFILE
C-8	LES LACS AVE. & PROTON AVE. PROFILES
C-9	PAVING PLAN & PROFILE - PARK PLACE
C-10	LEFT TURN LANE- BELTWAY DR. AT LES LACS AVE. (DELETED FROM THE PROJECT)
C-11	LOT GRADING PLAN
C-12	EROSION CONTROL PLAN
GN-12	GENERAL NOTES
SD-1	STREET CROWNS & JOINTS
SD-2	SIDEWALK & RAMPS
SD-3	CURB INLETS
SD-4	TURN LANES & JOINTS
SD-5	EMBEDMENT DETAILS
SD-6	MANHOLES & CONNECTIONS
SD-7	LATERALS & CLEANOUTS
SD-8	SCREEN WALL DETAILS (SEE SCREEN WALL PLANS)
SD-9	CONCRETE HEADWALLS FOR PIPE CULVERTS
SD-10	FIRE HYDRANTS, PULL BOXES & VALVES
SD-11	THRUST BLOCKS
SD-12	TYPE "B" MANHOLE

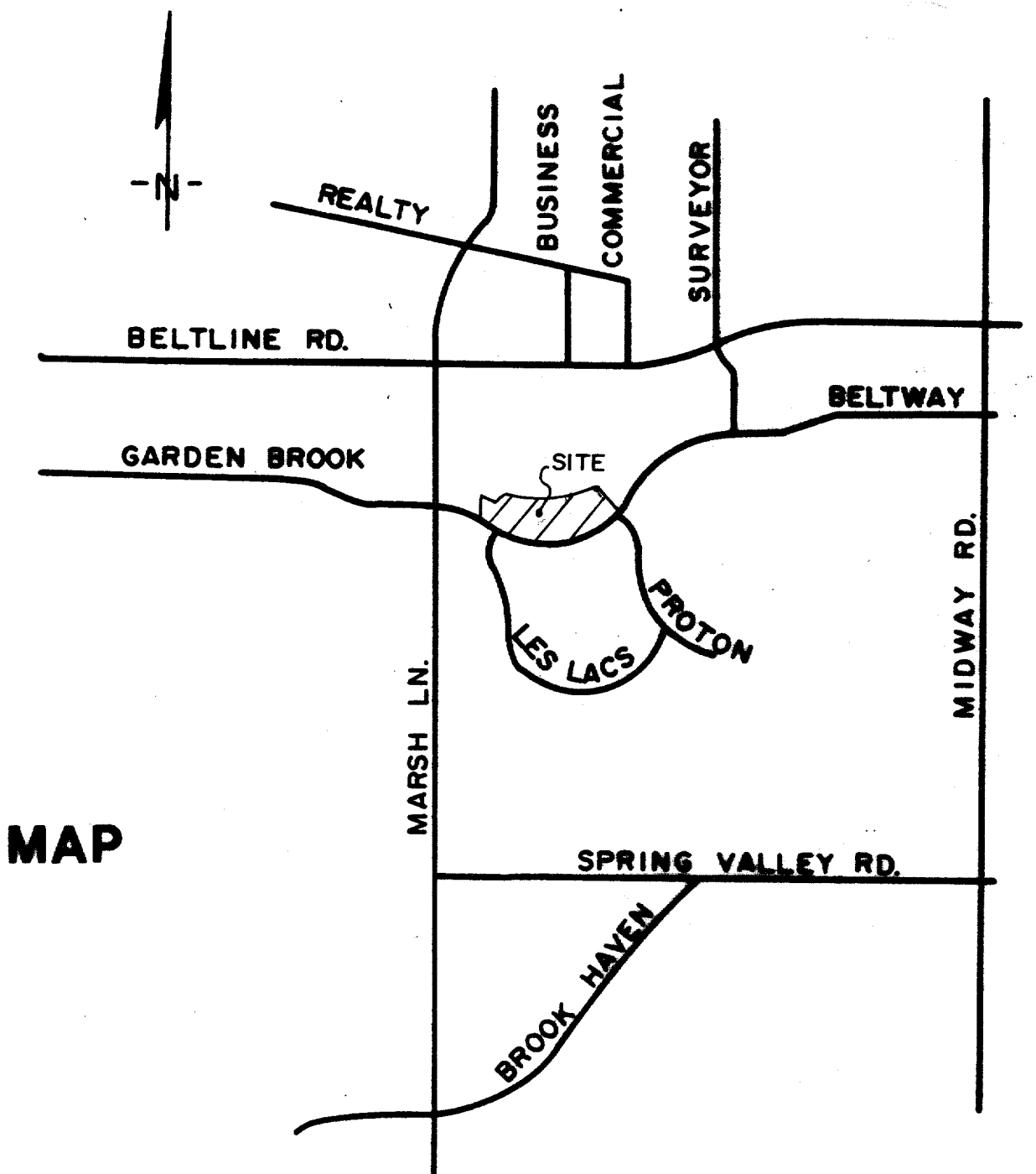

LOCATION MAP

OWNER:
GRAND LAND, LTD.
8800 N. CENTRAL EXPWY, STE 330
DALLAS, TEXAS 75231
(214) 750-6528

ENGINEER:
LAWRENCE A. CATES & ASSOCIATES, INC.
14200 MIDWAY ROAD, SUITE 122
DALLAS, TEXAS 75244
(214) 385-2272

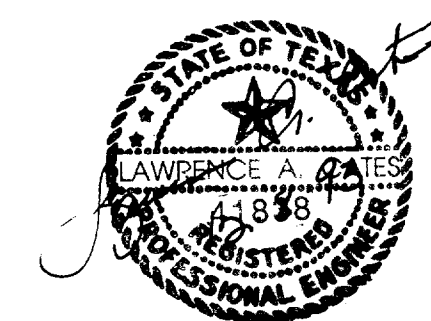

JUNE 15, 1993

AS-BUILTS

I CERTIFY THIS PROJECT WAS CONSTRUCTED IN GENERAL CONFORMANCE WITH THESE CONSTRUCTION PLANS AND WILL FUNCTION AS DESIGNED.

ADDISON TOWN CENTER SUBDIVISION

FF-6