

Drainage Calculations (T.H.D. Hydraulic Manual)

Rolling Terrain 1% - 3.5%
 Impervious Soil
 Commercial C = 0.6 - 0.9 (use C = 0.75)

For Dallas County
 $I_{24} = \frac{b}{(1+d)^e} = \frac{90}{(10+8.7)^{.774}} = 9.3 \text{ in/hr.}$
 $Q_{24} = C.I.A. = (0.75)(9.3)(A)$
 $Q_{24} = 6.95(A)$

Acres
 C.F.S.

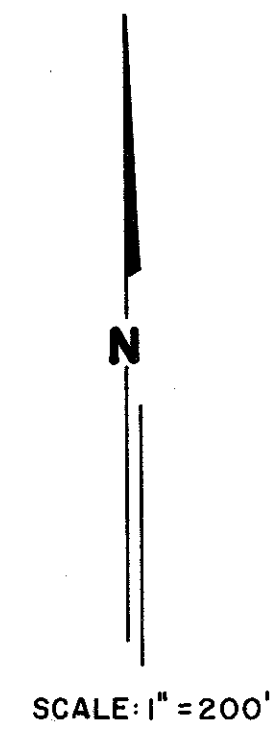

SCALE: 1" = 200'

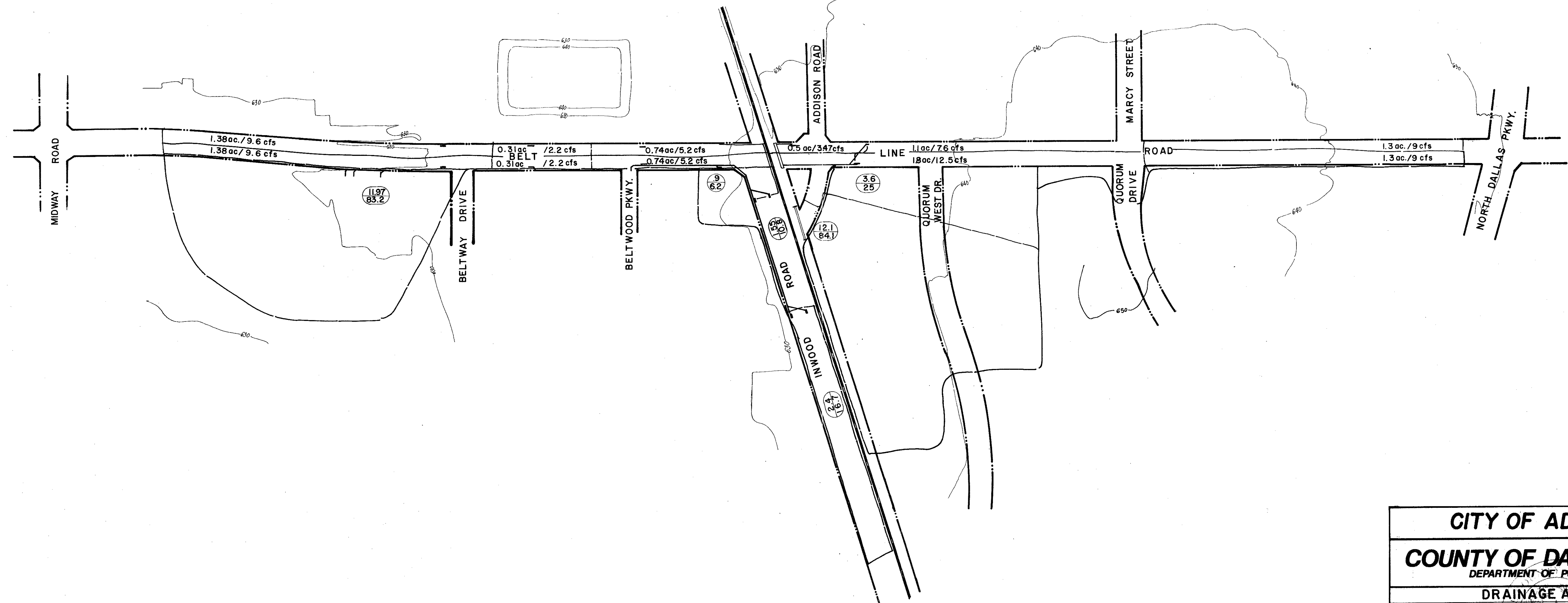

CITY OF ADDISON		
COUNTY OF DALLAS, TEXAS		
<small>DEPARTMENT OF PUBLIC WORKS</small>		
DRAINAGE AREA MAP		
BELT LINE ROAD		
MIDWAY ROAD TO NORTH DALLAS PKWY.		
GINN, INC., CONSULTING ENGINEERS		
<small>DESIGNED - H.B.J.</small>	<small>DRAWN - B.H.</small>	<small>DATE - MAY-1980</small>
<small>APPROVED - HWG</small>	<small>CHECKED - S.M.</small>	<small>SCALE - 1" = 200'</small>
		<small>FILE SHEET 30 OF</small>