

Approx. location 10" san. sewer. Locate prior to start of construction. Exist. sewer encased under riprap.

Install 29 L.F. 36" R.C.P. Breakout exist. wall as required. Bevel cut end for flush finish.

Remove and relay exist. 21" R.C.P. as req'd. to tie to new 36" R.C.P. (I.L.F.)

Remove wall and footing.

Remove wall to top of box.

Remove all 6" non-reinf. channel lining. (100 S.Y.)

Remove parapet. Bend reinf into new box.

Remove wall footing. Extend reinf into new box.

Remove wall footing.

Remove parapet. Bend reinf into new box.

Remove wall footing. Extend reinf into new box.

Remove wall footing.

Remove wall footing.

Remove wall footing.

Remove wall footing.

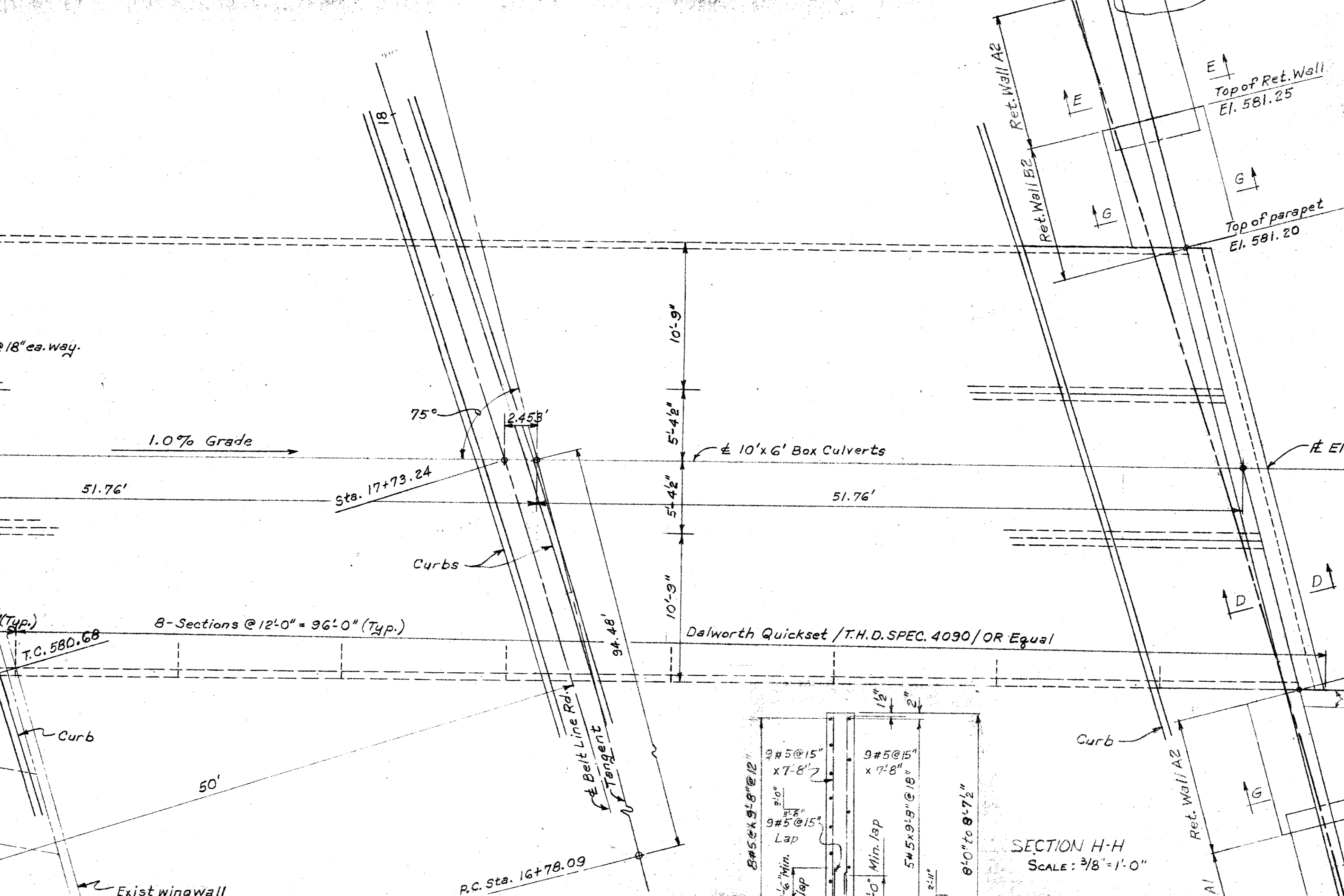

PLAN OF BOX CULVERT
Scale: 3/16" = 1'-0"

SECTION A-A
Scale: 3/8" = 1'-0"

SECTION B-B
Scale: 3/8" = 1'-0"

SECTION C-C
Scale: 3/8" = 1'-0"

SECTION D-D
Scale: 3/8" = 1'-0"

SECTION E-E
Scale: 3/8" = 1'-0"

SECTION F-F
Scale: 3/8" = 1'-0"

SECTION G-G
Scale: 3/8" = 1'-0"

SECTION H-H
Scale: 3/8" = 1'-0"

SECTION I-I
Scale: 3/8" = 1'-0"

SECTION J-J
Scale: 3/8" = 1'-0"

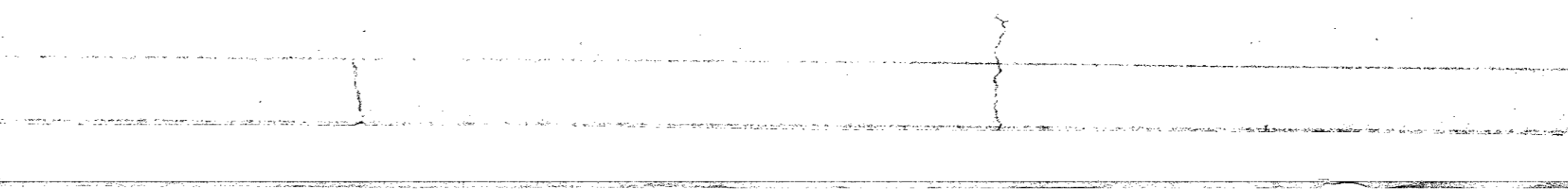
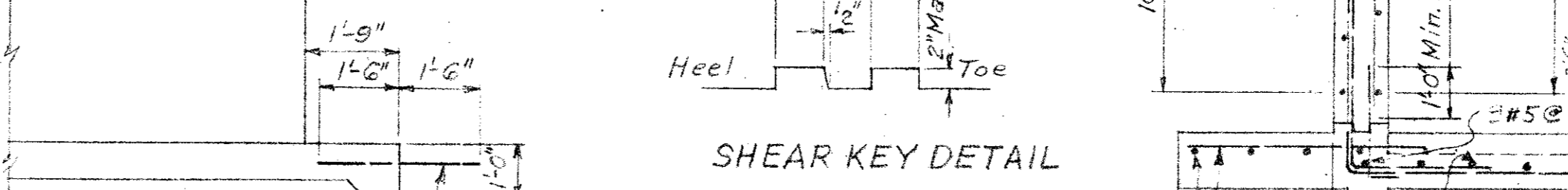
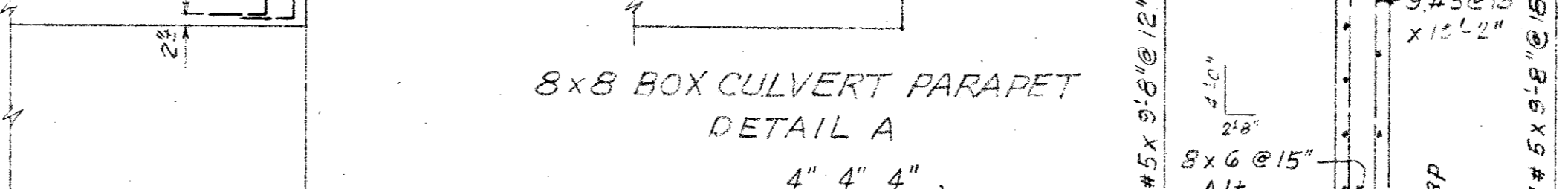
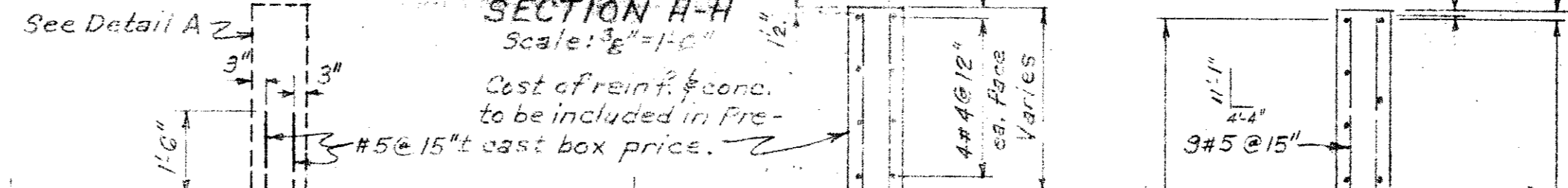
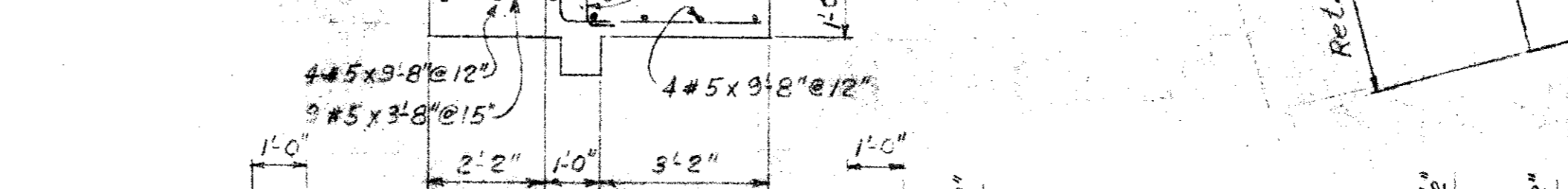
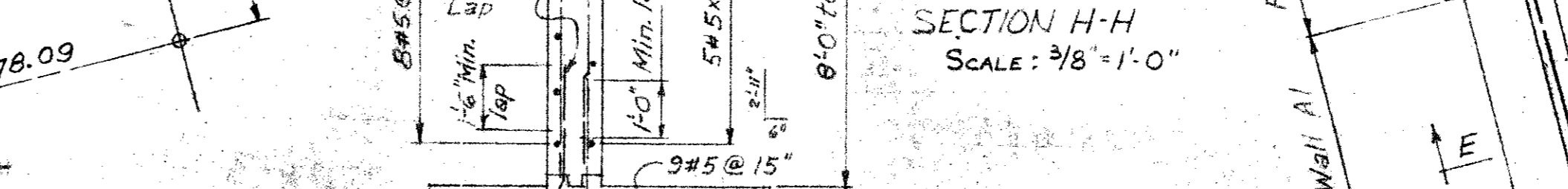
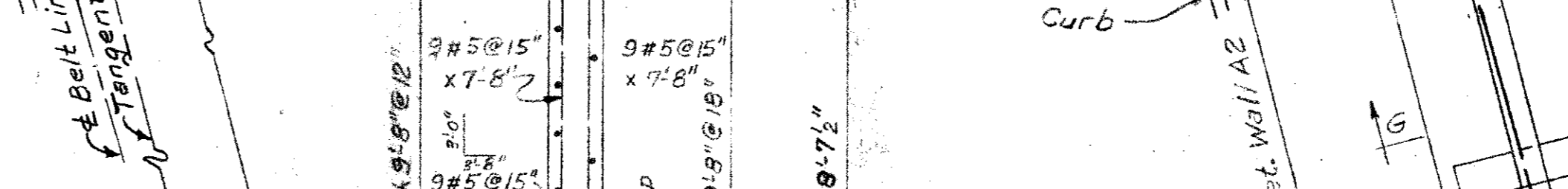
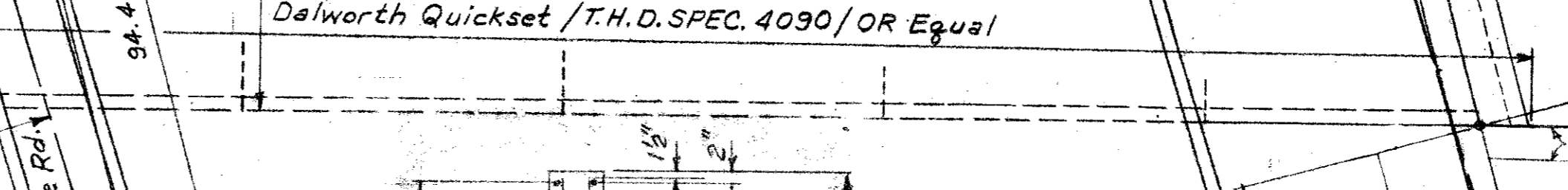
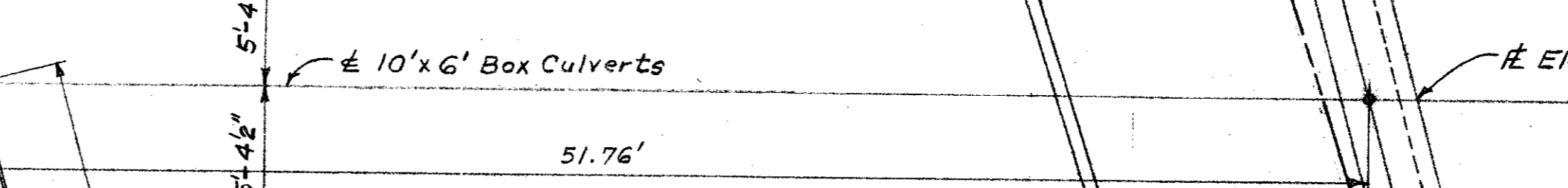
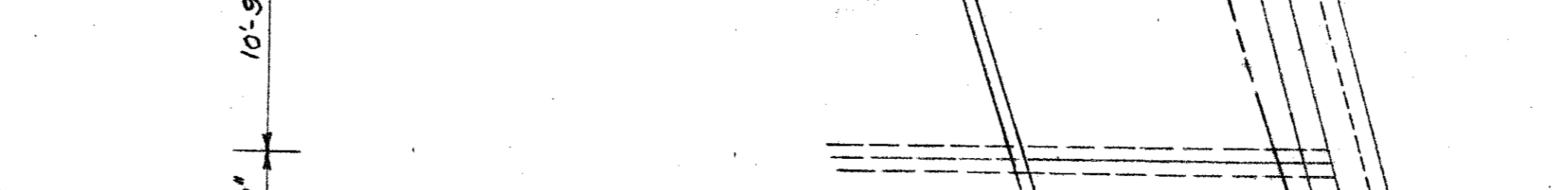
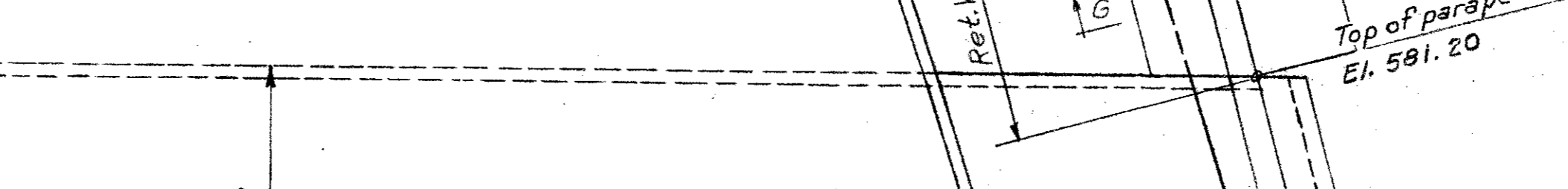
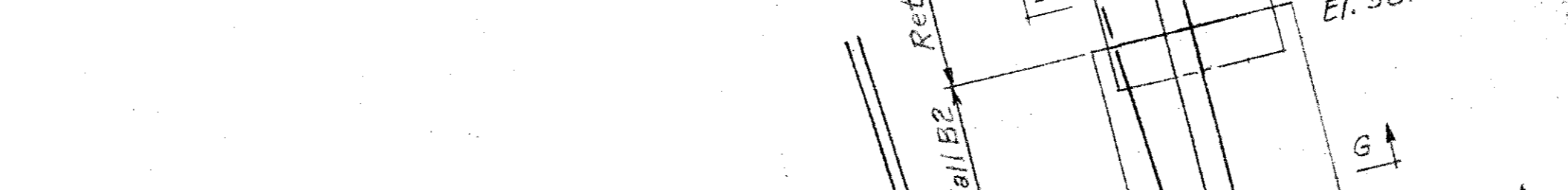
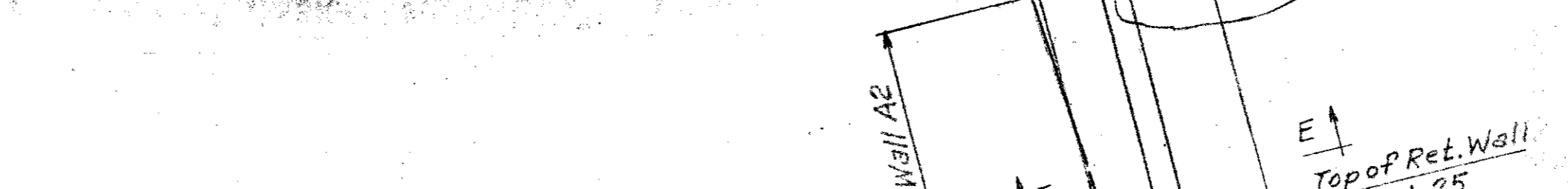

Remove parapet. Bend reinf into new box.

Remove wall footing. Extend reinf into new box.

Remove wall footing.

Remove parapet. Bend reinf into new box.

Remove wall footing. Extend reinf into new box.

Remove wall footing.

Remove parapet. Bend reinf into new box.

Remove wall footing. Extend reinf into new box.

Remove wall footing.

Remove parapet. Bend reinf into new box.

Remove wall footing. Extend reinf into new box.

Remove wall footing.

Remove parapet. Bend reinf into new box.

Remove wall footing. Extend reinf into new box.

Remove wall footing.

Remove parapet. Bend reinf into new box.

RETAINING WALL CLASS
All concrete to be Class C, f_c = 3000 psi in 28 days.
All reinf. steel to be A.S.T.M. Grade 60.
Concrete 64.4 C.Y.
Reinf. Steel 6061 Lbs.

1	Add. Sh.	6-13-80
NO.	REVISION	DATE

CITY OF ADDISON
COUNTY OF DALLAS, TEXAS
DEPARTMENT OF PUBLIC WORKS
BOX CULVERT & RETAINING WALL DETAILS
BELT LINE ROAD
MARSH LN. TO NORTH DALLAS PKWY.
GINN, INC., CONSULTING ENGINEERS

DESIGNED - A.C.F.	DRAWN - A.C.F.	DATE - JUNE 1980	FILE
APPROVED - HWG	CHECKED - S.M.	SCALE - AS SHOWN	SHEET 33 A OF