

ESTIMATED QUANTITIES			
ITEM	DESCRIPTION	UNIT	QUANTITY
100	Prepare Roadway R.O.W	Sta.	5
104.1	Remove Old Concrete, Pavement & Median	SY	223
104.2	Sawed Break-Out Groove	LF	41.5
110	Unclassified Road Excavation (Dens Cont.)	CY	2704
160	Placing 4" Topsoil	CY	25.24
248	6" Flex Base (Dens Cont.) (Ty A, Gr 2, C1 3)	CY	
260.1	Lime (Ty A) Slurry Method	Ton	45.90
260.2	6" Lime Treated Subgrade (Dens Cont.)	SY	3671.95
340.1	3" Hot Mix Asph (Ty D) Resurf Shoulder	Ton	77.01
340.2	6" Hot Mix Asphalt (Ty B)	Ton	306.59
360.1	8" Conc Pavement (3000 PSI)	SY	4382.04
360.2	6" Conc Monolithic Curb (3000 PSI)	LF	1833
360.3	4" Non-Reinf Conc in Median (2000PSI)	SY	87.15
479.1	Adjust Water Valves	EA	1
640.5	2" PVC. SCH 40 (Conc. Encasement)	L.F.	45
522	Conc Curb & Gutter Class A	LF	
524	Conc Driveways, Appr 5" Reinf Conc (3000PSI)	SY	
630.1	Foundation (Ty A) Traffic Sig in Place	EA	
630.2	Foundation (Ty B) Traffic Sig in Place	EA	
630.3	Foundation (Ty C) Traffic Sig in Place	EA	
630.4	Foundation (Ty D) Illumination	EA	2
640.1	1/2" PVC Conduit, Furnish & Install	LF	500
640.2	2" PVC Conduit, Furnish & Install	LF	409
640.3	3" PVC Conduit, Furnish & Install	LF	181
640.4	Pull Box, Complete in Place	EA	4
752.1	Traffic Buttons - Single Refl Ty P15 White	EA	44
752.2	Traffic Buttons - Single Refl Ty P18-1 White	EA	21
754.1	Traffic Buttons - Nonrefl, Ty P7 White	EA	220

LEGEND	
□	Bench Mark
•	Iron Pin
○	Monument
⊙	Gas Meter
⊕	Gas Valve
⊖	Gas Valve
⊗	Gas Line
⊘	Power Pole (Typical Pole Symbol)
⊙	Power Line
⊙	Guy Wire Anchor
⊙	Telephone Line
⊙	Water Meter
⊙	Water Valve
⊙	Water Line
⊙	Fire Hydrant
⊙	Manhole
⊙	Sanitary Sewer Line
⊙	Fence Line
⊙	Flow Direction Indicator
⊙	Property or Right-of-Way Line (R.O.W.)
⊙	Easement Line
⊙	Traffic Pole Base
⊙	Mast Arm Pole Foundation (Type A or B)
⊙	Pedestal Pole Foundation (Type C)
⊙	Signal Illumination Pole Foundation (Type D)
T.C.	Top of Curb
E	Flow Line

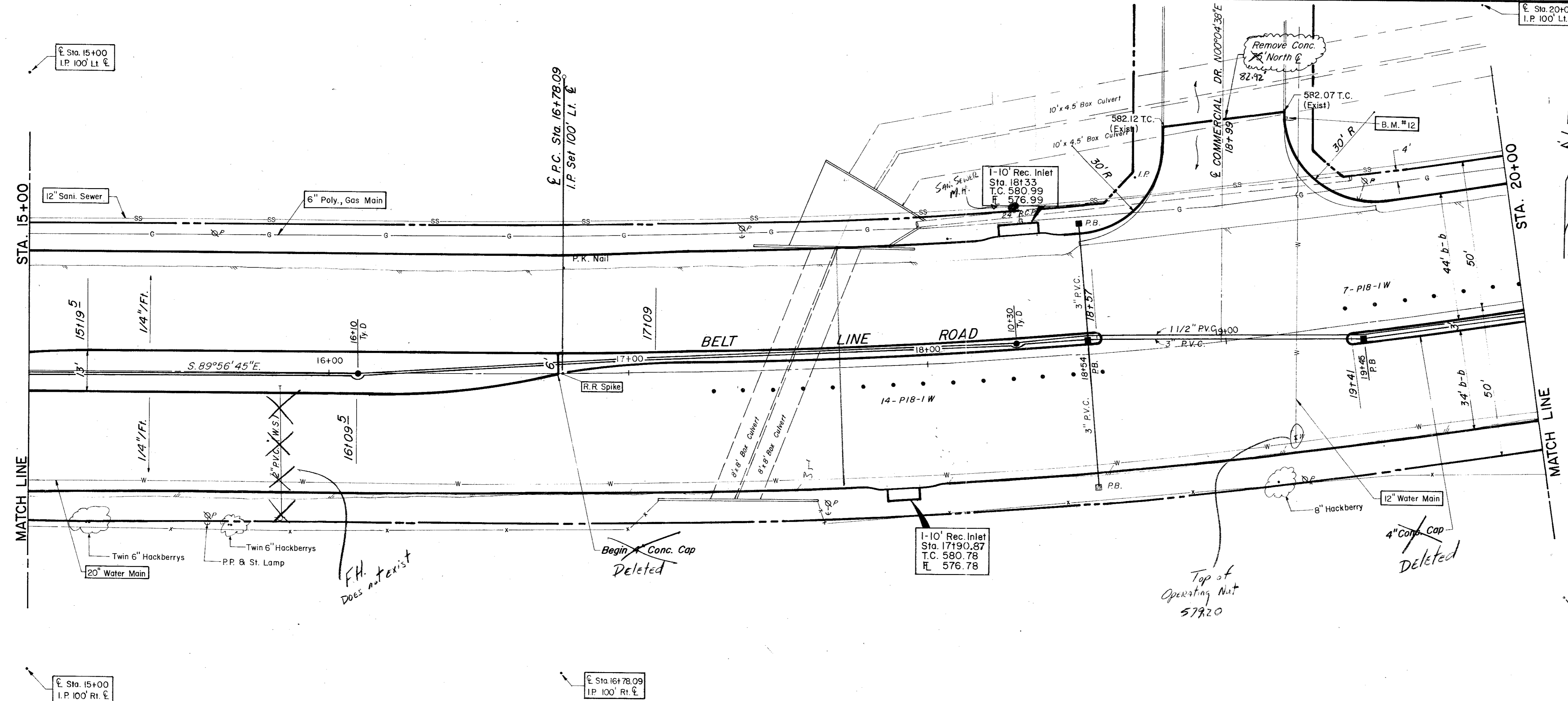

B.M. #12 "d" Top of Curb At Curb Return East Side Of Commercial Dr. & N. Belt Line, ELEV. = 582.16

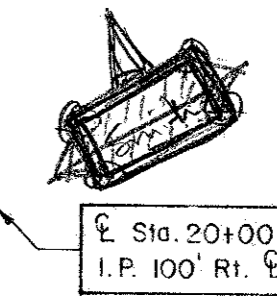
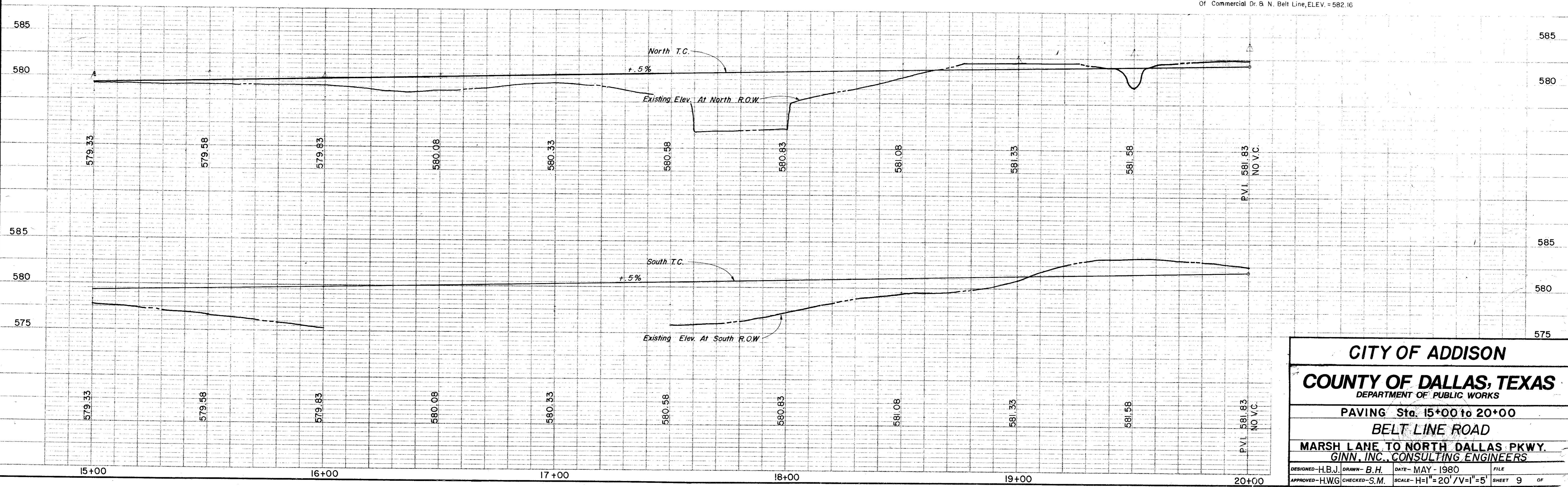

**CITY OF ADDISON**  
**COUNTY OF DALLAS, TEXAS**  
 DEPARTMENT OF PUBLIC WORKS

PAVING Sta. 15+00 to 20+00  
**BELT LINE ROAD**  
 MARSH LANE TO NORTH DALLAS PKWY.  
 GINN, INC., CONSULTING ENGINEERS

DESIGNED - H.B.J. DRAWN - B.H. DATE - MAY - 1980 FILE  
 APPROVED - HWG CHECKED - S.M. SCALE - H=1"=20' / V=1"=5' SHEET 9 OF