

USER: ch1770

OFFICE: DAL

PROJECT # 29350

FILE: 29350 TEL 03.dgn

TIME: 11:22:14 AM

DATE: 12/19/2013

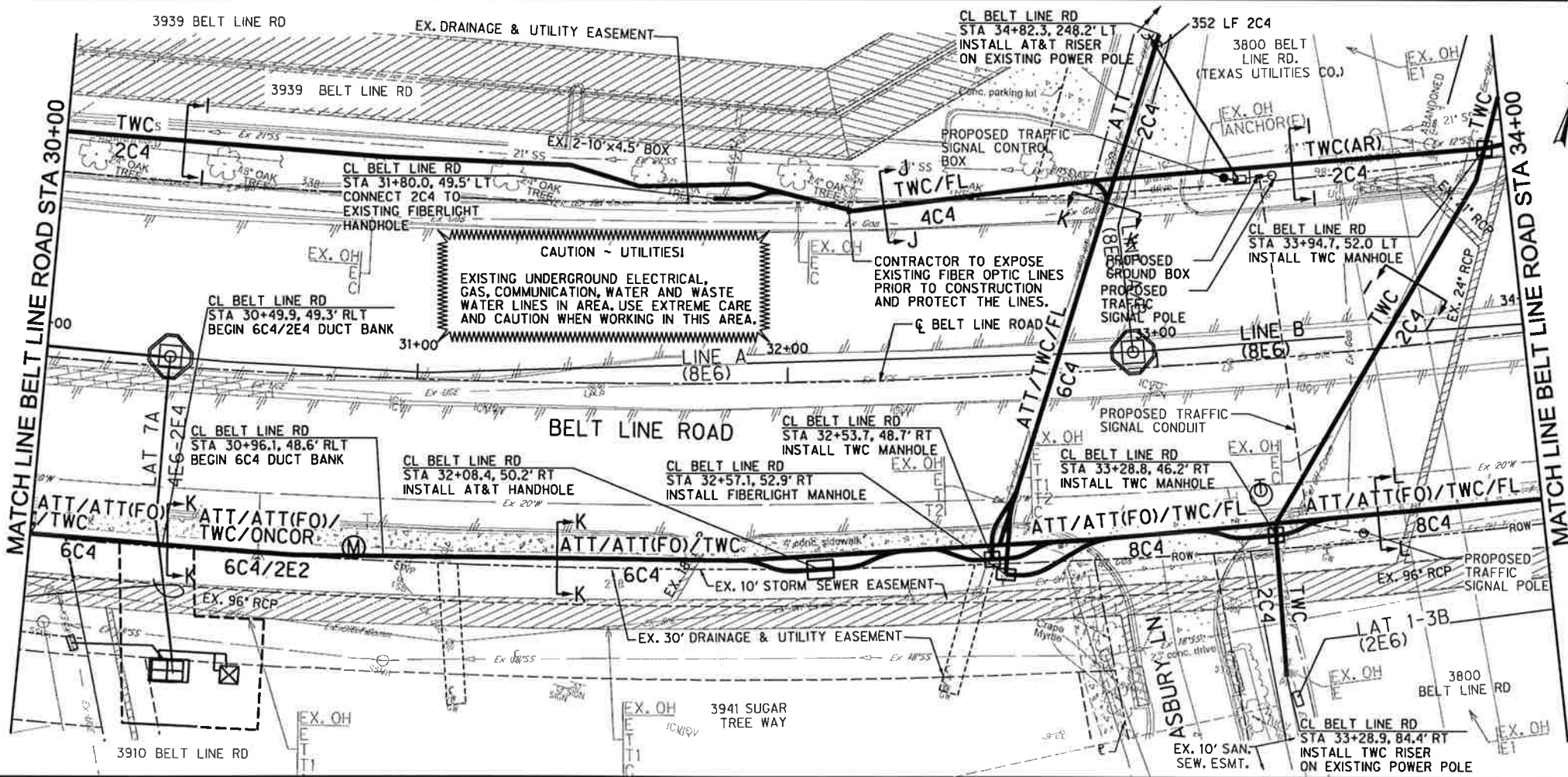
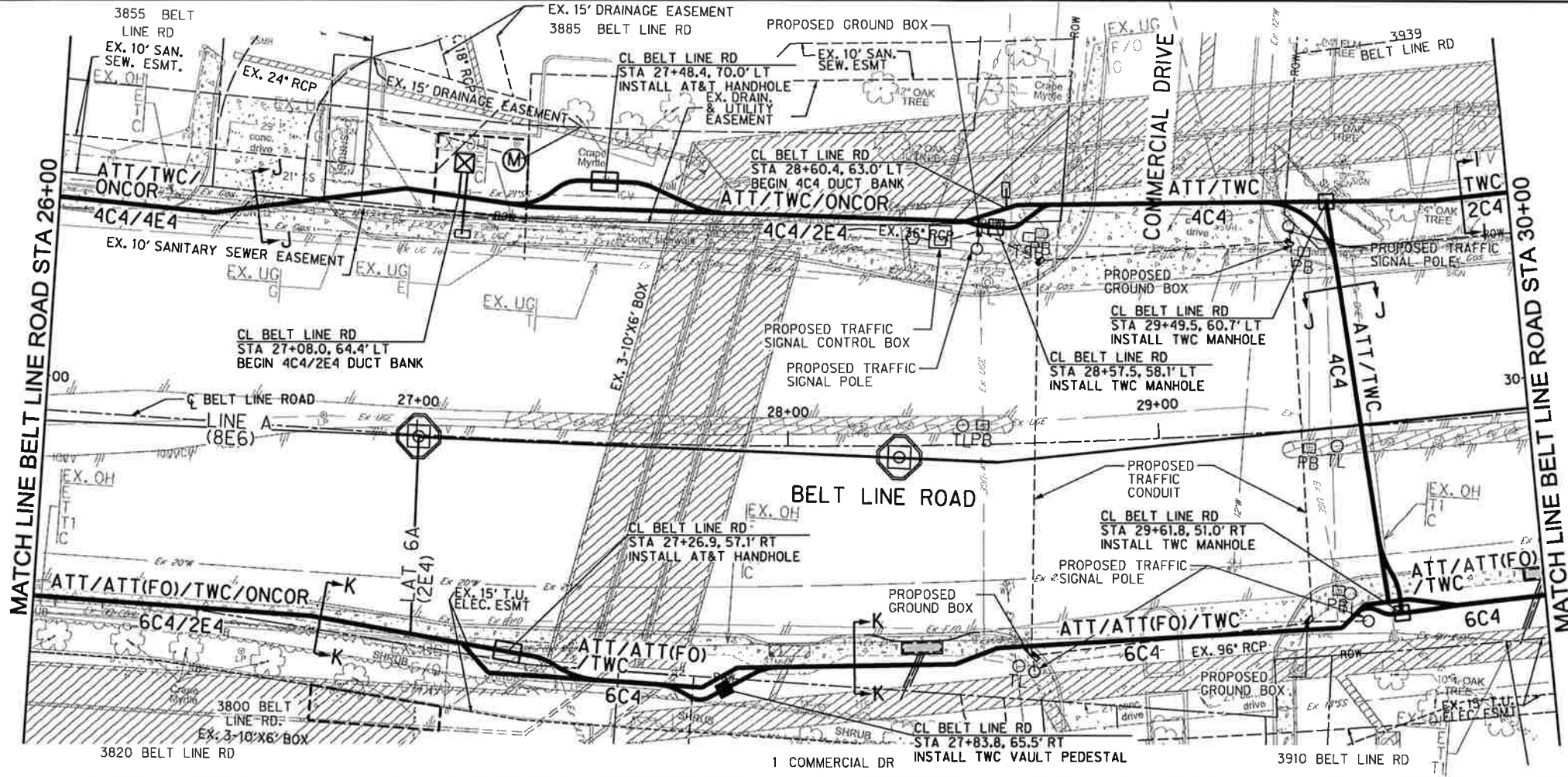

EXISTING UTILITY LOCATIONS SHOWN ARE SCHEMATIC IN NATURE AND MAY NOT ACCURATELY REFLECT THE SIZE AND LOCATION OF EACH PARTICULAR UTILITY. SOME UTILITY LINES MAY NOT BE SHOWN. CONTRACTOR SHALL ASSUME RESPONSIBILITY FOR ACTUAL FIELD LOCATION AND PROTECTION OF ALL EXISTING UTILITIES WHETHER SHOWN OR NOT. CONTRACTOR SHALL ALSO ASSUME RESPONSIBILITY FOR REPAIRS TO EXISTING UTILITIES, WHETHER SHOWN OR NOT, DAMAGED BY CONTRACTOR'S ACTIVITIES. DIFFERENCES IN HORIZONTAL OR VERTICAL LOCATION OF EXISTING UTILITIES SHALL NOT BE A BASIS FOR ADDITIONAL COMPENSATION. CALL 1-800-344-8377 TWO WORKING DAYS PRIOR TO CONSTRUCTION FOR ONSITE LOCATIONS.

**LEGEND**

- ONCOR SEE ONCOR DUCT BANK PLAN SHEETS FOR ONCOR LOAD CABLES TO BE LOCATED IN JOINT TRENCH.
- ATT PROPOSED AT&T TELEPHONE LINE (2- 4" PVC)
- ATT(FO) PROPOSED AT&T FIBER OPTIC LINE (2- 4" PVC)
- FL PROPOSED FIBERLIGHT LINE (2- 4" PVC)
- TWC PROPOSED TIME WARNER CABLE LINE REQUIRED TO REPLACE EXISTING TIME WARNER CABLE (2-4" PVC)
- TWC(AR) ADDITIONAL REQUESTED PROPOSED TIME WARNER CABLE LINE (2-4" PVC)
- PROPOSED TIME WARNER PULL BOX
- PROPOSED TIME WARNER PEDESTAL/VAULT
- PROPOSED AT&T HANDHOLE
- PROPOSED FIBERLIGHT HANDHOLE

ATT/TWC/FL/ONCOR PROPOSED AT&T, TIME WARNER CABLE ONCOR AND FIBERLIGHT LINE IN JOINT TRENCH

— BY OTHER THAN OPEN CUT  
 - - - - - B.O.T.O.C.

NOTE:  
 1. ALL LINES TO BE INSTALLED BY OPEN CUT UNLESS OTHERWISE NOTED.

WAITING ON DESIGN AT&T FIBERLIGHT TIME WARNER



*almon* P.E. 12-19-2013  
 Signature of Registrant Date

FIRM REGISTRATION NUMBER: 312

NO.	REVISION	BY	DATE
<b>TOWN OF ADDISON</b> DALLAS COUNTY, TEXAS  <b>BELT LINE ROAD</b> UNDERGROUND ELECTRICAL  <b>TELECOM RELOCATION PLAN</b> BELT LINE RD STA 26+00 TO STA 34+00  <b>HALFF</b> 1201 NORTH BOWSER ROAD, RICHARDSON, TEXAS 75081-2275 TEL (214) 348-8200 FAX (214) 738-0095			
PROJECT	DESIGN	DRAWN	DATE
29350	HALFF	HALFF	NOV, 2013
FILE	SHEET		
29350 TEL 03	TEL-3		

SHEET 109 OF 235