

USER: ah1299
 OFFICE: RCH
 PROJECT: 29350
 FILE: 29350 TCP01-05-01.dgn
 TIME: 3:14:27 PM
 DATE: 10/24/2013

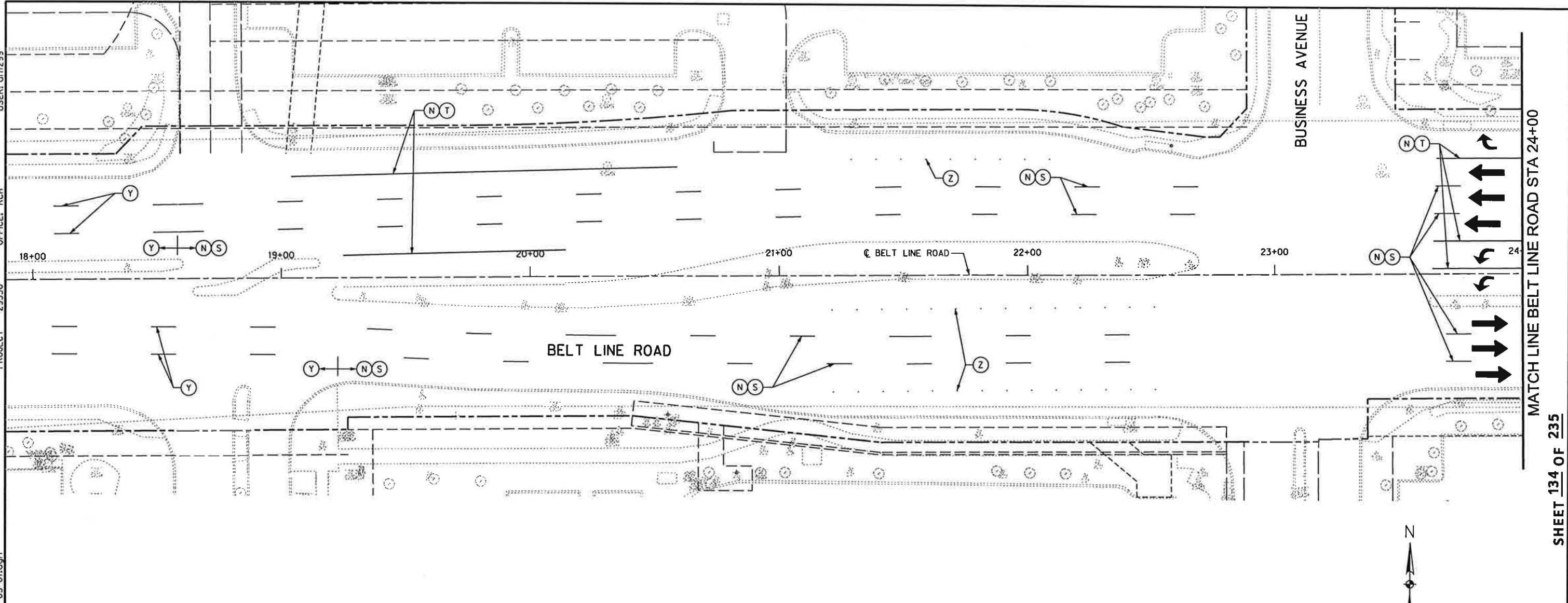

MATCH LINE BELT LINE ROAD STA 24+00
 SHEET 134 OF 235

LEGEND

- ▲ CONES
- OPPOSING TRAFFIC LANE DIVIDERS (OTLD)
- DRUMS
- TYPE III BARRICADE
- LOW PROFILE CONCRETE BARRIER
- ← LANES TO BE OPEN AT ALL TIMES
- ⇄ LANES TO BE CLOSED DURING OFF-PEAK HOURS ONLY
- DUCT BANK TRENCH
- ▣ DUCT BANK BORING
- Ⓝ NON-REMOVABLE
- Ⓡ REMOVABLE
- Ⓢ 4" WHITE BROKEN
- Ⓣ 4" WHITE SOLID
- Ⓨ PREVIOUS PAVEMENT MARKINGS
- Ⓩ EXISTING RAISED PAVEMENT MARKINGS

NOTES:
 1. ALL LOW PROFILE CONCRETE BARRIERS SHALL BEGIN WITH A TYPE 2 LPCB. END LOW PROFILE CONCRETE BARRIERS WITH A TYPE 2 LPCB WHEN IT CAN BE IMPACTED BY OPPOSING TRAFFIC.
 2. CONTRACTOR TO ADD NECESSARY SIGNAGE AS NEEDED ACCORDING TO TMUTCD.
 3. CONTRACTOR TO ENSURE THAT EQUIPMENT DOES NOT BLOCK LINE OF SIGHT FOR DRIVERS.

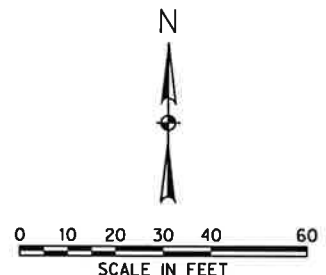

[Signature]
 Signature of Registrant
 P.E. 10/25/13
 Date
 FIRM REGISTRATION NUMBER: 312

NO.	REVISION	BY	DATE		
TOWN OF ADDISON DALLAS COUNTY, TEXAS BELT LINE ROAD UNDERGROUND ELECTRICAL TRAFFIC CONTROL PLAN - DUCT BANK PHASE 1, STEP 5					
HALFF <small>1201 NORTH BOWSER ROAD, RICHARDSON, TEXAS 75061-2275 TEL (214) 348-0200 FAX (214) 738-0096</small>					
PROJECT	DESIGN	DRAWN	DATE	FILE	SHEET
29350	HALFF	HALFF	OCT. 2013	29350TCP01-05-01	TCP-8