

DATE: 10/24/2013 TIME: 3:14:53 PM FILE: 29350 TCP 02.dgn PROJECT: 29350 OFFICE: RCH USER: oh1299

* CONTRACTOR SHALL DIRECT TRAFFIC TO ALTERNATE ACCESS POINTS AS NECESSARY.

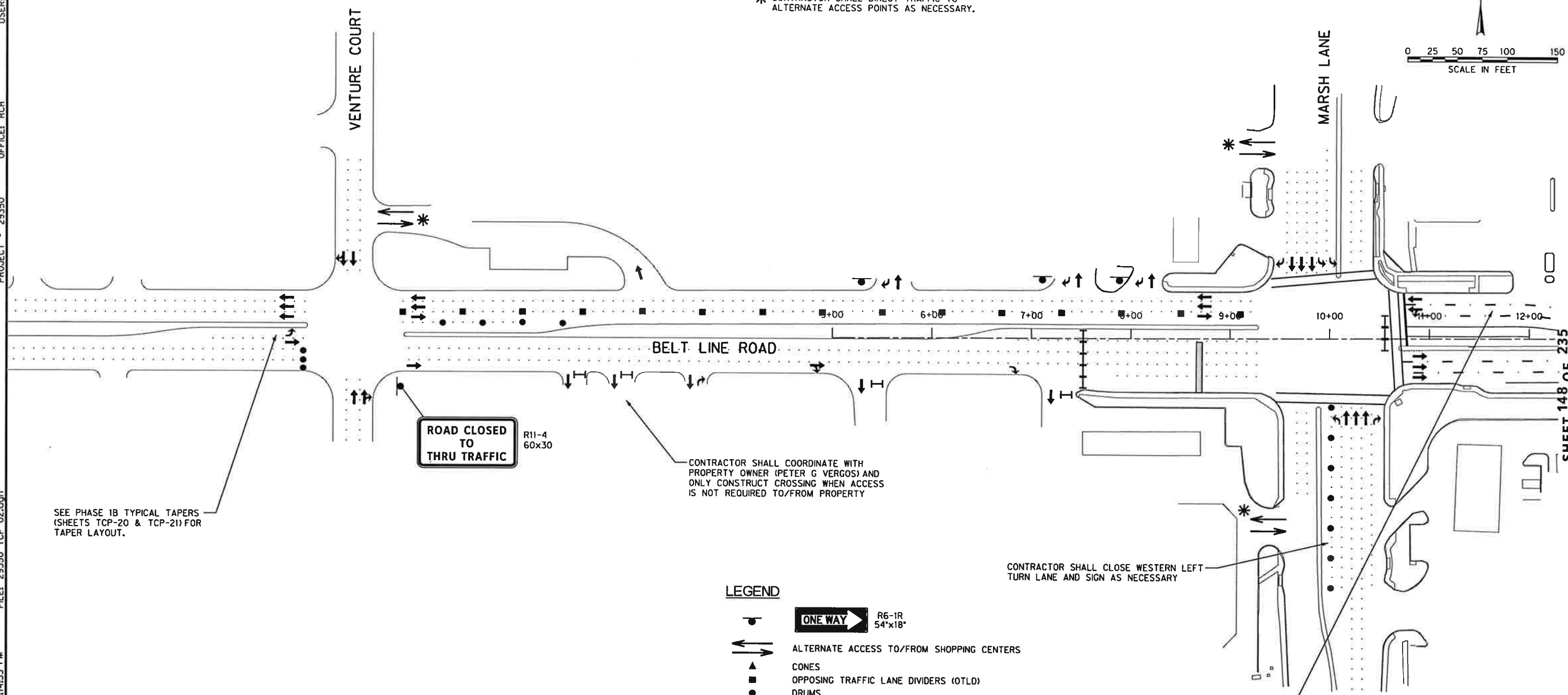
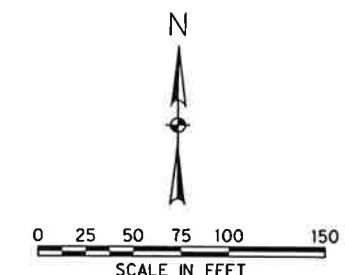

SEE PHASE 1B TYPICAL TAPERS (SHEETS TCP-20 & TCP-21) FOR TAPER LAYOUT.

ROAD CLOSED TO THRU TRAFFIC
R11-4
60x30

CONTRACTOR SHALL COORDINATE WITH PROPERTY OWNER (PETER G VERGOS) AND ONLY CONSTRUCT CROSSING WHEN ACCESS IS NOT REQUIRED TO/FROM PROPERTY

CONTRACTOR SHALL CLOSE WESTERN LEFT TURN LANE AND SIGN AS NECESSARY

SEE PHASE 1B TYPICAL TAPERS (SHEETS TCP-20 & TCP-21) FOR TAPER LAYOUT.

LEGEND

- R6-1R 54"x18"
- ALTERNATE ACCESS TO/FROM SHOPPING CENTERS
- CONES
- OPPOSING TRAFFIC LANE DIVIDERS (OTLD)
- DRUMS
- TYPE III BARRICADE
- LOW PROFILE CONCRETE BARRIER
- LANES TO BE OPEN AT ALL TIMES
- LANES TO BE CLOSED DURING OFF-PEAK HOURS ONLY
- DUCT BANK TRENCH
- DUCT BANK BORING
- NON-REMOVABLE
- REMOVABLE
- 4" WHITE BROKEN
- 4" WHITE SOLID
- PREVIOUS PAVEMENT MARKINGS
- EXISTING RAISED PAVEMENT MARKINGS

- NOTES:**
1. ALL LOW PROFILE CONCRETE BARRIERS SHALL BEGIN WITH A TYPE 2 LPCB. END LOW PROFILE CONCRETE BARRIERS WITH A TYPE 2 LPCB WHEN IT CAN BE IMPACTED BY OPPOSING TRAFFIC.
 2. CONTRACTOR TO ADD NECESSARY SIGNAGE AS NEEDED ACCORDING TO TMUTCD.
 3. CONTRACTOR TO ENSURE THAT EQUIPMENT DOES NOT BLOCK LINE OF SIGHT FOR DRIVERS.
 4. CONTRACTOR MAY WORK ON PHASE 1B, STEP 1 CONCURRENTLY WITH PHASE 1, STEPS 1.

Signature of Registrant: *M.E. Romandorsky* Date: 10/25/13

FIRM REGISTRATION NUMBER: 312					
NO.	REVISION	BY	DATE		
TOWN OF ADDISON DALLAS COUNTY, TEXAS					
BELT LINE ROAD UNDERGROUND ELECTRICAL					
TRAFFIC CONTROL PLAN PHASE 1B-STEP 1					
1201 NORTH BOWSER ROAD, RICHARDSON, TEXAS 75061-2275 TEL. (214) 346-8200 FAX (214) 739-0096					
PROJECT	DESIGN	DRAWN	DATE	FILE	SHEET
29350	HALFF	HALFF	OCT. 2013	29350 TCP 02	TCP-22

SHEET 148 OF 235