

OVERLAY CONSTRUCTION TO BE DONE DURING OFF-PEAK HOURS - CONTRACTOR TO PROVIDE DETAILED TCP FOR OVERLAY WORK

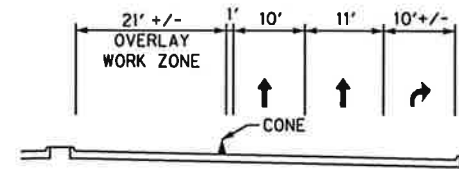

SECTION A-A
(N.T.S.)

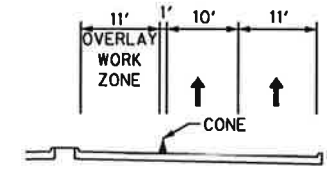

SECTION B-B
(N.T.S.)

LEGEND

- ▲ CONES
- OPPOSING TRAFFIC LANE DIVIDERS (OTLD)
- DRUMS
- ▬ TYPE III BARRICADE
- ▬ LOW PROFILE CONCRETE BARRIER
- ← LANES TO BE OPEN AT ALL TIMES
- ⇄ LANES TO BE CLOSED DURING OFF-PEAK HOURS ONLY
- ▭ DUCT BANK TRENCH
- ▭ DUCT BANK BORING
- (N) NON-REMOVABLE
- (R) REMOVABLE
- (S) 4" WHITE BROKEN
- (T) 4" WHITE SOLID
- (Y) PREVIOUS PAVEMENT MARKINGS
- (Z) EXISTING RAISED PAVEMENT MARKINGS

- NOTES:
- ALL LOW PROFILE CONCRETE BARRIERS SHALL BEGIN WITH A TYPE 2 LPCB. END LOW PROFILE CONCRETE BARRIERS WITH A TYPE 2 LPCB WHEN IT CAN BE IMPACTED BY OPPOSING TRAFFIC.
 - CONTRACTOR TO ADD NECESSARY SIGNAGE AS NEEDED ACCORDING TO TMUTCD.
 - CONTRACTOR TO ENSURE THAT EQUIPMENT DOES NOT BLOCK LINE OF SIGHT FOR DRIVERS.

N

0 10 20 30 40 60
SCALE IN FEET

Signature of Registrant: *M.E. Romanowski* Date: 10/25/13
FIRM REGISTRATION NUMBER: 312

NO.	REVISION	BY	DATE

HALFF 1201 NORTH BOWSER ROAD, RICHARDSON, TEXAS 75081-2275
TEL. (214) 348-0200 FAX (214) 738-0095

PROJECT	DESIGN	DRAWN	DATE	FILE	SHEET
29350	HALFF	HALFF	OCT. 2013	29350TCP06-01-01	TCP-37