

SECTION A-A (N.T.S.)

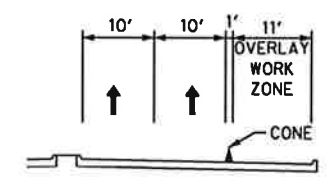

SECTION B-B (N.T.S.)

LEGEND

- ▲ CONES
- OPPOSING TRAFFIC LANE DIVIDERS (OTLD)
- DRUMS
- ▬ TYPE III BARRICADE
- ▬ LOW PROFILE CONCRETE BARRIER
- LANES TO BE OPEN AT ALL TIMES
- ⇄ LANES TO BE CLOSED DURING OFF-PEAK HOURS ONLY
- ▬ DUCT BANK TRENCH
- ▬ DUCT BANK BORING
- (N) NON-REMOVABLE
- (R) REMOVABLE
- (S) 4" WHITE BROKEN
- (T) 4" WHITE SOLID
- (Y) PREVIOUS PAVEMENT MARKINGS
- (Z) EXISTING RAISED PAVEMENT MARKINGS

- NOTES:
- ALL LOW PROFILE CONCRETE BARRIERS SHALL BEGIN WITH A TYPE 2 LPCB. END LOW PROFILE CONCRETE BARRIERS WITH A TYPE 2 LPCB WHEN IT CAN BE IMPACTED BY OPPOSING TRAFFIC.
  - CONTRACTOR TO ADD NECESSARY SIGNAGE AS NEEDED ACCORDING TO TMUTCD.
  - CONTRACTOR TO ENSURE THAT EQUIPMENT DOES NOT BLOCK LINE OF SIGHT FOR DRIVERS.

Signature of Registrant: *M.E. Romanowski* Date: 10/25/13  
 FIRM REGISTRATION NUMBER: 312

NO.	REVISION	BY	DATE
<b>HALFF</b> 1201 NORTH BOWSER ROAD, RICHARDSON, TEXAS 75061-2275 TEL (214) 349-8200 FAX (214) 738-0995			
PROJECT	DESIGN	DRAWN	DATE
29350	HALFF	HALFF	OCT. 2013
FILE	SHEET		
29350TCP06-03-01	TCP-41		