

USER: ah2207

OFFICE: RCH

PROJECT #: 29350

FILE: 29350 LP 201.dgn

TIME: 12:42:19 PM

DATE: 10/25/2013

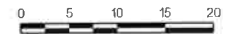

MATERIALS LEGEND	
SYMBOL	DESCRIPTION
	CONTROL JOINT
	EXPANSION JOINT
PA	PLANTING AREA (BERMUDA SOD)
	DECORATIVE CONCRETE FINISH: ACID ETCH W.R. GRACE #25 BEIGE
	DECORATIVE PAVERS TYPE: ACME BRICK - CLAY BRICK PAVERS COLOR: RED TO MATCH MEDIAN FINISH: STANDARD CONTACT: BRYAN HACKETT ACME BRICK 214-637-2720
	DETECTABLE WARNING PANEL SIZE: 24" X 36" MATERIAL: BRICK RED CONTACT: ARMORCAST 818-982-3600

- GENERAL NOTES:
1. CONTRACTOR IS RESPONSIBLE FOR LOCATING ALL ABOVE GROUND AND UNDERGROUND UTILITIES. \*EXTREME CARE AND CAUTION SHOULD BE EXERCISED WHEN EXCAVATING. CONTRACTOR SHALL BE RESPONSIBLE FOR ANY DAMAGE AND SUBSEQUENT REPAIR TO ANY EXISTING UTILITIES.
  2. REF. SHEETS P-1 TO P-13 FOR WALK LAYOUT.
  3. REF. SHEETS LP 301 TO LP 305 FOR DIMENSION CONTROL OF SITE MATERIALS.
  4. ALL AREAS DISTURBED DURING CONSTRUCTION SHALL RECEIVE BERMUDA SOD UNLESS OTHERWISE NOTED.
  5. CONTRACTOR SHALL MATCH AND MEET ADJOINING SIDEWALK GRADE ELEVATIONS AND WIDTH. REF. SHEET LP 401 DETAIL 07



10/25/13

FIRM REGISTRATION NUMBER: 312

NO.	REVISION	BY	DATE
<b>TOWN OF ADDISON</b> DALLAS COUNTY, TEXAS			
<b>BELT LINE ROAD</b> UNDERGROUND ELECTRICAL			
<b>SITE MATERIALS ENLARGEMENT</b> MARSH LN			
<b>HALFF</b>		1201 NORTH BOWSER ROAD, RICHARDSON, TEXAS 75081-2275 TEL (214) 346-6200 FAX (214) 739-0095	
PROJECT	DESIGN	DRAWN	DATE
29350	HALFF	HALFF	OCT. 2013
FILE	SHEET		
29350 LP 201	LP 201		

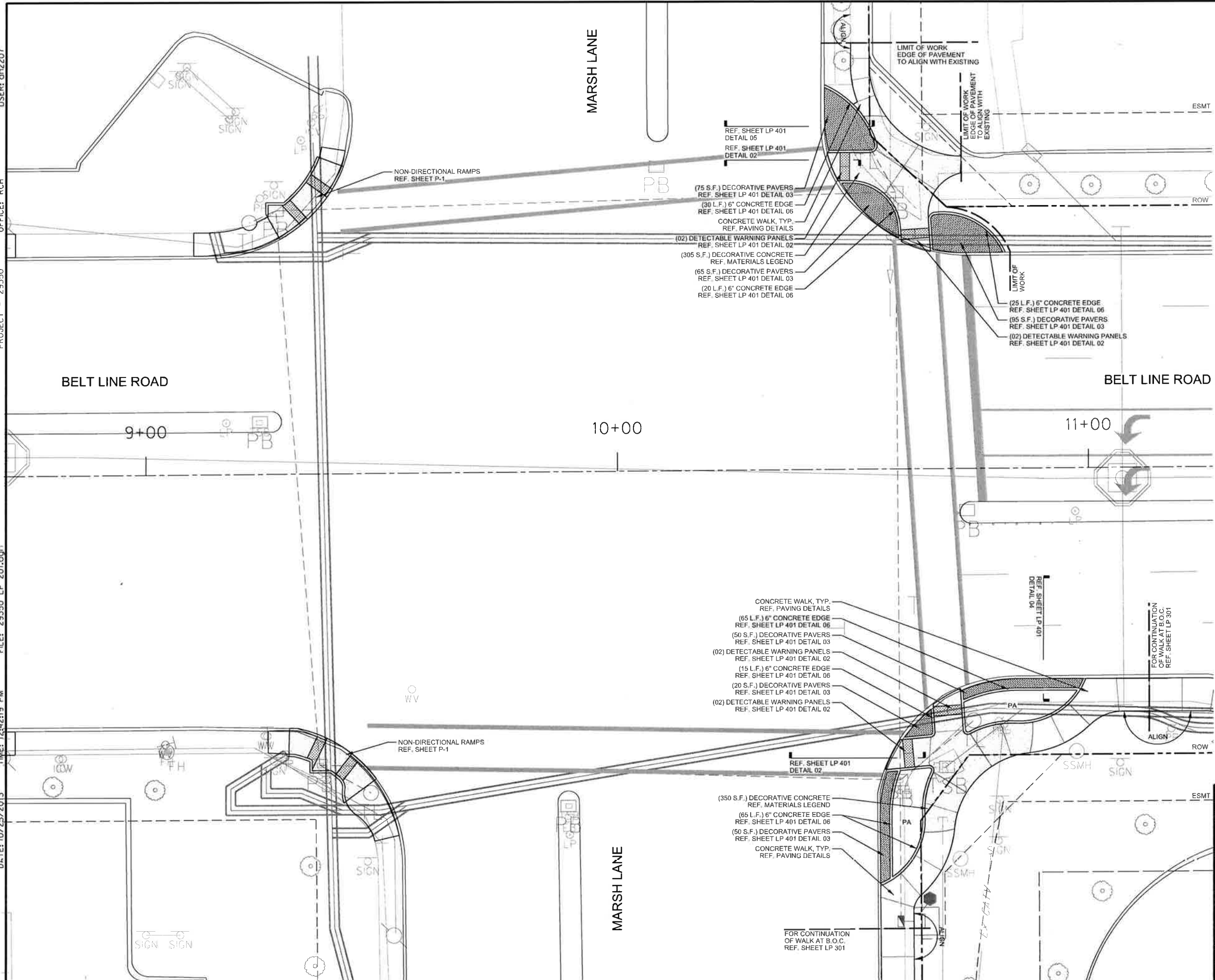

SHEET 177 OF 235