

USER: ah2207

OFFICE: RCH

PROJECT: 29350

FILE: 29350 LP 301.dgn

TIME: 12:46:29 PM

DATE: 10/25/2013

0 5 10 15 20



MATERIALS LEGEND	
SYMBOL	DESCRIPTION
	CONTROL JOINT
	EXPANSION JOINT
PA	PLANTING AREA (BERMUDA SOD)
	DECORATIVE CONCRETE REF. SHEETS LP 201 TO LP 205
	DECORATIVE PAVERS REF. SHEETS LP 201 TO LP 205
	DETECTABLE WARNING PANEL REF. SHEETS LP 201 TO LP 205

GENERAL NOTES:

- CONTRACTOR IS RESPONSIBLE FOR LOCATING ALL ABOVE GROUND AND UNDERGROUND UTILITIES. EXTREME CARE AND CAUTION SHOULD BE EXERCISED WHEN EXCAVATING. CONTRACTOR SHALL BE RESPONSIBLE FOR ANY DAMAGE AND SUBSEQUENT REPAIR TO ANY EXISTING UTILITIES.
- ALL DIMENSIONS ARE FROM F.O.C. UNLESS OTHERWISE NOTED.
- REF. SHEETS P-1 TO P-13 FOR WALK LAYOUT.
- REF. SHEETS LP 201 TO LP 205 FOR SITE MATERIALS.
- ALL AREAS DISTURBED DURING CONSTRUCTION SHALL RECEIVE BERMUDA SOD UNLESS OTHERWISE NOTED.
- CONTRACTOR SHALL MATCH AND MEET ADJOINING SIDEWALK GRADE ELEVATIONS AND WIDTH. REF. SHEET LP 401 DETAIL 07

SHEET 182 OF 235

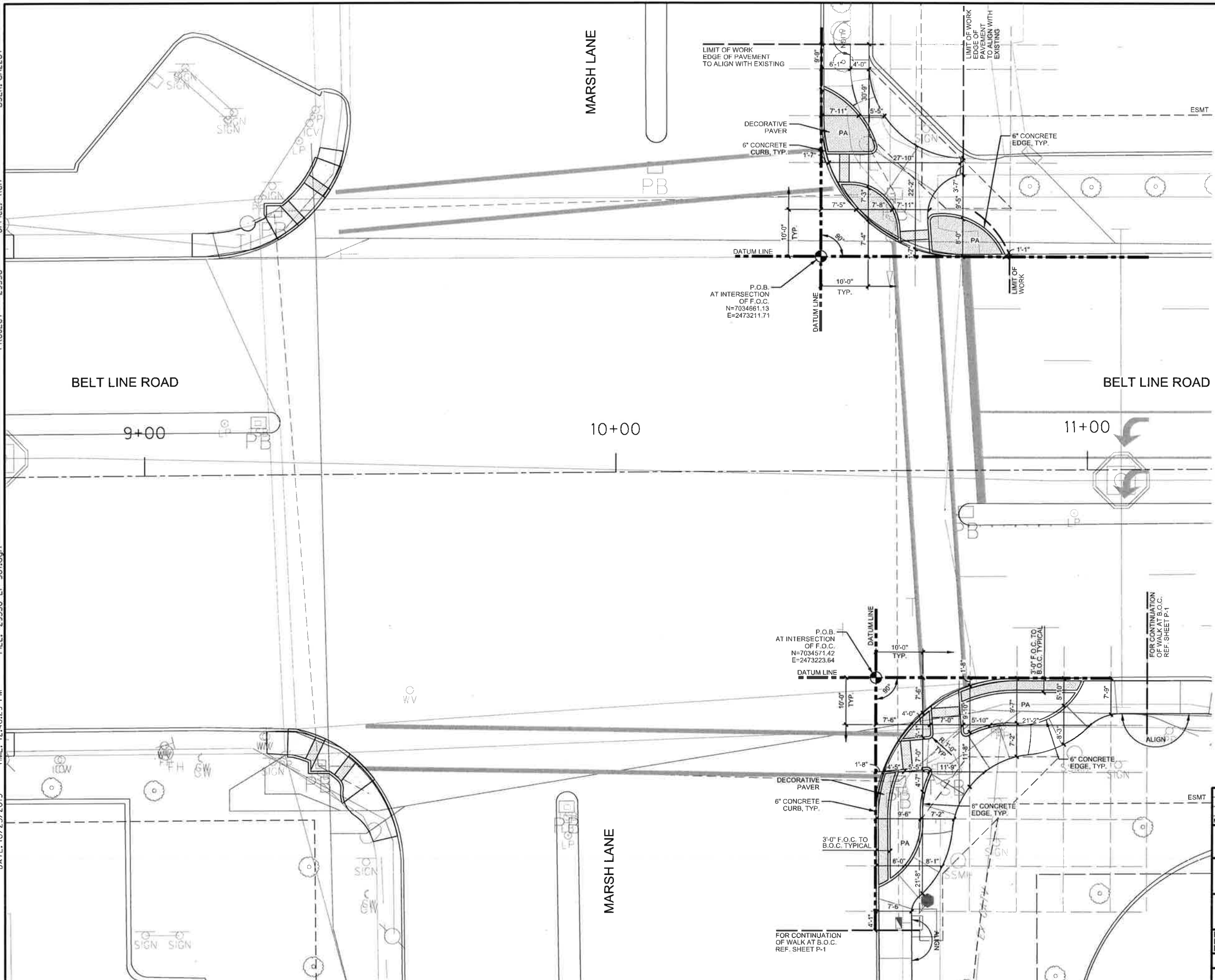

FIRM REGISTRATION NUMBER: 312

NO.	REVISION	BY	DATE
TOWN OF ADDISON DALLAS COUNTY, TEXAS BELT LINE ROAD UNDERGROUND ELECTRICAL DIMENSION CONTROL ENLARGEMENT MARSH LN			
		1201 NORTH BOWSER ROAD, RICHARDSON, TEXAS 75081-2275 TEL (214) 346-6200 FAX (214) 738-0095	
PROJECT	DESIGN	DRAWN	DATE
29350	HALFF	HALFF	OCT. 2013
FILE	SHEET		
29350 LP 301	LP 301		