

DATE: 10/24/2013 TIME: 4:35:35 PM FILE: 29350 REMV 04.dgn PROJECT: 29350 OFFICE: RCH USER: ah1299

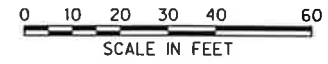

**LEGEND**

- CONCRETE MEDIAN/ISLAND TO BE REMOVED & REPLACED (SEE PAVING PLANS - SHEETS P-1 TO P-13)
- CONCRETE SIDEWALK TO BE REMOVED
- CONCRETE PAVEMENT TO BE REMOVED FOR FULL DEPTH REPAIR. (SEE PAVING PLANS - SHEETS P-1 TO P-13)
- CONCRETE MEDIAN / ISLAND TO BE REMOVED FOR FULL DEPTH REPAIR OR MEDIAN ISLAND ADJUSTMENT (SEE PAVING PLANS - SHEETS P-1 TO P-13)
- CONCRETE PAVEMENT TO BE REMOVED
- TREE PROTECTION (SEE REMOVAL DETAIL SHEET - SHEET DT-RD)
- TREE REMOVAL (SEE REMOVAL DETAIL SHEET - SHEET DT-RD)

**NOTES:**

1. ABANDON ALL OBSOLETE VALVES AND ADJUST ALL WATER AND SANITARY FACILITIES TO GRADE.
2. SIDEWALK REMOVAL TO INCLUDE RAMP REMOVAL AND CURB & GUTTER REPLACEMENT.
3. MEDIAN REMOVAL AND REPLACEMENT TO INCLUDE ANY ASSOCIATED CURB & GUTTER REMOVAL AND REPLACEMENT. CONTRACTOR SHALL REPLACE MEDIAN TO EXISTING CONDITION AT NO ADDITIONAL COST.
4. PAVEMENT REMOVAL (FOR OTHER THAN FULL DEPTH REPAIR) TO INCLUDE ANY ASSOCIATED CURB & GUTTER REMOVAL.
5. CURB REMOVAL AT PROPOSED RAMPS IS SUBSIDIARY AND NOT AN ADDITIONAL PAY ITEM.
6. CURB AND PAVEMENT REMOVAL ASSOCIATED WITH FULL DEPTH REPAIR OF PAVEMENT IS SUBSIDIARY AND NOT ADDITIONAL BID ITEMS. REMOVAL BEYOND LIMITS SHOWN IS ALSO SUBSIDIARY.
7. CURB & GUTTER REMOVAL ASSOCIATED WITH PROPOSED INLETS IS SUBSIDIARY AND NOT AN ADDITIONAL PAY ITEM.
8. PAVEMENT REPAIR, CURB REMOVAL AND REPLACEMENT AND MEDIAN REMOVAL ASSOCIATED WITH MEDIAN NOSE ADJUSTMENTS ARE SUBSIDIARY AND NOT ADDITIONAL PAY ITEMS.
9. SEE SHEET LP 001 FOR TREE SUMMARY.
10. CONTRACTOR SHALL MAINTAIN EXISTING IRRIGATION IN WORKING ORDER.

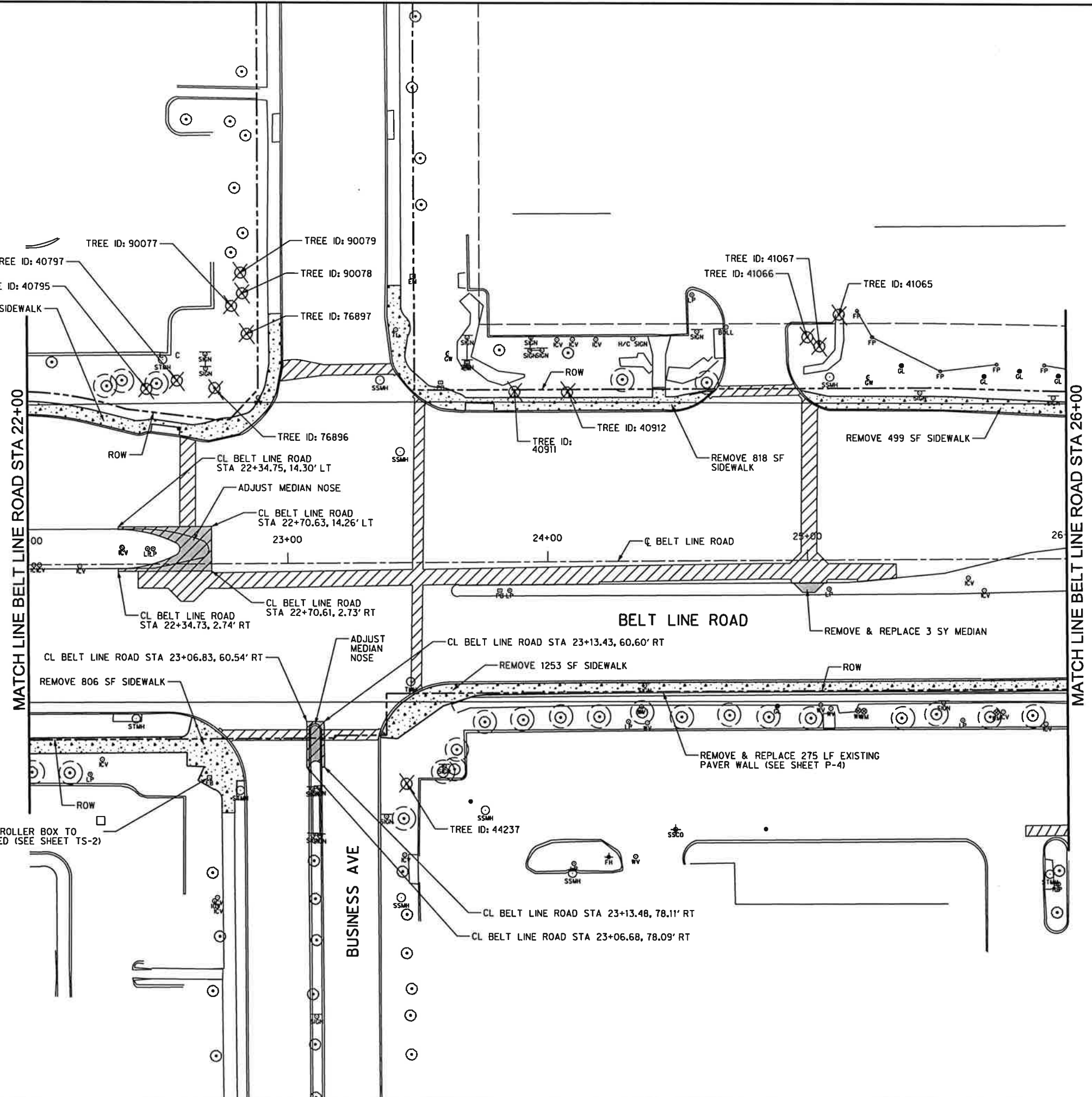

SHEET 25 OF 235

Signature of Registrant: *M.E. Romankowski* Date: 10/23/13  
 FIRM REGISTRATION NUMBER: 312

NO.	REVISION	BY	DATE
<b>TOWN OF ADDISON</b> DALLAS COUNTY, TEXAS			
<b>BELT LINE ROAD</b> UNDERGROUND ELECTRICAL			
<b>REMOVAL PLAN</b> BELT LINE RD STA 22+00 TO STA 26+00			
<b>HALFF</b> 1201 NORTH BOWSER ROAD, RICHARDSON, TEXAS 75061-2275 TEL. (214) 348-8200 FAX (214) 738-0095			
PROJECT	DESIGN	DRAWN	DATE
29350	HALFF	HALFF	OCT. 2013
FILE	SHEET		
29350 REMV 04	RM-4		