





USER: ah1854  
OFFICE: RCH  
PROJECT #: 29350  
FILE: 29350 PAV 01.dgn  
DATE: 10/25/2013  
TIME: 8:16:59 AM

**LEGEND**

-  FULL DEPTH REPAIR
-  3/4" NOVACHIP OVERLAY
-  PROPOSED SIDEWALK
-  MILLING LIMITS

**NOTES:**

1. FULL DEPTH REPAIR INCLUDES REMOVAL & REPLACEMENT OF PAVEMENT AND CURB & GUTTER.
2. FULL DEPTH REPAIR AND CURB & GUTTER ASSOCIATED WITH MEDIAN NOSE ADJUSTMENTS IS SUBSIDIARY & NOT ADDITIONAL PAY ITEMS.
3. REFER TO TRAFFIC CONTROL PLAN FOR CONSTRUCTION SEQUENCING AND INFORMATION.
4. SEE SHEET DT-P1 FOR CURB RAMPS AT DRIVEWAYS.

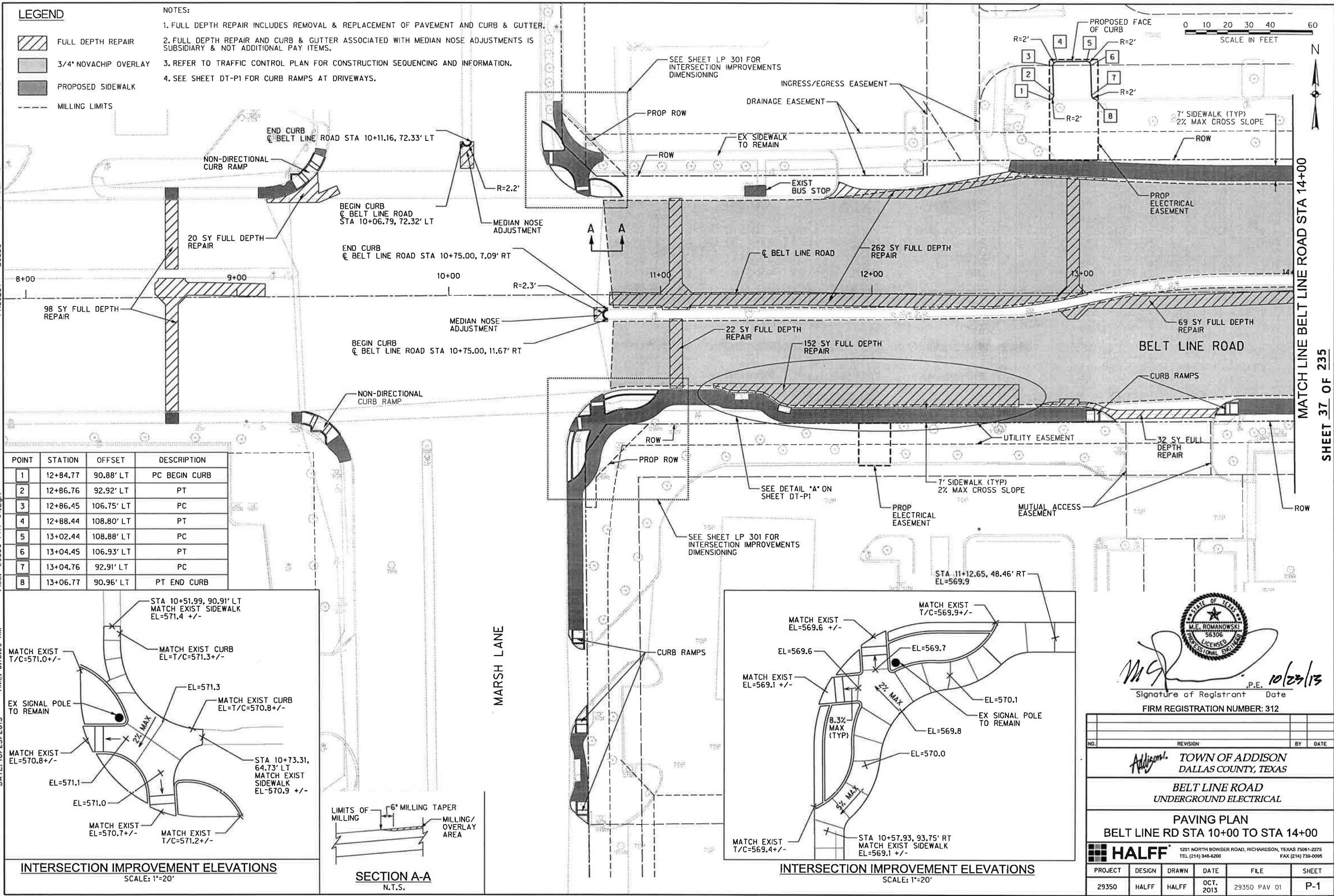
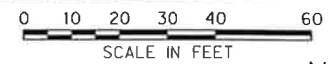

POINT	STATION	OFFSET	DESCRIPTION
1	12+84.77	90.88' LT	PC BEGIN CURB
2	12+86.76	92.92' LT	PT
3	12+86.45	106.75' LT	PC
4	12+88.44	108.80' LT	PT
5	13+02.44	108.88' LT	PC
6	13+04.45	106.93' LT	PT
7	13+04.76	92.91' LT	PC
8	13+06.77	90.96' LT	PT END CURB

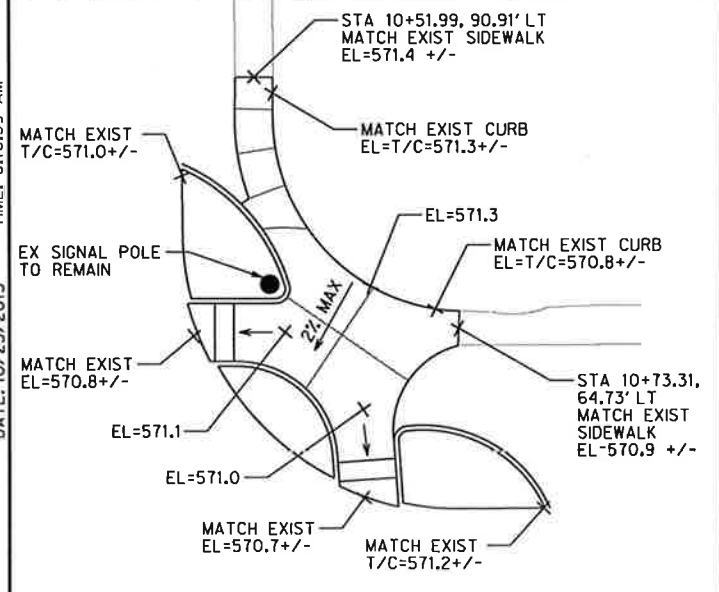

**INTERSECTION IMPROVEMENT ELEVATIONS**  
SCALE: 1"=20'

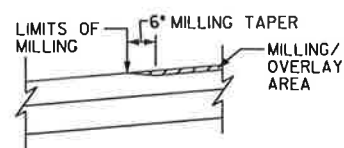

**SECTION A-A**  
N.T.S.

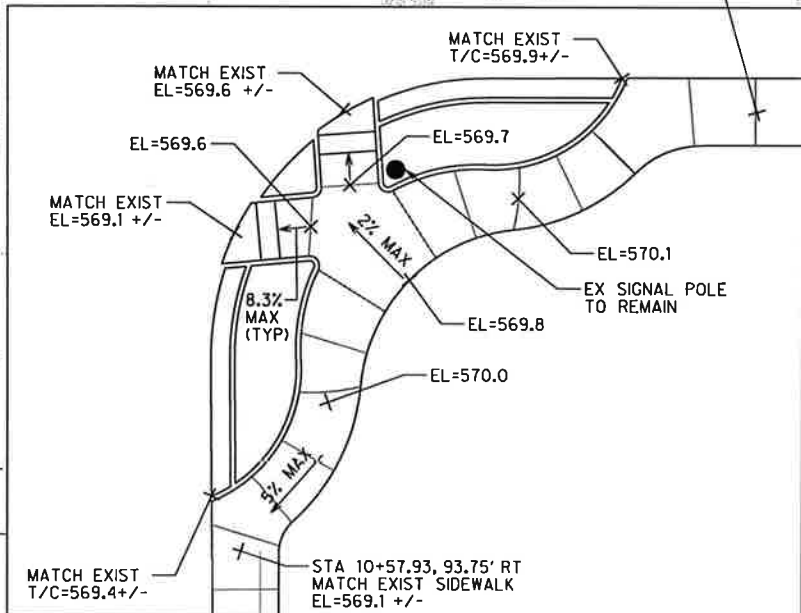

**INTERSECTION IMPROVEMENT ELEVATIONS**  
SCALE: 1"=20'



*MGR*  
Signature of Registrant  
Date: 10/23/13  
FIRM REGISTRATION NUMBER: 312

NO.	REVISION	BY	DATE

**TOWN OF ADDISON**  
DALLAS COUNTY, TEXAS

**BELT LINE ROAD**  
UNDERGROUND ELECTRICAL

**PAVING PLAN**  
BELT LINE RD STA 10+00 TO STA 14+00

**HALFF** 1201 NORTH BOWSER ROAD, RICHARDSON, TEXAS 75081-2275  
TEL (214) 346-6200 FAX (214) 739-0095

PROJECT	DESIGN	DRAWN	DATE	FILE	SHEET
29350	HALFF	HALFF	OCT. 2013	29350 PAV 01	P-1