

USER: ah1854

OFFICE: RCH

PROJECT # 29350

FILE: 29350 PAV 08.dgn

TIME: 8:23:52 AM

DATE: 10/25/2013

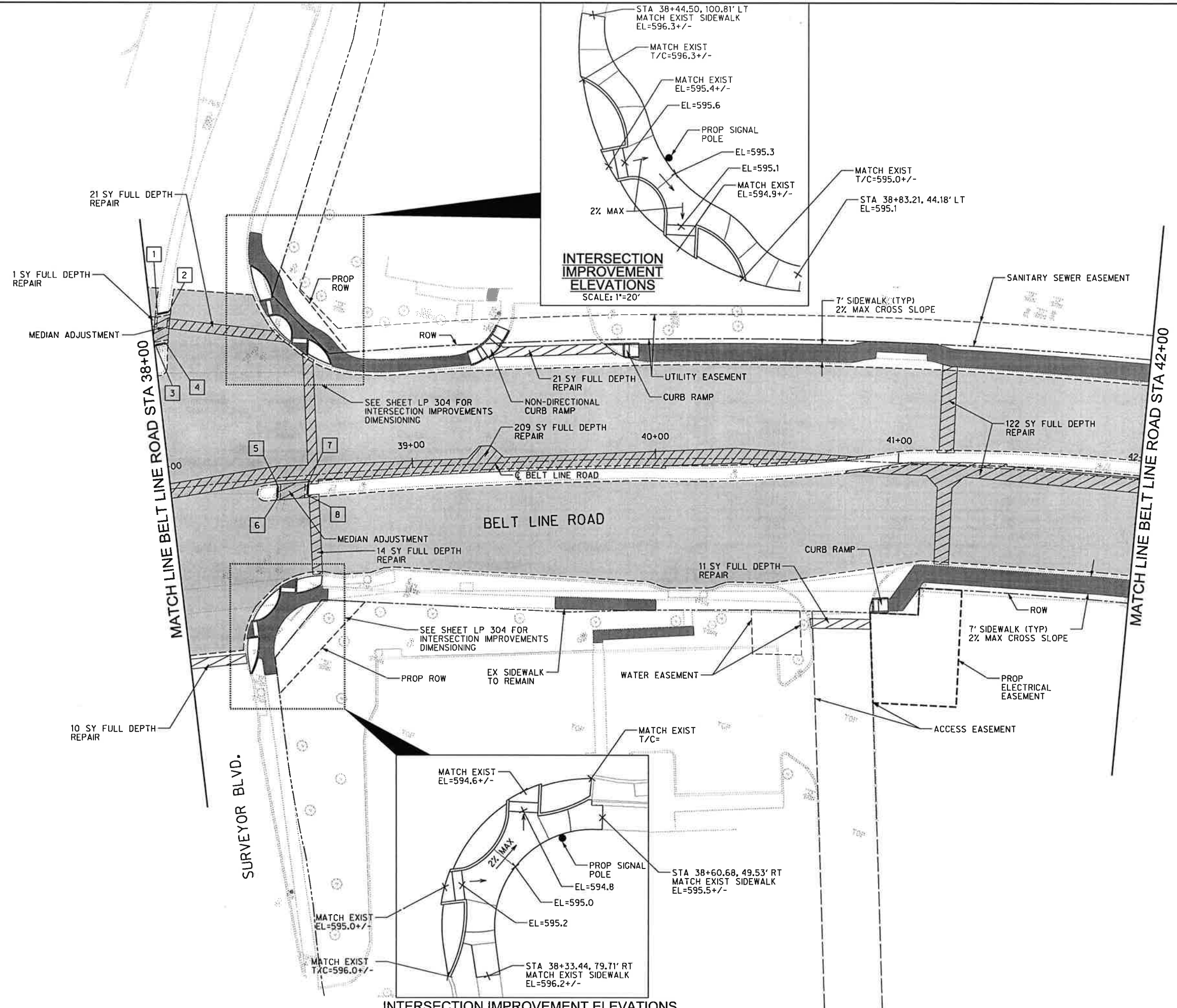
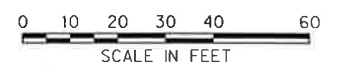

**LEGEND**

- FULL DEPTH REPAIR
- 3/4" NOVACHIP OVERLAY
- PROPOSED SIDEWALK
- MILLING LIMITS

POINT	STATION	OFFSET	DESCRIPTION
1	38+02.79	71.75' LT	PI
2	38+07.06	72.11' LT	PI
3	38+00.51	59.52' LT	PI
4	38+04.66	59.87' LT	PI
5	38+44.15	3.61' RT	PI
6	38+43.54	7.94' RT	PI
7	38+56.28	3.63' RT	PI
8	38+55.69	8.03' RT	PI

Signature of Registrant: *W.E. Romanowski* Date: 10/23/13  
 FIRM REGISTRATION NUMBER: 312

NO.	REVISION	BY	DATE
<b>TOWN OF ADDISON</b> DALLAS COUNTY, TEXAS <b>BELT LINE ROAD</b> UNDERGROUND ELECTRICAL <b>PAVING PLAN</b> BELT LINE RD STA 38+00 TO STA 42+00			
<b>HALFF</b> <small>1201 NORTH BOWSER ROAD, RICHARDSON, TEXAS 75081-2275          TEL. (214) 346-6200 FAX (214) 739-0095</small>			
PROJECT	DESIGN	DRAWN	DATE
29350	HALFF	HALFF	OCT. 2013
FILE	SHEET		
29350 PAV 08	P-8		