

USER: ah1299

OFFICE: RCH

PROJECT: 29350

FILE: 29350 SNPM 01.dgn

TIME: 3:12:39 PM

DATE: 10/24/2013

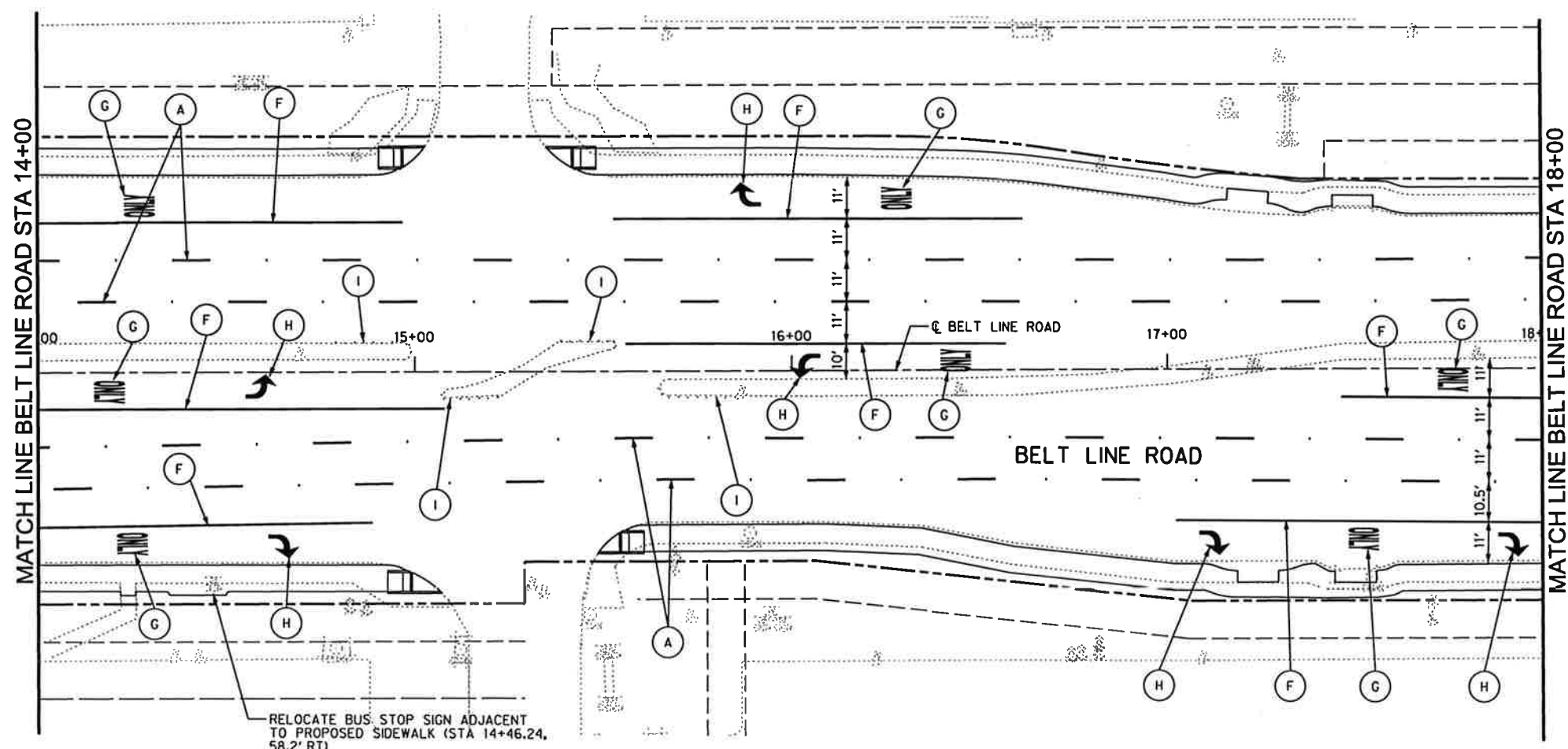
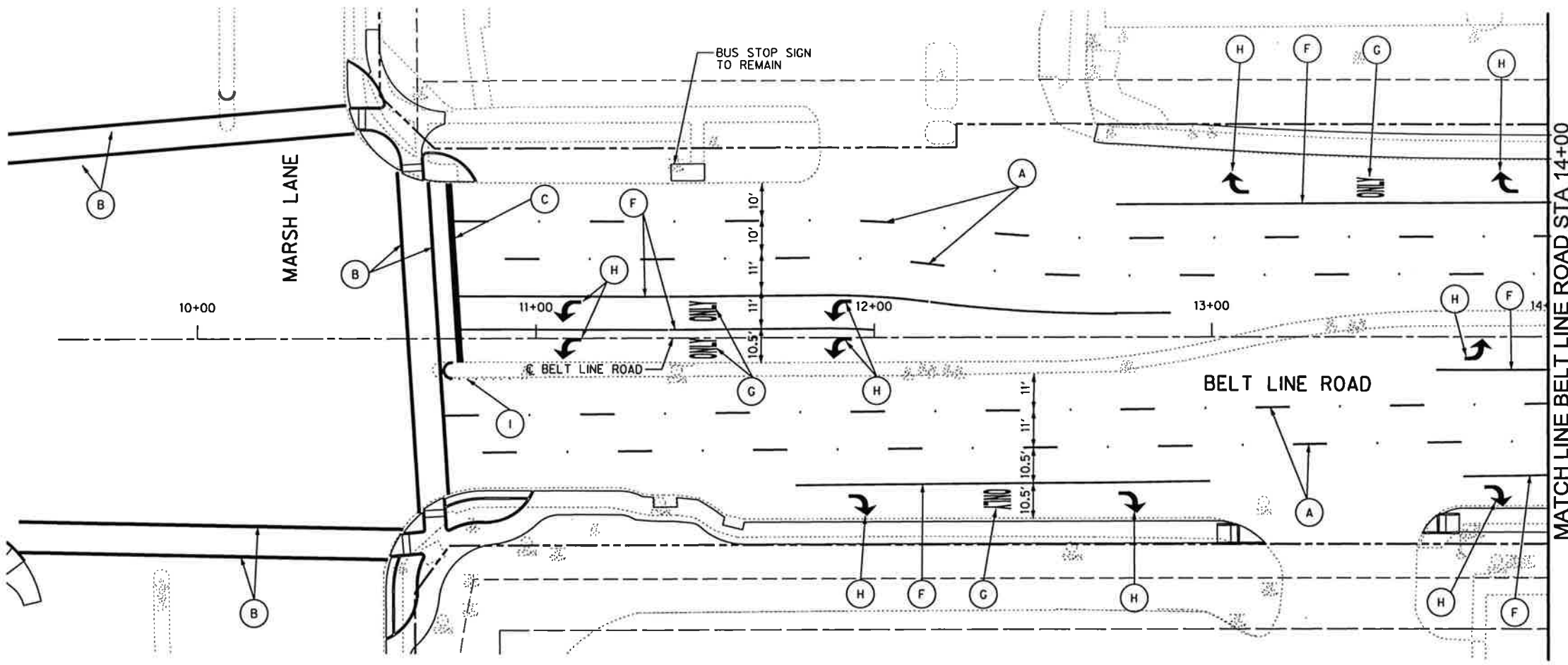

LEGEND

- (A) 4" WHITE BROKEN STRIPE 10' IN LENGTH WITH 30' GAPS SUPPLEMENTED BY TY-II-CR BUTTONS CENTERED ON GAP. CLEAR SIDE OF BUTTON SHALL FACE TRAFFIC FLOW. (SEE DETAIL 'A' ON SHEET DT-PM)
- (B) 12" WHITE SOLID REFLECTORIZED PAVEMENT MARKING
- (C) 24" WHITE SOLID REFLECTORIZED PAVEMENT MARKING
- (D) 4" WHITE DOT REFLECTORIZED PAVEMENT MARKING ('PUPPY TRACKS') (SEE DETAIL 'F' ON SHEET DT-PM)
- (E) DOUBLE 4" YELLOW SOLID REFLECTORIZED PAVEMENT MARKING SUPPLEMENTED, BY TY-II-A-A BUTTONS. (SEE DETAIL 'B' ON SHEET DT-PM)
- (F) 8" WHITE SOLID REFLECTORIZED PAVEMENT MARKING SUPPLEMENTED BY TY I-C BUTTONS (SEE DETAIL 'C' ON SHEET DT-PM)
- (G) WHITE REFLECTORIZED PAVEMENT MARKING WORD
- (H) WHITE REFLECTORIZED PAVEMENT MARKING ARROW
- (I) 4" ROUND NON-REFLECTIVE YELLOW MARKER AND YELLOW R.P.M. TYPE II-A-A (SEE DETAIL 'C' ON SHEET DT-PM)
- (J) WHITE REFLECTORIZED YIELD LINE (SEE DETAIL 'D' ON SHEET DT-PM)

NOTES:
ALL SIGNING AND STRIPING SHALL COMPLY WITH THE LATEST VERSION OF TMUTCD.

EXISTING SIGNAGE SHALL BE REUSED AND MOUNTED IN SAME LOCATION AFTER SIDEWALK DEMO AND RECONSTRUCTION. REFER TO BC(5)-07 OPTION 3 FOR SIGN MOUNT.



MFR
Signature of Registrant Date 10/25/13
P.E.
FIRM REGISTRATION NUMBER: 312

NO.	REVISION	BY	DATE
TOWN OF ADDISON DALLAS COUNTY, TEXAS BELT LINE ROAD UNDERGROUND ELECTRICAL STRIPING & SIGNAGE LAYOUT BELT LINE RD STA 10+00 TO STA 18+00			
HALFF <small>1201 NORTH BOWSER ROAD, RICHARDSON, TEXAS 75061-2275 TEL (214) 348-8200 FAX (214) 738-0085</small>			
PROJECT	DESIGN	DRAWN	DATE
29350	HALFF	HALFF	OCT. 2013
FILE	SHEET		
29350 SNPM 01	PM-1		

SHEET 53 OF 235