

NOTE: REINFORCEMENT SHOWN IS ADDITIONAL FOR SPECIAL CONDITION, FOR REMAINDER OF REINFORCEMENT SEE SECTIONS.

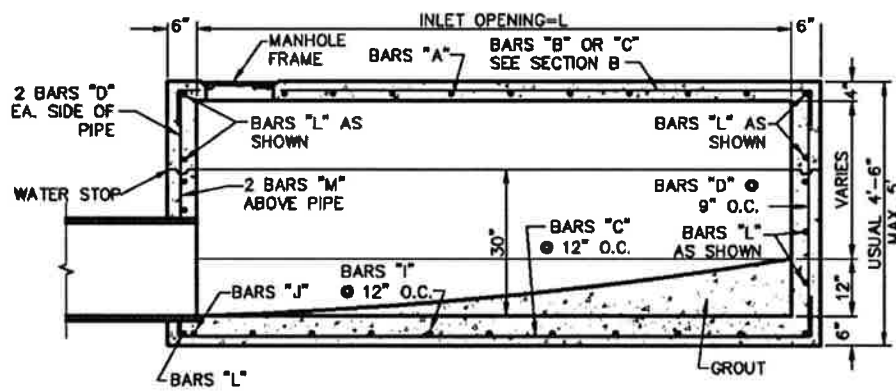

STANDARD & RECESSED CURB INLET 4, 6, 8 & 10 FOOT INLETS  
N.T.S.

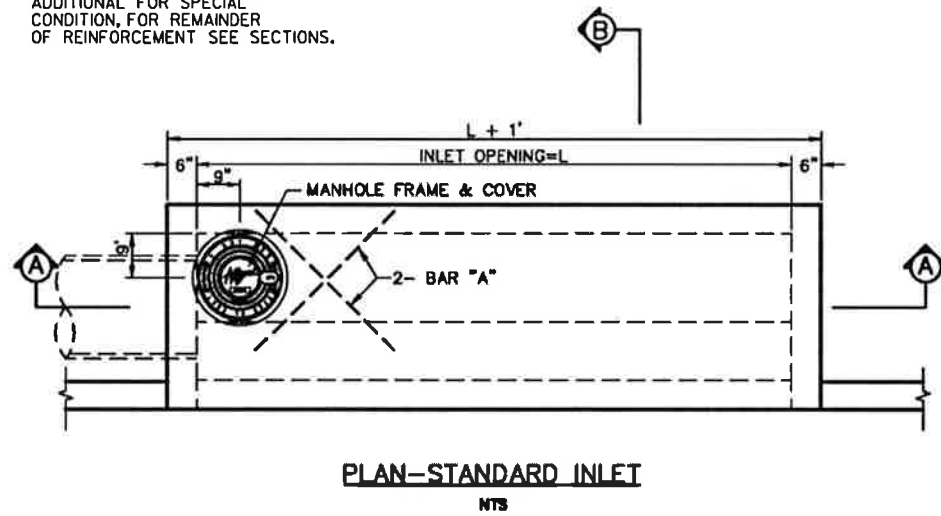
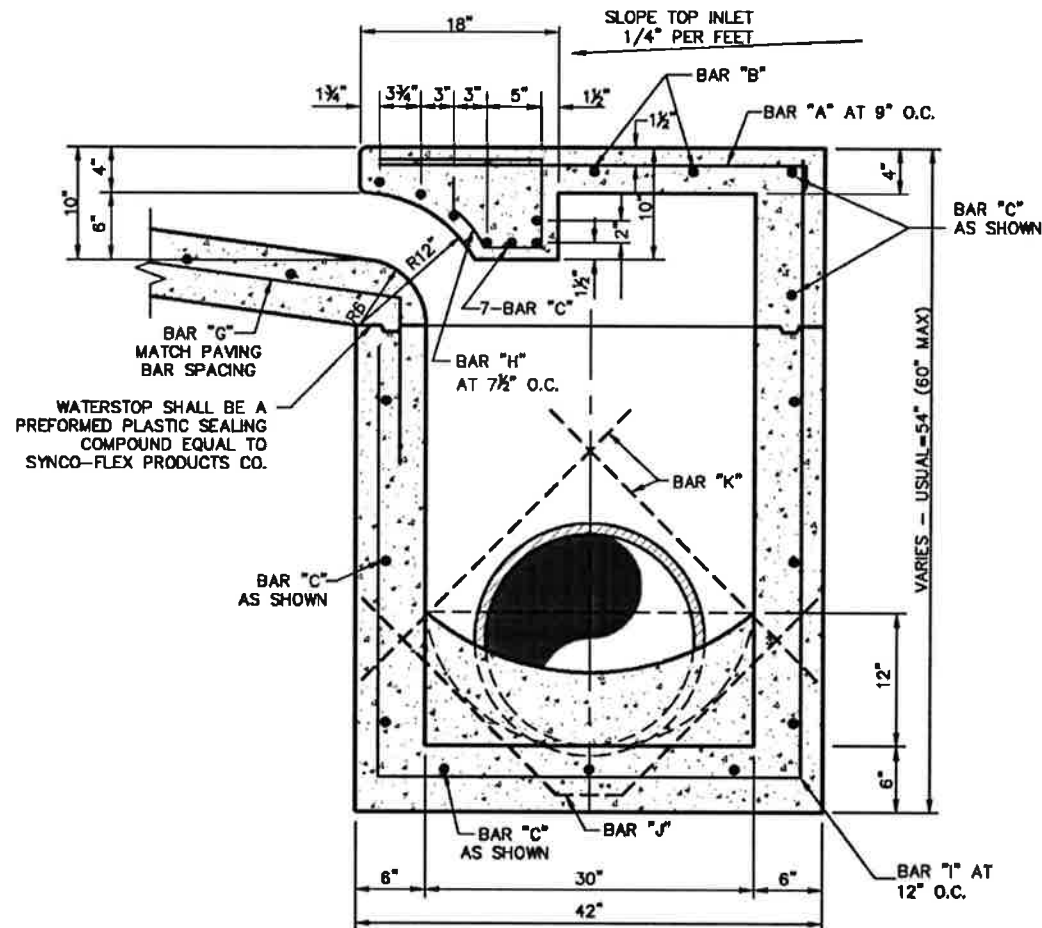

TYPICAL SECTION "B"  
STANDARD & RECESSED CURB INLETS  
(4, 6, 8 & 10 FOOT INLETS)  
N.T.S.

REINFORCING STEEL SCHEDULE						
DIMENSIONS SHOWN ARE FOR MAXIMUM SIZE INLET						
INLET LENGTH	BAR TYPE	BAR DIA. (1/8")	NO REQ'D	BAR DIMENSIONS		
				A	B	C
4'	A	3	6	3'-2"	0'-3"	-
	B	3	2	2'-10"	-	-
	C	4	18	4'-8"	0'-6"	-
	D	4	9	4'-8"	-	-
	G	3	4	2'-0"	1'-3"	-
	H	3	7	•	•	•
	I	4	3	3'-2"	3'-2"	4'-8"
	J	5	1	•	•	•
	K	5	2	3'-2"	0'-6"	-
	L	4	11	3'-2"	0'-6"	-
	M	4	2	3'-0"	-	-
6'	A	3	9	3'-2"	0'-3"	-
	B	3	2	4'-10"	-	-
	C	4	18	6'-8"	0'-6"	-
	D	4	9	4'-8"	-	-
	G	3	6	2'-0"	1'-3"	-
	H	3	11	•	•	•
	I	4	5	3'-2"	3'-2"	4'-8"
	J	5	1	•	•	•
	K	5	2	3'-2"	0'-6"	-
	L	4	11	3'-2"	0'-6"	-
	M	4	2	3'-0"	-	-
8'	A	3	12	3'-2"	0'-3"	-
	B	3	2	6'-10"	-	-
	C	4	18	8'-8"	0'-6"	-
	D	4	9	4'-8"	-	-
	G	3	7	2'-0"	1'-3"	-
	H	3	14	•	•	•
	I	4	7	3'-2"	3'-2"	4'-8"
	J	5	1	•	•	•
	K	5	2	3'-2"	0'-6"	-
	L	4	11	3'-2"	0'-6"	-
	M	4	2	3'-0"	-	-
10'	A	3	15	3'-2"	0'-3"	-
	B	3	2	8'-10"	-	-
	C	4	18	10'-8"	0'-6"	-
	D	4	9	4'-8"	-	-
	G	3	9	2'-0"	1'-3"	-
	H	3	17	•	•	•
	I	4	9	3'-2"	3'-2"	4'-8"
	J	5	1	•	•	•
	K	5	2	3'-2"	0'-6"	-
	L	4	11	3'-2"	0'-6"	-
	M	4	2	3'-0"	-	-

\* SEE DIAGRAM FOR DIMENSIONS  
\*\* FIELD CUT AS REQUIRED TO ACCOMMODATE DRAIN PIPE

REINFORCING STEEL SCHEDULE  
4, 6, 8 & 10 FOOT INLETS  
N.T.S.



*Marcus Champraser* P.E. 10/25/2013  
Signature of Registrant Date

FIRM REGISTRATION NUMBER: 312

NO.	REVISION	BY	DATE
<p><i>Addison</i> TOWN OF ADDISON DALLAS COUNTY, TEXAS</p> <p>BELT LINE ROAD UNDERGROUND ELECTRICAL</p> <p><b>STORM DRAIN DETAILS</b></p>			
<p><b>HALFF</b> 1201 NORTH BOWSER ROAD, RICHARDSON, TEXAS 75061-2275 TEL (214) 346-8200 FAX (214) 738-0065</p>			
PROJECT	DESIGN	DRAWN	DATE
29350	HALFF	HALFF	OCT. 2013
FILE	SHEET		
29350 STMD 05	DT-SD3		