

USER: 012424  
 PROJECT # 29350 OFFICE: RCH  
 FILE: 29350\_SGNL\_05.dgn  
 DATE: 3/24/2014 TIME: 9:58:37 AM

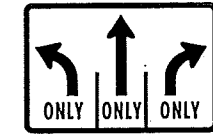

R3-8b  
36" X 24"

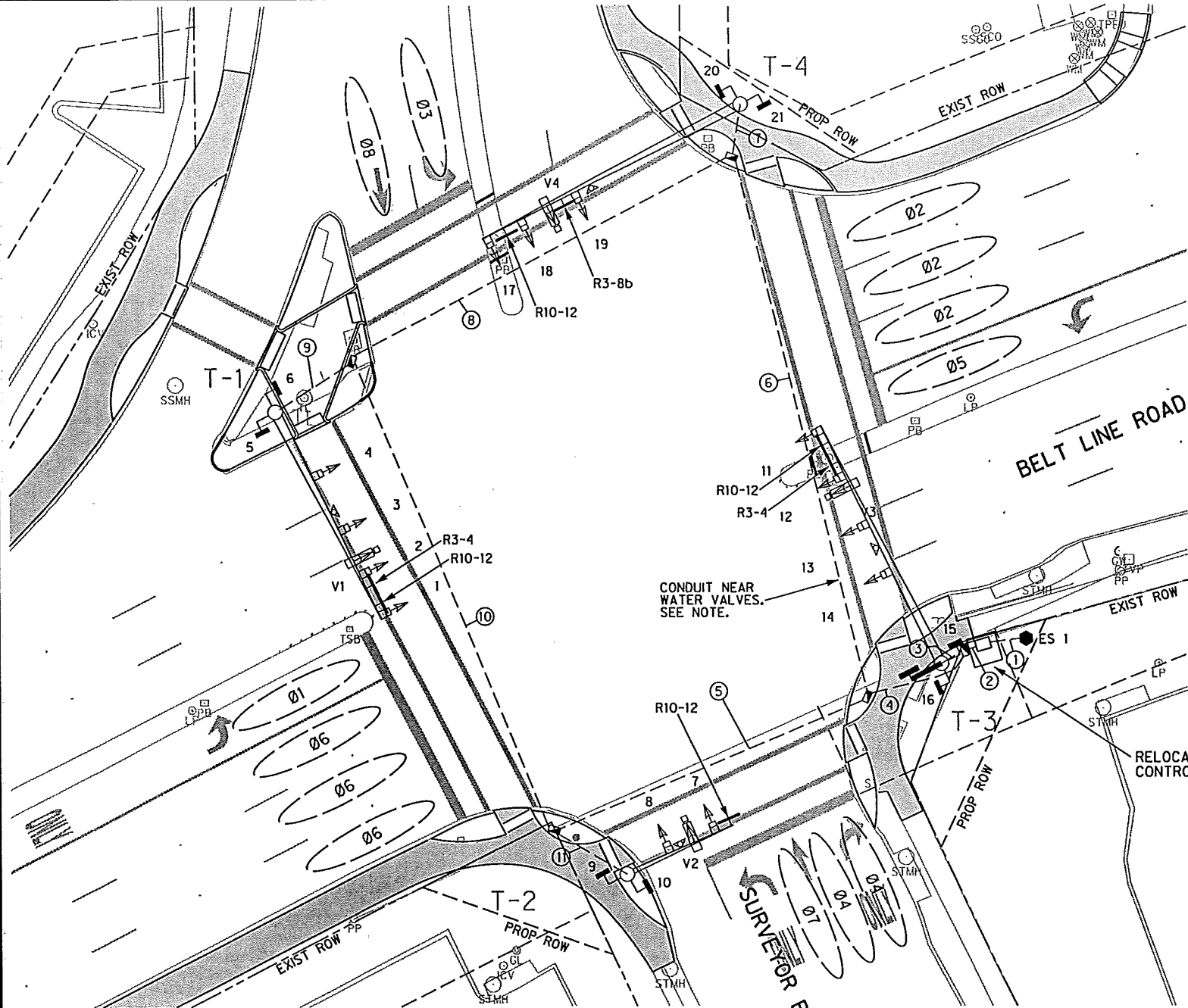

R3-4  
24" X 24"

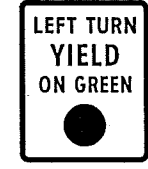

R10-12  
24" X 30"

LEGEND OF SYMBOLS	
	VIDEO DETECTION ZONES
	SIGNAL POLE/MAST ARM SET UP
	SIGNAL HEAD NUMBERS
	CONTROLLER CABINET
	GROUND BOX TYPE D (LG)
	GROUND BOX TYPE E (SM)
	LUMINAIRE
	PHASE NUMBERS
	POLE NUMBERS
	CONDUIT RUN NUMBERS
	RIGHT OF WAY LINES
	VIVDS CAMERA
	ELECTRICAL SERVICE
	OPTICOM
	MAST ARM MOUNTED SIGN
	WIRELESS ETHERNET SUBSCRIBER

SIGNAL HEAD TYPES

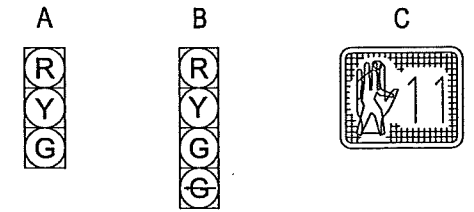

PED  
 V3 V4LT\* (WITH COUNTDOWN)  
 \*WITH BI-MODAL YELLOW AND GREEN ARROWS.

ELECTRICAL SERVICE DATA

ELECTRICAL SERVICE DESCRIPTION SEE ED(4)	SERVICE CONDUIT SIZE (RMC)	SERVICE CONDUCTORS NO./SIZE	MAIN CIRCUIT BREAKER POLE/AMP	TWO-POLE CONTACTOR AMPS	PANEL/LOADCENTER AMP PANEL (MN)	CIRCUIT NO.	BRANCH CKT. BRK. POLE/AMPS	KVA LOAD
TY D (120/240) TO (HS) SS (E) PS (U)	2"	3 / #6	2P / 100	30	100	T.S. ILSN	1P / 50 2P / 20	< 7.1

\*ONCOR WILL CONNECT ELECTRICAL SERVICE TO ELECTRICAL SUPPLY. CONTRACTOR RESPONSIBLE TO CONNECT SIGNAL CONTROLLER TO SERVICE

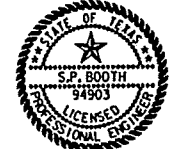

*S.P. Booth*  
 Signature of Registrant Date 3/21/2014

NOTES:

- EXISTING SIGNAL CONTROLLER TO BE RELOCATED AS SHOWN. SALVAGE EXISTING SIGNAL EQUIPMENT AND RETURN TO TOWN OF ADDISON.
- ALL POLES AND MAST ARMS TO BE POWDER COAT SILVER TO MATCH BELT LINE STREET LIGHTS.
- ALL MAST ARM MOUNTED SIGNS SHALL HAVE HIGH INTENSITY PRISMATIC (HIP) SHEETING.
- RELOCATE EXISTING STREET NAME SIGNS TO NEW POLES/MAST ARMS.
- FURNISH AND INSTALL A 10' POLE EXTENSION ON T-3 SIGNAL ARM. CONTRACTOR TO INSTALL TOWN SUPPLIED WIRELESS ETHERNET SUBSCRIBER ON THE POLE EXTENSION. CONTRACTOR TO MOUNT WIRELESS RADIO AND SHALL AIM THE ETHERNET SUBSCRIBER UNIT AS DIRECTED BY THE TOWN ENGINEER.
- CONTRACTOR SHALL FURNISH AND INSTALL THE VIDEO SERVER AND HARDENED ETHERNET SWITCH INSIDE THE TRAFFIC SIGNAL CONTROLLER CABINET.
- THE VIDEO SERVER SHALL BE INSTALLED BETWEEN THE VIVDS PROCESSOR AND HARDENED ETHERNET SWITCH (POLE T-3).
- REMOVE ALL EXISTING FIELD WIRING AFTER NEW SIGNALS ARE PUT INTO SERVICE.
- ALL EXISTING PULL BOXES TO TO BE REMOVED AND ABANDONED CONDUIT TO BE CUT AND CAPPED. SALVAGED PULL BOXES TO BE RETURNED TO TOWN OF ADDISON.
- COORDINATE SEQUENCING OF INSTALL OF SIGNAL CONDUITS WITH INSTALL OF WATER VALVES.

SIGNAL POLE CHART

POLE NUMBER	T-1	T-2	T-3	T-4
MAST ARM LENGTH	48'	24'	55'	60'
FOUNDATION TYPE	36-A	30-A	48-A	48-A
WITH LUMNAIRES	NO	NO	NO	NO
MAST ARM SIGNS	R10-12, R3-4	R10-12	R10-12, R3-4	R10-12, R3-8b
SIZE OF LENS	12"			
SIGNAL TYPE	B A A A C C B A C C B A A A C C B A A C C			
SIGNAL FACE NO.	1 2 3 4 5 6 7 8 9 10 11 12 13 14 15 16 17 18 19 20 21			
LED SIGNAL INDICATIONS	R R R R DW DW R R DW DW R R R R DW DW R R R DW DW			
	Y Y Y Y W W Y Y W W Y Y Y Y W W Y Y Y W W			
	G G G G C C C C G C G G C C G C G			
	←GY ←GY ←GY ←GY			

ALL SIGNAL HEADS SHALL HAVE BLACK PLASTIC BACK PLATES. LEFT-TURN INDICATIONS WILL CONSIST OF 4 SECTION HEADS WITH BI-MODAL YELLOW AND GREEN ARROWS. ALL MAST ARMS WILL HAVE LED ILLUMINATED STREET NAME SIGNS.

NO.		REVISION		BY		DATE	
TOWN OF ADDISON DALLAS COUNTY, TEXAS <b>BELT LINE ROAD</b> UNDERGROUND ELECTRICAL <b>PROPOSED TRAFFIC SIGNAL LAYOUT</b> BELT LINE RD AT SURVEYOR BLVD							
		1201 NORTH BOWSER ROAD, RICHARDSON, TEXAS 75081-2275 TEL (214) 346-6200		FILE		SHEET	
PROJECT	DESIGN	DRAWN	DATE	FILE	SHEET		
29350	HALFF	HALFF	MAR. 2014	29350_SGNL_05	TS-5		