

NOTES

- EXCEPT AS NOTED ON THE PLANS, NEW CONDUIT SHALL BE INSTALLED WHERE NECESSARY TO ACCOMMODATE PULL BOXES AND CONTROLLERS. SAID CONDUIT SHALL BE INSTALLED IN SUCH A MANNER SO AS TO ALLOW EASY PULLING OF SIGNAL CABLE.
- CONTRACTOR SHALL MAINTAIN TRAFFIC SIGNAL OPERATION AT ALL TIMES UNLESS BRIEF SHUTDOWN IS APPROVED IN WRITING BY THE TOWN OF ADDISON. THE CONTRACTOR MAY INSTALL TEMPORARY SIGNALS AS APPROVED BY THE TOWN OF ADDISON.
- THE CONTRACTOR SHALL RECONNECT ALL SIGNAL INTERCONNECT AND EMERGENCY VEHICLE CABLE TO THE RELOCATED CONTROLLER BETWEEN COMMERCIAL AND MARSH SO AS TO DUPLICATE EXISTING SIGNAL PHASING, DETECTOR OPERATION, PEDESTRIAN PHASING, INTERCONNECT AND EMERGENCY VEHICLE PHASING EXCEPT AS NOTED ON THE PLANS. NEW CONDUIT SHALL BE INSTALLED WHERE NECESSARY IN THE MEDIAN OR ELSEWHERE TO ACCOMMODATE RELOCATED PULL BOXES AND CONTROLLERS. SAID CONDUIT SHALL BE INSTALLED IN SUCH A MANNER SO AS TO ALLOW EASY PULLING OF SIGNAL CABLE THROUGH THE NEW CONDUIT.
- NEW MAST ARM POLES AND 55' MAST ARMS SHALL BE FURNISHED TO THE CONTRACTOR BY THE TOWN OF ADDISON. CONTRACTOR SHALL PICK UP SAID EQUIPMENT FROM THE TOWN OF ADDISON STORAGE YARD. CONTRACTOR SHALL FURNISH AND INSTALL NEW CONTROLLER CABINET, SIGNALS HEADS AND APPURTENANCES REQUIRED AT BELT LINE / BUSINESS IN ACCORDANCE WITH THE COMPONENT REQUIREMENTS PROVIDED IN GENERAL NOTE 22 ON SHEET 2 OF 46.
- TWO OF THE EXISTING MAST ARM POLES AND 36' MAST ARMS INCLUDING SIGNAL HEADS FROM THE BELT LINE / MARSH LANE INTERSECTION SHALL BE RELOCATED TO THE BELT LINE / BUSINESS INTERSECTION.

| | | | |
|--------------------|-----------------------|-----------------|----------------------------|
| HEAD NUMBERS | 1,2,3,7,9 10,11,14 | 4,5,8, 12,15 | 16,17,18,19 20,21,22,23 |
| LENS SIZE | 12" | 12" | |
| TYPE | CONV. | CONV. | CONV. |
| LENS CONFIGURATION | R | R | DW |
| | Y | Y | WALK |
| | G | G | |

WIRING & P.V.C. DIAGRAM
(SCHEMATIC - NO SCALE)

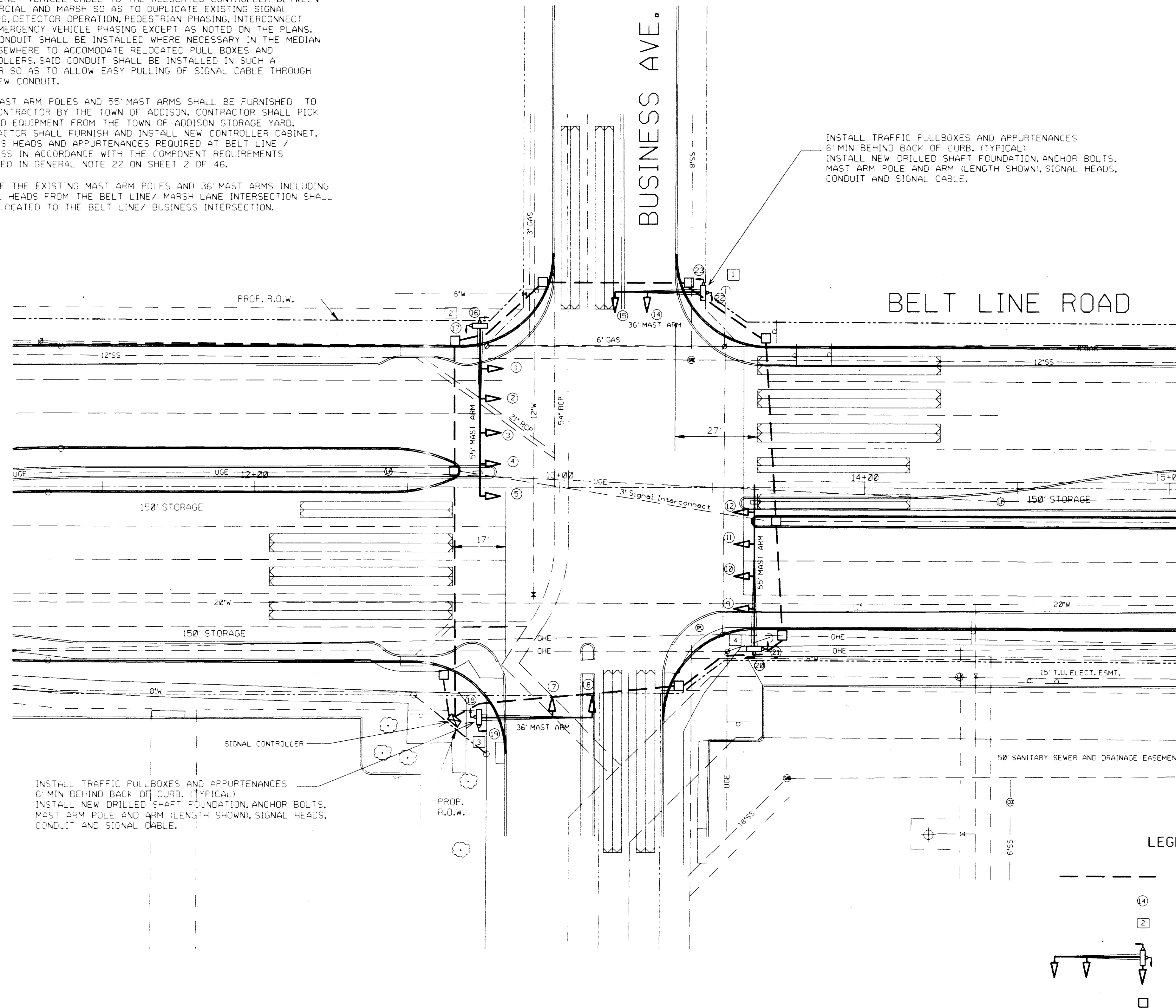
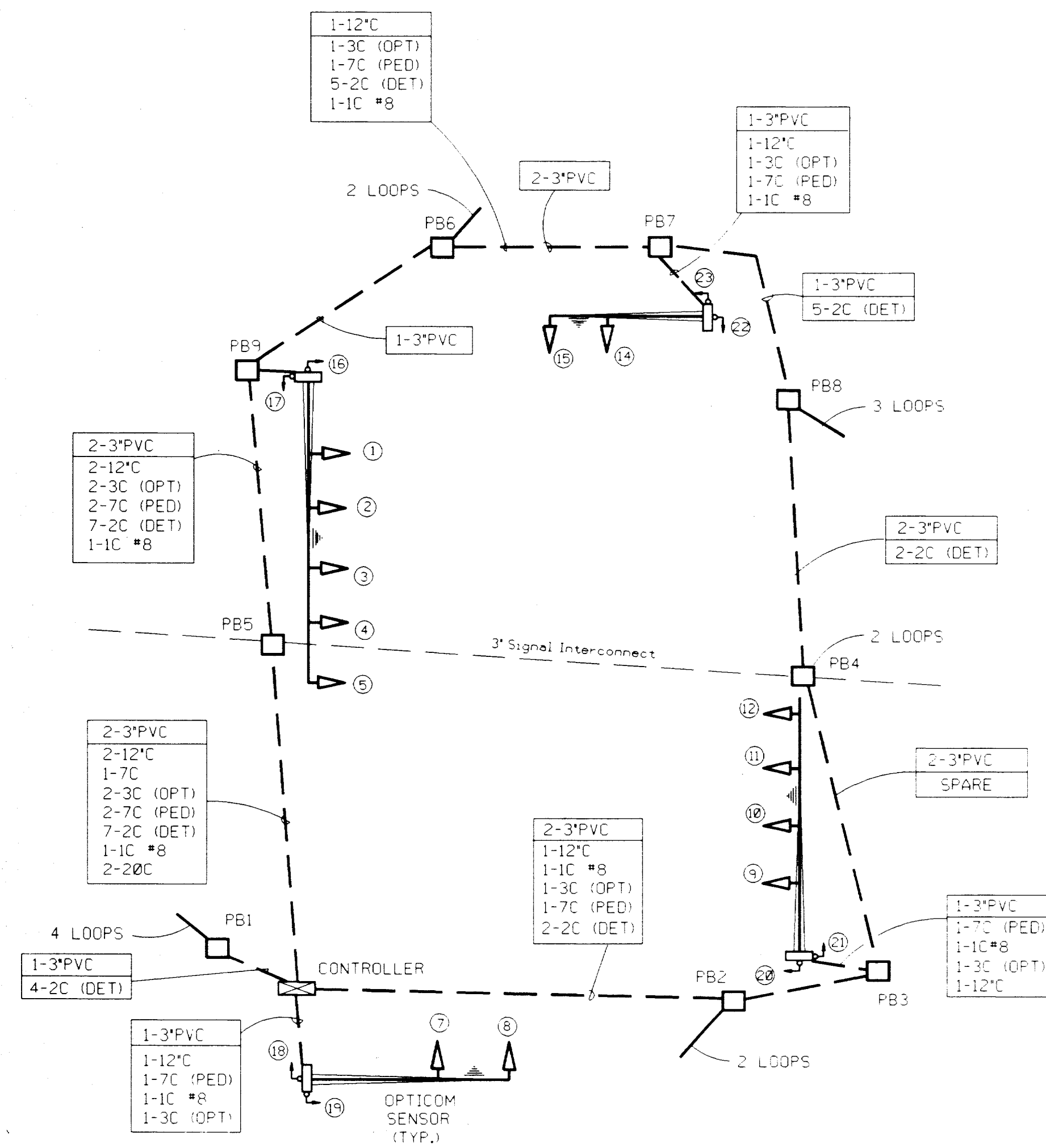

| | | | |
|-----|-------------------------------------------|-----|---------|
| NO. | REVISION | BY | DATE |
| 3 | REVISED DETECTOR LOOP & SIGNAL HEAD TABLE | PSS | 4-20-94 |
| 2 | REVISED MAST ARM & COMMENTS | PSS | 4-8-94 |
| 1 | REVISED MAST ARM & ADD GENERAL NOTES | PSS | 3-23-94 |

DESIGNED BY: _____
 DRAWN BY: _____ EH&A
 CHECKED BY: _____ B. GRANTHAM
 SCALE: 1" = 20'
 DATE: _____ JANUARY 1994
 FILE: \ADDISON\BUSINESS\SIGNAL

EH&A Espey, Huston & Associates, Inc.
 Engineering & Environmental Consultants
 13800 Montfort Drive, Suite 230
 Dallas, Texas 75240 (214) 387-0771

ASA ENGINEERING
 13747 MONTFORT DRIVE, SUITE 204
 P.O. BOX 802207, DALLAS, TEXAS, 75380-2307
 (214) 960-1137 FAX (214) 960-1139

TRAFFIC SIGNAL PLAN
 PAVING IMPROVEMENTS
 BELT LINE ROAD AT BUSINESS AVENUE
 for
 THE TOWN OF ADDISON

SHEET NO. 19
 OF 46 SHEETS
 JOB NO. 15411