

B23-6

INTERSECTION IMPROVEMENTS

FOR

BELT LINE ROAD AT MARSH LANE BELT LINE ROAD AT BUSINESS AVENUE

TOWN OF ADDISON

INDEX OF DRAWINGS	
TITLE SHEET	1
GENERAL NOTES	2
QUANTITY SUMMARY	3
BELT LINE/MARSH LANE	
RIGHT-OF-WAY PLAN	4
PAVING PLAN	5-6
PAVEMENT MARKING PLAN	7-8
TRAFFIC SIGNAL PLAN	9
LANDSCAPE PLAN	10-11
IRRIGATION PLAN	12-13
BELT LINE/BUSINESS AVENUE	
RIGHT-OF-WAY PLAN	14
PAVING PLAN	15-16
PAVEMENT MARKING PLAN	17-18
TRAFFIC SIGNAL PLAN	19
LANDSCAPE PLAN	20-21
IRRIGATION PLAN	22-23
CONSTRUCTION DETAILS	24
STANDARD DETAILS	25-31
TRAFFIC SIGNAL DETAILS	32-46

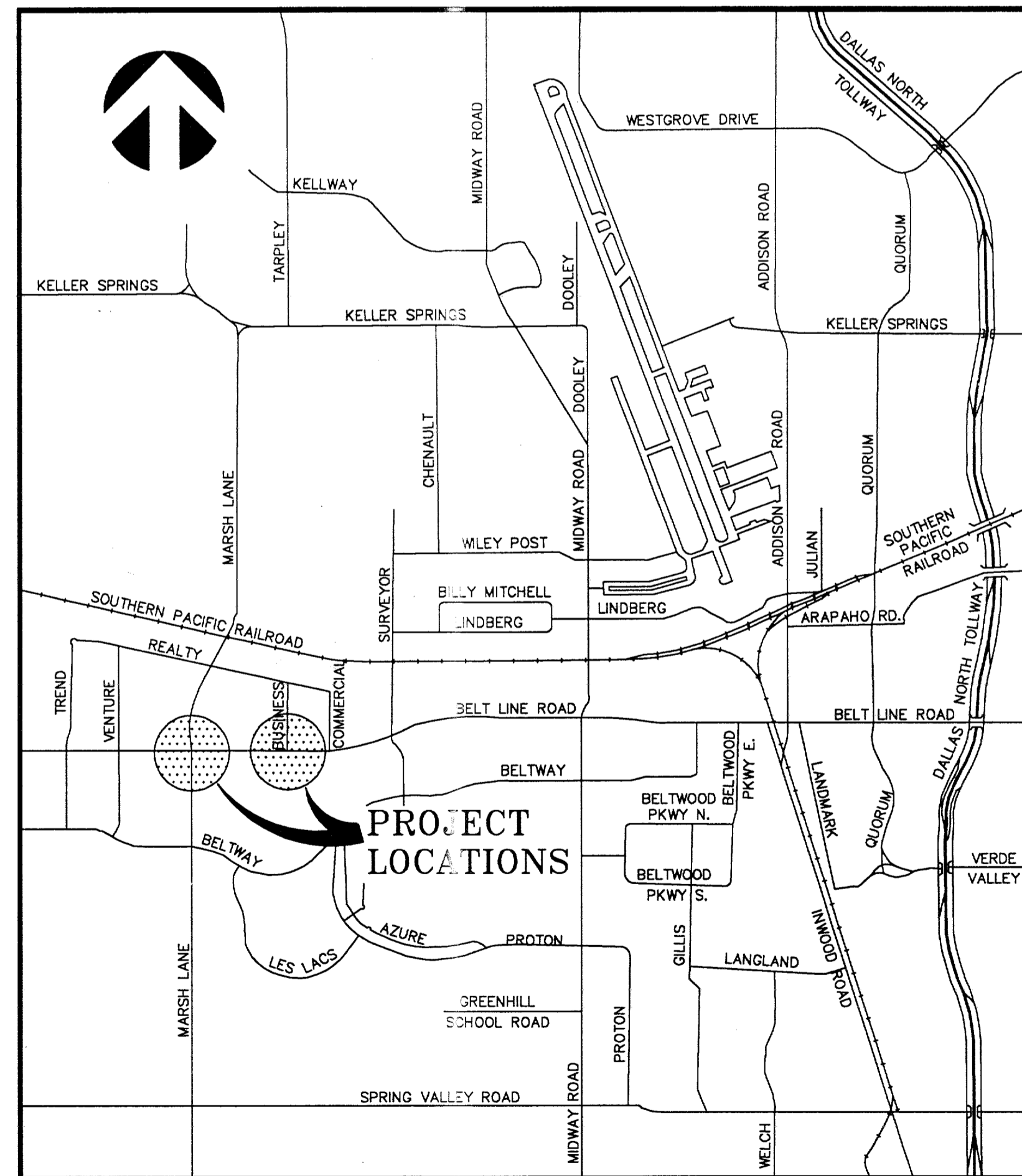

LOCATION MAP

N.T.S.

CONSTRUCTION SET

ISSUED BY
TOWN OF ADDISON
PUBLIC WORKS DEPARTMENT

NAME: David Nighmeyer DATE: 7/18/94

TOWN OF ADDISON ENGINEER

JOHN BAUMGARTNER, P.E.

EH&A PROJECT MANAGER

BRUCE GRANTHAM, P.E.

EH&A Espey,
Huston &
Associates, Inc.

Engineering & Environmental Consultants
13800 Montfort Drive, Suite 230
Dallas, Texas 75240 (214) 387-0771

E.H. & A. JOB NO. 13921

E.H. & A. JOB NO. 15411

B23-6

BELT LINE ROAD/BUSINESS AVENUE
BELT LINE ROAD/MARSH LANE