

MARKING DETAILS
TURN LANES

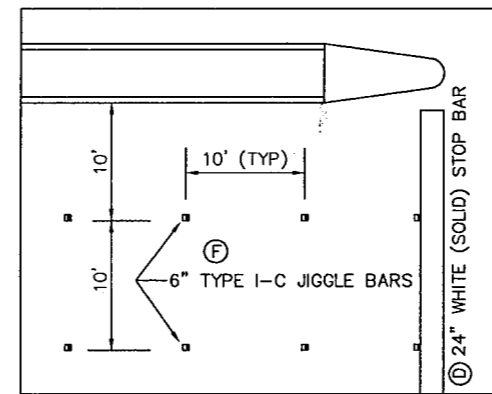

DOUBLE LEFT TURN LANE DETAIL

NOTES :

1. ALL STRIPING SHALL BE THERMOPLASTIC AND REFLECTIVE.
2. ALL MARKERS SHALL BE 4". JIGGLE BARS SHALL BE 6"
3. PROPOSED PAVEMENT MARKINGS SHALL MATCH EXISTING MARKINGS AT LIMITS OF CONSTRUCTION. ALL CONFLICTING MARKINGS SHALL BE COMPLETELY REMOVED.
4. THE TOWN OF ADDISON WILL PROVIDE SMALL ROADSIDE SIGNS UPON COMPLETION OF CONSTRUCTION.

PROPOSED PERMANENT PAVEMENT MARKINGS LEGEND

- A 4" TYPE W MARKER (WHITE NON-REFLEC)(CL C)
- B 4" TYPE I-C MARKER (WHITE REFLEC)(CL B)
- C 12" WHITE (SOLID) STRIPING (TYPE I)
- D 24" WHITE (SOLID) STRIPING (TYPE I)
- E LANE ASSIGNMENT MARKING
- F 6" TYPE I-C JIGGLE BAR (WHITE REFLEC)(CL A)
- H 4" TYPE I WHITE (BROKEN) STRIPING

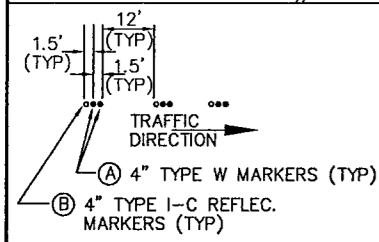
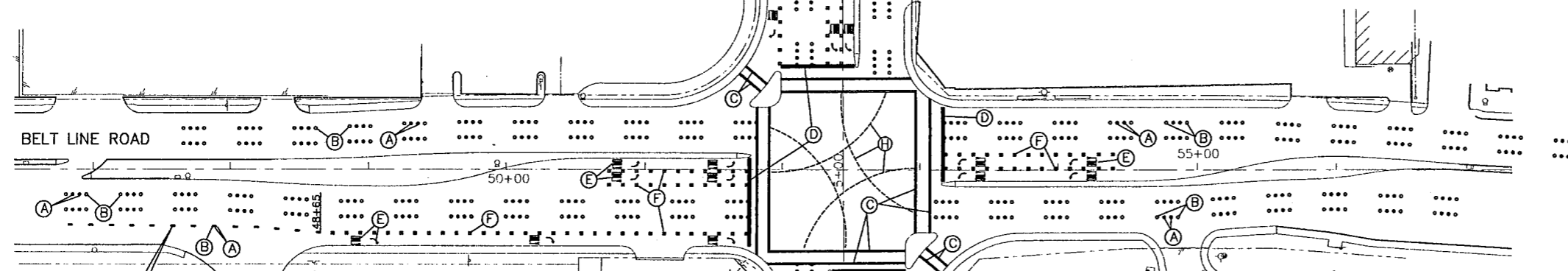

LANE DROP MARKINGS

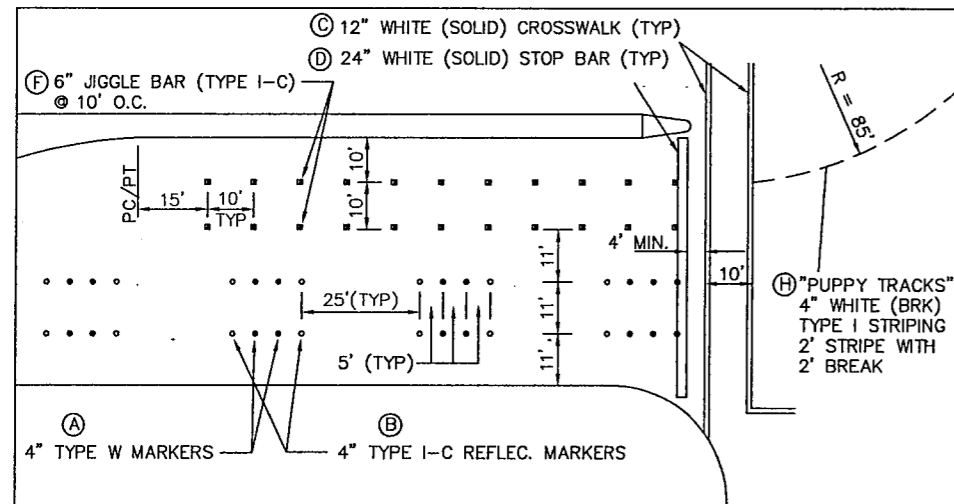

TYPICAL LANE MARKINGS

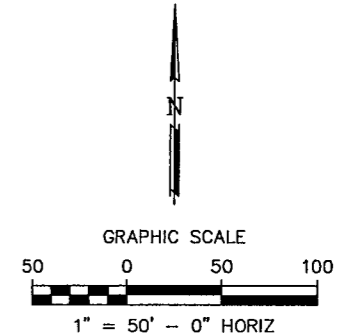

SHEET 1 OF 2

BARTON-ASCHMAN ASSOCIATES, INC.

PERMANENT PAVEMENT MARKINGS SHEET
MIDWAY ROAD AT BELT LINE ROAD
ADDISON, TEXAS

Texas Department of Transportation		DART	
REVISION	DATE	FED. ROAD DIST. No.	FEDERAL AID PROJECT NO.
		6	CM 97 (449)
		STATE	COUNTY
		TEXAS	DALLAS
		CONT.	JOB
		8050	034
DESIGNED BY: R.A.Y.		SECT.	HIGHWAY No.
DRAWN BY: B.A.A.		18	BELT LINE RD
CHECKED BY: L.M.P.			BA FILE NAME :

