

NO.	DELTA	RADIUS	LENGTH	NO.	DELTA	RADIUS	LENGTH
45	03° 17' 40"	1802.0'	103.61'	51	02° 49' 32"	1768.34'	87.21'
46	03° 15' 00"	1802.0'	102.22'	52	02° 46' 07"	1735.34'	83.85'
47	00° 47' 52"	1835.0'	25.55'	53	02° 52' 18"	1801.34'	90.28'
48	13° 17' 15"	300.0'	69.57'				
49	12° 38' 05"	300.0'	66.16'				
50	02° 49' 32"	1768.34'	87.21'				

CURVE TABLE

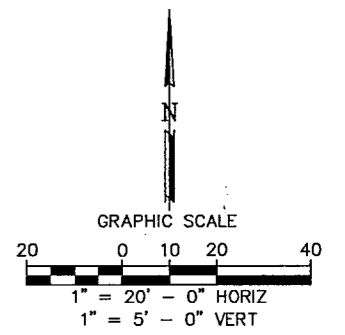
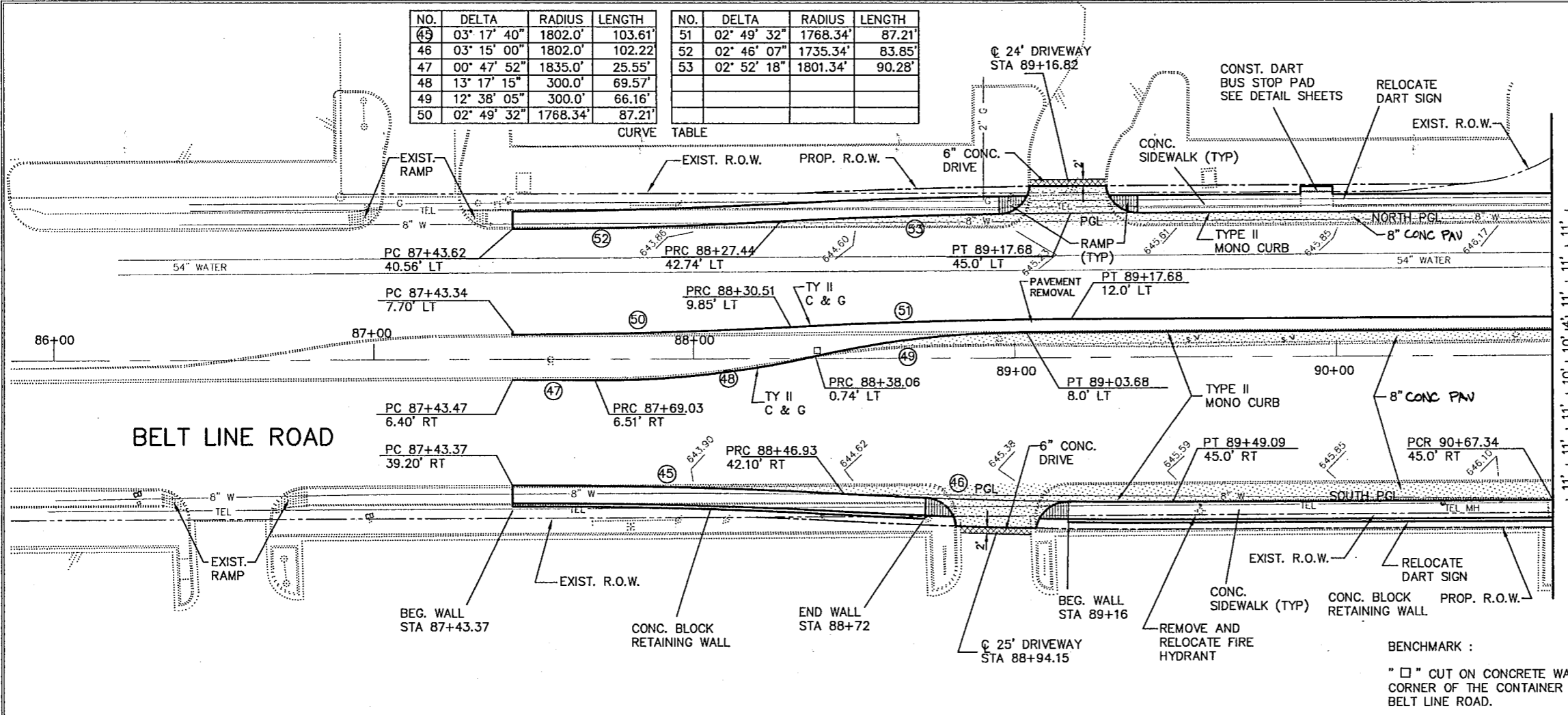

- LEGEND :
- PGL PROFILE GRADE LINE
 - PC POINT OF CURVATURE
 - PT POINT OF TANGENCY
 - PRC POINT OF REVERSE CURVE
 - PCC POINT OF COMPOUND CURVE
 - PCR POINT OF CURB RETURN
 - EX EXISTING
 - RT RIGHT
 - LT LEFT

- BARRIER FREE RAMP
- PROP. NEW PAVEMENT
- EX. SPOT GUTTER ELEV.

- NOTES :
1. ALL DRIVEWAY RADII SHALL BE 15' UNLESS NOTED OTHERWISE.
 2. BARRIER FREE RAMPS SHALL BE CONSTRUCTED AT ALL DRIVEWAYS AND STREET INTERSECTIONS. SEE PLANS FOR LOCATIONS.
 3. SEE DRIVEWAY PROFILE PLAN FOR DRIVEWAY PROFILES.
 4. FINAL LOCATIONS OF DART SIGNS SHALL BE AS DIRECTED BY THE ENGINEER AND SHALL BE PAID FOR UNDER ITEM 649.

BENCHMARK :
 " □ " CUT ON CONCRETE WALK AT THE SOUTHEAST CORNER OF THE CONTAINER STORE AT 4939 BELT LINE ROAD.
 ELEV. 644.48

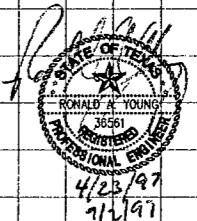
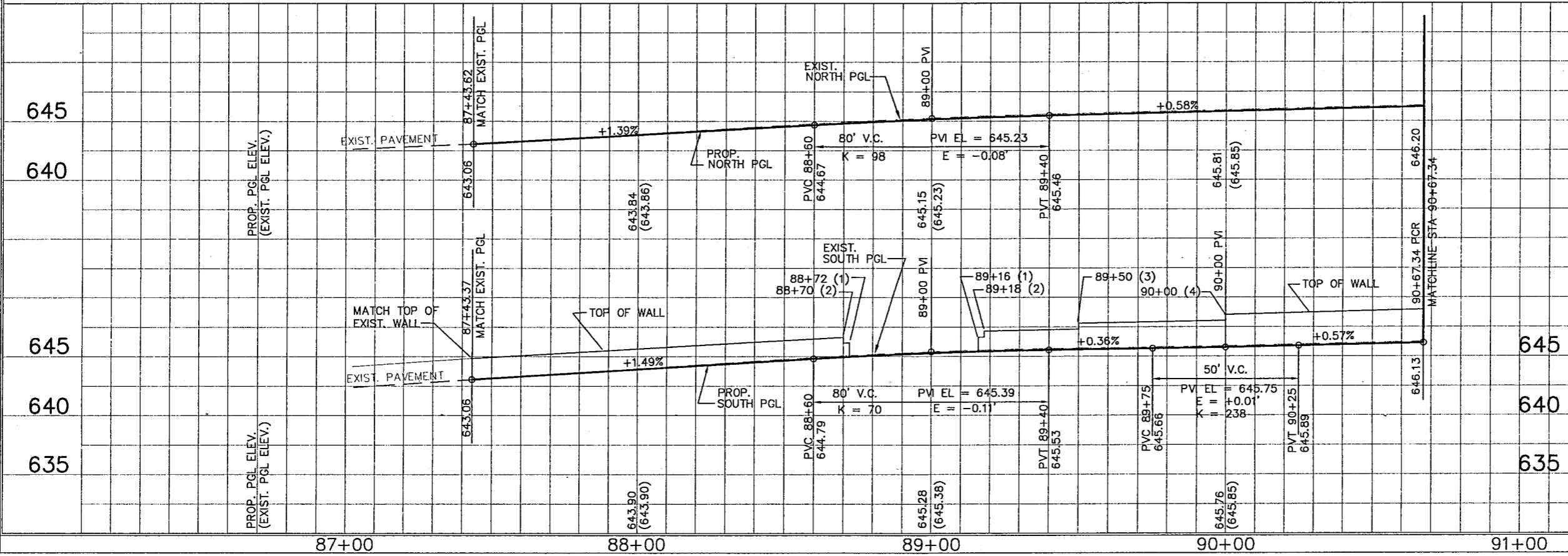

REVISED 8" CPED TO 8" CONC. PAV.
 2/2/97 RT
 SHEET 5 OF 8

BARTON-ASCHMAN ASSOCIATES, INC.

PAVING AND DRAINAGE PLAN/PROFILE SHEET
 BELT LINE ROAD
 STA 87+43.34 TO STA 90+67.34
 ADDISON, TEXAS

DESIGNED BY: R.A.Y.
 DRAWN BY: B.A.A.
 CHECKED BY: L.M.P.

REVISION	DATE	FED. ROAD DIST. No.	FEDERAL AID PROJECT NO.	SHEET No.
		6	CM 97 (449)	20
		STATE	STATE DIST.	COUNTY
		TEXAS	DALLAS	DALLAS
		CONT.	SECT.	JOB
		8050	18	034
		HIGHWAY No.		
		BELT LINE RD.		
BA FILE NAME :				