

CURVE TABLE				CURVE TABLE			
NO.	DELTA	RADIUS	LENGTH	NO.	DELTA	RADIUS	LENGTH
79	23° 46' 13"	700.0'	290.41'	84	12° 38' 33"	824.0'	181.82'
80	4° 18' 29"	1875.55'	141.02'	85	88° 58' 02"	15.0'	23.29'
81	19° 08' 56"	800.0'	267.37'	86	79° 40' 11"	10.0'	13.90'
82	15° 50' 31"	300.0'	82.95'	87	12° 40' 24"	250.0'	55.30'
83	07° 22' 04"	250.0'	32.15'	88	16° 04' 55"	125.0'	35.09'
				94	05° 44' 52"	686.0'	68.82'

**SHEET NOTES:**  
 1. THE EXIT DRIVEWAY AT STA. 17+68.29 RIGHT SHALL REMAIN OPEN TO TRAFFIC DURING ALL BUSINESS HOURS. THE CONTRACTOR, WITH THE APPROVAL OF THE ENGINEER, MAY USE HIGH EARLY STRENGTH CONCRETE AND MAY PERFORM THE CONSTRUCTION BETWEEN SATURDAY NOON AND MONDAY MORNING.

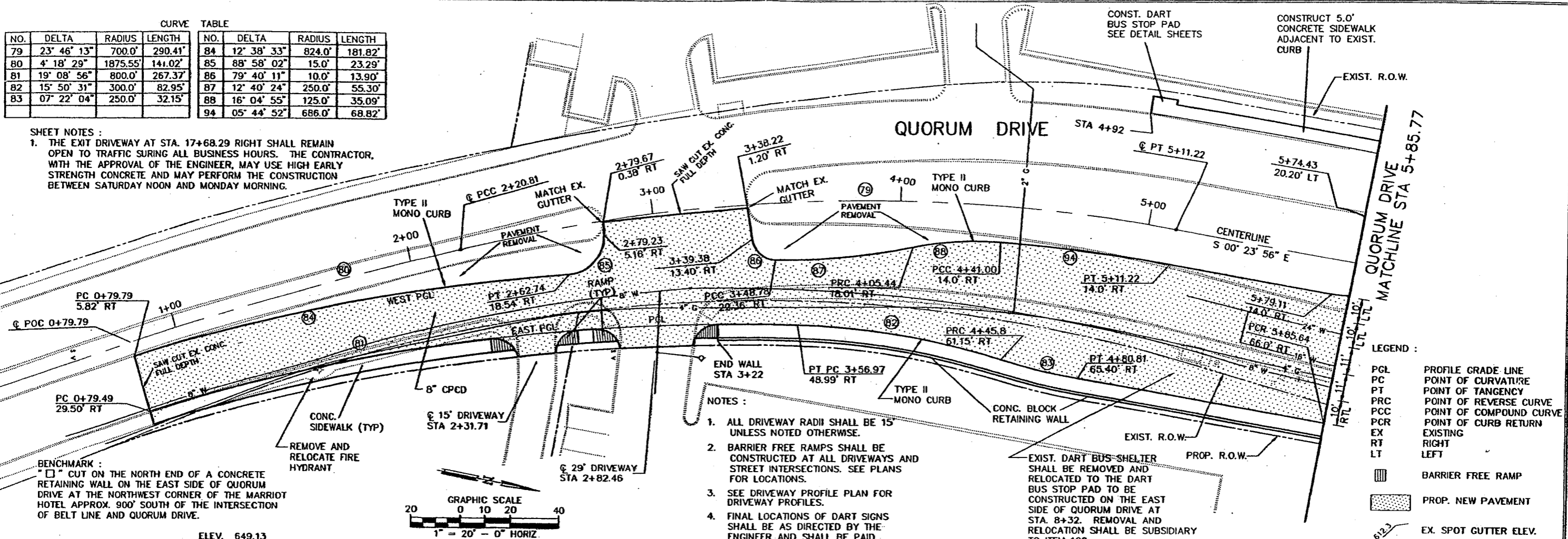

- NOTES:**
1. ALL DRIVEWAY RADII SHALL BE 15' UNLESS NOTED OTHERWISE.
  2. BARRIER FREE RAMPS SHALL BE CONSTRUCTED AT ALL DRIVEWAYS AND STREET INTERSECTIONS. SEE PLANS FOR LOCATIONS.
  3. SEE DRIVEWAY PROFILE PLAN FOR DRIVEWAY PROFILES.
  4. FINAL LOCATIONS OF DART SIGNS SHALL BE AS DIRECTED BY THE ENGINEER AND SHALL BE PAID FOR UNDER ITEM 649.

**LEGEND:**

PGL	PROFILE GRADE LINE
PC	POINT OF CURVATURE
PT	POINT OF TANGENCY
PRC	POINT OF REVERSE CURVE
PCC	POINT OF COMPOUND CURVE
PCR	POINT OF CURB RETURN
EX	EXISTING
RT	RIGHT
LT	LEFT
	BARRIER FREE RAMP
	PROP. NEW PAVEMENT
	EX. SPOT GUTTER ELEV.

**BENCHMARK:**  
 "□" CUT ON THE NORTH END OF A CONCRETE RETAINING WALL ON THE EAST SIDE OF QUORUM DRIVE AT THE NORTHWEST CORNER OF THE MARRIOTT HOTEL APPROX. 900' SOUTH OF THE INTERSECTION OF BELT LINE AND QUORUM DRIVE.

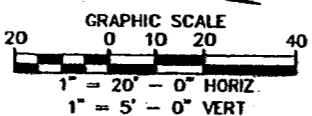

ELEV. 649.13

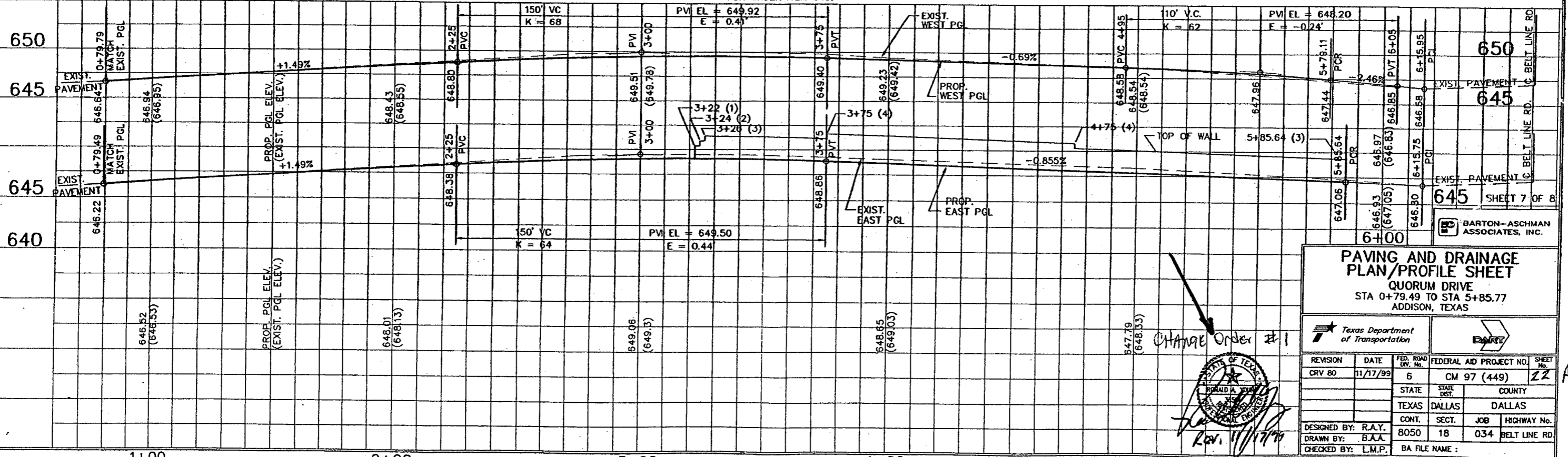

**PAVING AND DRAINAGE PLAN/PROFILE SHEET**  
 QUORUM DRIVE  
 STA 0+79.49 TO STA 5+85.77  
 ADDISON, TEXAS

Texas Department of Transportation

REVISION	DATE	FED. ROAD DIST. NO.	FEDERAL AID PROJECT NO.	SHEET NO.
CRV 80	11/17/99	6	CM 97 (449)	22
DESIGNED BY: R.A.Y.		STATE:	COUNTY:	
DRAWN BY: B.A.A.		TEXAS	DALLAS	
CHECKED BY: L.M.P.		CONT.:	SECT.:	JOB:
		8050	18	034
		HIGHWAY No. BELT LINE RD.		
		BA FILE NAME:		

CHANGE Order #1

Rev. 11/17/99

SHEET 7 OF 8

BARTON-ASCHMAN ASSOCIATES, INC.