

QUORUM DRIVE - MATCHLINE STA 7+36.27

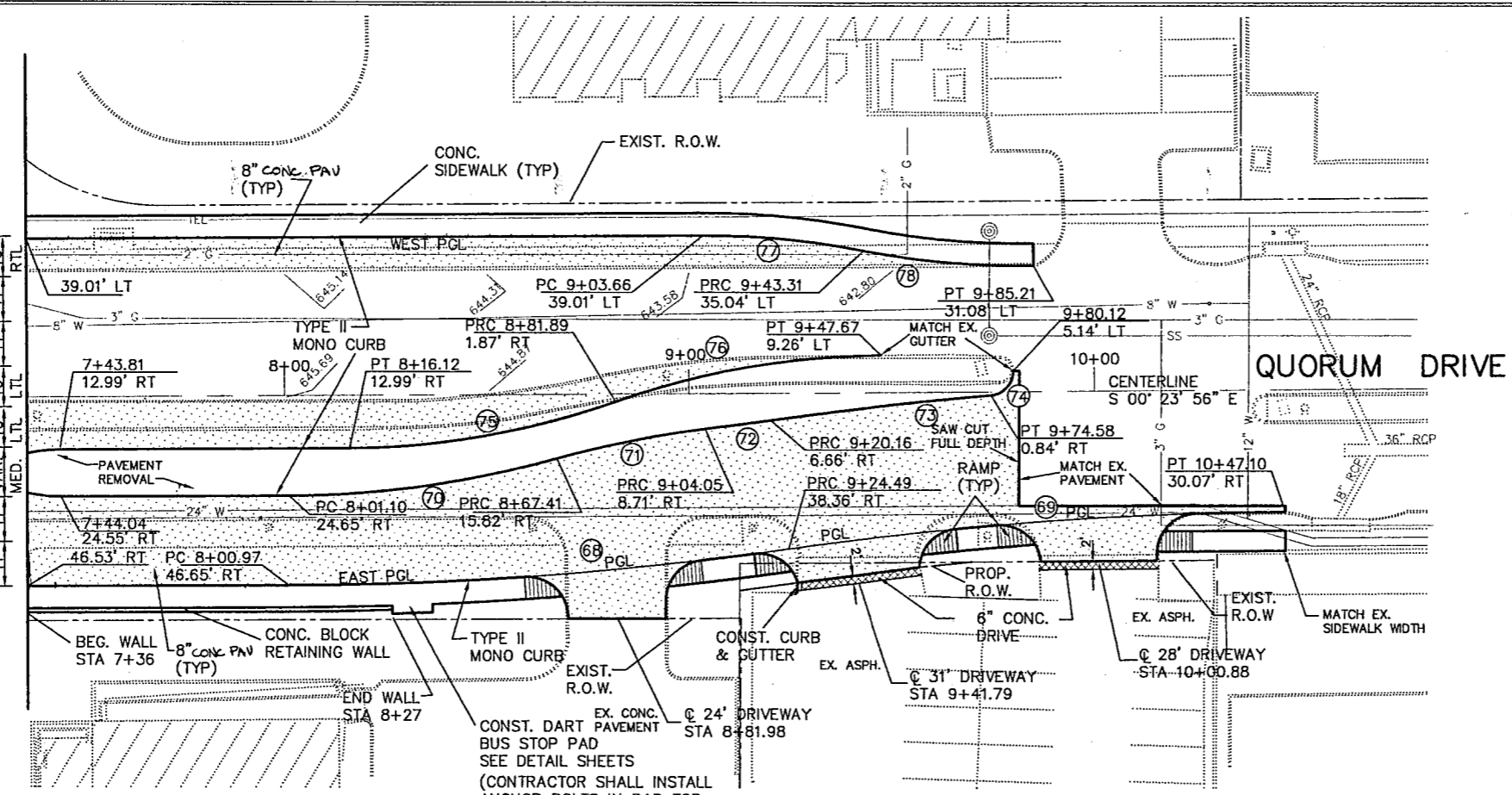

CURVE TABLE			CURVE TABLE				
NO.	DELTA	RADIUS	LENGTH	NO.	DELTA	RADIUS	LENGTH
68	07° 53' 15"	900.0'	123.90'	74	85° 34' 56"	6.0'	8.96'
69	07° 49' 47"	900.0'	122.99'	75	19° 11' 59"	200.0'	67.02'
70	15° 22' 42"	250.0'	67.10'	76	19° 12' 02"	200.0'	67.02'
71	08° 33' 44"	250.0'	37.36'	77	11° 26' 06"	200.0'	39.92'
72	01° 04' 17"	868.0'	16.23'	78	12° 04' 40"	200.0'	42.16'
73	03° 21' 55"	932.0'	54.74'				

BENCHMARK:  
 " □ " CUT ON THE BACK OF CURB ON THE SOUTH NOSE OF MEDIAN CENTERLINE OF QUORUM DRIVE APPROX. 275' SOUTH OF THE INTERSECTION OF ARAPAHO ROAD AND QUORUM DRIVE.

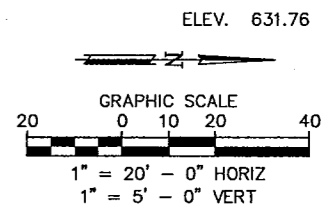

- LEGEND :
- PGL PROFILE GRADE LINE
  - PC POINT OF CURVATURE
  - PT POINT OF TANGENCY
  - PRC POINT OF REVERSE CURVE
  - PCC POINT OF COMPOUND CURVE
  - PCR POINT OF CURB RETURN
  - EX EXISTING
  - RT RIGHT
  - LT LEFT
  - [Symbol] BARRIER FREE RAMP
  - [Symbol] PROP. NEW PAVEMENT
  - [Symbol] EX. SPOT GUTTER ELEV.

- NOTES :
- ALL DRIVEWAY RADII SHALL BE 15' UNLESS NOTED OTHERWISE.
  - BARRIER-FREE RAMP SHALL BE CONSTRUCTED AT ALL DRIVEWAYS AND STREET INTERSECTIONS. SEE PLANS FOR LOCATIONS.
  - SEE DRIVEWAY PROFILE PLAN FOR DRIVEWAY PROFILES.
  - FINAL LOCATIONS OF DART SIGNS SHALL BE AS DIRECTED BY THE ENGINEER AND SHALL BE PAID FOR UNDER ITEM 649.

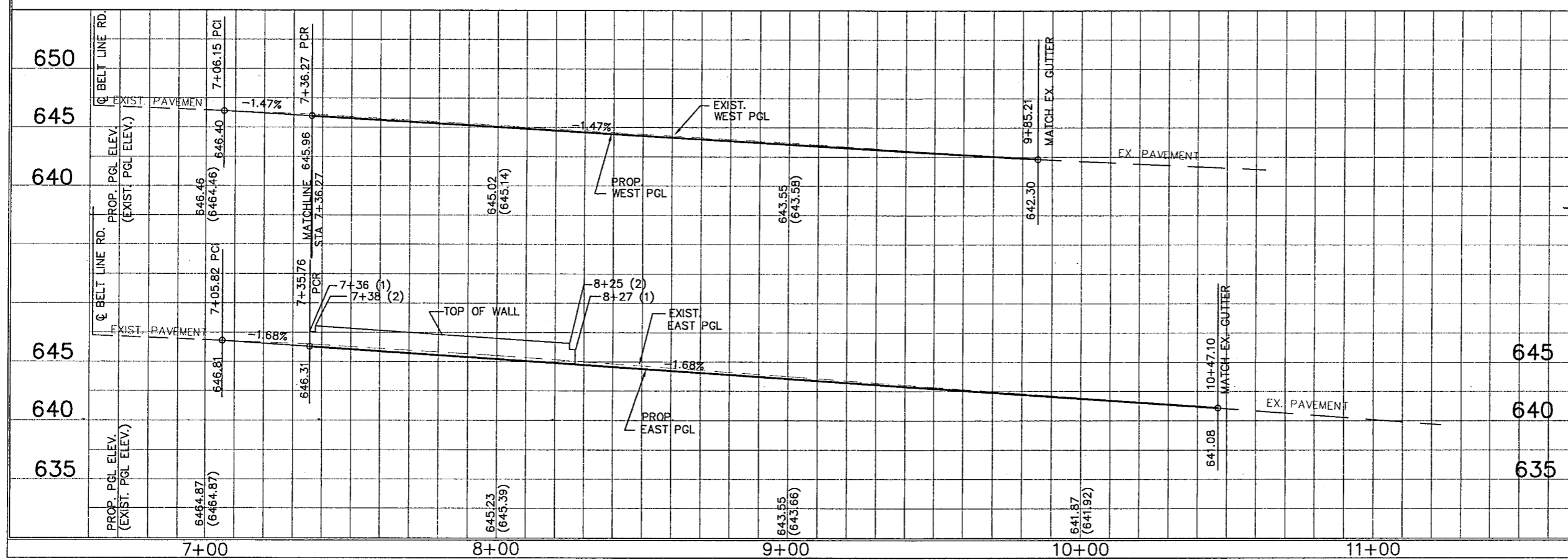

STATE OF TEXAS  
 PROFESSIONAL ENGINEER  
 RONALD A. YOUNG  
 3556  
 4/22/97  
 9/2/97

REVISED 8" CONC. TO 8" CONC. PAV. 9/2/97 - RT

SHEET 8 OF 8

BARTON-ASCHMAN ASSOCIATES, INC.

PAVING AND DRAINAGE PLAN/PROFILE SHEET				
QUORUM DRIVE				
STA 7+36.27 TO STA 10+47.10				
ADDISON, TEXAS				
Texas Department of Transportation		DART		
REVISION	DATE	FED. ROAD DIV. No.	FEDERAL AID PROJECT NO.	SHEET No.
		6	CM 97 (449)	23
		STATE	STATE DIST.	COUNTY
		TEXAS	DALLAS	DALLAS
		CONT.	SECT.	JOB
		8050	18	034 BELT LINE RD.
DESIGNED BY:	R.A.Y.	BA FILE NAME :		
DRAWN BY:	B.A.A.			
CHECKED BY:	L.M.P.			