

TYPICAL DETECTOR INSTALLATION

- At Night—1. Steady burn lamps for delineation instead of cones.
2. Flashers on barricades.

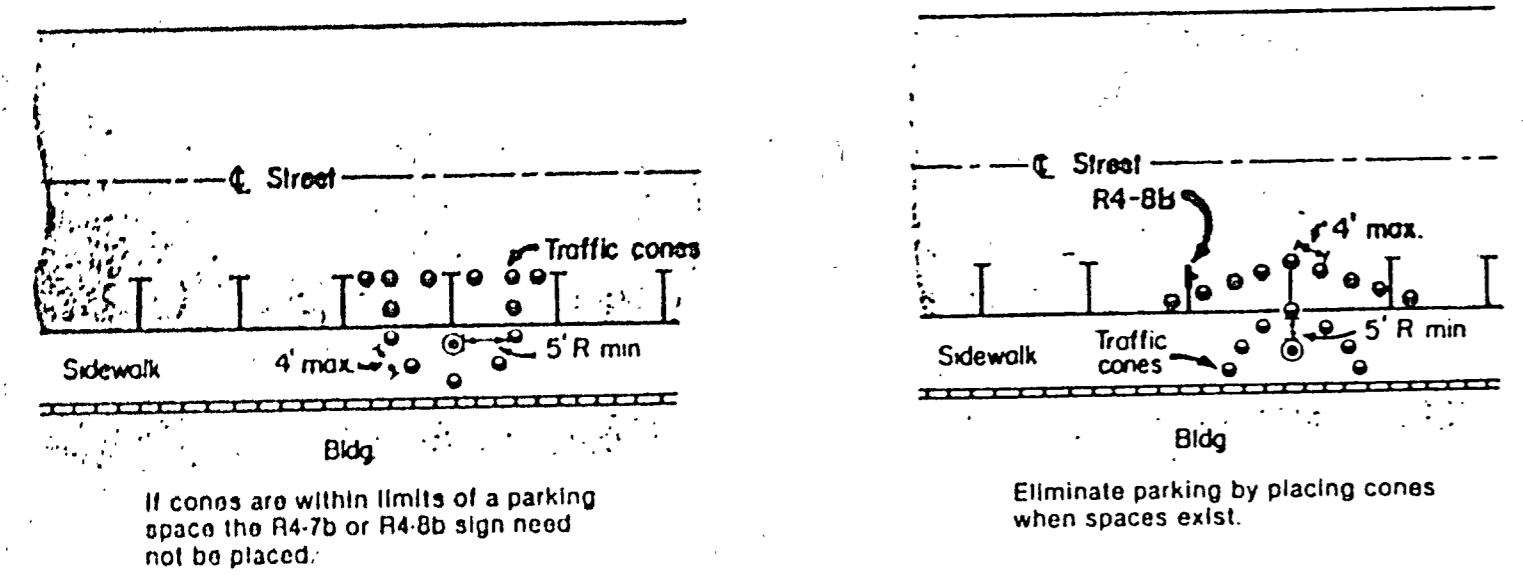
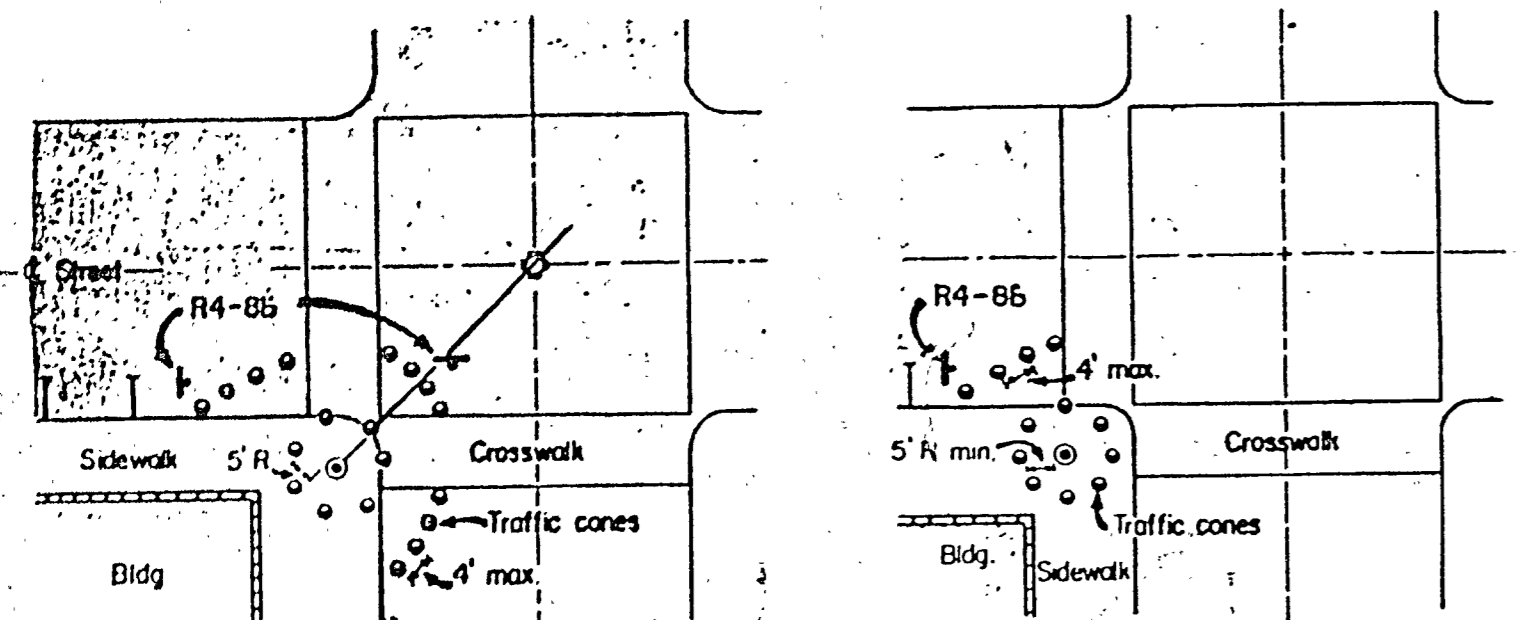

TYPICAL RESTRICTED PEDESTRIAN MOVEMENTS

Where pedestrian movements are anticipated at night, all holes, trenches or other hazardous areas shall be adequately protected by use of barricades, lights or other protective devices

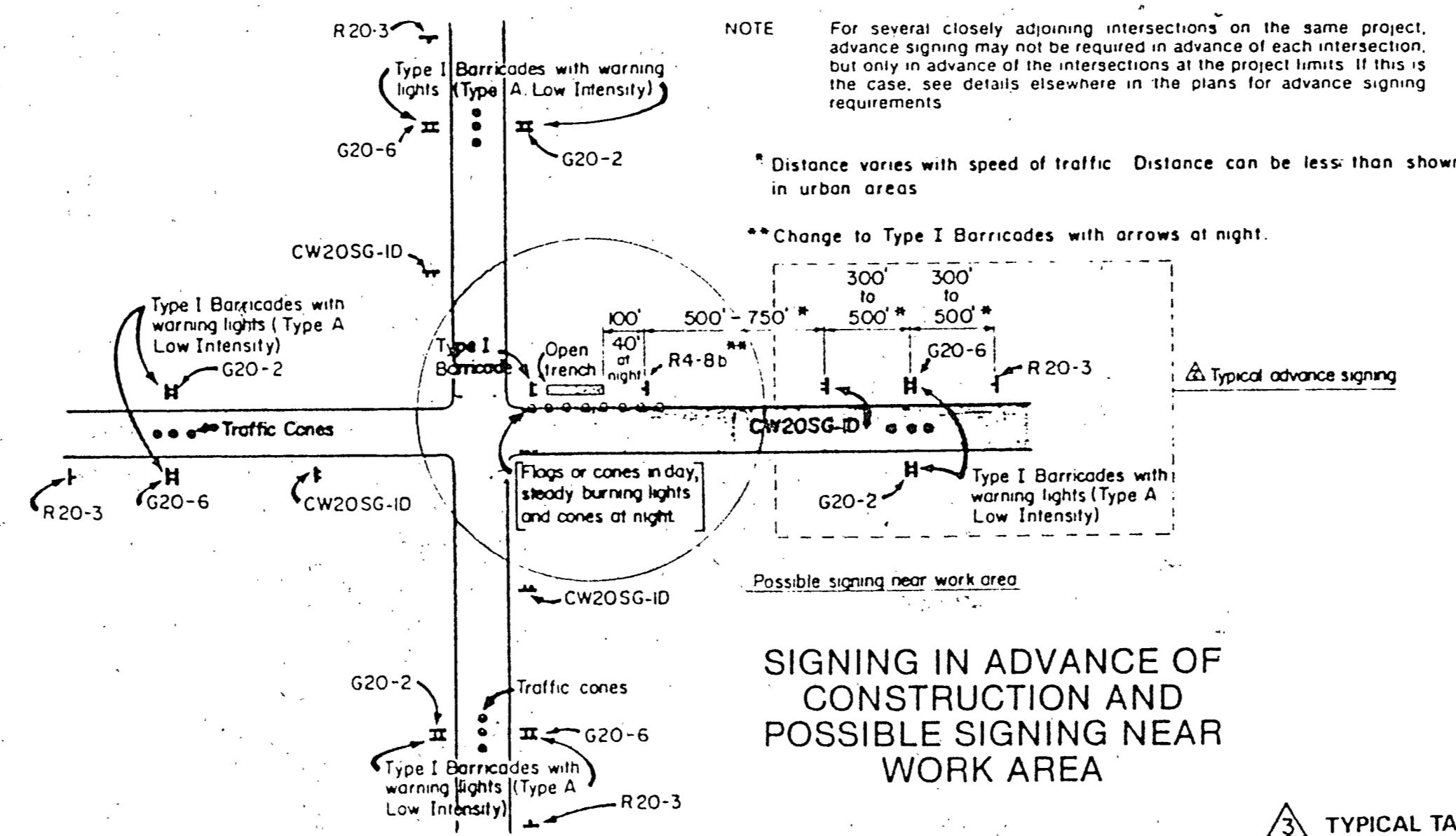

SIGNING IN ADVANCE OF CONSTRUCTION AND POSSIBLE SIGNING NEAR WORK AREA

TYPICAL TAPER LENGTH (L)

| Post-to-Speed | Formula | Minimum Desirable Taper Lengths* | | |
|---------------|-----------------------|----------------------------------|-----|-----|
| | | 10 | 11 | 12 |
| 30 | $L = \frac{VS^2}{60}$ | 150 | 165 | 180 |
| 35 | | 205 | 225 | 245 |
| 40 | | 265 | 295 | 320 |
| 45 | | 330 | 375 | 410 |
| 50 | $L = WS$ | 500 | 550 | 600 |
| 55 | | 550 | 605 | 660 |
| 60 | | 600 | 660 | 720 |

* 85TH PERCENTILE SPEED MAY BE USED ON ROADS WHERE TRAFFIC SPEEDS NORMALLY EXCEED THE POSTED SPEED LIMIT. TAPER LENGTHS HAVE BEEN ROUNDED OFF.

L = TAPER LENGTH IN FEET
W = OFFSET IN FEET
S = SPEED IN MPH

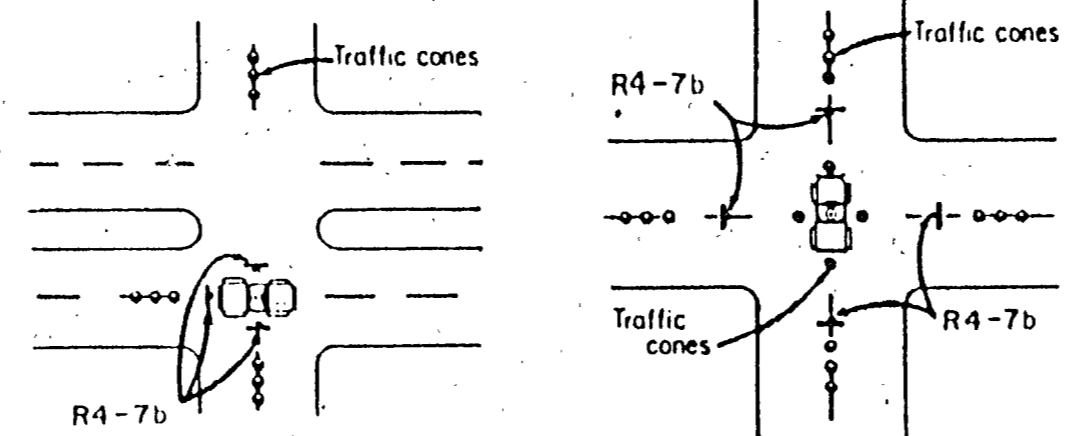

TYPICAL HANGING SIGNAL INSTALLATIONS

- NOTES:
1. Flagmen & CW20-7a sign may also be required according to field conditions.
2. Use vehicle equipped with yellow rotating beacon or strobe.

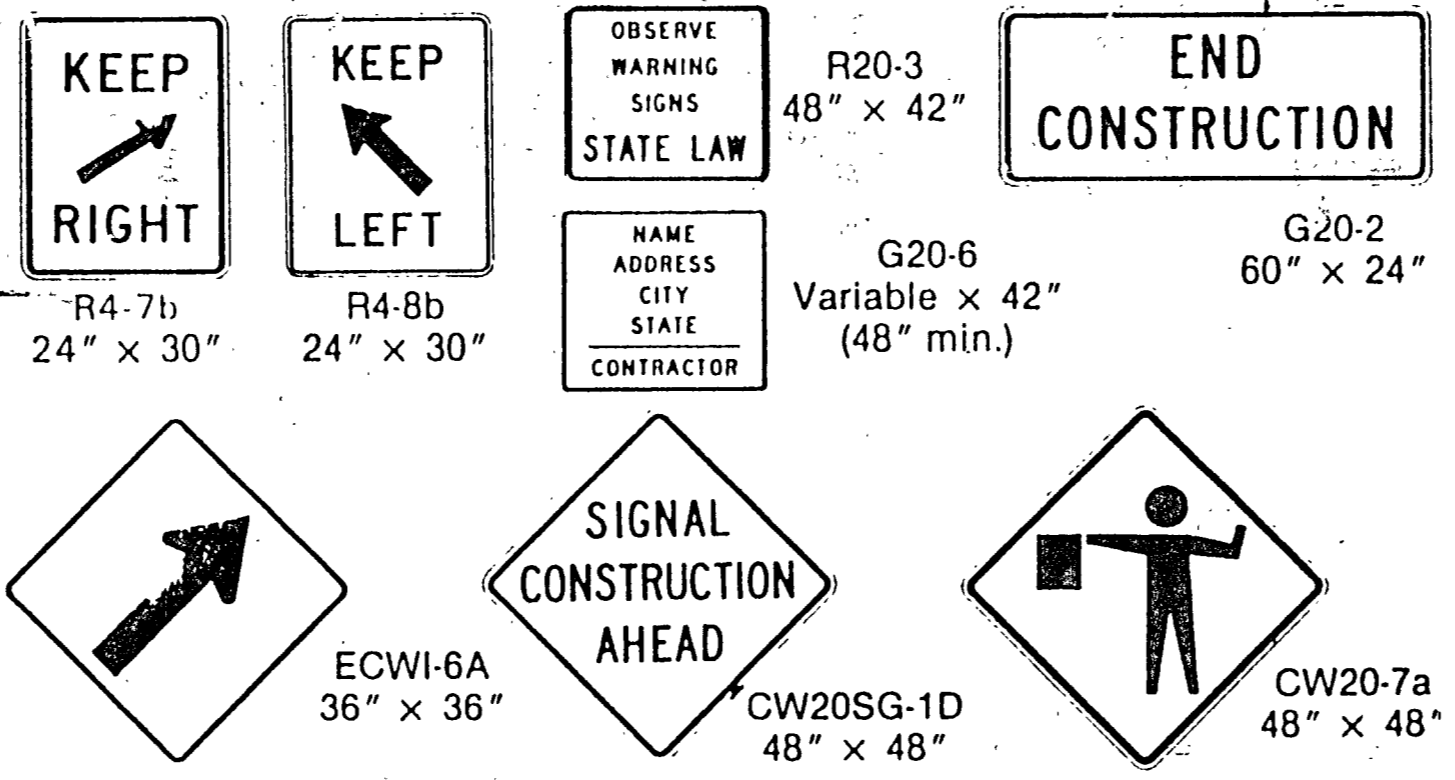

TYPICAL SIGNS USED IN TRAFFIC SIGNAL CONSTRUCTION AREAS

TYPICAL SIGN SUPPORTS

Other type of portable or temporary sign supports may be used with approval of the ENGINEER

FIXED SUPPORTS

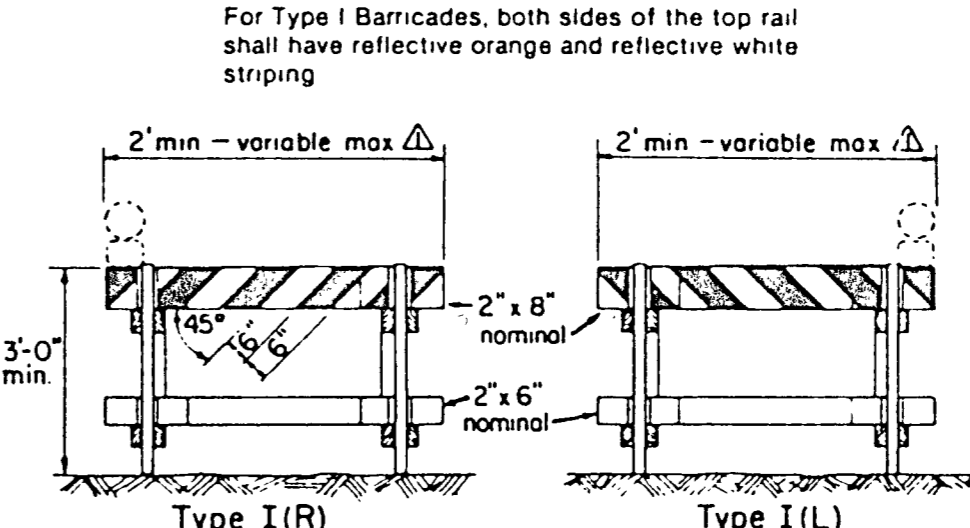
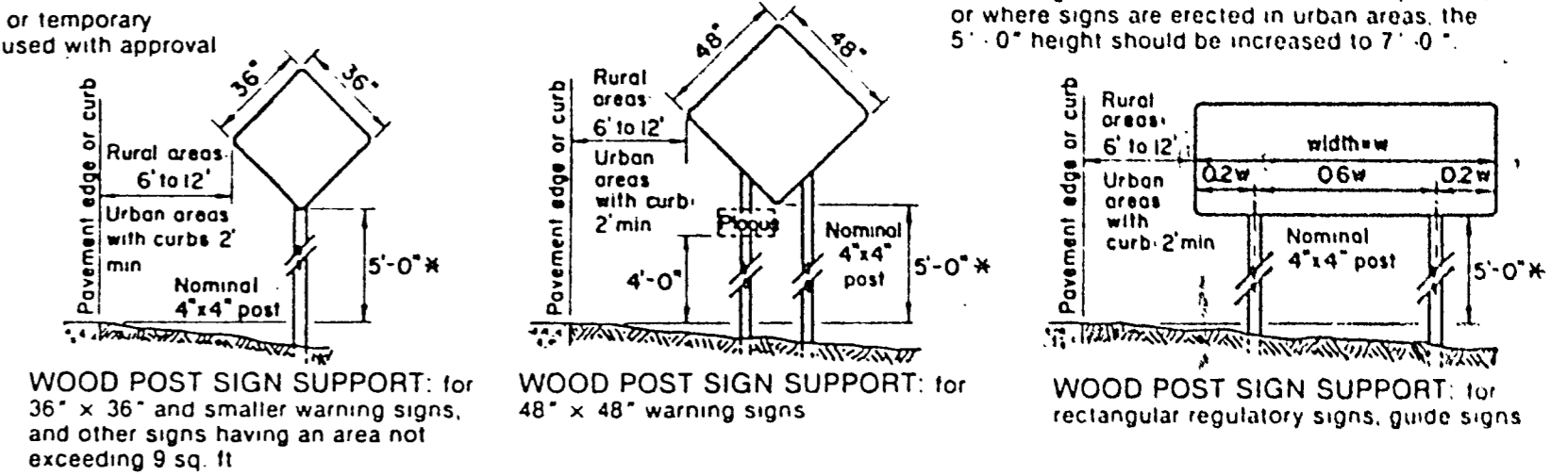

TYPICAL BARRICADES

TEMPORARY SUPPORTS

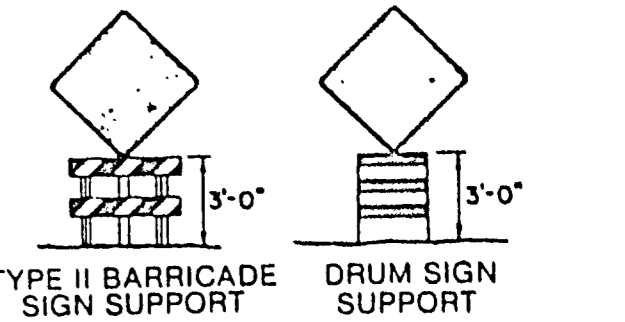

PORTABLE SUPPORTS

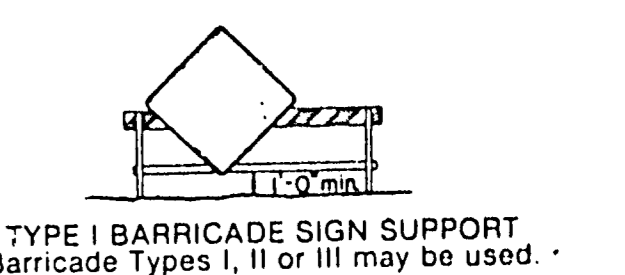

| REVISIONS | | | |
|-----------|-------------|------|----|
| NO. | DESCRIPTION | DATE | BY |
| | | | |
| | | | |

DUNAWAY ASSOCIATES, INC.

DeShazo, Starek, & Tang, Inc.
ENGINEERS • PLANNERS
330 Union Station
Dallas, Texas 75202-4802
(214) 748-6740
Fax: (214) 748-7037

DESIGN BY: BDJ
DRAWN BY: BBP
CHECKED BY: BDJ
APPROVED BY: _____

DATE: 3-11-92
DATE: 3-11-92
DATE: 3-11-92
DATE: _____

55-92

TYPICAL CONSTRUCTION LAYOUTS FOR TRAFFIC SIGNAL INSTALLATIONS

Scale: NONE

SHEET 19 OF 19
91268-19