

CONDUIT & CABLE QUANTITIES (PROPOSED)											
FROM	TO	DISTANCE	PVC CONDUIT T-TRENCH P-PUSH	CABLE							
				SWITCHING	DETECTOR		GRD		LOOP		PWR
				12C	7C	7C	2C	3C	1C	3C	
					7C	7C	2C	3C	1C	3C	
③	PB4	10'				25					
	PB9	PB4	15'	1-2" T			50			440	
	PB4	PB3	105'			115	230				
②	PB3	10'				25					
	PB3	PB2	50'			120	120				
	PB2	⑤	10'	1-2" T		25			25		
	PB2	PB1	40'			80	160	160		80	
①	PB1	6'				21					
	PB1	⊗	22'			32	96	64		32	
	⊗	PB6	8'			18	18	18	18	476	
	PB6	PB7	53'			63	63	63	63		
	PB7	④	5'	1-3" T		20	20	20	20		
TOTALS					101	137	663	642	101	238	916

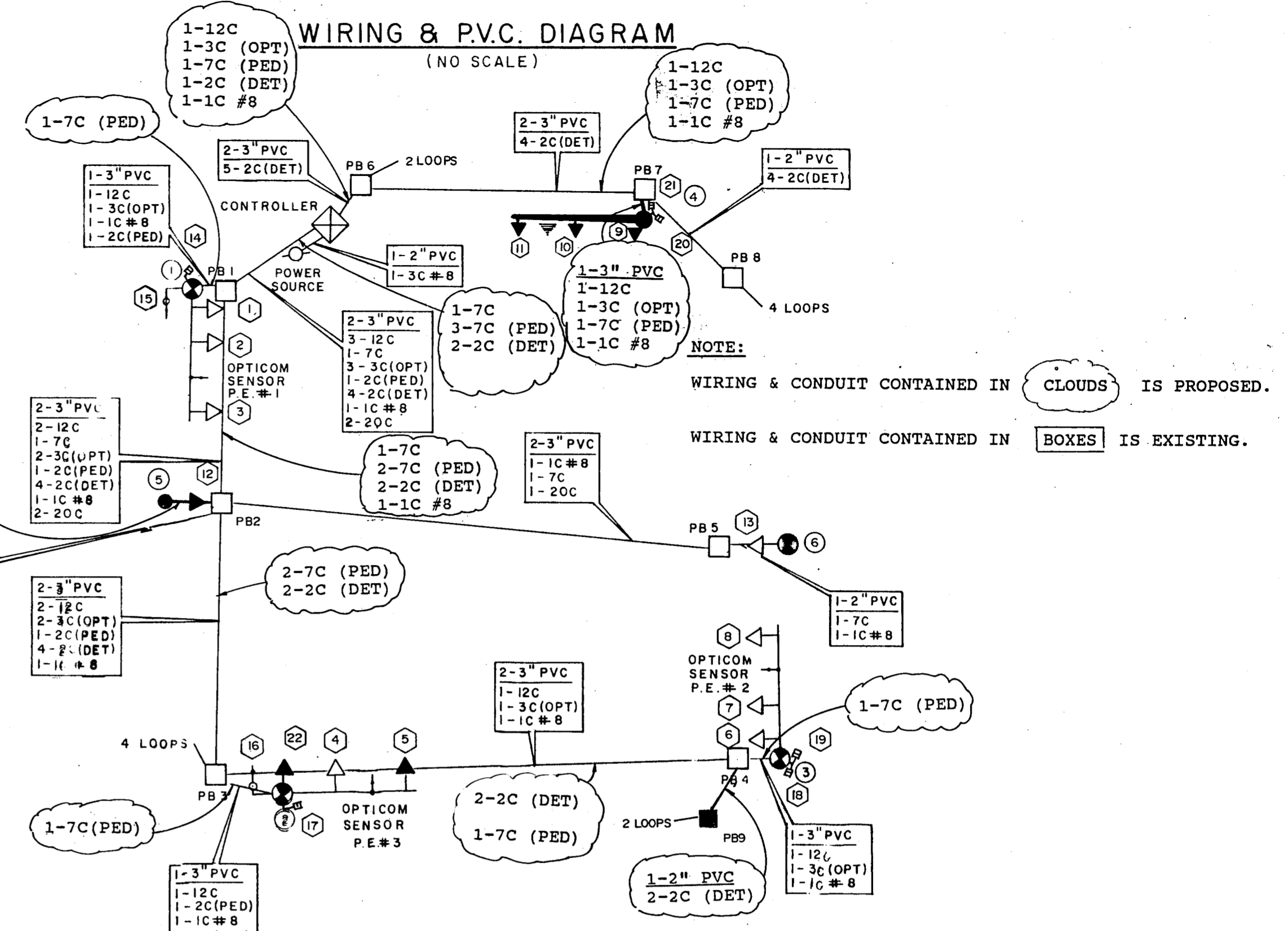

NOTE: SPLICE 20C CABLE TO EXISTING INTERCONNECT IN MEDIAN PULL BOX NOTIFY ROBIN JONES, TOWN OF ADDISON, 214-450-7244 48 HRS. PRIOR TO SPLICE SPLICE TO BE INDIVIDUALLY SOLDERED & CAST IN SCOTCHCAST RESIN.

NOTE: WIRING & CONDUIT CONTAINED IN CLOUDS IS PROPOSED. WIRING & CONDUIT CONTAINED IN BOXES IS EXISTING.

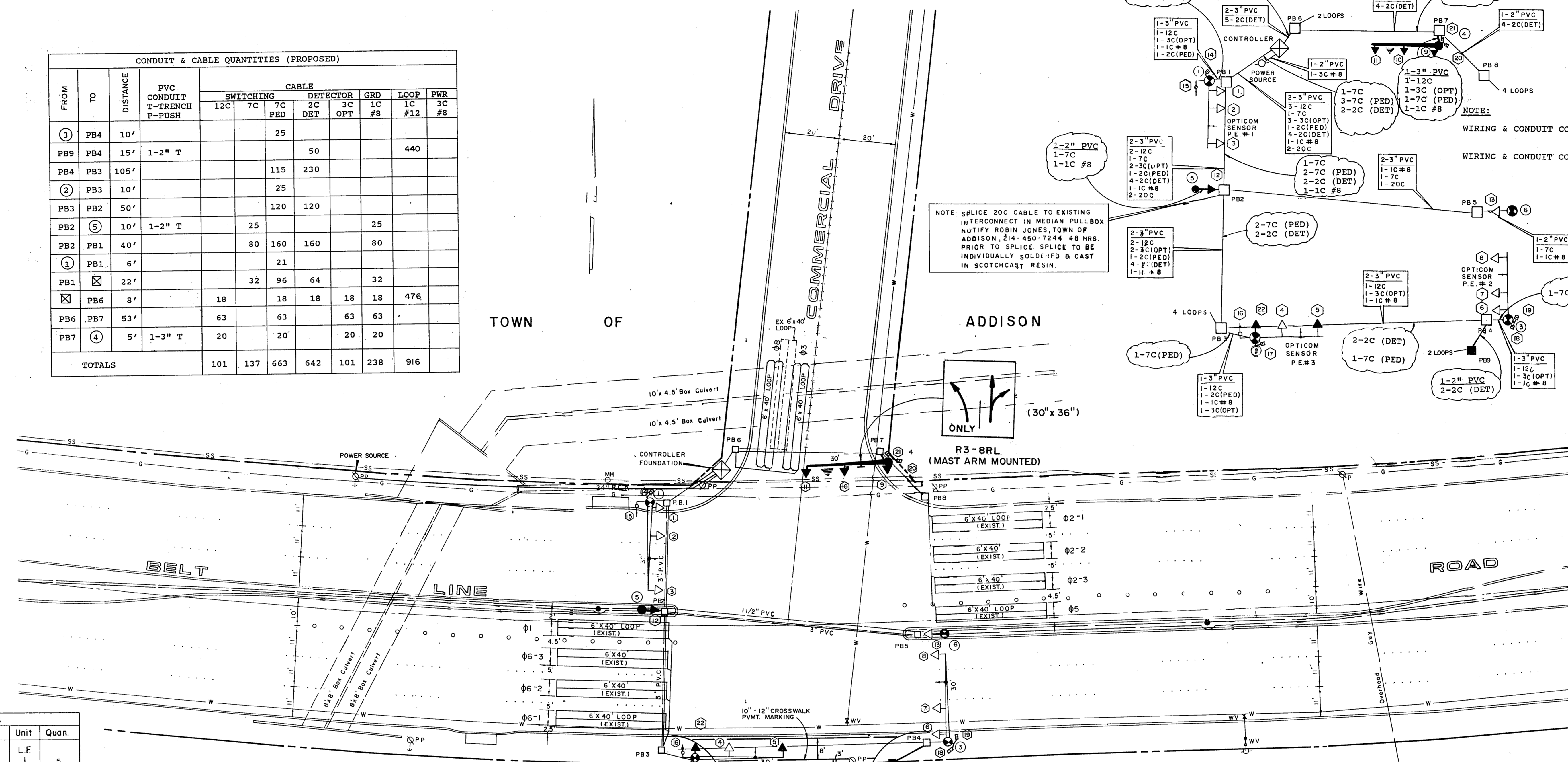

QUANTITIES		
ITEM	Unit	Quan.
CONDUIT: 1-3" PVC TRENCH 1-2" PVC TRENCH	L.F.	5 25
PULL BOX	Ea.	1
3M OPTICOM DETECTOR OPTICAL AMPLIFIER	Ea.	1 1
PEDESTRIAN PUSH BUTTON w/ INTEGRAL SIGN LOOP DETECTOR AMPLIFIER	Ea.	6 3
CABLE-WIRE:	L.F.	
12 CONDUCTOR #12		101
7 CONDUCTOR #12		137
7 CONDUCTOR #12 (PED)		663
2 CONDUCTOR (DET)		642
3 CONDUCTOR (OPTICOM)		101
1 CONDUCTOR #8 (GROUND)		238
THHN DETECTOR LOOP(1c#12)	L.F.	788
FOUNDATIONS: CONTROLLER TYPE 30-A 24-A	Ea.	1 1
POLES: SIGNAL PEDESTAL MAST ARM POLE w/30' ARM	Ea.	1 1
SIGNAL HEADS: 4 SECTION 12" LENS 3 SECTION " " " 1 SECTION PEDESTRIAN	Ea.	3 2 6

NOTE TO CONTRACTOR:
1. PRIOR TO BEGINNING ANY CONSTRUCTION IN ADDISON, NOTIFY ROBIN JONES, DIRECTOR OF STREETS # 450-7244 AND DON PREECE, DIRECTOR OF UTILITIES # 450-72

SIGNAL FACES (PROPOSED)				
HEAD NUMBERS	9,10,22	5,11,12	14,17,18	19,20,21
LENS SIZE	12"	12"	-	-
TYPE	CONV.	CONV.	PED.	PED.
LENS CONFIGURATION	R V G	R V G	DW/W	DW/W
TOTAL NO. OF UNITS	2	3		6

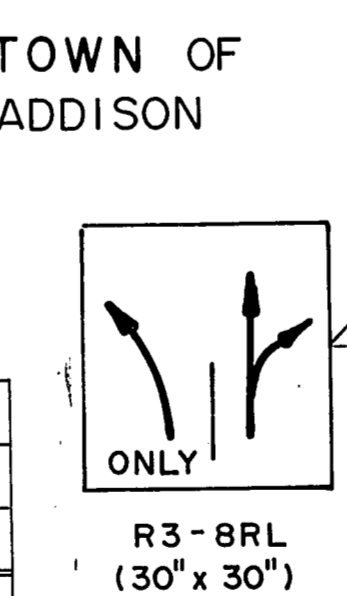

- ⑤ INSTALL PEDESTAL SIGNAL POLE
- ④ 30' INSTALL SIGNAL MAST ARM & POLE
- ③ EXIST. SIGNAL MAST ARM & POLE
- ② INSTALL TRAFFIC SIGNAL HEAD
- ① EXIST. TRAFFIC SIGNAL HEAD
- ⑦ INSTALL PEDESTRIAN PUSH BUTTON & ILLUMINATED SIGN
- ⑥ EXIST. PEDESTRIAN PUSH BUTTON & ILLUMINATED SIGN
- ⑩ INSTALL OPTICOM DETECTOR ONE DIRECTION
- ⑧ EXIST. OPTICOM DETECTOR ONE DIRECTION
- ⑨ INSTALL SIGNAL PULLBOX
- ⑪ EXIST. SIGNAL PULLBOX
- ⑫ EXIST. CONTROLLER & FOUNDATION
- ⑬ POWER POLE SERVICE SOURCE
- ⑭ INSTALL PVC CONDUIT
- ⑮ EXISTING U.G. UTILITIES
- ⑯ STORM SEWER
- ⑰ EXIST. PVC CONDUIT

NOTE 1. ALL PAVEMENT MARKINGS & SIGNS REQUIRED WITH THIS INSTALLATION TO MEET M.U.T.C.D. STANDARDS.
2. THE EXISTING 3 SECTION SIGNAL HEAD AT LOCATION ③ IS TO BE RELOCATED FOR USE AS POLE MOUNTED SIGNAL AT LOCATION ②②

AS BUILTS
I CERTIFY THIS PROJECT WAS CONSTRUCTED IN GENERAL CONFORMANCE WITH THESE CONSTRUCTION PLANS AND WILL FUNCTION AS DESIGNED.
01/16/93

TRAFFIC SIGNAL INSTALLATION						
COMMERCIAL DR. AT BELTLINE ROAD						
TOWN OF ADDISON, TEXAS						
LAWRENCE A. CATES & ASSOC. CONSULTING ENGINEERS DALLAS, TEXAS						
DESIGN	DRAWN	DATE	SCALE	NOTES	FILE	NO.
L.A.C.	L.A.C.	8/24/92	1"=20'			TI