

CURVE TABLE				TABLE			
NO.	DELTA	RADIUS	LENGTH	NO.	DELTA	RADIUS	LENGTH
45	03° 17' 40"	1802.0'	103.61'	51	02° 49' 32"	1768.34'	87.21'
46	03° 15' 00"	1802.0'	102.22'	52	02° 46' 07"	1735.34'	83.85'
47	00° 47' 52"	1835.0'	25.55'	53	02° 52' 18"	1801.34'	90.28'
48	13° 17' 15"	300.0'	69.57'				
49	12° 38' 05"	300.0'	66.16'				
50	02° 49' 32"	1768.34'	87.21'				

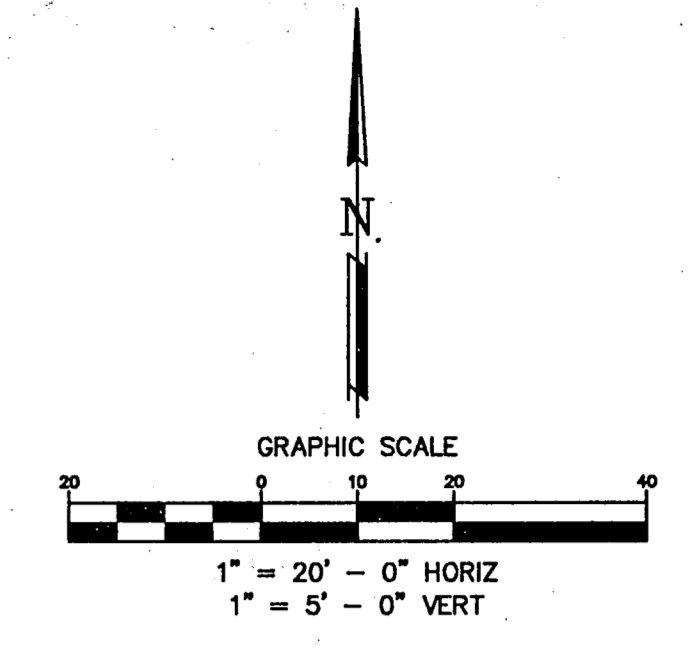
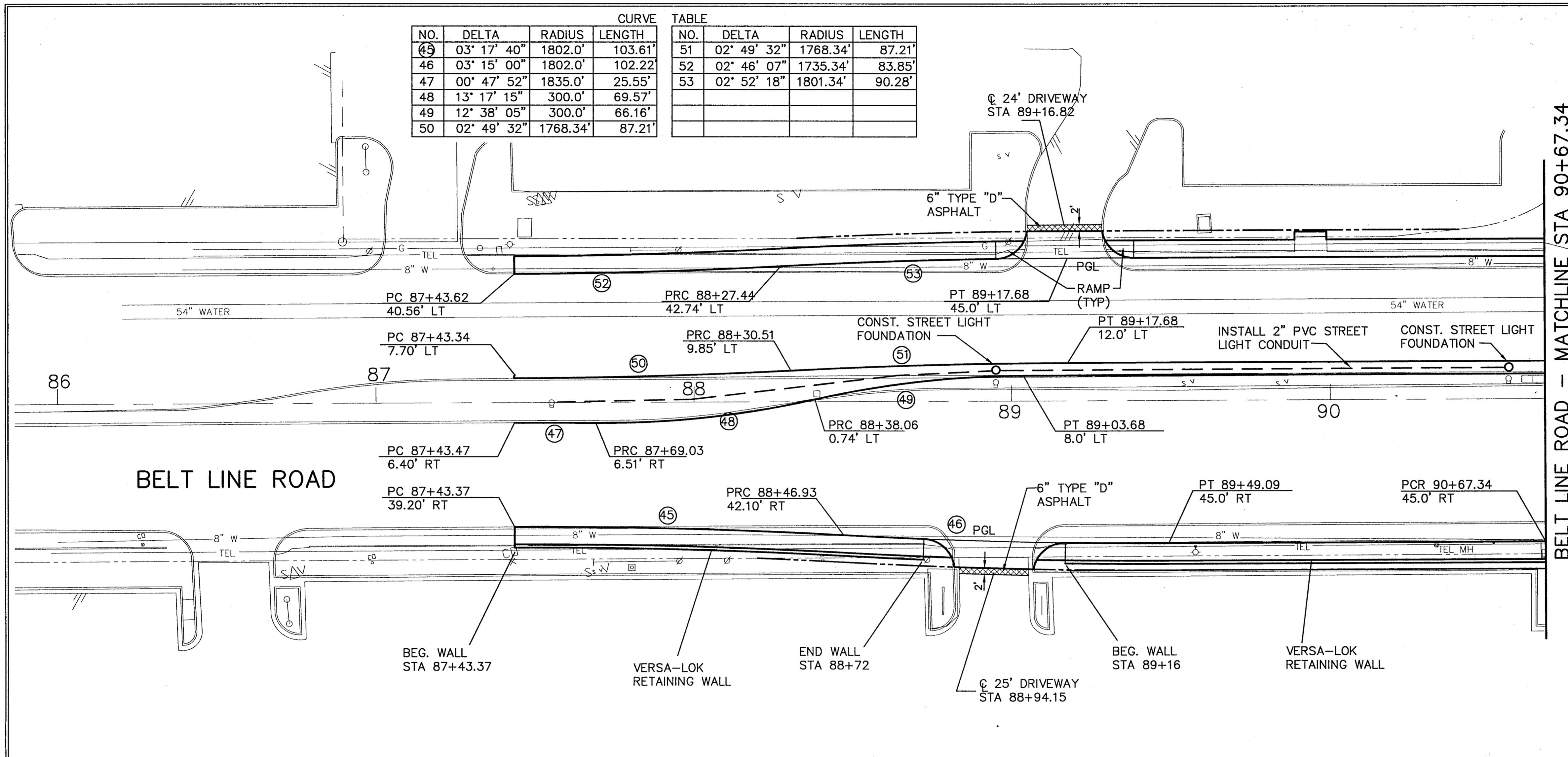

- LEGEND :
- PGL PROFILE GRADE LINE
 - PC POINT OF CURVATURE
 - PT POINT OF TANGENCY
 - PRC POINT OF REVERSE CURVE
 - PCR POINT OF COMPOUND CURVE
 - EX EXISTING
 - RT RIGHT
 - LT LEFT
 - BARRIER FREE RAMP

BENCHMARK :
 " □ " CUT ON CONCRETE WALK AT THE SOUTHEAST CORNER OF THE CONTAINER STORE AT 4939 BELT LINE ROAD.
 ELEV. 644.48

- NOTES :
1. ALL DRIVEWAY RADII SHALL BE 10' UNLESS NOTES OTHERWISE.
 2. BARRIER FREE RAMPS SHALL BE CONSTRUCTED AT ALL DRIVEWAYS AND STREET INTERSECTIONS. SEE PLANS FOR LOCATIONS.
 3. SEE SHEET FOR DRIVEWAY PROFILES.

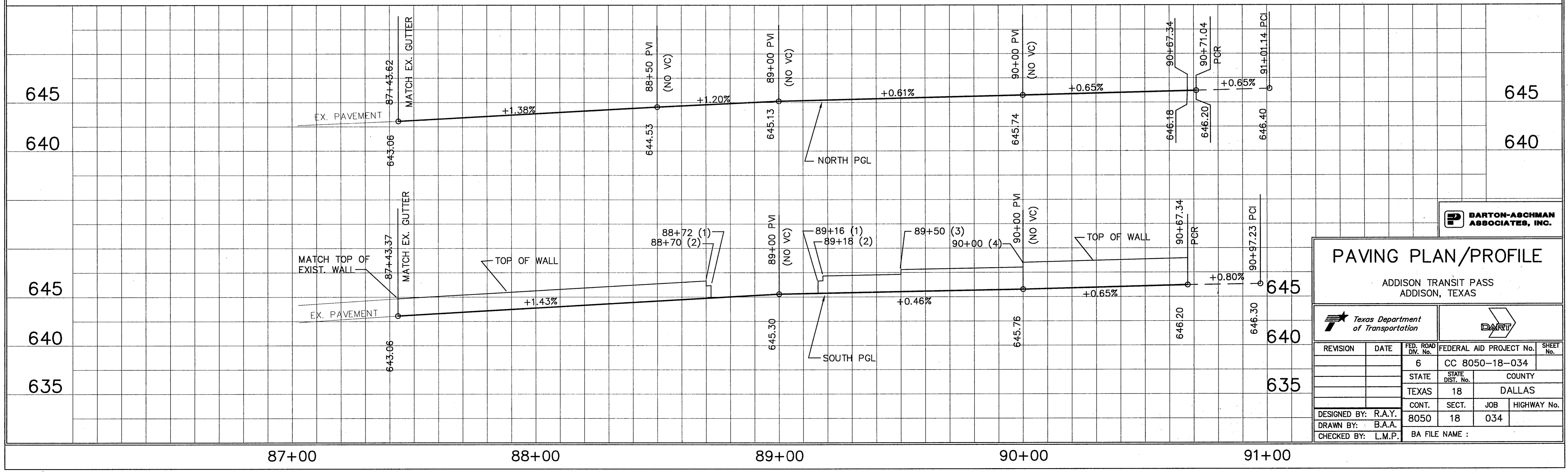

BARTON-ASCHMAN ASSOCIATES, INC.

PAVING PLAN/PROFILE

ADDISON TRANSIT PASS
 ADDISON, TEXAS

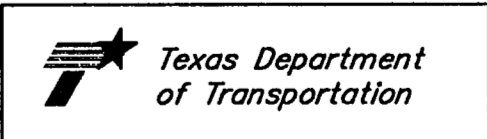

REVISION	DATE	FED. ROAD DIV. No.	FEDERAL AID PROJECT No.	SHEET No.
		6	CC 8050-18-034	
		STATE	COUNTY	
		TEXAS	DALLAS	
		CONT.	SECT.	JOB
		8050	18	034
DESIGNED BY:	R.A.Y.			
DRAWN BY:	B.A.A.			
CHECKED BY:	L.M.P.			
BA FILE NAME :				