

| CURVE TABLE | | | | CURVE TABLE | | | |
|-------------|-------------|--------|---------|-------------|-------------|---------|--------|
| NO. | DELTA | RADIUS | LENGTH | NO. | DELTA | RADIUS | LENGTH |
| 68 | 07° 53' 15" | 900.0' | 123.90' | 74 | 85° 34' 56" | 6.0' | 8.96' |
| 69 | 07° 49' 47" | 900.0' | 122.99' | 75 | 18° 51' 32" | 201.90' | 66.46' |
| 70 | 15° 22' 42" | 250.0' | 67.10' | 76 | 18° 51' 32" | 201.90' | 66.46' |
| 71 | 08° 33' 44" | 250.0' | 37.36' | 77 | 10° 45' 20" | 250.0' | 46.93' |
| 72 | 01° 04' 17" | 868.0' | 16.23' | 78 | 10° 37' 13" | 250.0' | 46.38' |
| 73 | 03° 21' 55" | 932.0' | 54.74' | | | | |

BENCHMARK:
 " □ " CUT ON THE BACK OF CURB ON THE SOUTH NOSE OF MEDIAN CENTERLINE OF QUORUM DRIVE APPROX. 275' SOUTH OF THE INTERSECTION OF ARAPAHO ROAD AND QUORUM DRIVE.

ELEV. 631.76

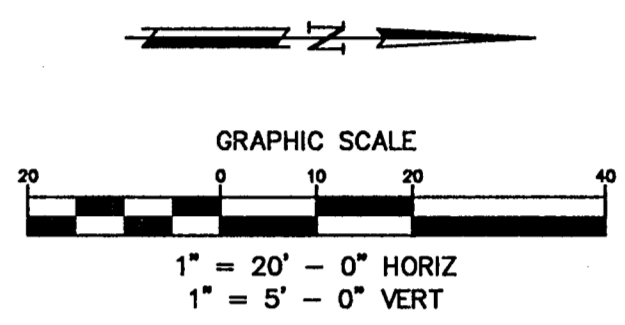

- LEGEND :
- PGL PROFILE GRADE LINE
 - PC POINT OF CURVATURE
 - PT POINT OF TANGENCY
 - PRC POINT OF REVERSE CURVE
 - PCC POINT OF COMPOUND CURVE
 - PCR POINT OF CURB RETURN
 - EX EXISTING
 - RT RIGHT
 - LT LEFT
 - BARRIER FREE RAMP

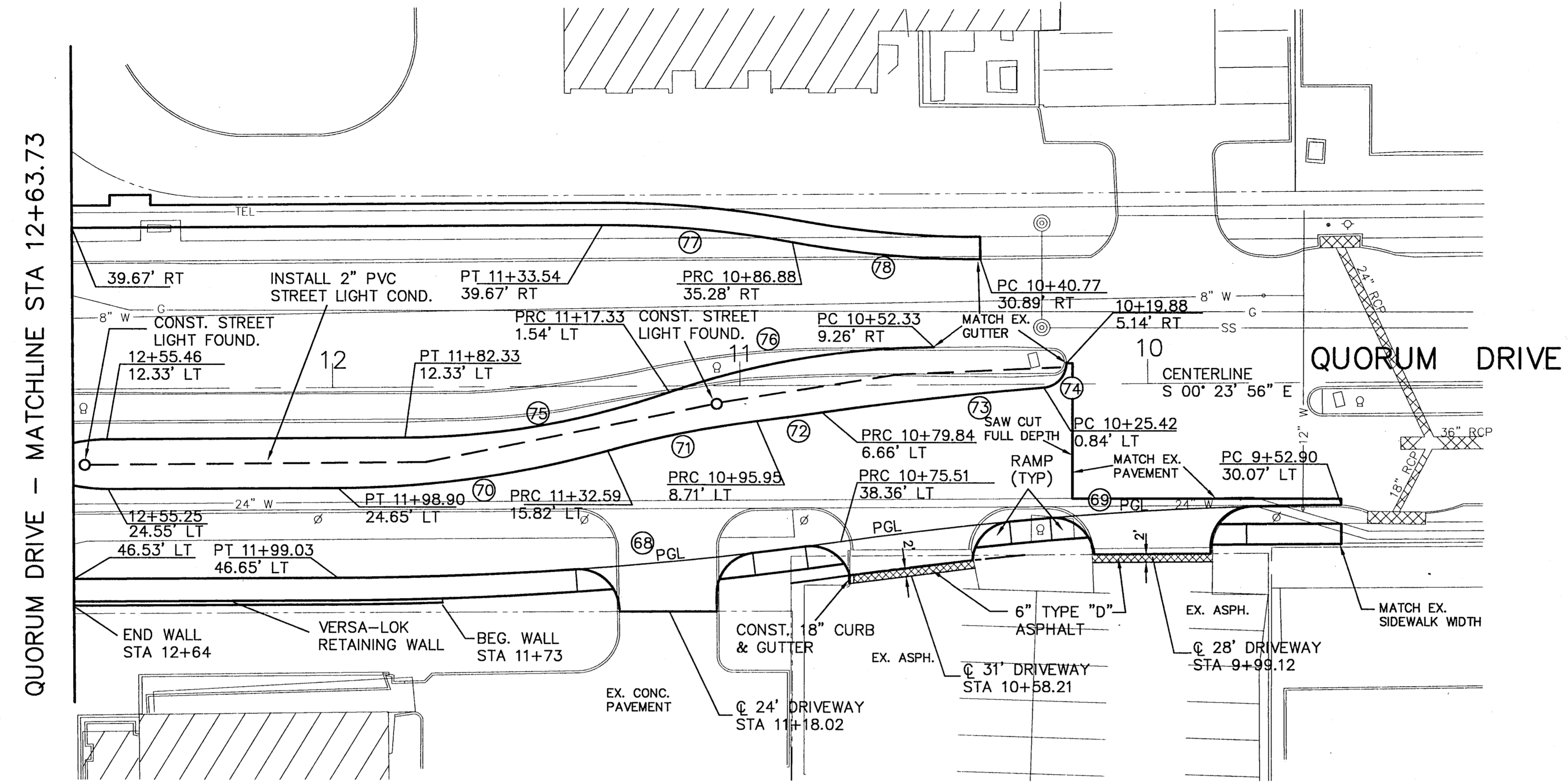

- NOTES :
- ALL DRIVEWAY RADII SHALL BE 10' UNLESS NOTES OTHERWISE.
 - BARRIER FREE RAMPS SHALL BE CONSTRUCTED AT ALL DRIVEWAYS AND STREET INTERSECTIONS. SEE PLANS FOR LOCATIONS.
 - SEE SHEET FOR DRIVEWAY PROFILES.

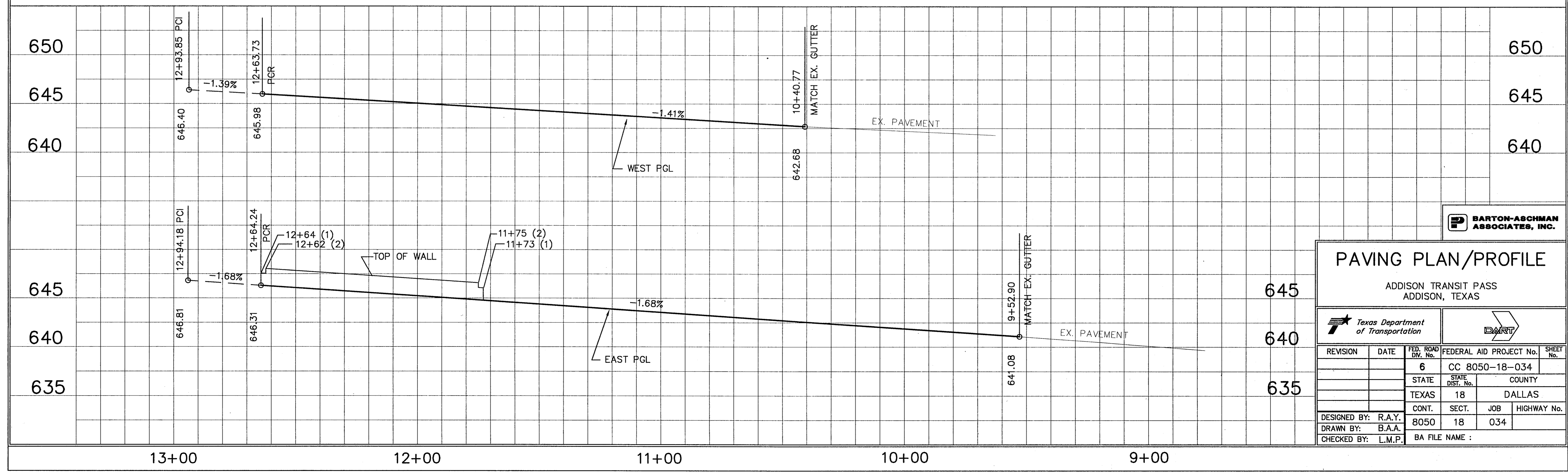

BARTON-ASCHMAN ASSOCIATES, INC.

PAVING PLAN/PROFILE

ADDISON TRANSIT PASS
ADDISON, TEXAS



| REVISION | DATE | FED. ROAD DIV. No. | FEDERAL AID PROJECT No. | SHEET No. |
|----------|------|--------------------|-------------------------|-----------------|
| | | 6 | CC 8050-18-034 | |
| | | STATE | STATE DIST. No. | COUNTY |
| | | TEXAS | 18 | DALLAS |
| | | CONT. | SECT. | JOB HIGHWAY No. |
| | | 8050 | 18 | 034 |

DESIGNED BY: R.A.Y.
 DRAWN BY: B.A.A.
 CHECKED BY: L.M.P.

BA FILE NAME :