

CURVE TABLE				CURVE TABLE			
NO.	DELTA	RADIUS	LENGTH	NO.	DELTA	RADIUS	LENGTH
79	23° 46' 13"	700.0'	290.41'	84	12° 38' 33"	824.0'	181.82'
80		1875.55'		85	88° 58' 02"	15.0'	23.29'
81	19° 08' 56"	800.0'	267.37'	86	78° 32' 56"	25.0'	34.27'
82	15° 50' 31"	300.0'	82.95'	87	12° 07' 52"	250.0'	52.93'
83	07° 22' 04"	250.0'	32.15'	88	19° 54' 15"	250.0'	86.85'

- LEGEND :
- PGL PROFILE GRADE LINE
 - PC POINT OF CURVATURE
 - PT POINT OF TANGENCY
 - PRC POINT OF REVERSE CURVE
 - PCC POINT OF COMPOUND CURVE
 - PCR POINT OF CURB RETURN
 - EX EXISTING
 - RT RIGHT
 - LT LEFT
 - BARRIER FREE RAMP

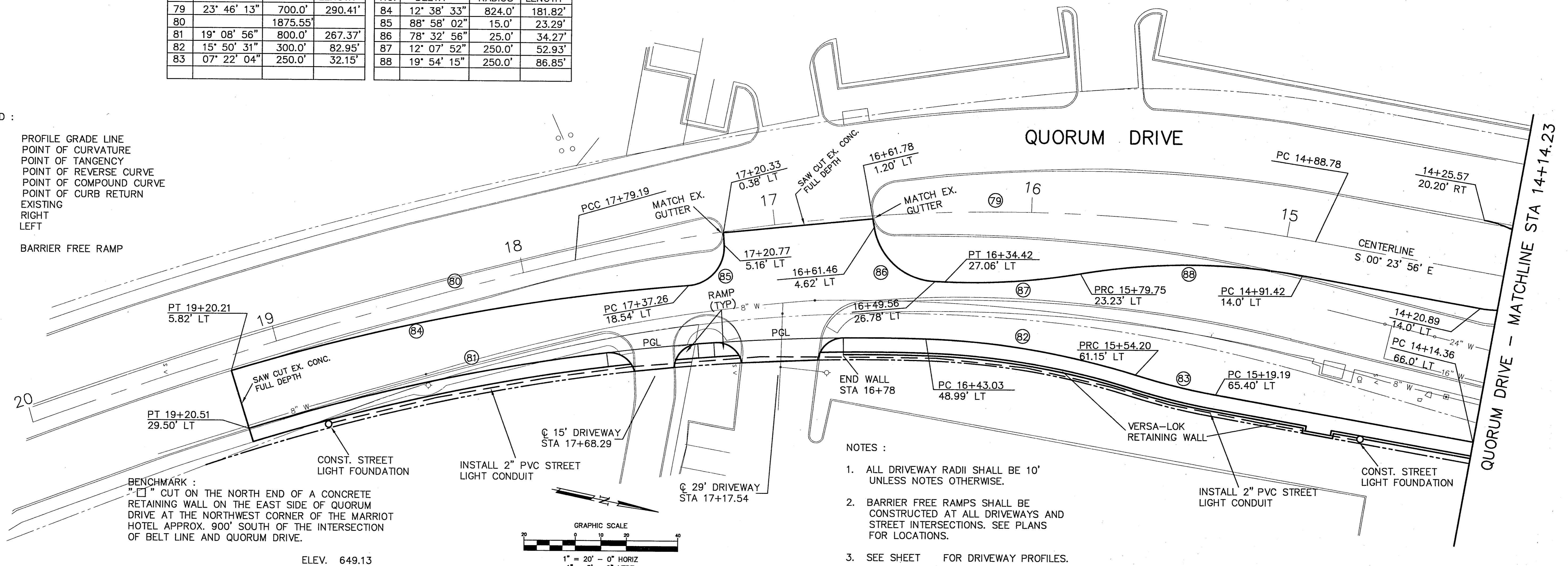

- NOTES :
1. ALL DRIVEWAY RADII SHALL BE 10' UNLESS NOTES OTHERWISE.
 2. BARRIER FREE RAMP SHALL BE CONSTRUCTED AT ALL DRIVEWAYS AND STREET INTERSECTIONS. SEE PLANS FOR LOCATIONS.
 3. SEE SHEET FOR DRIVEWAY PROFILES.

BENCHMARK :
 "X" CUT ON THE NORTH END OF A CONCRETE RETAINING WALL ON THE EAST SIDE OF QUORUM DRIVE AT THE NORTHWEST CORNER OF THE MARRIOTT HOTEL APPROX. 900' SOUTH OF THE INTERSECTION OF BELT LINE AND QUORUM DRIVE.

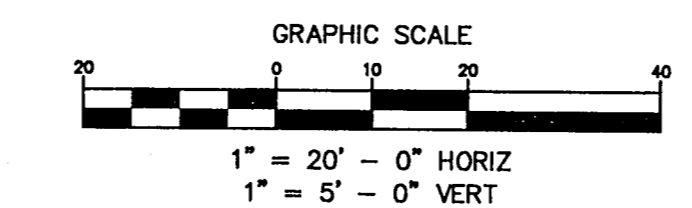

ELEV. 649.13

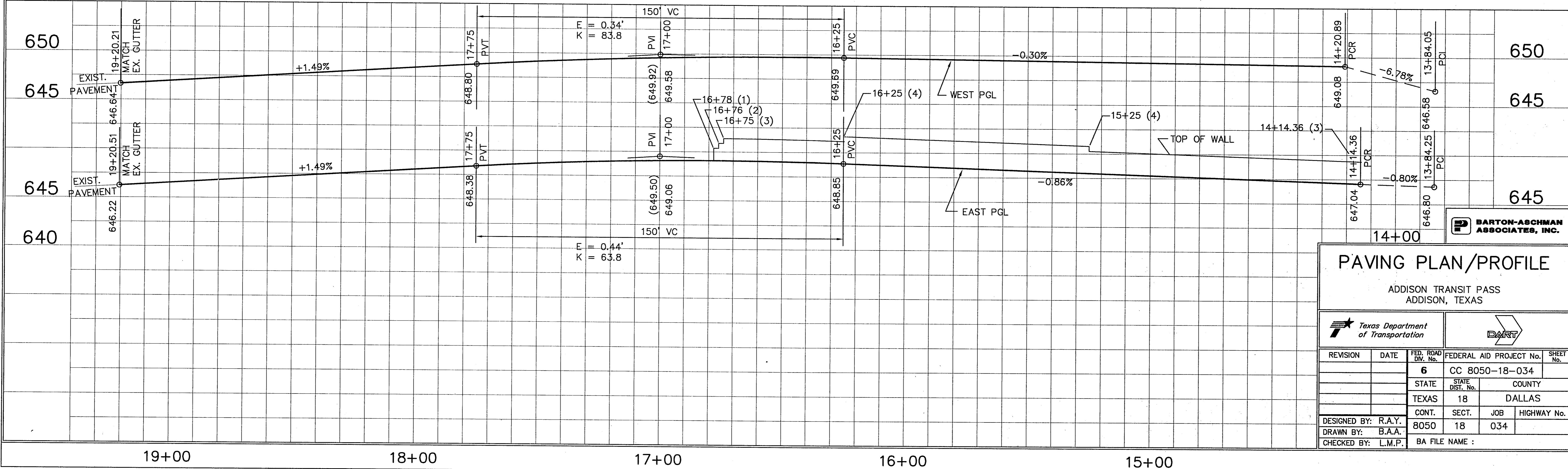

PAVING PLAN/PROFILE
 ADDISON TRANSIT PASS
 ADDISON, TEXAS

Texas Department of Transportation		DART	
REVISION	DATE	FED. ROAD DIST. No.	FEDERAL AID PROJECT No.
		6	CC 8050-18-034
		STATE	COUNTY
		TEXAS	DALLAS
		CONT.	SECT.
		8050	18
		JOB	HIGHWAY No.
		034	
DESIGNED BY:	R.A.Y.	BA FILE NAME :	
DRAWN BY:	B.A.A.		
CHECKED BY:	L.M.P.		

10/14/04
 10/14/04