

- GENERAL NOTES:
- All Water Mains shall be Class 200 Cast Iron Pipe and shall have a minimum cover of 4' below ground or approved street grade.
  - Due to soil resistivity readings of less than 1500 OHMS per cc., all C.I. Water Pipe shall have 5 mil. thickness Polyethylene Tube Wrap.
  - 1 1/2" Copper Water Service shall be installed at location shown.
  - San. Service shall be 6" Vitrified Clay Tile.

BENCH MARK:  
 [ ] Cut on West Headwall 4'x2.25' Conc. Culvert under Noell Road, 1040'± NW of Celestial Road. Elev. 602.11

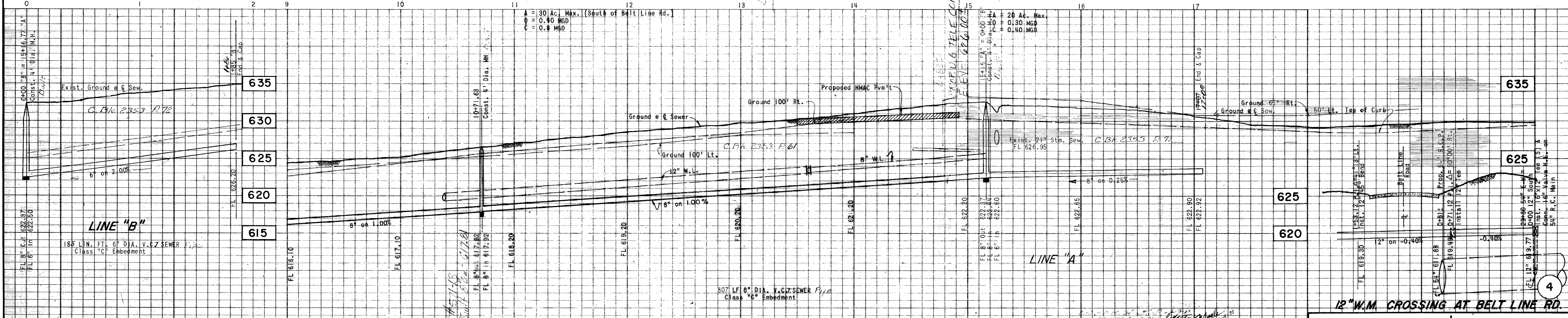

PROJECT: _____	PROJECT: _____
DESIGN BY <i>Walter F. Albritton</i> DATE 10-9-70	DESIGN BY <i>Walter F. Albritton</i> DATE 10-9-70
R.O.W. APPROVED <i>John R. Pank</i> DATE 4-23-71	R.O.W. APPROVED <i>John R. Pank</i> DATE 11-17-70
ENGINEER OF DESIGN <i>Walter F. Albritton</i> DATE 4-23-71	ENGINEER OF DESIGN <i>Walter F. Albritton</i> DATE 11-17-70
CONTRACT NO. 71-98-P-CULLUM-4-12-71	CONTRACT NO. 70-217-P-CULLUM-11-17-70

DEVELOPER  
**MOBIL OIL COMPANY**  
 P.O. BOX 22225 DALLAS, TEXAS 75222 Ph. 330-9283

**ALBRITTON & ASSOCIATES, INC.**  
 CONSULTING ENGINEERS  
 404 UCC BLDG. 741-4884  
 DALLAS, TEXAS 75207

BY *Walter F. Albritton P.E.*

**PROPOSED SANITARY SEWER**  
**NOELL ROAD AND**  
**BELT LINE ROAD**  
**DALLAS WATER UTILITIES DEPT.**  
**CITY OF DALLAS, TEXAS**

DESIGN	DRAWN	DATE	SCALE	NOTES	FILE	NO.
D.E.W.	G.C.B.	AUG, 70	Horiz. 1"=40' Vert. 1"=6'		411 Q	1960