

MATCH LINE SHEET 1 OF 10

MATCH LINE SEE ABOVE RIGHT

MATCH LINE SEE BELOW LEFT

PLANT REMOVAL NOTES (BY MEDIAN NUMBER)

- (1.5) (ALL PISTACHE TREES ARE TO REMAIN)
WIDE SECTION: REMOVE FEW REMAINING JUNIPERS
- (2.1) WEST NOSE: REMOVE (2) PEAR TREES (6", 7.5" CAL)
EAST NOSE: REMOVE (2) PEAR TREES (7", 8" CAL)
(ALL PISTACHE TREES ARE TO REMAIN)

LEGEND

- EXISTING TRAFFIC SIGNAL POLE
- EXISTING LIGHT POLE
- EXISTING IRRIGATION STATION VALVE BOX
- EXISTING IRRIGATION QUICK COUPLER VALVE BOX
- EXISTING TREE TO REMAIN (CHINESE PISTACHE UNLESS OTHERWISE NOTED)
- EXISTING CONCRETE MEDIAN NOSE
- EXISTING VALVE BOX
- EXISTING MANHOLE
- EXISTING TELEPHONE MANHOLE
- EXISTING IRRIGATION METER
- EXISTING IRRIGATION CONTROLLER
- EXISTING IRRIGATION BACKFLOW ASSEMBLY
- EXISTING IRRIGATION SLEEVE FOR CONTROL WIRES
- EXISTING IRRIGATION WATER MAIN
- ROADWAY LIGHT
- MEDIAN REFERENCE NUMBER
- REMOVE AND REPLACE
- NEW PAVING

MEDIAN PAVING NOTES

LOCATIONS NOTED "REMOVE AND REPLACE" INCLUDE REMOVAL OF EXISTING PAVERS AND BASE AS NEEDED TO REPLACE WITH BRICK PAVING AS DETAILED AND SPECIFIED.

LOCATIONS NOTED "NEW PAVING" INCLUDE PROVIDING BRICK PAVING AS DETAILED AND SPECIFIED.



February 25, 2011

| NO. | DATE | REVISION | APPROV. |
|---|-----------|----------|-----------|
| HNTB ARCHITECTS ENGINEERS PLANNERS The HNTB Companies - TSP# Firm No. 420 2001 BRYAN STREET, SUITE 100 DALLAS, TEXAS 75201 (214) 748-8400 | | | |
| BELT LINE ROAD MEDIAN | | | |
| MARSH LANE TO DALLAS N. TOLLWAY | | | |
| REMOVAL AND LAYOUT PLANS | | | |
| SHEET 2 OF 10 | | | |
| TOWN OF ADDISON, TEXAS | | | |
| DESIGN | AF | DRAWN | BB |
| CHECK | BR | CHECK | TK |
| DATE | 25-Feb-11 | SCALE | HNTB NO. |
| | | | 48564 |
| | | | SHEET NO. |
| | | | 22 |

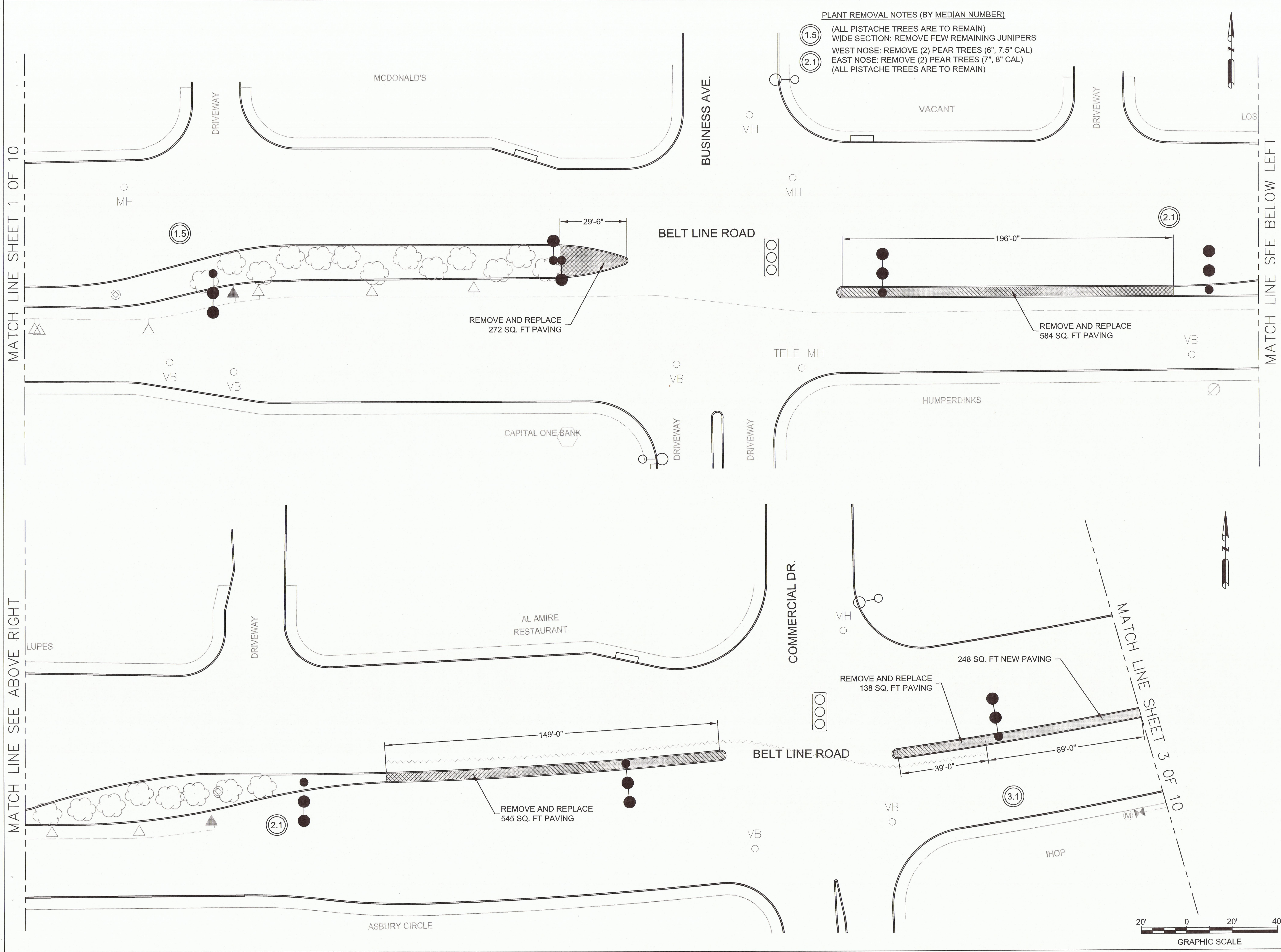
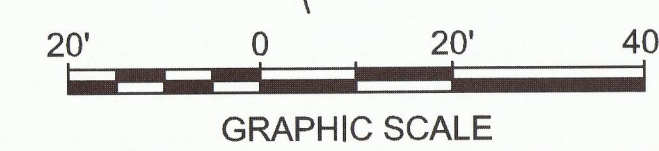

ISSUED FOR CONSTRUCTION - 6/1/11