

**PLANT REMOVAL NOTES (BY MEDIAN NUMBER)**

- (4.2) WEST NOSE: REMOVE (8) CRAPE MYRTLE TREES (8-12' HT)  
EAST NOSE: REMOVE (7) FOSTER TREES (2", 3", 3", 4", 4", 4.5", 4.5" CAL)  
WIDE SECTION: REMOVE ALL JUNIPERS  
(ALL PISTACHE TREES ARE TO REMAIN)
- (5.1) WEST NOSE: REMOVE (6) FOSTER TREES (6", 4.5", 4", 3.5", 4", 3" CAL)  
CENTER SECTION: REMOVE (5) PEAR TREES (9.5", 7.5", 6.5", 9.5", 13.5"),  
LIRIOPE, AND (7) 'GULF STREAM' NANDINA

**LEGEND**

- ⊙ EXISTING TRAFFIC SIGNAL POLE
- ⊙ EXISTING LIGHT POLE
- △ EXISTING IRRIGATION STATION VALVE BOX
- ▲ EXISTING IRRIGATION QUICK COUPLER VALVE BOX
- ☁ EXISTING TREE TO REMAIN (CHINESE PISTACHE UNLESS OTHERWISE NOTED)
- ◐ EXISTING CONCRETE MEDIAN NOSE
- VB EXISTING VALVE BOX
- MH EXISTING MANHOLE
- TELE MH EXISTING TELEPHONE MANHOLE
- Ⓜ EXISTING IRRIGATION METER
- ⓐ EXISTING IRRIGATION CONTROLLER
- ⋈ EXISTING IRRIGATION BACKFLOW ASSEMBLY
- ⋈ EXISTING IRRIGATION SLEEVE FOR CONTROL WIRES
- ⋈ EXISTING IRRIGATION WATER MAIN
- ROADWAY LIGHT
- ①.1 MEDIAN REFERENCE NUMBER
- ▨ REMOVE AND REPLACE
- NEW PAVING

**MEDIAN PAVING NOTES**

LOCATIONS NOTED "REMOVE AND REPLACE" INCLUDE REMOVAL OF EXISTING PAVERS AND BASE AS NEEDED TO REPLACE WITH BRICK PAVING AS DETAILED AND SPECIFIED.

LOCATIONS NOTED "NEW PAVING" INCLUDE PROVIDING BRICK PAVING AS DETAILED AND SPECIFIED.

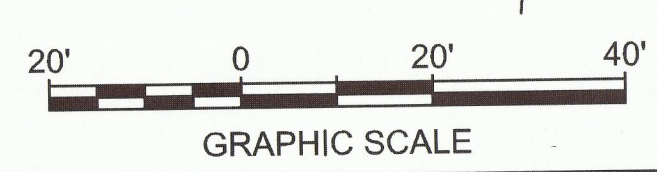
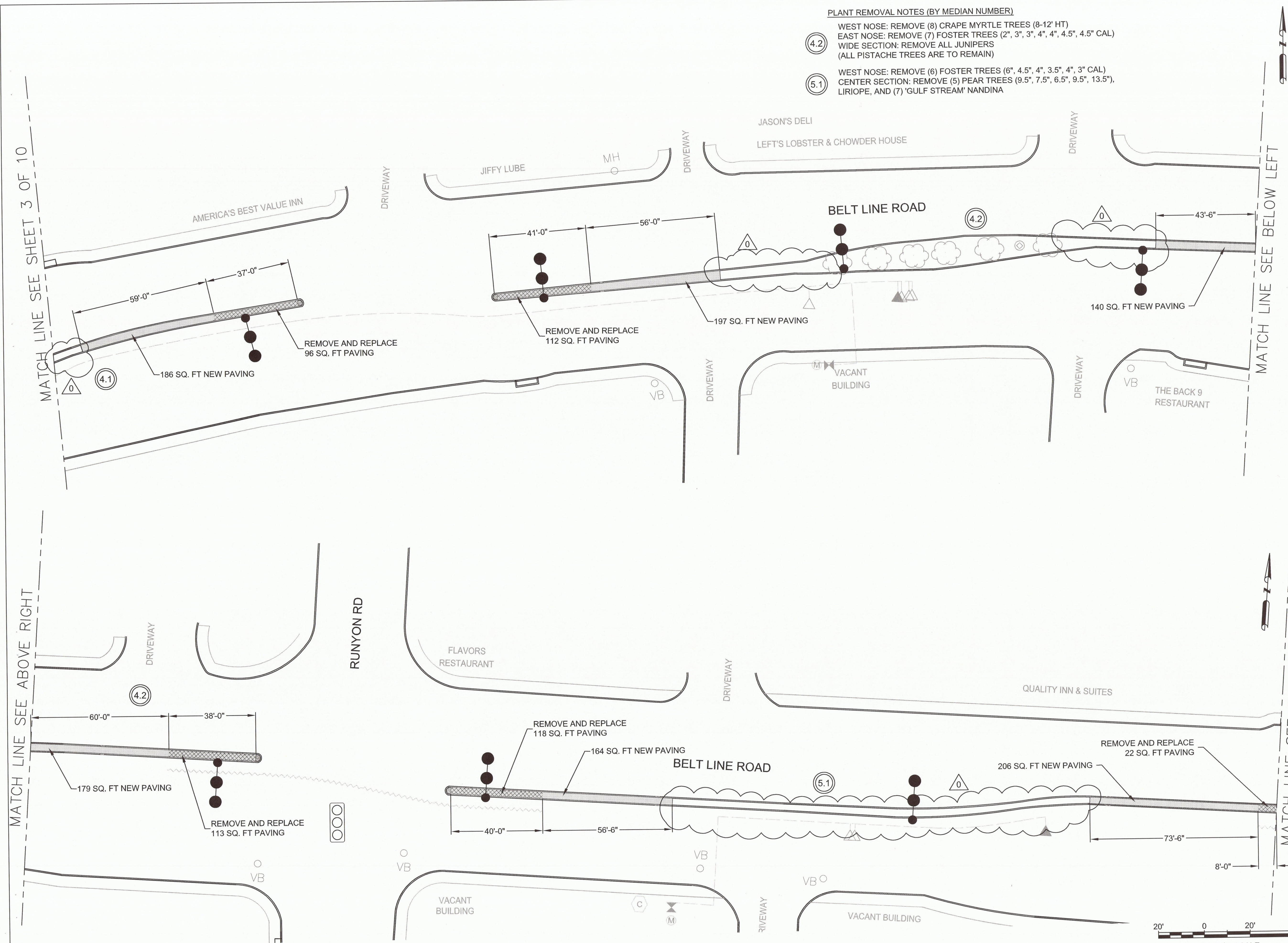

NO.		DATE		REVISION		APPROV.	
Δ	6/1/2011	ADDENDUM 1		TGK			
<b>HNTB</b> ARCHITECTS ENGINEERS PLANNERS The HNTB Companies - TPPE Firm No. 420 2001 BRYAN STREET, SUITE 100 DALLAS, TEXAS 75201 (214) 748-8400							
<b>BELT LINE ROAD MEDIAN</b>							
MARSH LANE TO DALLAS N. TOLLWAY							
REMOVAL AND LAYOUT PLANS							
SHEET 4 OF 10							
<b>TOWN OF ADDISON, TEXAS</b>							
DESIGN	AF	DRAWN	BB	DATE	SCALE	HNTB NO.	SHEET NO.
CHECK	BR	CHECK	TK	25-Feb-11		48564	24

ISSUED FOR CONSTRUCTION - 6/1/11