

- PLANT REMOVAL NOTES (BY MEDIAN NUMBER)
- (7.2) WIDE SECTION: REMOVE ASIAN JASMINE GROUNDCOVER
 - (7.3) WIDE SECTION: REMOVE ASIAN JASMINE GROUNDCOVER
 - (8.1) REMOVE COMPACT NANDINA FROM ENTIRE MEDIAN.

- LEGEND
- ⊙ EXISTING TRAFFIC SIGNAL POLE
 - ⊙ EXISTING LIGHT POLE
 - △ EXISTING IRRIGATION STATION VALVE BOX
 - ▲ EXISTING IRRIGATION QUICK COUPLER VALVE BOX
 - ☁ EXISTING TREE TO REMAIN (CHINESE PISTACHE UNLESS OTHERWISE NOTED)
 - ◐ EXISTING CONCRETE MEDIAN NOSE
 - VB EXISTING VALVE BOX
 - MH EXISTING MANHOLE
 - TELE MH EXISTING TELEPHONE MANHOLE
 - ⊙ EXISTING IRRIGATION METER
 - ⊙ EXISTING IRRIGATION CONTROLLER
 - ⊙ EXISTING IRRIGATION BACKFLOW ASSEMBLY
 - ⊙ EXISTING IRRIGATION SLEEVE FOR CONTROL WIRES
 - ⊙ EXISTING IRRIGATION WATER MAIN
 - ROADWAY LIGHT
 - (1.1) MEDIAN REFERENCE NUMBER
 - ▨ REMOVE AND REPLACE
 - ▨ NEW PAVING

MEDIAN PAVING NOTES

LOCATIONS NOTED "REMOVE AND REPLACE" INCLUDE REMOVAL OF EXISTING PAVERS AND BASE AS NEEDED TO REPLACE WITH BRICK PAVING AS DETAILED AND SPECIFIED.

LOCATIONS NOTED "NEW PAVING" INCLUDE PROVIDING BRICK PAVING AS DETAILED AND SPECIFIED.



February 25, 2011

NO.	DATE	REVISION	APPROV.

HNTB ARCHITECTS ENGINEERS PLANNERS
The HNTB Companies - T&E Firm No. 420
2001 BRYAN STREET, SUITE 100
DALLAS, TEXAS 75201 (214) 748-8400

BELT LINE ROAD MEDIAN
MARSH LANE TO DALLAS N. TOLLWAY
REMOVAL AND LAYOUT PLANS

SHEET 8 OF 10

TOWN OF ADDISON, TEXAS

DESIGN	AF	DRAWN	BB	DATE	SCALE	HNTB NO.	SHEET NO.
CHECK	BR	CHECK	TK	25-Feb-11		48564	28

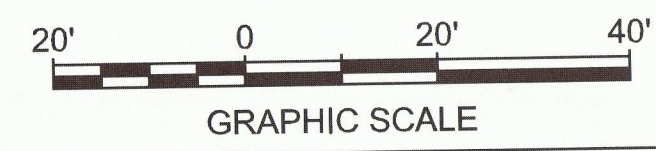
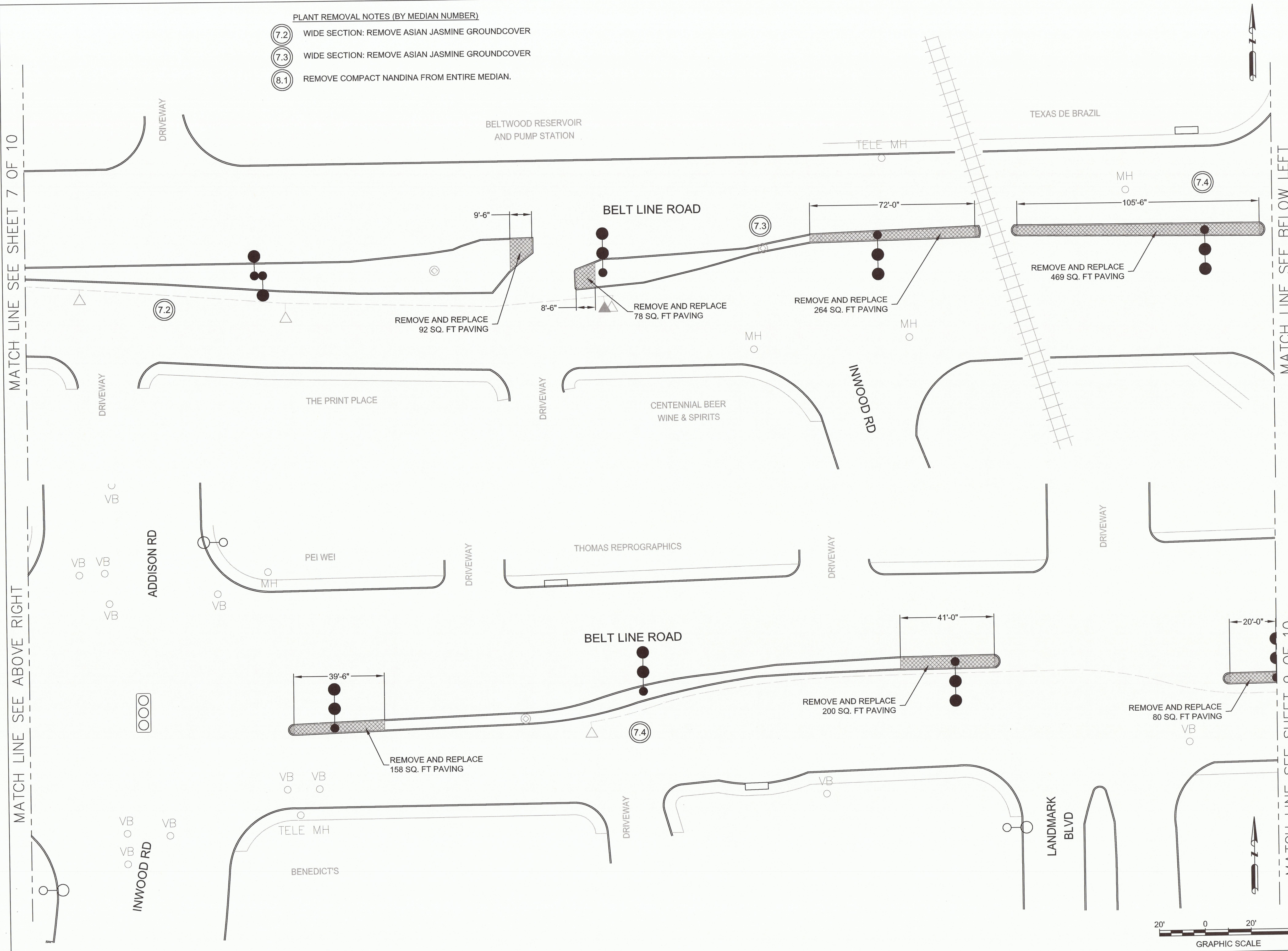

MATCH LINE SEE SHEET 7 OF 10

MATCH LINE SEE ABOVE RIGHT

MATCH LINE SEE BELOW LEFT

MATCH LINE SEE SHEET 9 OF 10

ISSUED FOR CONSTRUCTION - 6/1/11