

NOTES

1. CONTRACTOR SHALL COORDINATE WITH ONCOR UTILITY FOR OBTAINING ELECTRICAL SERVICE AT THE LIGHTING CONTROLLER. CONTRACTOR SHALL FOLLOW ONCOR UTILITIES STANDARDS AND GUIDELINES FOR INSTALLING THE REQUIRED CONDUIT, WIRE, ETC.
2. ALL DIMENSIONS ARE TAKEN FROM THE CENTER OF THE POLE BASE.
3. THE CONTRACTOR SHALL PLACE THE CONTROLLER ON TOWN RIGHT OF WAY.

CIRCUIT SCHEDULE LIGHTING CONTROLLER "B" 120 / 240 VOLTS				
CIRCUIT NO.	WIRE SIZE (AWG)	CONNECTED LOAD (W)	BREAKER SIZE	CONTACTOR SIZE
B1	#4	4656	2P/30A	2P/30A
B2	#4	3275	2P/30A	2P/30A
B3	#4	3725	2P/30A	2P/30A
B4	#4	2794	2P/30A	2P/30A
Total Load:		14.9 KW		

LIGHTING LEGEND

- FUTURE LIGHT POLE
- PROPOSED SINGLE LUMINAIRE ON CURVED 55' RADIUS POLE
- PROPOSED TWIN LUMINAIRE ON CURVED 40' RADIUS POLE
- EXISTING LIGHT POLE TO-BE REMOVED
- TRENCHED CONDUIT
- BORED CONDUIT
- PROPOSED GROUND BOX
- PROPOSED LIGHTING CONTROLLER

- A 1 - 1
- POLE NUMBER
 - CIRCUIT NUMBER
 - CONTROLLER
- (A) 2" C, 2#4, 1#4 BARE GND
 - (B) 2" C, 4#4, 1#4 BARE GND
 - (C) 2-2" C, 8#4, 1#4 BARE GND

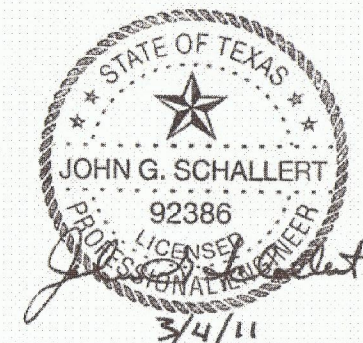
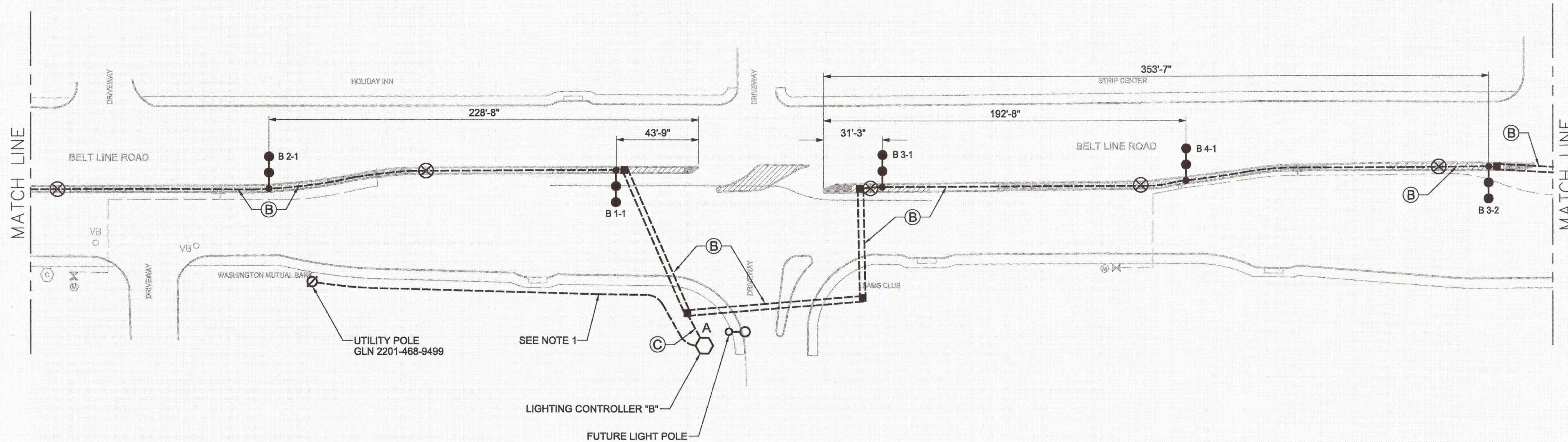

ISSUED FOR CONSTRUCTION - 6/1/11

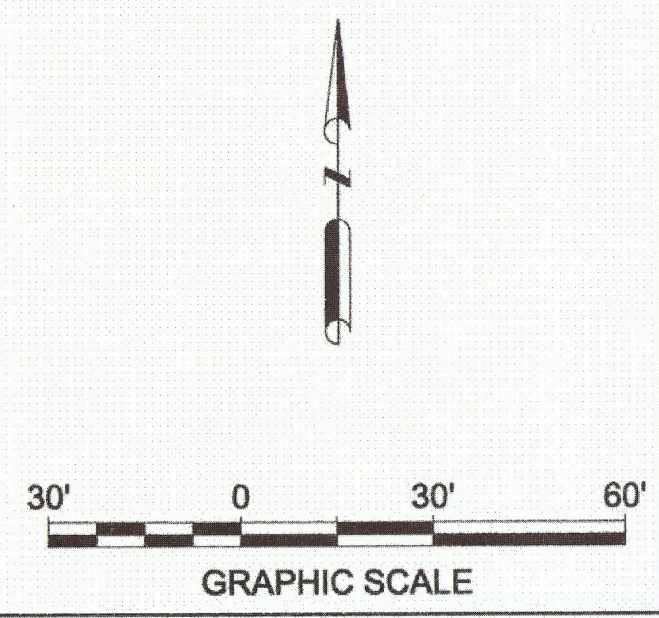

NO.	DATE	REVISION	APPROV.

HNTB ARCHITECTS ENGINEERS PLANNERS
 The HNTB Companies - TBPE Firm No. 420
 2001 BRYAN STREET, SUITE 100
 DALLAS, TEXAS 75201 (214) 748-8400

BELT LINE ROAD MEDIAN
MARSH LANE TO DALLAS N. TOLLWAY

ROADWAY LIGHTING PLAN

SHEET 6 OF 19

TOWN OF ADDISON, TEXAS

DESIGN	RS	DRAWN	FH	DATE	SCALE	HNTB NO.	SHEET NO.
CHECK	JS	CHECK	TK	30-Dec-10	1"=30'	48564	7