

THE CITY OF ADDISON AND THE COUNTY OF DALLAS

CONSTRUCTION PLANS FOR:

-BELT LINE ROAD IMPROVEMENTS-
MARSH LANE TO NORTH DALLAS PARKWAY
PROJECT LENGTH: 10,185 FT.

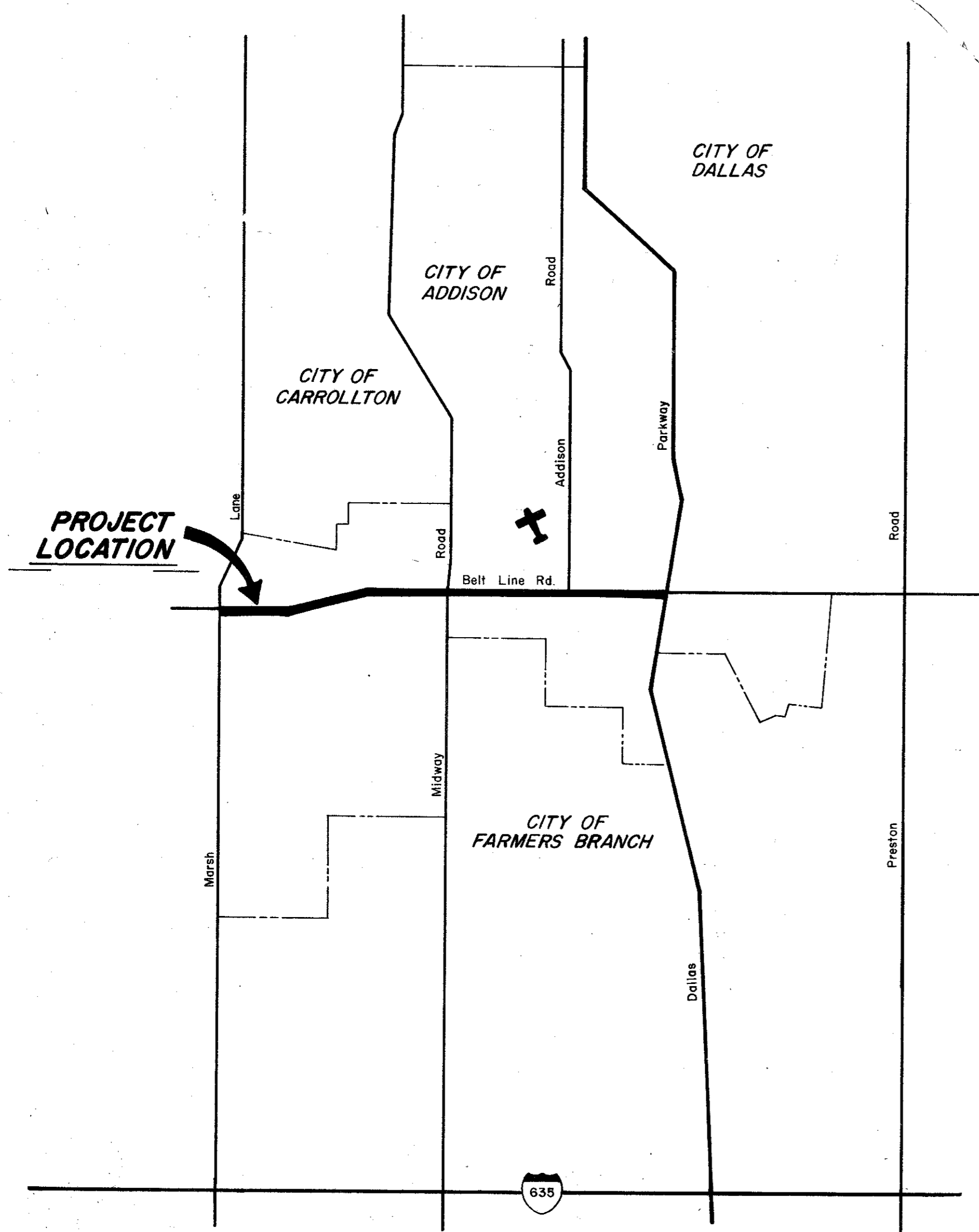

JERRY J. REDDING - MAYOR
COUNCILMEN:
JOHN B. ALLEN
RICHARD RODER
WILLIAM F. SELLMAYER
JACK DINGLER
TERRY ROBERTS
C. J. WEBSTER - CITY ADMINISTRATOR
DON PREECE - DIRECTOR OF PUBLIC WORKS



GINN INC.
CONSULTING ENGINEERS
DALLAS, TEXAS
1980

CITY OF ADDISON
Approved By: *[Signature]*
Mayor
COUNTY OF DALLAS
Approved By: _____
C. Judson Shock P.E.
Director Of Public Works

B17-2
Belt Line Rd. Marsh Ln. to Dallas Pkwy Total 1980
B17-2