

ESTIMATED QUANTITIES			
ITEM	DESCRIPTION	UNIT	QUANTITY
100	Prepare Roadway R.O.W	Sta.	5
104.1	Remove Old Concrete, Pavement & Median	SY	
104.2	Sawed Break-Out Groove	LF	95
110	Unclassified Road Excavation (Dens Cont.)	CY	2344
160	Placing 4\"/>		

LEGEND			
□	Survey Mark		
○	Iron Pin		
○	Monument		
○	Gas Meter		
○	Gas Valve		
○	Gas Line		
○	Power Pole (Typical Pole Symbol)		
○	Power Line		
○	Guy Wire Anchor		
○	Telephone Line		
○	Water Meter		
○	Water Valve		
○	Water Line		
○	Fire Hydrant		
○	Manhole		
○	Sanitary Sewer Line		
○	Fence Line		
○	Flow Direction Indicator		
○	Property or Right-of-Way Line (R.O.W)		
○	Excavation Line		
○	Traffic Post Box		
○	Mark Arm Pole Foundation (Type A or B)		
○	Pedestal Pole Foundation (Type C)		
○	Signal Illumination Pole Foundation (Type D)		
○	Top Of Curb		
○	Flow Line		

R.C.-1	R.C.-2
$\Delta = 6^\circ 28' 33''$	$\Delta = 16^\circ 39' 52''$
$R = 820'$	$R = 250'$
$T = 47.57'$	$T = 36.61'$
$L = 95.03'$	$L = 72.71'$
$\Delta = 6^\circ 38' 23''$	

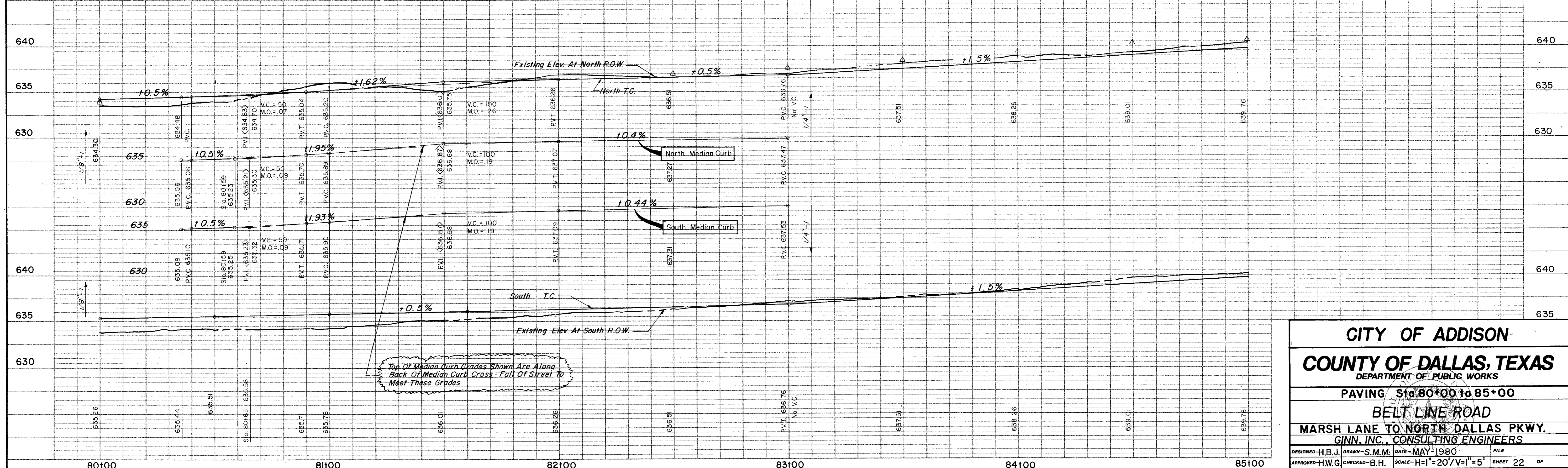

**CITY OF ADDISON**  
**COUNTY OF DALLAS, TEXAS**  
 DEPARTMENT OF PUBLIC WORKS  
 PAVING Sta. 80+00 to 85+00  
**BELT LINE ROAD**  
 MARSH LANE TO NORTH DALLAS PKWY.  
 GINN, INC., CONSULTING ENGINEERS  
 DESIGNED-H.B.J. DRAWN-S.M.M. DATE-MAY-1980 FILE  
 APPROVED-H.W.G. CHECKED-B.H. SCALE-H=1"=20' V=1"=5' SHEET 22 OF