

ESTIMATED QUANTITIES			
ITEM	DESCRIPTION	UNIT	QUANTITY
100	Prepare Roadway R.O.W	Sta.	5
104.1	Remove Old Concrete, Pavement & Median	SY	---
104.2	Sawed Break-Out Groove	LF	74
110	Unclassified Road Excavation (Dens Cont.)	CY	3482
160	Placing 4\"/>		

LEGEND			
□	Drain Mark		
○	Manhole		
○	Manhole		
○	Gas Meter		
○	Gas Valve		
○	Gas Line		
○	Power Pole (Typical Pole Symbol)		
○	Power Line		
○	Gay Wire Anchor		
○	Telephone Line		
○	Water Meter		
○	Water Valve		
○	Water Line		
○	Fire Hydrant		
○	Manhole		
○	Sanitary Sewer Line		
○	Fence Line		
○	Flow Direction Indicator		
○	Property or Right-of-Way Line (ROW)		
○	Easement Line		
○	Traffic Pull Box		
○	Block Area Pole Foundation (Type A or B)		
○	Pedestal Pole Foundation (Type C)		
○	Signal Illumination Pole Foundation (Type D)		
○	Top of Curb		
○	Flow Line		

B.M. #2 "a" On Conc. Walk At S.E. Corner Of Storage Building For Payless  
 Caseways East Of Addison Road & North Of Belt Line Road. ELEV. = 638.65

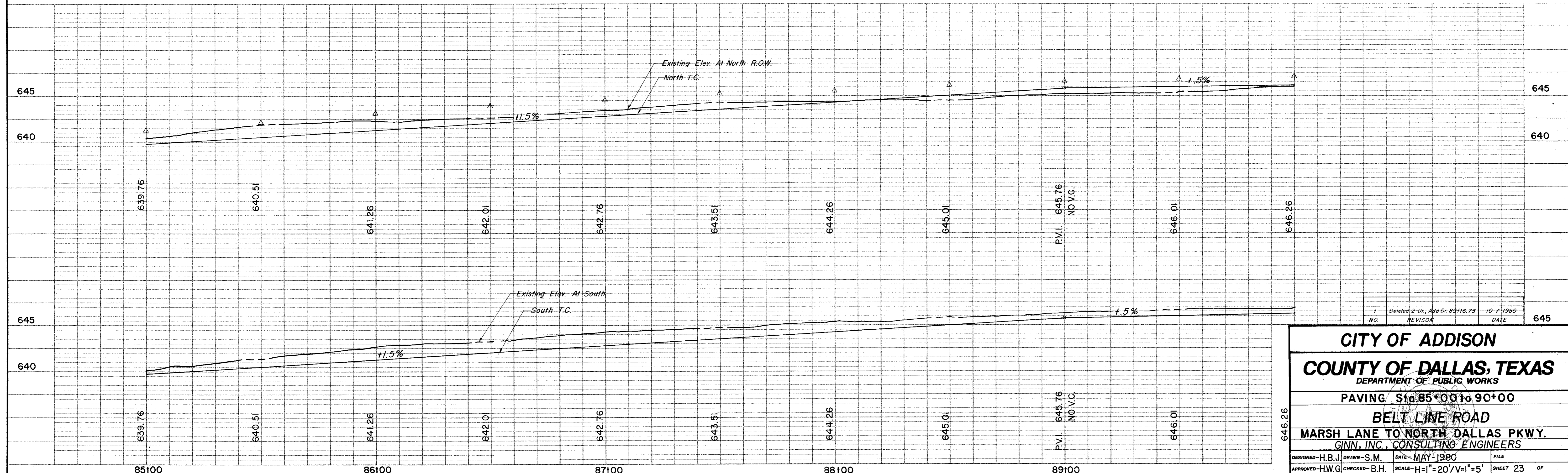

**CITY OF ADDISON**  
**COUNTY OF DALLAS, TEXAS**  
 DEPARTMENT OF PUBLIC WORKS

PAVING Sta. 85+00 to 90+00  
**BELT LINE ROAD**  
 MARSH LANE TO NORTH DALLAS PKWY.  
 GINN, INC., CONSULTING ENGINEERS

DESIGNED - H.B.J. DRAWN - S.M. DATE - MAY - 1980 FILE  
 APPROVED - H.W.G. CHECKED - B.H. SCALE - H=1"=20'/V=1"=5' SHEET 23 OF