

ESTIMATED QUANTITIES		SHEET 27	SHEET 28
ITEM	DESCRIPTION	UNIT	QUANTITY
100	Prepare Roadway R.O.W	Sta.	5
104.1	Remove Old Concrete, Pavement & Median	SY	3
104.2	Sawed Break-Out Groove	LF	55
110	Unclassified Road Excavation (Dens Cont.)	CY	254
160	Placing 4" Topsoil	CY	56
248	6" Flex Base (Dens Cont) (Ty A, Gr 2, C13)	CY	56
260.1	Lime (Ty A) Slurry Method	Ton	42.76
260.2	6" Lime Treated Subgrade (Dens Cont)	SY	3421.09
340.1	3" Hot Mix Asphalt (Ty D) Resurf Shoulder	SY	1514.67
340.2	6" Hot Mix Asphalt (Ty B)	Ton	
360.1	8" Conc Pavement (3000 PSI)	SY	3307.52
360.2	6" Conc Monolithic Curb (3000 PSI)	LF	982
360.3	4" Non-Reinf Conc in Median (2000 PSI)	SY	17.78
360.4	Conc St Header	LF	45
360.5	Conc RR Header	LF	215
524	Conc Driveways, Appr 5" Reinf Conc (3000 PSI)	SY	38.09
640.4	Pull Box, Complete in Place	EA	3
752.1	Traffic Buttons - Single Refl Ty P15 White	EA	73
752.3	Traffic Buttons - Double Refl Ty P17 Yellow	EA	100
754.1	Traffic Buttons - Nonrefl, Ty P7 White	EA	130
130	Unclassified Borrow (Dens Cont)	CY	1595
640.2	2" PVC Conduit, Furnish & Install	EA	100

- LEGEND**
- Bench Mark
 - Iron Pin
 - Monument
 - Gas Meter
 - Gas Valve
 - Gas Line
 - Power Pole (Typical Pole Symbol)
 - Guy Wire Anchor
 - Telephone Line
 - Water Meter
 - Water Valve
 - Water Line
 - Fire Hydrant
 - Manhole
 - Sanitary Sewer Line
 - Fence Line
 - Flow Direction Indicator
 - Property or Right-of-Way Line (ROW)
 - Easement Line
 - Traffic Pull Box
 - Manhole Pole Foundation (Type A or B)
 - Pedestal Pole Foundation (Type C)
 - Signal Illumination Pole Foundation (Type D)
 - Top Of Curb
 - Flow Line

B.M. #16 on N.W. corner of conc. drive at 15025 block of Inwood Road. ELEV. = 630.31

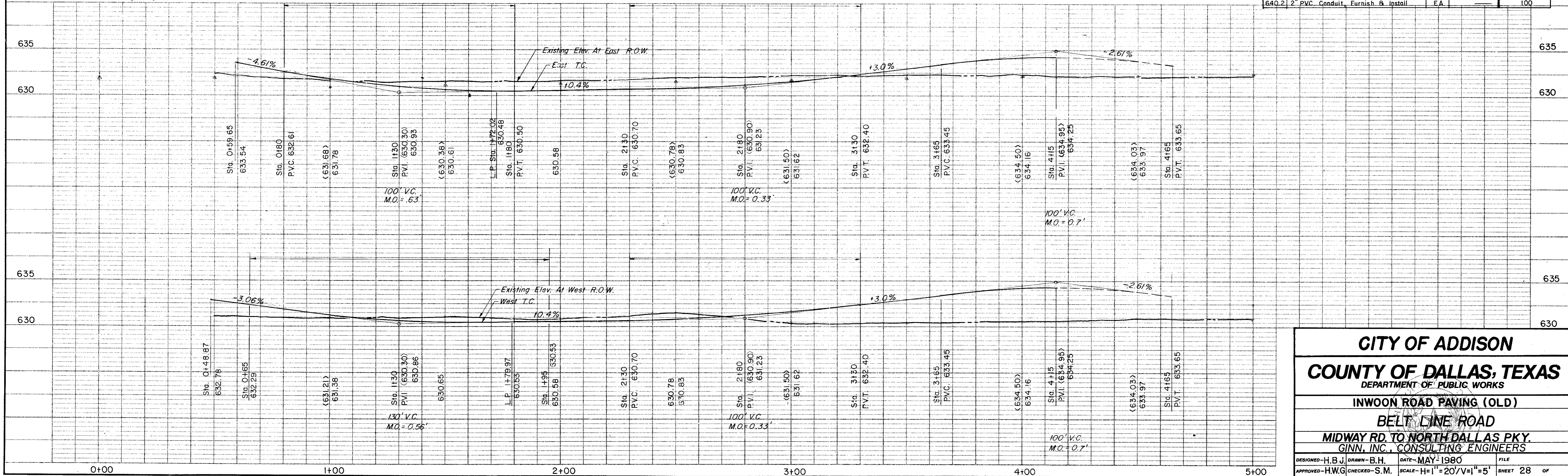

CITY OF ADDISON
COUNTY OF DALLAS, TEXAS
 DEPARTMENT OF PUBLIC WORKS
INWOOD ROAD PAVING (OLD)
BELT LINE ROAD
 MIDWAY RD. TO NORTH DALLAS PKY.
 GINN, INC., CONSULTING ENGINEERS

DESIGNED - H.B.J. DRAWN - B.H. DATE - MAY 1980 FILE
 APPROVED - H.W.G. CHECKED - S.M. SCALE - H=1"=20'/V=1"=5' SHEET 28 OF