

Drainage Calculations (T.H.D. Hydraulic Manual)  
 Rolling Terrain 1% - 3.5%  
 Impervious Soil  
 Commercial C = 0.6 - 0.9 (use C=0.75)  
 For Dallas County  
 $I_{25} = \frac{b}{(1+d)^e} = \frac{90}{(10+8.7)^{.774}} = 9.3 \text{ in/hr.}$   
 $Q_{25} = C.I.A. = (0.75)(9.3)(A)$   
 $Q_{25} = 6.95(A)$

Acres  
C.F.S.

N  
SCALE: 1" = 200'

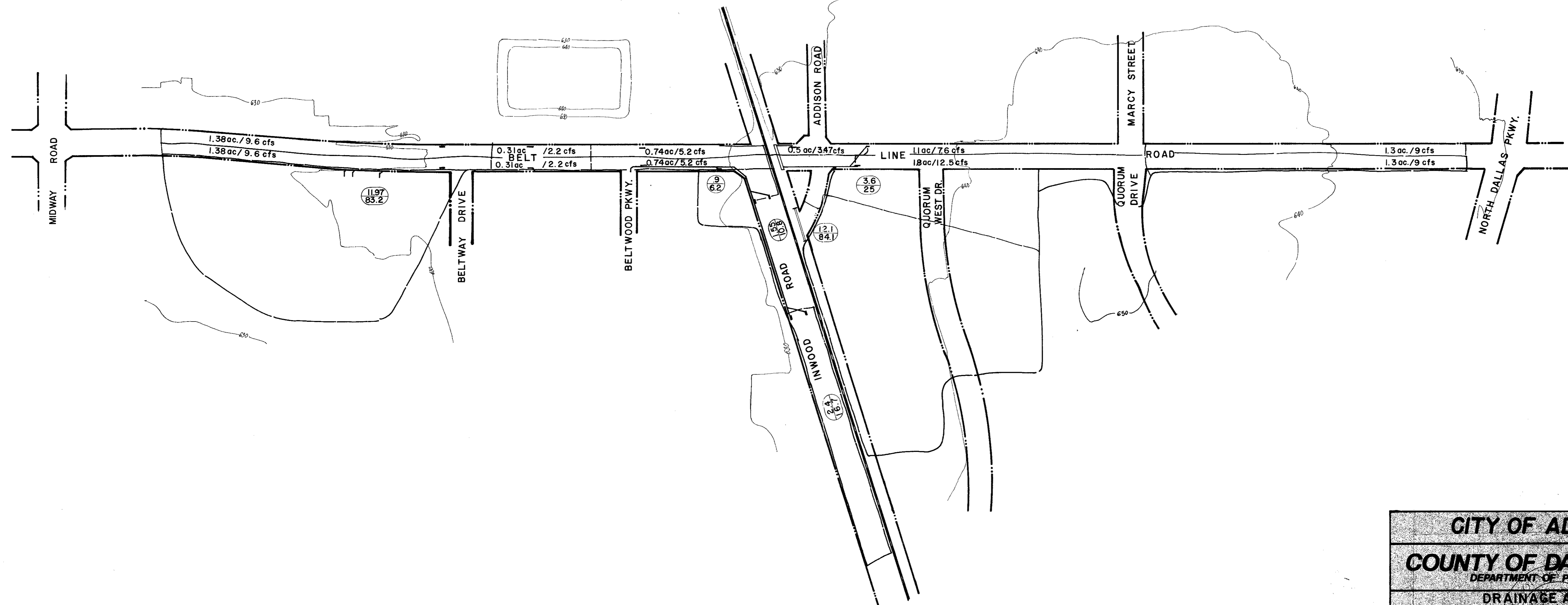

<b>CITY OF ADDISON</b>	
<b>COUNTY OF DALLAS, TEXAS</b>	
DEPARTMENT OF PUBLIC WORKS	
DRAINAGE AREA MAP	
BELT LINE ROAD	
MIDWAY ROAD TO NORTH DALLAS PKWY	
GINN, INC., CONSULTING ENGINEERS	
DESIGNED - H.B.J.	CHECKED - B.H.
DATE - MAY 1960	SCALE - 1" = 200'
APPROVED - H.W.G.	DATE - MAY 1960