

ESTIMATED QUANTITIES			
ITEM	DESCRIPTION	UNIT	QUANTITY
465.1	18" R.C.P. CI 111	LF	20.0
465.2	24" R.C.P. CI 111	LF	130.0
465.3	24" R.C.P. CI 111	LF	130.0
465.13	24" R.C.P. CI 111	LF	516.0
470	Rec. Inlet-compl. in pl.	EA	9.0
470.4	24" Standard C.I.	EA	1.0
475.3	Adjust 8" Water Main	LF	20.0
479.0	Adjust 8" Water Main	LF	47.0

LEGEND	
□	Bench Mark
○	Iron Pin
○	Mound
⊙	Gas Meter
⊙	Gas Valve
⊙	Gas Line
⊙	Power Pole (Typical Pole Symbol)
⊙	Power Line
⊙	Gay Wire Anchor
⊙	Telephone Line
⊙	Water Meter
⊙	Water Valve
⊙	Water Line
⊙	Fire Hydrant
⊙	Manhole
⊙	Sanitary Sewer Line
⊙	Fence Line
⊙	Flow Direction Indicator
⊙	Property or Right-of-Way Line (R.O.W.)
⊙	Easement Line
⊙	Traffic Pull Box
⊙	Met. Arm Pole Foundation (Type A or B)
⊙	Patented Pole Foundation (Type C)
⊙	Signal Illumination Pole Foundation (Type D)
⊙	Top of curb
⊙	Flow Line

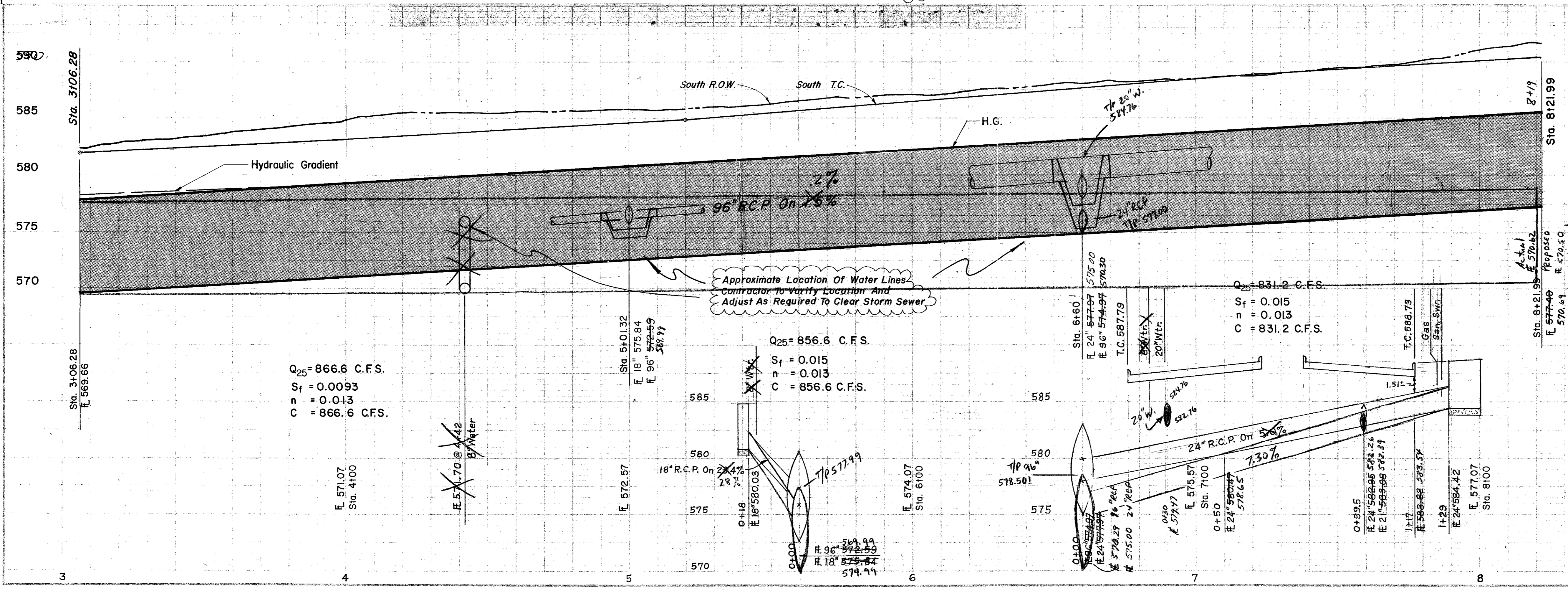

NO.		REVISION		DATE
1	Added Laterals		6-18-80	

**CITY OF ADDISON**  
**COUNTY OF DALLAS, TEXAS**  
 DEPARTMENT OF PUBLIC WORKS  
**DRAINAGE STA. 20+00 - 25+00**  
**BELT LINE ROAD**  
**MARSH LN. TO NORTH DALLAS PKWY.**  
**GINN, INC., CONSULTING ENGINEERS**

DESIGNED - J.C.H. ORAZIM - S.M. DATE - MAY - 1980 FILE  
 APPROVED - HWG. CHECKED - B.H. SCALE - H=1"=20'/V=1"=5' SHEET 34 OF