

LEGEND:

- ① ↑ DIRECTIONAL ARROW
- ② ↗ RIGHT TURN ARROW
- ③ ↖ LEFT TURN ARROW
- ④ ↗ STRAIGHT AND RIGHT TURN ARROW
- ⑤ ↖ STRAIGHT AND LEFT TURN ARROW
- ⑥ ONLY TYP. ELONGATED LETTERS
- ⑦ X TYP. ELONGATED RR MARKINGS
- RR
- ⑧ - - - PUPPY TRACK LINES
- ⑨ ——— CROSSWALK LINES
- ⑩ ——— STOP LINES

NOTES:

1. LOCATION OF PAVEMENT MARKINGS SHOWN ARE APPROXIMATE ONLY. FINAL LOCATIONS WILL BE AS DIRECTED BY THE OWNER'S REPRESENTATIVE. CONTRACTOR TO FOLLOW DESIGN CRITERIA SET FORTH IN TXDOT PAVEMENT MARKING AND THE TEXAS MANUAL OF UNIFORM TRAFFIC CONTROL DEVICES.
2. TRAFFIC BUTTONS/MARKERS NOT SHOWN. SEE SHEET 3 FOR STANDARD DETAILS.
3. CONTRACTOR SHALL REPLACE AND MATCH EXISTING TRAFFIC MARKERS/BUTTONS AND STRIPES ON NEW PAVEMENT AREAS OF ALL SIDE STREETS AND DRIVES. USE ITEM PAVEMENT MARKING CONTINGENCY FOR PAVEMENT.



THE SEAL ON THIS DOCUMENT WAS AUTHORIZED BY WM. SCOTT FORBES P.E.# 87223 ON 09-SEP-2004

NO.	DATE	REVISION	APPROV.

HNTB ARCHITECTS ENGINEERS PLANNERS
The HNTB Companies

BELT LINE ROAD
MARSH LANE TO DALLAS NORTH TOLLWAY

PAVEMENT MARKING PLAN
BEGIN TO STA 36+00

TOWN OF ADDISON, TEXAS

Design	Drawn	DATE	SCALE	PROJECT NO.	SHEET NO.
WSF	GFS	SEPT 04	1"=50'	40316	8

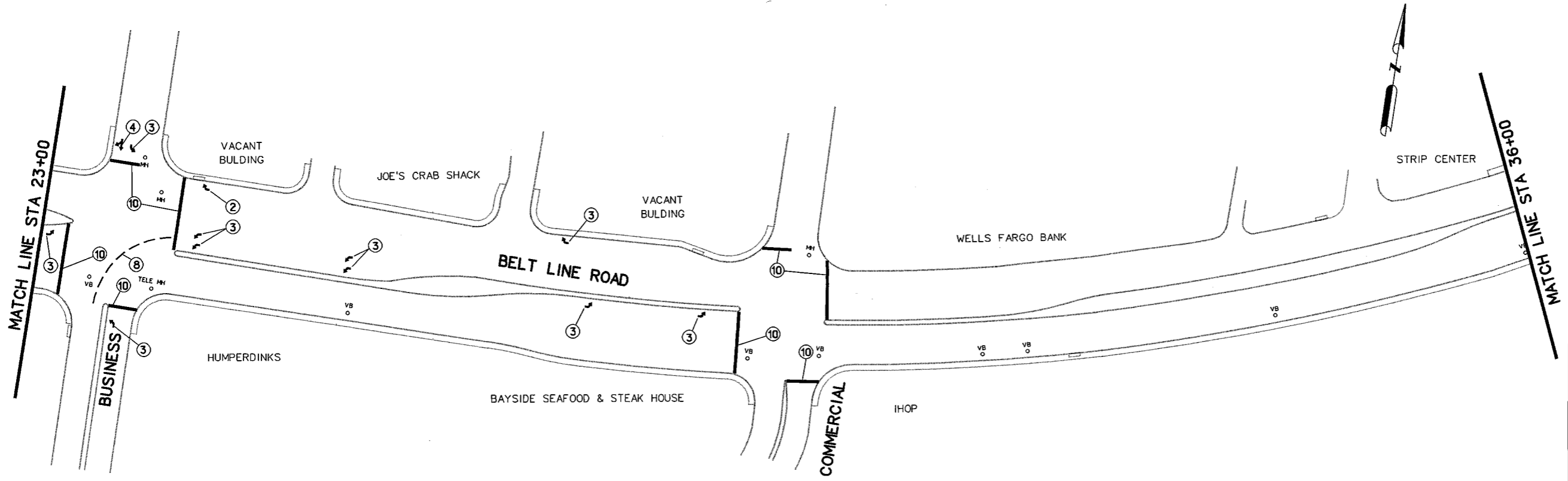
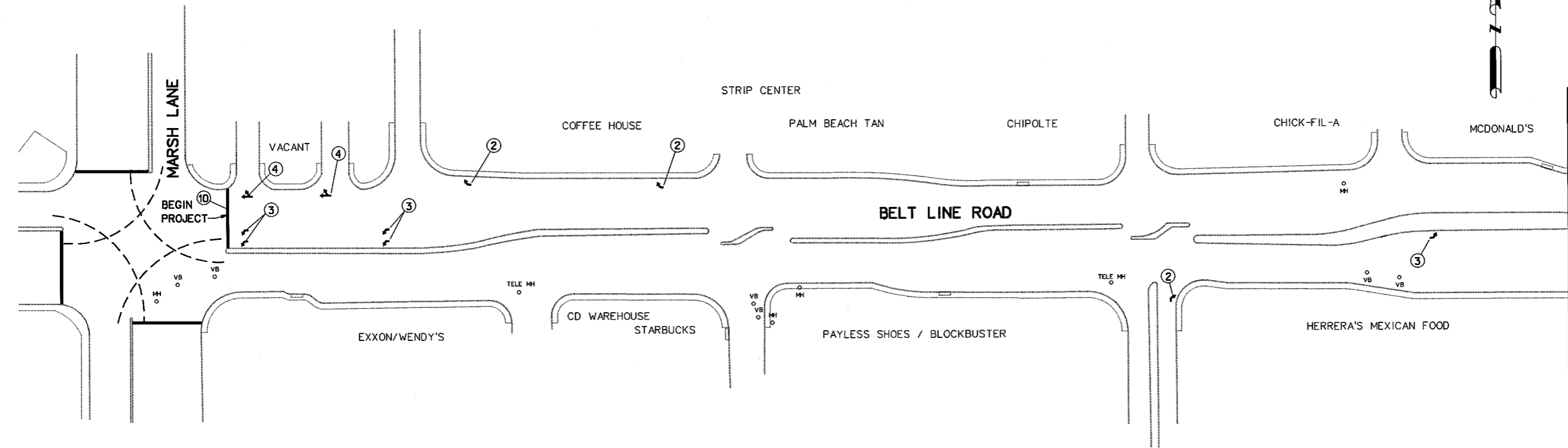

09-SEP-2004 16:00 C:\10516\Cad\Sheets\blisp01.dgn