

83-2
BELT LINE 2002 GROOVING

ACC BELT LINE Rd. 2002-2003

Pavement Markings

West Bound Belt Line Missing for Plan.

- 1) SB Runway - Left Turn Arrow
- 2) Local lane W of Commercial - 4 right turn Arrows
- 3) SE Business - 1 Left turn Arrow, 1 Straight/Right Arrow
- 4) Local lane @ 3711 E. - 1 Rt. arrow
- 5) WB & right lane - 2 straight/right arrows

EB Belt Line

- 1) Repair tail on arrow (first left turn arrow approaching Business)
- 2) NB Beltwood - Left arrow
- 3) NB Inwood - stop bar
- 4) NB landmark - stop bar
- 5) Local lane/Rt. turn lane approaching DP - 2 rt. turn arrows

Questions

- 1) Crosswalk @ Dallas Plum. - Atk. diff.
- 2) Crosswalk south side of Inwood/BL between Benedicts + Landanial
- 3) Stop bars @ Inwood (NB) and Beltwood (NB) should be closer to intersection
- 4) Triangle @ Shell station is hatched, but no direction given
- 5) Bold arrow @ Bayless/Harveys NE driveway, but no direction

TOWN OF ADDISON

CONSTRUCTION PLANS FOR

PAVEMENT GROOVING IMPROVEMENTS

AUGUST 2002

INDEX OF DRAWINGS

- 1. COVER SHEET
- 2. GENERAL NOTES & QUANTITY SHEET
- 3. CONSTRUCTION PHASING PLAN
- 4. PAVEMENT REPAIR PLAN
- 5. PAVEMENT MARKING PLAN
- 6. DETAIL SHEET

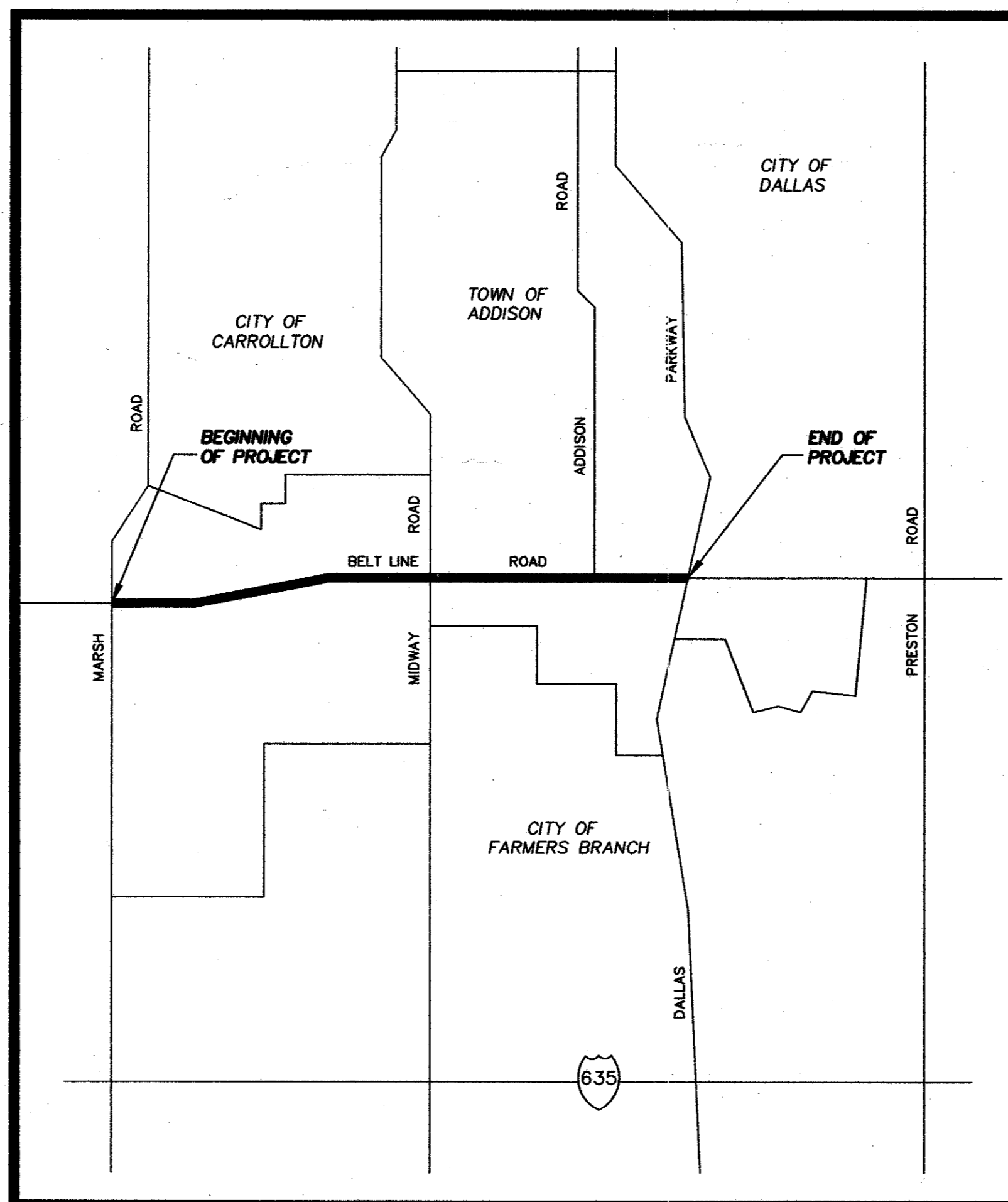

VICINITY MAP
N.T.S.

CITY OFFICIALS

MAYOR
R. Scott Wheeler

COUNCIL
Cathy Ways (Mayor Pro Tempore)
Bob Barrett (Deputy Mayor Pro Tempore)
Diane Mallory
Glynda Turner
Joe Chow
Fredric M. Silver

CITY MANAGER
Ron Whitehead

DIRECTOR OF PUBLIC WORKS
Mike Murphy, P.E.

APPROVED BY: Nicholas E. Murphy
DIRECTOR OF PUBLIC WORKS
TOWN OF ADDISON



5999 Summerside Drive, Suite 202
Dallas, Texas 75252 (972)380-2605

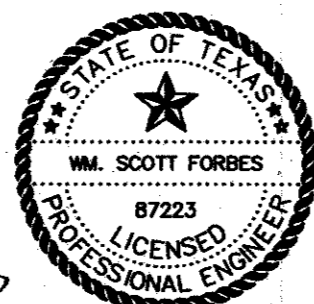

Wm Scott Forbes August 27, 2002
WM. SCOTT FORBES, P.E.

PBS&J JOB NO. 450949

B3-2
BELT LINE GROOVING

GENERAL NOTES

GENERAL NOTES:

1. Construction should be in accordance with all contract documents and the latest edition of the NCTCOG Standard Specifications for Public Works Construction, and as described in the specifications.
2. Contractor will be responsible for obtaining and familiarizing himself with current Town of Addison standards and specifications.
3. Contractor shall prepare and implement a traffic control plan for all work within street right-of-way. Traffic control plan shall conform to the Texas Manual on Uniform Traffic Control Devices. Contractor at all times shall provide barricades, warning signs, flagmen and lighting adequate to safeguard the public from any hazards.
4. All work within the public right-of-way shall also comply with the Town of Addison Street Excavation Ordinance.
5. Any street right-of-way, or other property damaged by the Contractor or his subcontractor shall be repaired properly at their expense.
6. All adjacent property damage by the proposed construction shall be restored to equal or better condition than which it was found before such work was undertaken (Non-Pay item).
7. Working hours for this project shall be Sunday through Thursday 10:00 p.m. to 6:00 am. The Contractor shall maintain at least one free lane of free flow traffic in each direction at all times.
8. No business shall be denied access at any time.
9. All communication with the property owners or tenants shall be the responsibility of the Town of Addison Street Superintendent.
10. Owner reserves the right to sequence locations of work as necessary.
11. Contractor shall employ a qualified English speaking project manager who will be responsible for directing all work crews. Project Manager shall remain on the job at all times, in order to supervise the work of all sub-contractors, as well as the Contractor's own work crews.
12. Contractor will be responsible for water for the project and will use a loan meter provided by the Town of Addison and pay a deposit and water fee.
13. The Town of Addison will not reimburse the contractor for any water used to perform the work as required in the contract.
14. Contractor shall obtain and pay for any permits required.
15. Contractor shall remove all surplus dirt, debris, etc., from the site and dispose of it legally offsite. All work areas shall be cleaned up at the completion of each day's work.

PAVEMENT REPAIR:

1. The Town of Addison will designate pavement repair areas in the field.
2. The Contractor shall repair pavement areas ahead of grooving operations.
3. Pavement removal and replacement shall be full depth. Minimum pavement removal size shall be 3'X3' to allow for pavement dowels.
4. Provide full-depth pavement repair in accordance with the Town of Addison Full-Depth Repair of Existing Concrete Pavement (Night Work) Specification.
5. The Contractor shall use "Class K" quick set concrete to repair pavement.
6. It will be the responsibility of the Contractor to protect all public utilities in the construction of this project. All manholes, cleanouts, valve boxes, etc., must be adjusted to proper line and grade by the contractor after the placing of permanent paving.

TRAFFIC AND ACCESS CONTROL:

1. The Contractor, at all times, shall provide barricades, warning signs, flagmen and lighting adequate to safeguard the public from any hazards.
2. The Contractor shall maintain, at all times, at least one free lane of traffic in each direction to permit local traffic flow.
3. The Contractor shall provide access to all business locations at all times during the construction. Closure of driveways due to construction operations will be allowed on a limited time basis subject to approval of the Owner.
4. The Contractor shall maintain access to all cross streets. Closure of cross streets due to construction operations will be allowed on a limited time basis subject to approval of the Owner.
5. The Contractor shall provide detours as necessary at cross streets and driveways to maintain access to all business locations and to protect the traveling public. Detours subject to approval of the Town of Addison.

PAVEMENT GROOVING:

1. The Contractor shall groove no closer than six (6) inches on either side of the longitudinal joints, striping, or button paths unless otherwise directed by the Town of Addison.
2. The Contractor shall ensure that the grooves in the wheel path should be at a minimum of 1/4" deep at the lowest point of the path. See detail sheet for groove depth and spacing.
3. The Contractor shall use a vacuum truck and sweeper at the end of each night's work before opening the street to morning traffic.

TRANSVERSE JOINT REPLACEMENT:

1. Contractor shall remove existing transverse joint material from all transverse joints.
2. Contractor shall prepare transverse joints for new sealant in accordance with Item 2.2 Portland Cement Concrete and Related Materials of the Supplemental Specifications.
3. Joint sealant and backer rod: Furnish and install joint sealant and backer rod in accordance with Item 2.2 Portland Cement Concrete and Related Materials of the Supplemental Specifications.

LONGITUDINAL JOINT REPLACEMENT:

1. The Town of Addison shall designate longitudinal joints for replacement.
2. Contractor shall remove existing longitudinal joint material from selected joints.
3. Contractor shall prepare longitudinal joints for new sealant in accordance with Item 2.2 Portland Cement Concrete and Related Materials of the Supplemental Specifications.
4. Joint sealant and backer rod: Furnish and install joint sealant and backer rod in accordance with Item 2.2 Portland Cement Concrete and Related Materials of the Supplemental Specifications.
5. For bidding purposes, the project is estimating one-half of the longitudinal joints will be removed and replaced.

RAISED TRAFFIC MARKERS:

1. Contractor to remove and replace all raised traffic markers on this project. Remove existing raised traffic markers in accordance with TxDOT Standard Specification Item 677 or latest revision. Cost of removal is subsidiary to construction.
2. Review existing raised traffic marker locations with Owner. Match existing raised traffic marker locations unless otherwise directed by Owner.
3. Prepare pavement surface for new raised traffic markers in accordance with TxDOT Standard Specification Item 678 or latest revision. Cost is subsidiary to construction.
4. Contractor to use new raised traffic marker pattern. See detail on page 6 of 6 of this set of plans. Install raised traffic markers in accordance with TxDOT Standard Specification Item 672 or latest revision. Install raised traffic markers using traffic marker adhesive.
5. Non-Reflectorized Marker: 4" round ceramic; white.
6. Reflectorized Marker: 4"x4"x0.70"; white with one side reflective.
7. Traffic marker adhesive: Type II Epoxy adhesive meeting TxDOT material specification DMS-6100 and in accordance with TxDOT Special Specification 5699 or latest revision.

PAVEMENT MARKINGS:

1. Contractor to remove and replace pavement markings on the project. Remove existing pavement markings in accordance with TxDOT Standard Specification Item 677 or latest revision. Cost is subsidiary to construction.
2. Review existing pavement marking locations with Owner. Match existing pavement marker locations unless otherwise directed by Owner.
3. Prepare pavement surface for new pavement markings in accordance with TxDOT Standard Specification Item 678 or latest revision. Cost is subsidiary to construction.
4. Install pavement markings in accordance with TxDOT Standard Specification Item 666 or latest revision.
5. Pavement markings: Crosswalk Delineations, Stop Bars and Traffic Symbols shall be Thermoplastic Material meeting TxDOT Materials Specification D-9-8220.

TRAFFIC SIGNAL LOOP REPLACEMENT:

1. The Contractor shall notify the Town of Addison when damage occurs to a traffic loop due to construction operations.
2. The Contractor shall replace electrical loops damaged by construction operations. The replacement of the traffic signal loops shall be in accordance with Town of Addison Standards.
3. Traffic signal loop sizes vary. For bidding purposes, the project is estimating that approximately one-half of the traffic signal loops will be damaged and replaced.

SUMMARY OF QUANTITIES

NO.	DESCRIPTION	QUANTITY	UNIT
1.	Mobilization	1	L.S.
2.	Traffic Control	1	L.S.
3.	Remove & Replace 8" thick Reinf. Conc. Pwmt.	67	S.Y.
4.	Remove & Replace Concrete Curb & Gutter	20	L.F.
5.	Pavement Grooving	60,100	S.Y.
6.	Remove and Replace Existing Transverse Joint	42,100	L.F.
7.	Remove and Replace Existing Longitudinal Joint	21,000	L.F.
8.	Remove and Replace Existing Traffic Signal Loop	40	EA.
9.	Random Crack Repair	1,200	L.F.
10.	Traffic Markers (4" Lead Acrylic Reflectorized)	1,050	EA.
11.	Traffic Markers (4" Round Ceramic Buttons)	11,700	EA.
12.	Prefabricated Reflectorized Stop Bars (24" Wide)	1,510	L.F.
13.	Prefabricated Reflectorized Crosswalks (6" Wide)	1,210	L.F.
14.	Prefabricated Reflectorized Puppy Tracks (6" Wide)	790	L.F.
15.	Prefabricated Reflectorized Words / Symbols	35	EA.
16.	Prefabricated Reflectorized Left-Turn Arrows	59	EA.
17.	Prefabricated Reflectorized Right-Turn Arrows	19	EA.
18.	Prefabricated Reflectorized Straight Arrows	8	EA.
19.	Prefabricated Reflectorized Combined Right	4	EA.
20.	Adjust Manhole Castings and Valve Boxes	5	EA.
21.	Temporary Inlet Protection	24	EA.

RANDOM PAVEMENT CRACK REPAIR:

1. The Town of Addison shall designate random pavement cracks for repair.
2. Contractor shall route open existing crack to provide opening for joint sealant.
3. Contractor shall prepare random pavement crack for new sealant in accordance with Item 2.2 Portland Cement Concrete and Related Materials of the Supplemental Specifications.
4. Joint sealant: Furnish and install joint sealant in accordance with Item 2.2 Portland Cement Concrete and Related Materials of the Supplemental Specifications.

TEMPORARY PAVEMENT MARKINGS:

1. When existing pavement markings are removed for construction, The Contractor shall provide temporary pavement markings at the end of each night's work before opening the street to morning traffic. Cost is subsidiary to bid item for Traffic Control.
2. Contractor to provide temporary markings in accordance with the requirements of Item 662 of the TxDOT Standard Specifications.
3. Contractor to remove temporary pavement markings at the Contractor's expense in accordance with Item 677 of the TxDOT Standard Specifications. Cost is subsidiary to temporary pavement marking bid item.

NO.	REVISION	BY	DATE

DESIGNED BY: _____ DRS
 DRAWN BY: _____ PBSJ
 CHECKED BY: _____ WSF
 SCALE: _____ AS SHOWN
 DATE: _____ AUGUST, 2002
 FILE: _____ 949-GEN NOTES

PBSJ
 5999 Summerside Drive, Suite 202
 Dallas, Texas 75252 (972)380-2605

Town of Addison
Dallas County
Texas

BELT LINE ROAD
PAVEMENT GROOVING IMPROVEMENTS
"GENERAL NOTES & QUANTITY SHEET"
 TOWN OF ADDISON
 AUGUST, 2002

SHEET NO. **2**
 OF **6** SHEETS
 JOB NO. **450949**

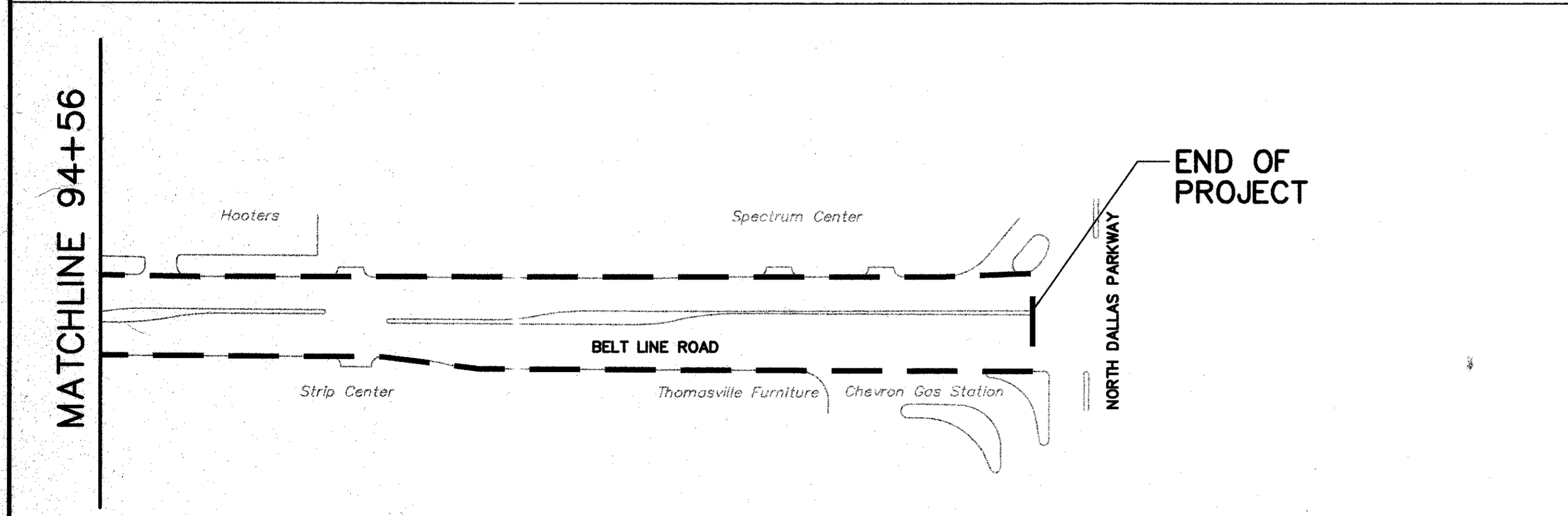
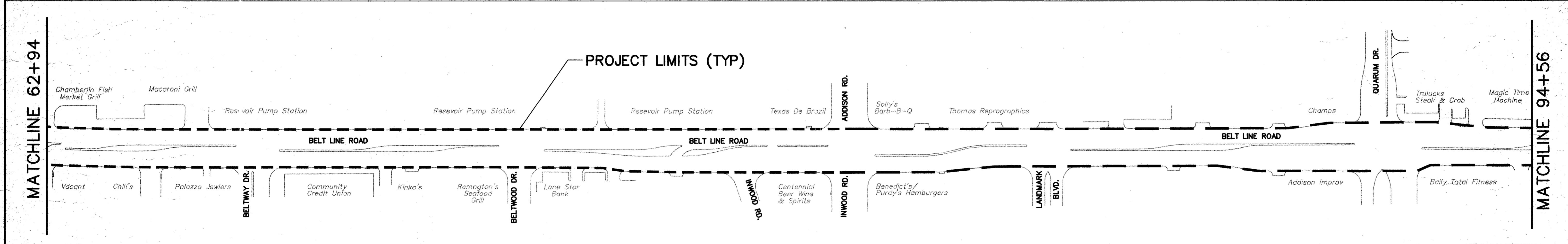
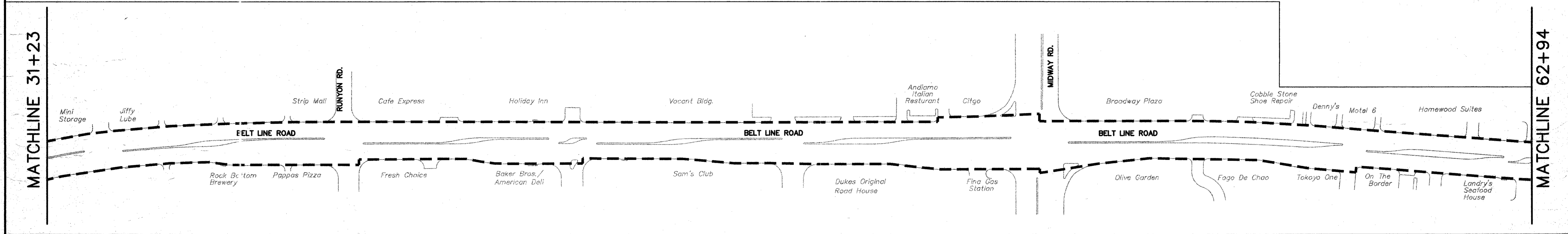
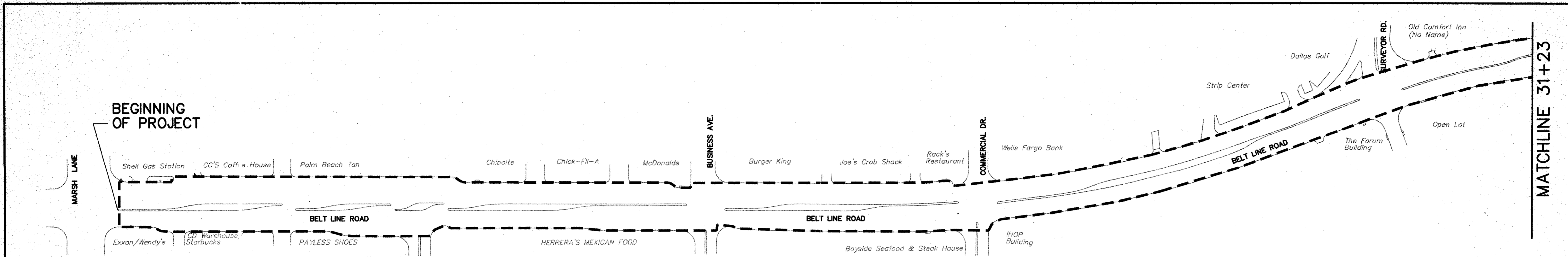

CONSTRUCTION PHASING NOTES:

1. CONTRACTOR TO DEVELOP CONSTRUCTION PHASING PLAN AND IMPLEMENT CONSTRUCTION IN PHASES.
2. THE CONTRACTOR SHALL SUBMIT A CONSTRUCTION PHASING PLAN TO THE TOWN OF ADDISON FOR APPROVAL.
3. SIGNS, BARRICADES, FLAGMEN AND WARNING DEVICES, AS NECESSARY FOR CONSTRUCTION, SHALL CONFORM TO THE TEXAS MANUAL ON UNIFORM TRAFFIC CONTROL DEVICES.
4. CONSTRUCTION SHOULD BE IN ACCORDANCE WITH ALL CONTRACT DOCUMENTS, THE LATEST EDITION OF THE NCTCOG STANDARD SPECIFICATIONS FOR PUBLIC WORKS CONSTRUCTION, AND AS DESCRIBED IN THE SPECIFICATIONS.
5. WORKING HOURS SHALL BE SUNDAY THROUGH THURSDAY 10:00 p.m. TO 6:00 a.m.
6. CONTRACTOR TO MAINTAIN AT LEAST ONE LANE OF OPEN TRAFFIC IN EACH DIRECTION AT ALL TIMES.
7. THE CONTRACTOR SHALL KEEP OPEN, ALONG ENTIRE PROJECT, THE SAME TRAFFIC LANE SO AS TO MAINTAIN TRAFFIC CONSISTENCY AND PREVENT MOTORISTS FROM HAVING TO SWITCH LANES AND WEAVE IN AND OUT AND AROUND BARRELS OR BARRICADES.
8. NO BUSINESS SHALL BE DENIED ACCESS AT ANY TIME.
9. THE CONTRACTOR SHALL COMPLETE PAVEMENT REPAIR IN SUCH A MANNER SO AS NOT TO PREVENT CONFLICT WITH THE GROOVING PHASE WHICH IS TO FOLLOW.
10. THE CONTRACTOR SHALL PROVIDE A VACUUM TRUCK AND SWEEPER TO CLEAN THE WORK AREA AT THE END OF EACH NIGHT'S WORK PRIOR TO REOPENING FOR MORNING TRAFFIC.
11. CONSTRUCTION SIGNS SHALL BE REMOVED UPON COMPLETION OF THE WORK. INDIVIDUAL WARNING SIGNS SHALL BE REMOVED, TURNED AWAY FROM THE VIEW OF TRAFFIC, OR COVERED WHENEVER THE SPECIFIC DANGER OF WHICH THE PARTICULAR SIGN WARNS HAS CEASED TO EXIST, EITHER PERMANENTLY OR TEMPORARILY. THE SIGN MUST BE PROMPTLY REPLACED, TURNED INTO VIEW, OR UNCOVERED WHEN THE SITUATION AGAIN BECOMES A POTENTIAL DANGER.

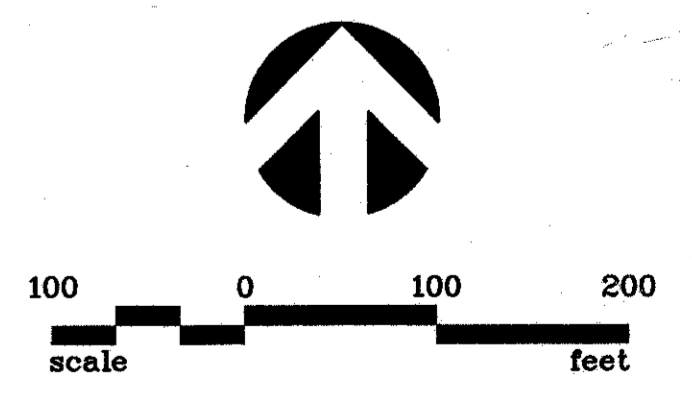

NO.	REVISION	BY	DATE

DESIGNED BY: _____ DRS
 DRAWN BY: _____ PBSJ
 CHECKED BY: _____ WSF
 SCALE: 1"=100' (H)
 DATE: AUGUST 2002
 FILE: 949-CONST PHASING PLAN.DWG

PBSJ
 5999 Summerside Drive, Suite 202
 Dallas, Texas 75252 (972)380-2605

Town of Addison
 Dallas County
 Texas

BELT LINE ROAD
 PAVEMENT GROOVING IMPROVEMENTS
"CONSTRUCTION PHASING PLAN"
 TOWN OF ADDISON
 AUGUST, 2002

SHEET NO. 3
 OF 6 SHEETS
 JOB NO. 450949

MATCHLINE 31+23

MATCHLINE 62+94

MATCHLINE 94+56

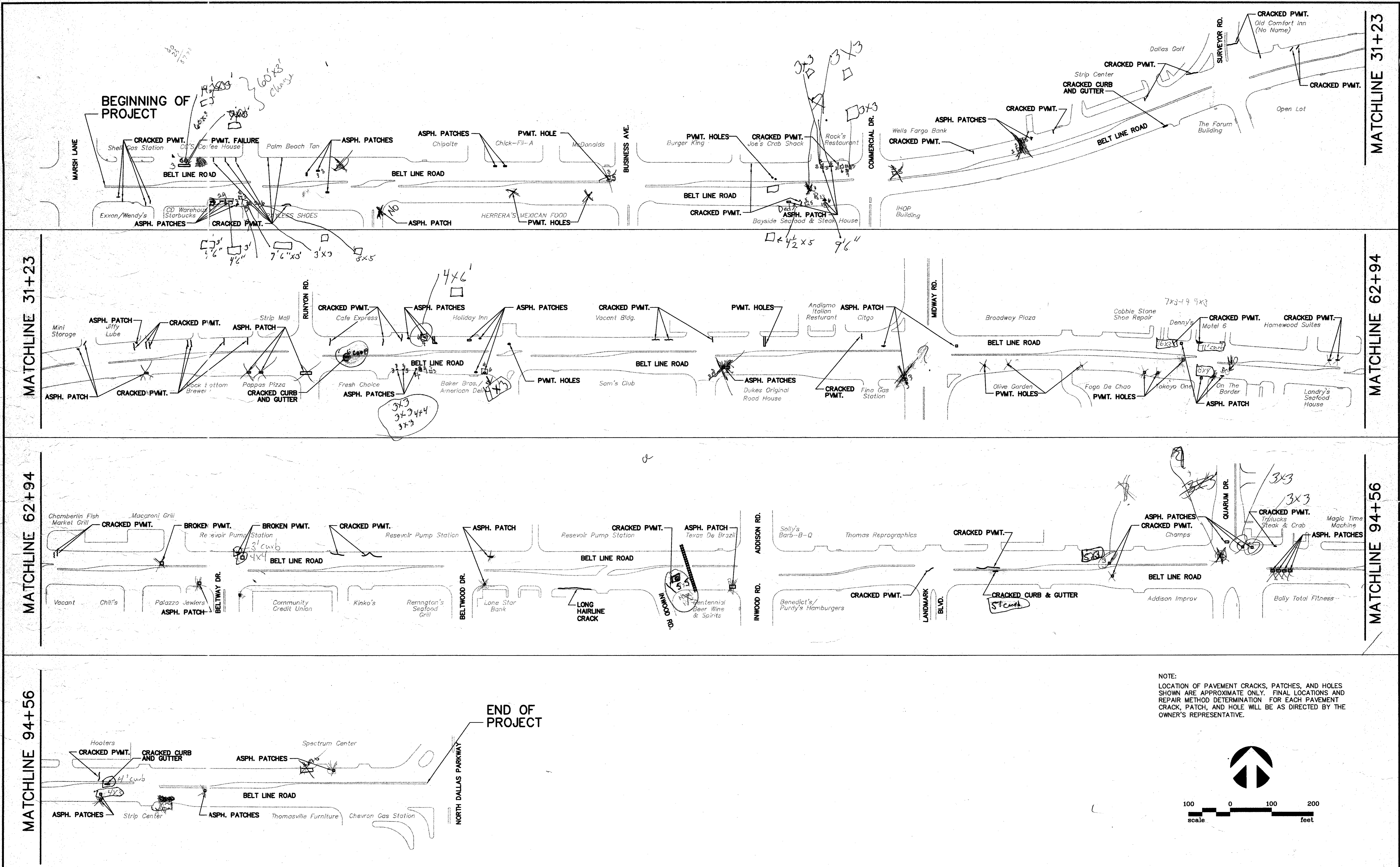

NOTE:
 LOCATION OF PAVEMENT CRACKS, PATCHES, AND HOLES SHOWN ARE APPROXIMATE ONLY. FINAL LOCATIONS AND REPAIR METHOD DETERMINATION FOR EACH PAVEMENT CRACK, PATCH, AND HOLE WILL BE AS DIRECTED BY THE OWNER'S REPRESENTATIVE.

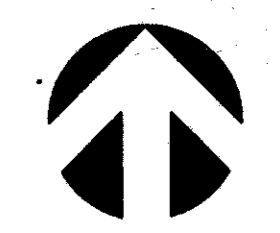

NO.	REVISION	BY	DATE

DESIGNED BY: DRS
 DRAWN BY: PBSJ
 CHECKED BY: WSF
 SCALE: 1"=100' (H)
 DATE: AUGUST 2002
 FILE: 949-PVMT REPAIR PLAN.DWG

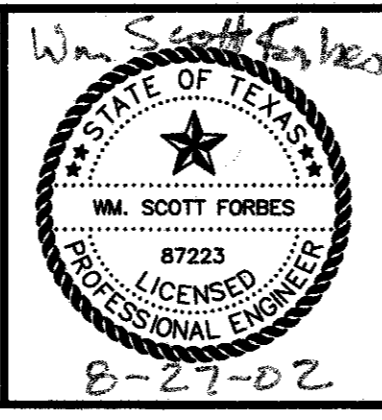

PBSJ
 5999 Summerside Drive, Suite 202
 Dallas, Texas 75252 (972)380-2605

Town of Addison
 Dallas County
 Texas

BELT LINE ROAD
 PAVEMENT GROOVING IMPROVEMENTS
"PAVEMENT REPAIR PLAN"
 TOWN OF ADDISON
 AUGUST, 2002

SHEET NO. 4
 OF 6 SHEETS
 JOB NO. 450949

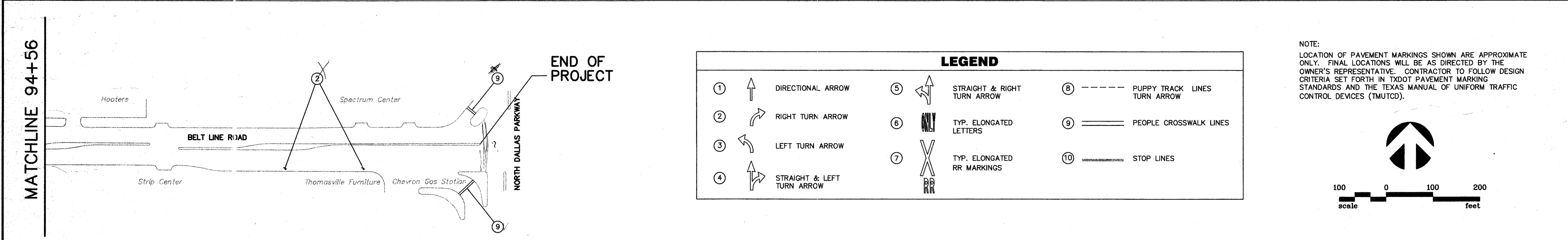
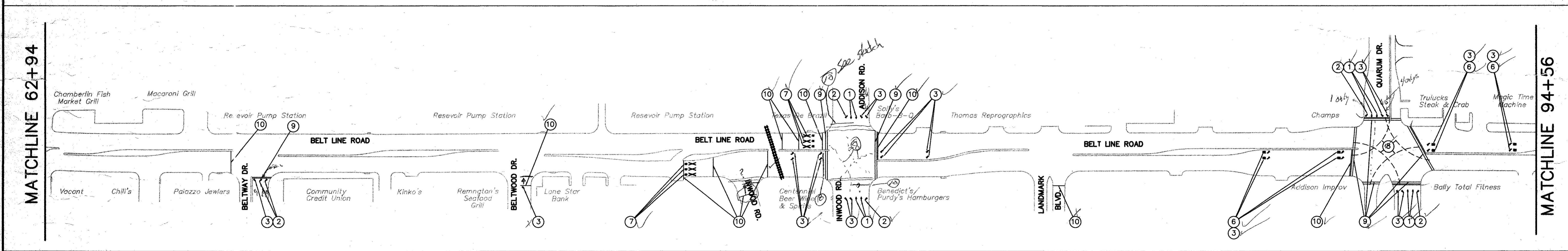
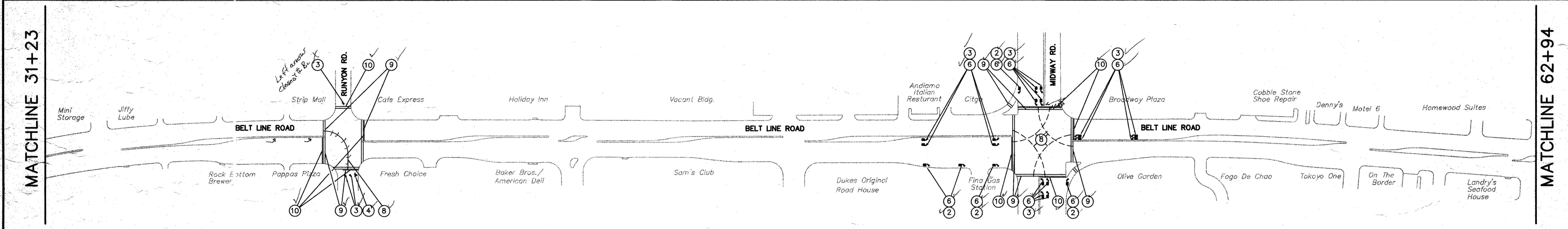
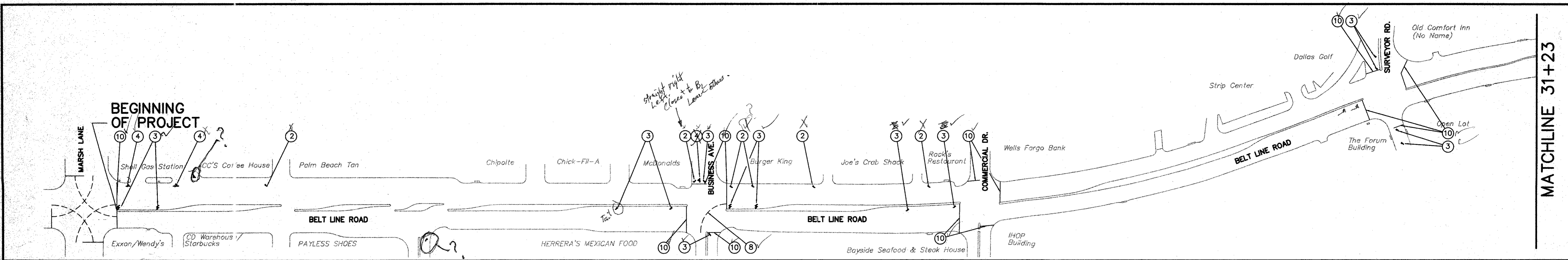

LEGEND		
1		DIRECTIONAL ARROW
2		RIGHT TURN ARROW
3		LEFT TURN ARROW
4		STRAIGHT & LEFT TURN ARROW
5		STRAIGHT & RIGHT TURN ARROW
6		TYP. ELONGATED LETTERS
7		TYP. ELONGATED RR MARKINGS
8		PUPPY TRACK LINES TURN ARROW
9		PEOPLE CROSSWALK LINES
10		STOP LINES

NOTE:
 LOCATION OF PAVEMENT MARKINGS SHOWN ARE APPROXIMATE ONLY. FINAL LOCATIONS WILL BE AS DIRECTED BY THE OWNER'S REPRESENTATIVE. CONTRACTOR TO FOLLOW DESIGN CRITERIA SET FORTH IN TXDOT PAVEMENT MARKING STANDARDS AND THE TEXAS MANUAL OF UNIFORM TRAFFIC CONTROL DEVICES (TMUTCD).

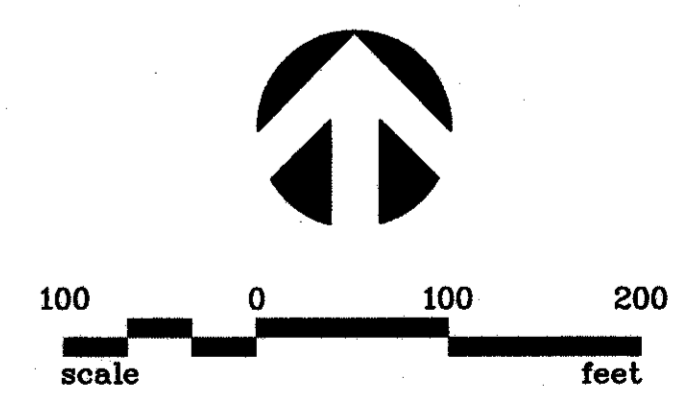

NO.	REVISION	BY	DATE

DESIGNED BY: DRS
 DRAWN BY: PBSJ
 CHECKED BY: WSF
 SCALE: 1"=100' (H)
 DATE: AUGUST 2002
 FILE: 949-TRAFFIC SIGNAGE PLAN.DWG

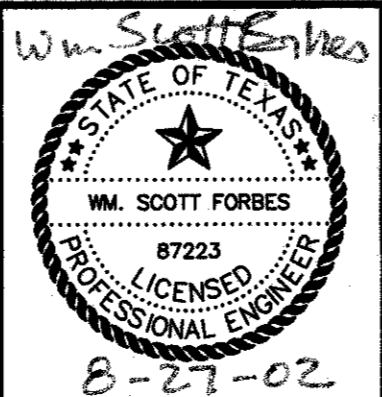

PBSJ
 5999 Summerside Drive, Suite 202
 Dallas, Texas 75252 (972)380-2605

Town of Addison
 Dallas County
 Texas

BELT LINE ROAD
 PAVEMENT GROOVING IMPROVEMENTS
"PAVEMENT MARKING PLAN"
 TOWN OF ADDISON
 AUGUST, 2002

SHEET NO. 5
 OF 6 SHEETS
 JOB NO. 450949

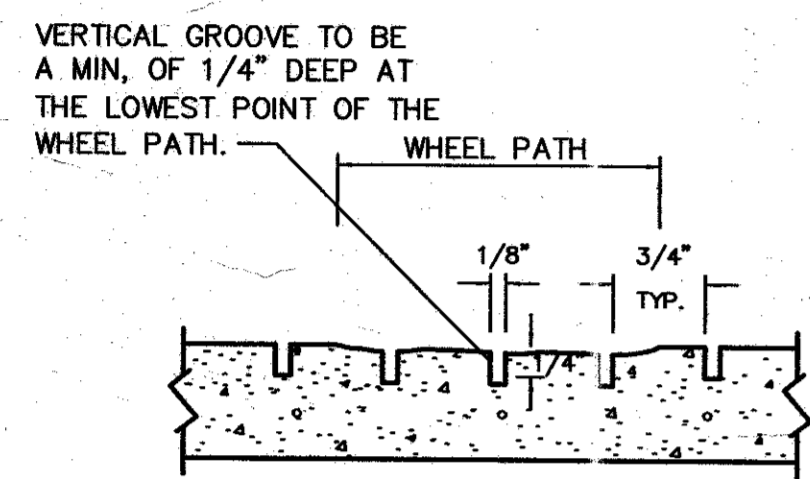

PAVEMENT GROOVE SPACING
NTS

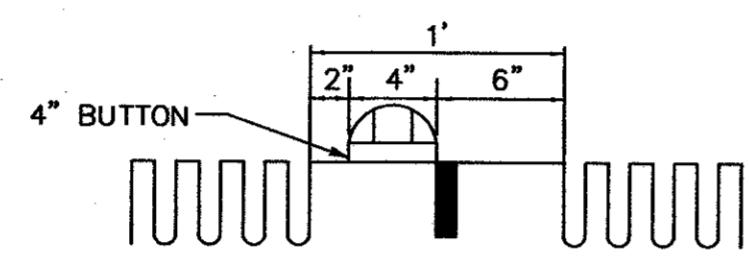

DETAIL "C"
NTS

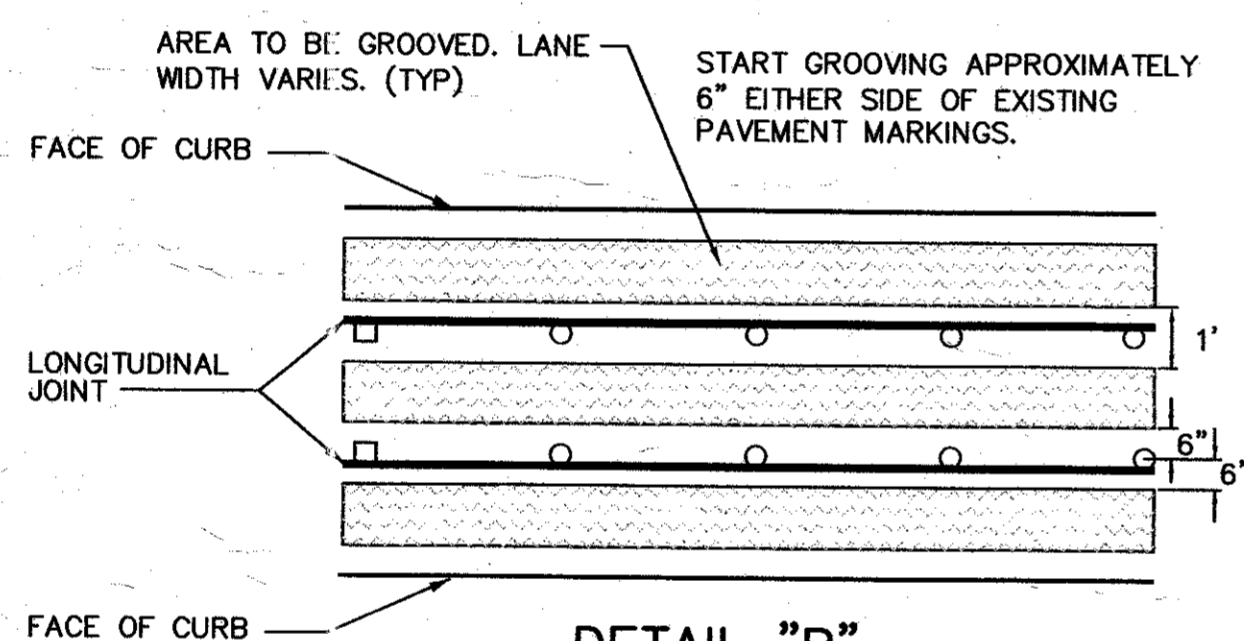

DETAIL "B"
NTS

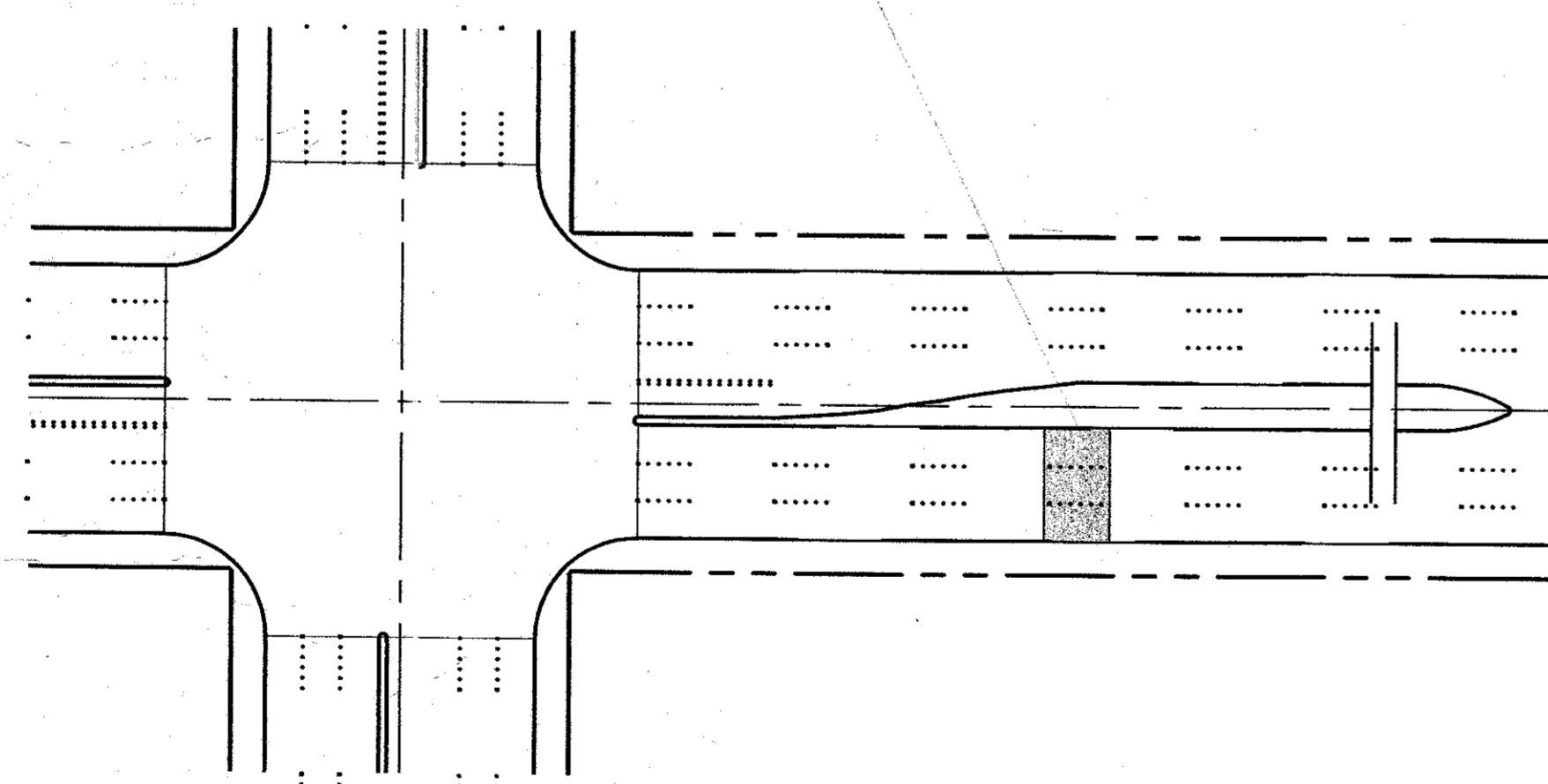

PAVEMENT GROOVING DETAILS
NTS

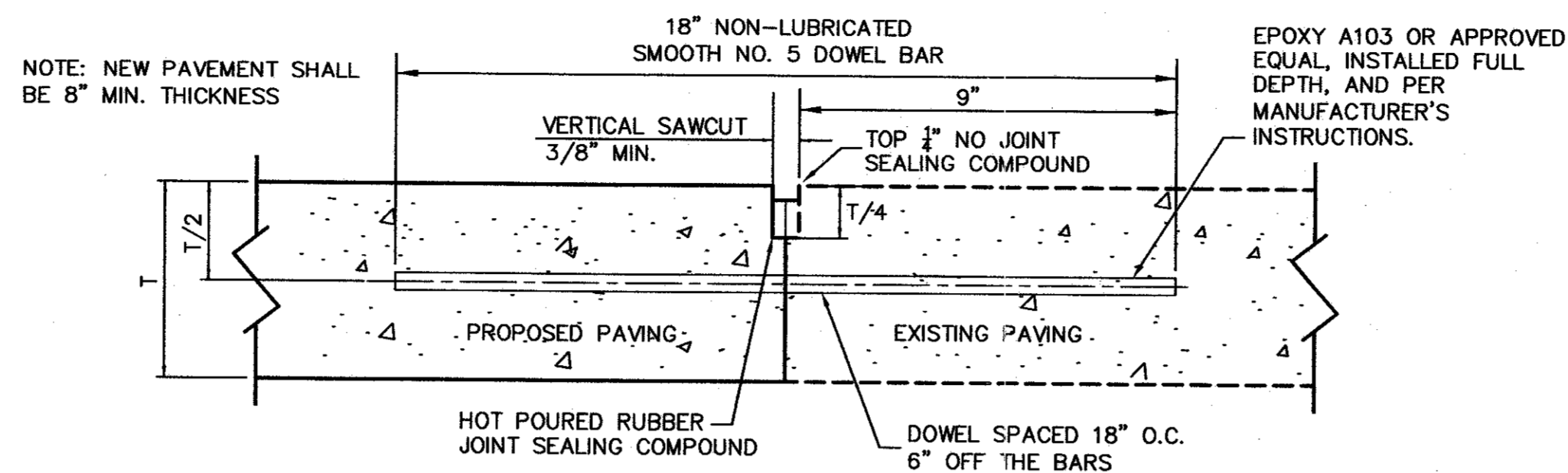

CONNECTION TO EXISTING PAVEMENT
NTS

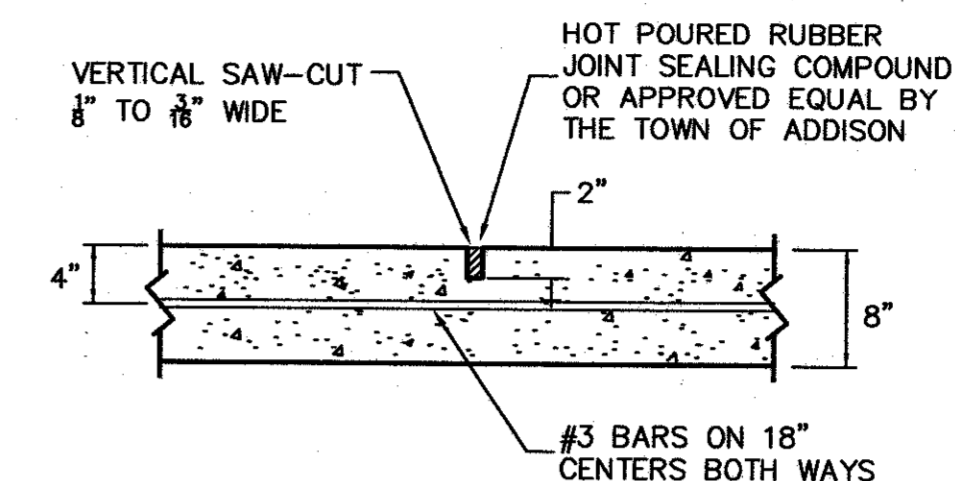

SECTION SAWED DUMMY JOINT
NTS

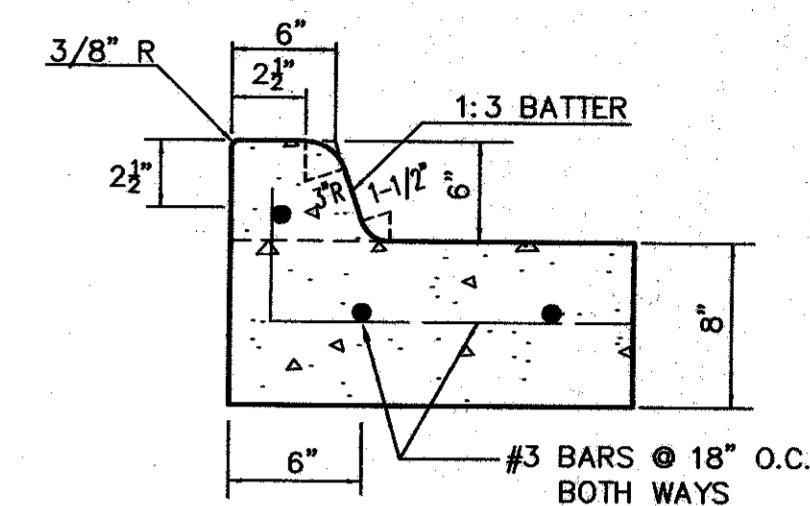

6" INTEGRAL CURB DETAIL
NTS

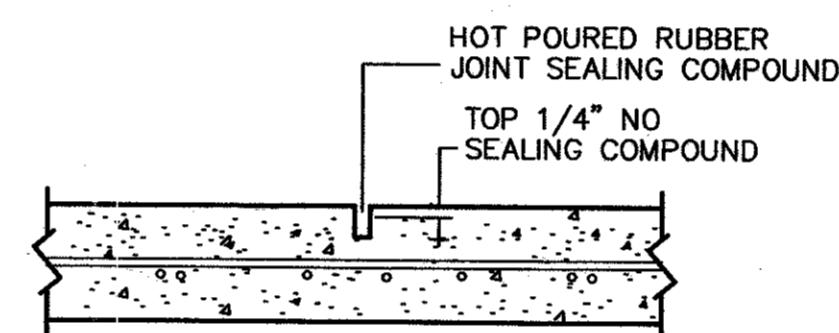

1. REMOVE EXISTING JOINT MATERIAL
2. SANDBLAST JOINT
3. REMOVE SAND FROM JOINTS
4. RESEAL JOINTS AS SHOWN

TRANSVERSE & LONGITUDINAL JOINT REPLACEMENT
NTS

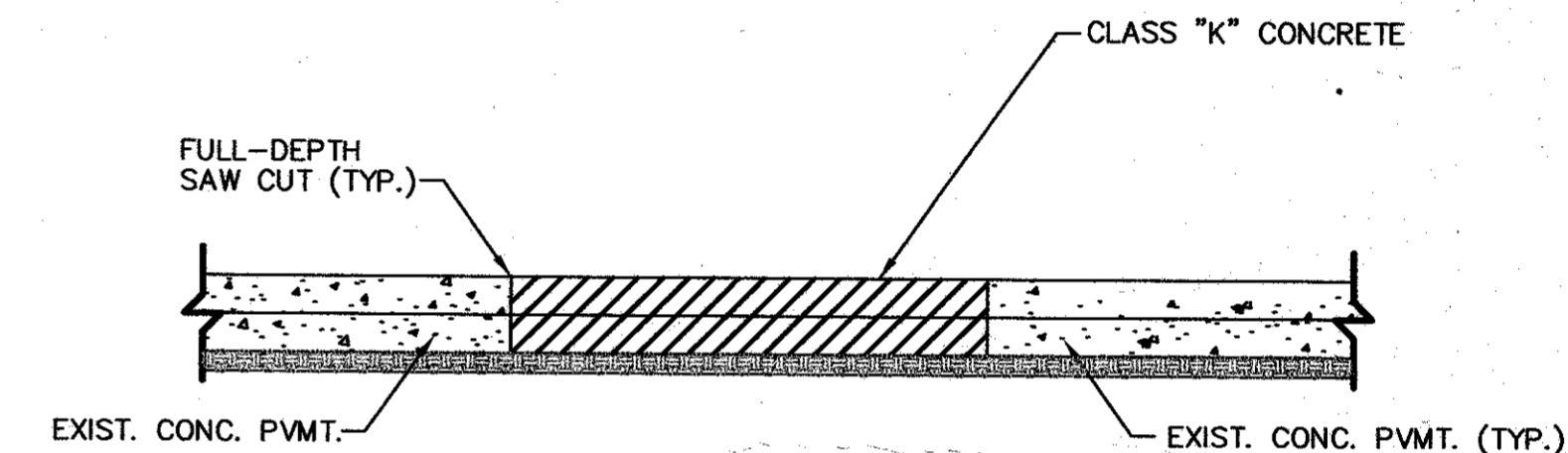

NOTE:

1. DOWEL INTO EXISTING PAVEMENT OR TIE ONTO EXISTING REBAR.
2. THICKNESS AND REINFORCEMENT TO MATCH ADJACENT PAVEMENT

CONCRETE PAVEMENT REPAIR
N.T.S.

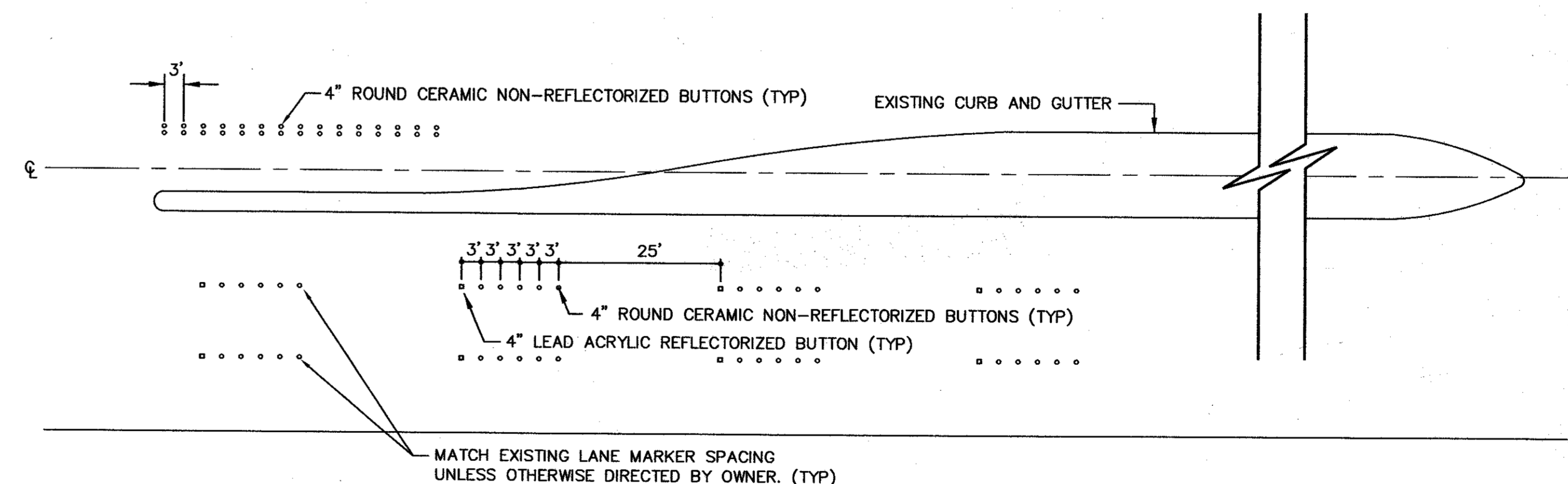

TRAFFIC BUTTONS/MARKERS
NTS

NO.	REVISION	BY	DATE

DESIGNED BY: DRS
 DRAWN BY: PBSJ
 CHECKED BY: WSF
 SCALE: VARIES
 DATE: AUGUST 2002
 FILE: 949-DETAIL.DWG

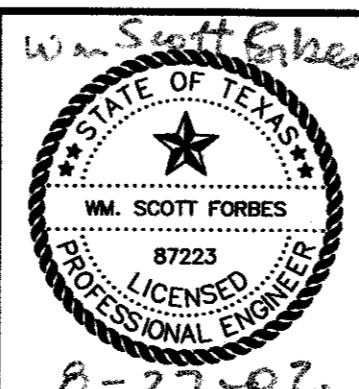

PBSJ
 5999 Summerside Drive, Suite 202
 Dallas, Texas 75252 (972)380-2605

Town of Addison
 Dallas County
 Texas

BELT LINE ROAD
 PAVEMENT GROOVING IMPROVEMENTS
"DETAIL SHEET"
 TOWN OF ADDISON
 AUGUST, 2002

SHEET NO. 6
 OF 6 SHEETS
 JOB NO. 450949