

**NOTES: PEDESTRIAN CROSSING**

**BASE BID SHALL INCLUDE THE FOLLOWING:**

1. POWER WASH AND CLEAN EXISTING CONCRETE ACCORDING TO MANUFACTURER'S RECOMMENDATIONS
2. SAW CUT CONCRETE AS NOTED ON PLAN DETAIL THIS SEET
3. APPLY CHEMICAL STAIN AS DESCRIBED ON PLAN DETAIL THIS SHEET

**ADD ALTERNATE:**

1. SAW CUT, REMOVE AND DISPOSE OF EXISTING CONCRETE PER CIVIL ENGINEER'S TRAFFIC SAFETY PLAN AND SPECIFICATIONS
2. PLACE AND FINISH INTEGRAL COLORED CONCRETE AS DESCRIBED ON PLAN THIS SHEET AND PER TOWN OF ADDISON STANDARD CONSTRUCTION DETAILS
3. APPLY COLOR WAX CURING COMPOUND PER MANUFACTURER'S SPECIFICATIONS

NOTE: SAW CUT ALL JOINTS SHOWN TO DEMARCATÉ CROSSING, NO OVERLAPS ARE ACCEPTABLE. DO NOT CUT CURBS. SAW CUTS 1/4" TO 1/2" MAX. ALL JOINTS TO BE CHALKED IN THE FIELD FOR APPROVAL BY LANDSCAPE ARCHITECT AND TOWN OF ADDISON PRIOR TO CUTTING. CONTACT MICHAEL KASHUBA, TOWN OF ADDISON LANDSCAPE ARCHITECT: 972.450.2831. CONTRACTOR IS RESPONSIBLE FOR ALL AREAS DISTURBED DURING CONSTRUCTION, WHETHER DEPICTED IN PLANS OR NOT. CONTRACTOR IS RESPONSIBLE FOR LOCATING AND PROTECTING ALL UTILITIES IN WORK AREA. SEE GENERAL NOTE #2. CONTRACTOR TO NOTIFY 1-800-DIGTESS PRIOR TO ANY EXCAVATION

NOTE:  
REFER TO CIVIL PLANS FOR ALL CROSSWALKS AND ACCESS RAMPS. LANDSCAPE PLANS DESCRIBE FINISHES ONLY

NOTE:  
FIELD VERIFY ALL LOCATIONS

**CONCRETE PRODUCTS**

C-1 STANDARD CONCRETE PAVING

MANUFACTURER: LOCAL  
PRODUCT: STANDARD GRAY CONCRETE; 3000 PSI; LIGHT BROOM FINISH

**BASE BID:**

C-2 STAINED CONCRETE PAVING

SUPPLIER: SCOFIELD LITHOCHROME CHEMSTAIN. COLOR TO BE SELECTED AFTER MOCK-UP SAMPLES. COLOR SUGGESTED: CS-14 "DARK WALNUT." APPLY PER MANUFACTURER'S SPECIFICATIONS. LOCAL SCOFIELD REP. JIM ORELLA 972.839.3730.

C-3 STAINED ACCENT BAND CONCRETE PAVING

SUPPLIER: SCOFIELD LITHOCHROME CHEMSTAIN. COLOR TO BE SELECTED AFTER MOCK-UP SAMPLES. COLOR SUGGESTED: CS-15 "ANTIQUÉ AMBER." APPLY PER MANUFACTURER'S SPECIFICATIONS. LOCAL SCOFIELD REP. JIM ORELLA 972.839.3730.

**ADD ALTERNATE:**

C-4 INTEGRAL COLORED CONCRETE PAVING

MANUFACTURER: LOCAL  
PRODUCT: INTEGRAL COLORED 8" THICK CONCRETE; SCOFIELD INTEGRAL COLOR TO BE SELECTED AFTER MOCK-UP SAMPLES. FOLLOWED BY SCOFIELD LITHOCHROME COLORWAX. COLOR SUGGESTED: SG677-4 "ROAST CHESTNUT." APPLY PER MANUFACTURER'S SPECIFICATIONS. LOCAL SCOFIELD REP. JIM ORELLA 972.839.3730. REFERENCE TOWN OF ADDISON STANDARD DETAILS FOR CONSTRUCTION.

C-5 INTEGRAL COLORED ACCENT BAND CONCRETE PAVING

MANUFACTURER: LOCAL  
PRODUCT: INTEGRAL COLOR 8" THICK CONCRETE; SCOFIELD INTEGRAL COLOR TO BE SELECTED AFTER MOCK-UP SAMPLES. FOLLOWED BY SCOFIELD LITHOCHROME COLORWAX. COLOR SUGGESTED: SG447-2 "SCHOONER BEIGE." APPLY PER MANUFACTURER'S SPECIFICATIONS. LOCAL SCOFIELD REP. JIM ORELLA 972.839.3730. REFERENCE TOWN OF ADDISON STANDARD DETAILS FOR CONSTRUCTION.

1807 Ross Ave,  
Suite 333  
Dallas, Texas 75201  
214.871.0568 tel  
214.871.1507 fax  
mesadesigngroup.com



**VICINITY MAP**

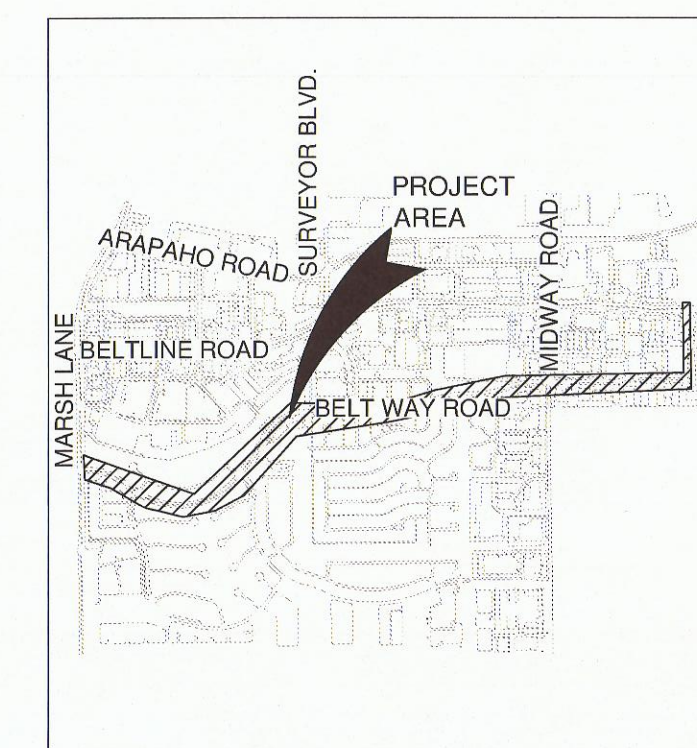

**Project Name**

Beltway Drive  
Parkway Improvements  
Addison, Texas

Project No: 14002

**Issue Title**

Construction Documents

Issue Date: 09.29.2014

**Seal**

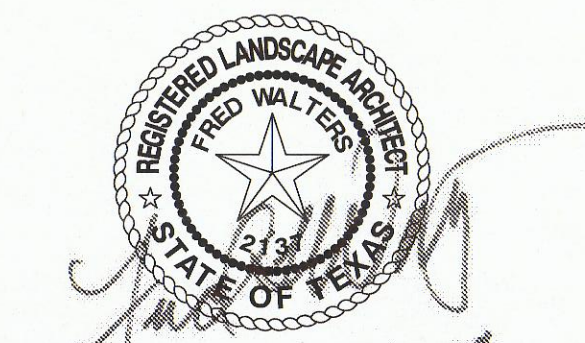

This drawing and the design shown is the property of MESA Design Associates, known also as MESA. The reproduction, copying, or use of this drawing without the written consent of MESA is prohibited and any infringement will be subject to legal action. © Copyright 2014 MESA.

**Issue / Addenda / Revisions**

Date	Description
06.25.2014	50% Review
07.31.2014	90% Review
09.29.2014	100% Bid Documents

**Drawing Title**

Layout Plan

**Sheet No.**

L2.05

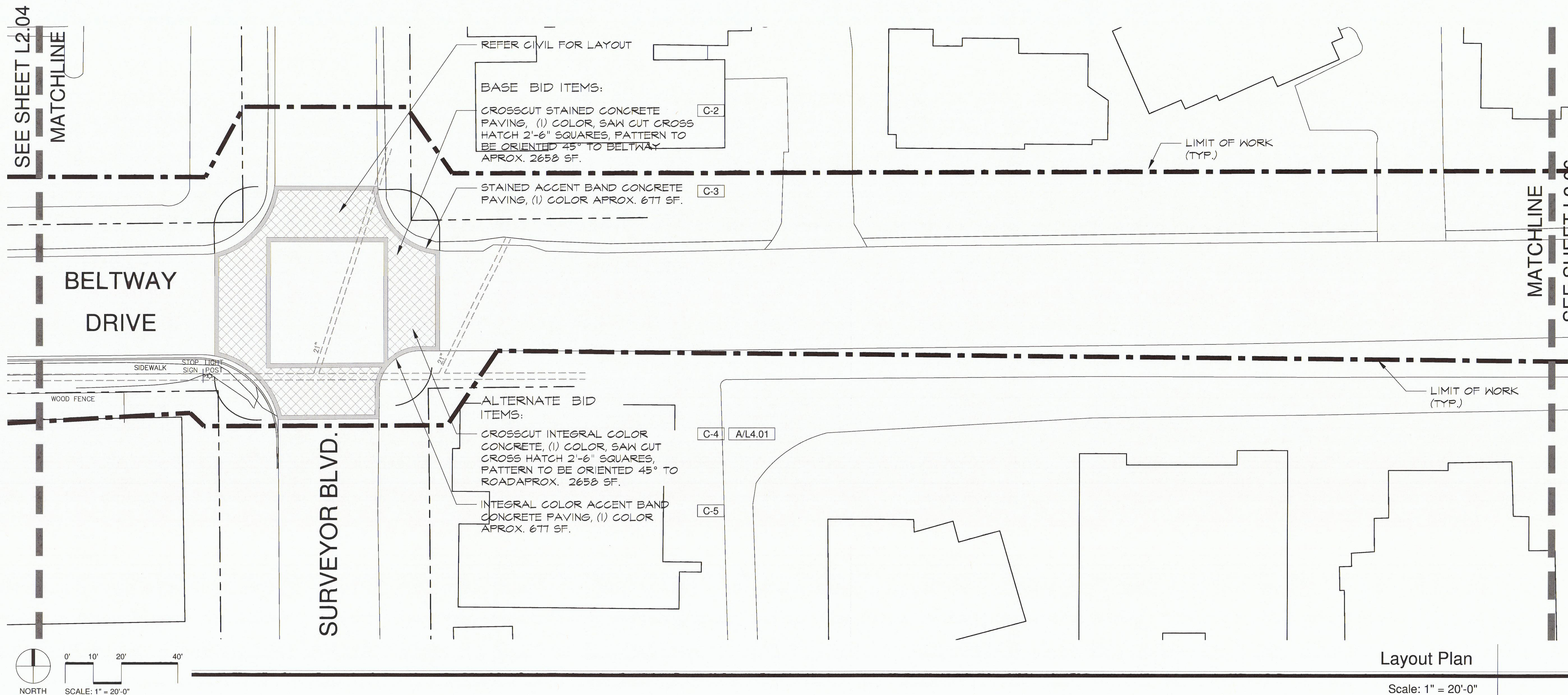

Layout Plan

Scale: 1" = 20'-0"