

VICINITY MAP

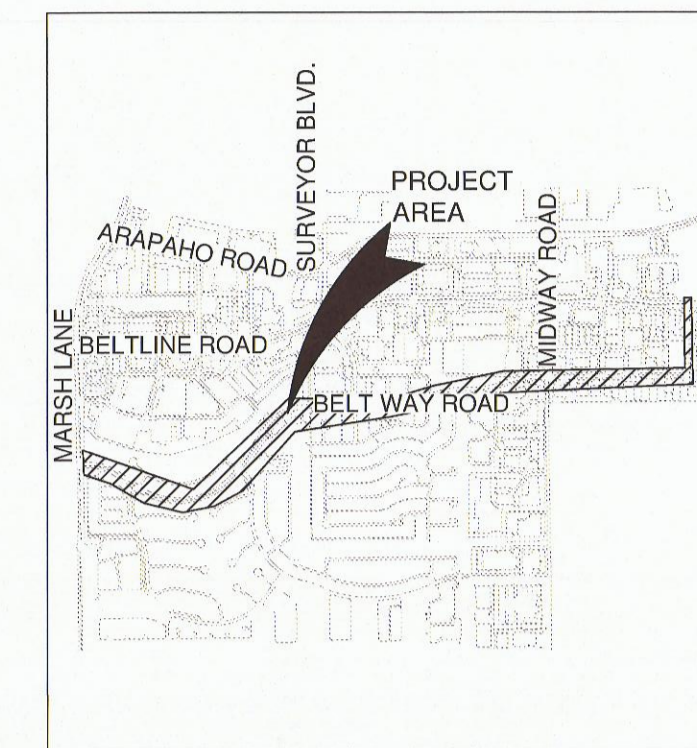

Project Name

Beltway Drive
Parkway Improvements
Addison, Texas
Project No: 14002

Issue Title

Construction Documents

Issue Date: 09.29.2014

Seal

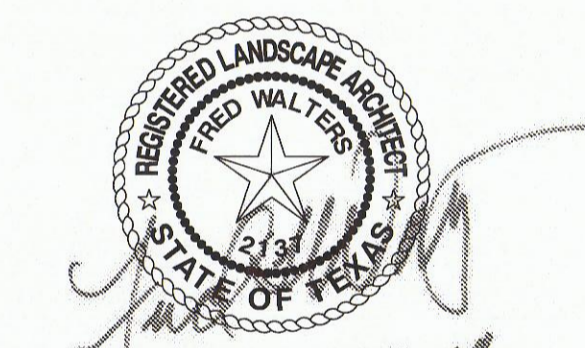

This drawing and the design shown is the property of MESA Design Associates, known also as MESA. The reproduction, copying, or use of this drawing without the written consent of MESA is prohibited and any infringement will be subject to legal action. © Copyright 2012, MESA

Issue / Addenda / Revisions

Date	Description
06.25.2014	50% Review
07.31.2014	90% Review
09.29.2014	100% Bid Documents

Drawing Title

Landscape Plan

Sheet No.

L5.07

NOTE:

- CONTRACTOR IS RESPONSIBLE FOR ALL AREAS DISTURBED DURING CONSTRUCTION, WHETHER DEPICTED IN PLANS OR NOT.
- PLANTING, SEEDING/SODDING AND TEMPORARY WATERING SHALL BE INCLUDED IN BID TO ENSURE STABILIZATION OF GROUND PLANE RESULTING FROM CONSTRUCTION.
- CONTRACTOR SHALL REPAIR AND RECONFIGURE EXISTING IRRIGATION SYSTEM TO ENSURE THE HEALTH OF EXISTING AS WELL AS PROPOSED LANDSCAPE MATERIAL. ANY IRRIGATION LINES DAMAGED DURING CONSTRUCTION SHALL BE REPAIRED OR CAPPED PER TOWN OF ADDISON DISCRETION.
- CONTRACTOR SHALL PROVIDE SCHEDULE 40 SLEEVING OF APPROPRIATE SIZE FOR EXISTING PIPING AND WIRING WHERE SYSTEM CROSSES THE PROPOSED IMPROVEMENTS AND COORDINATE IRRIGATION HEAD RELOCATION WITH THE TOWN.
- TURF REPAIRS TO BE WITH SOLID SOD WITH TYPE AND SPECIES TO MATCH ADJACENT TURF AREAS. TOWN OF ADDISON CONTACT: MICHAEL KASHUBA, LANDSCAPE ARCHITECT, 972.450.2831

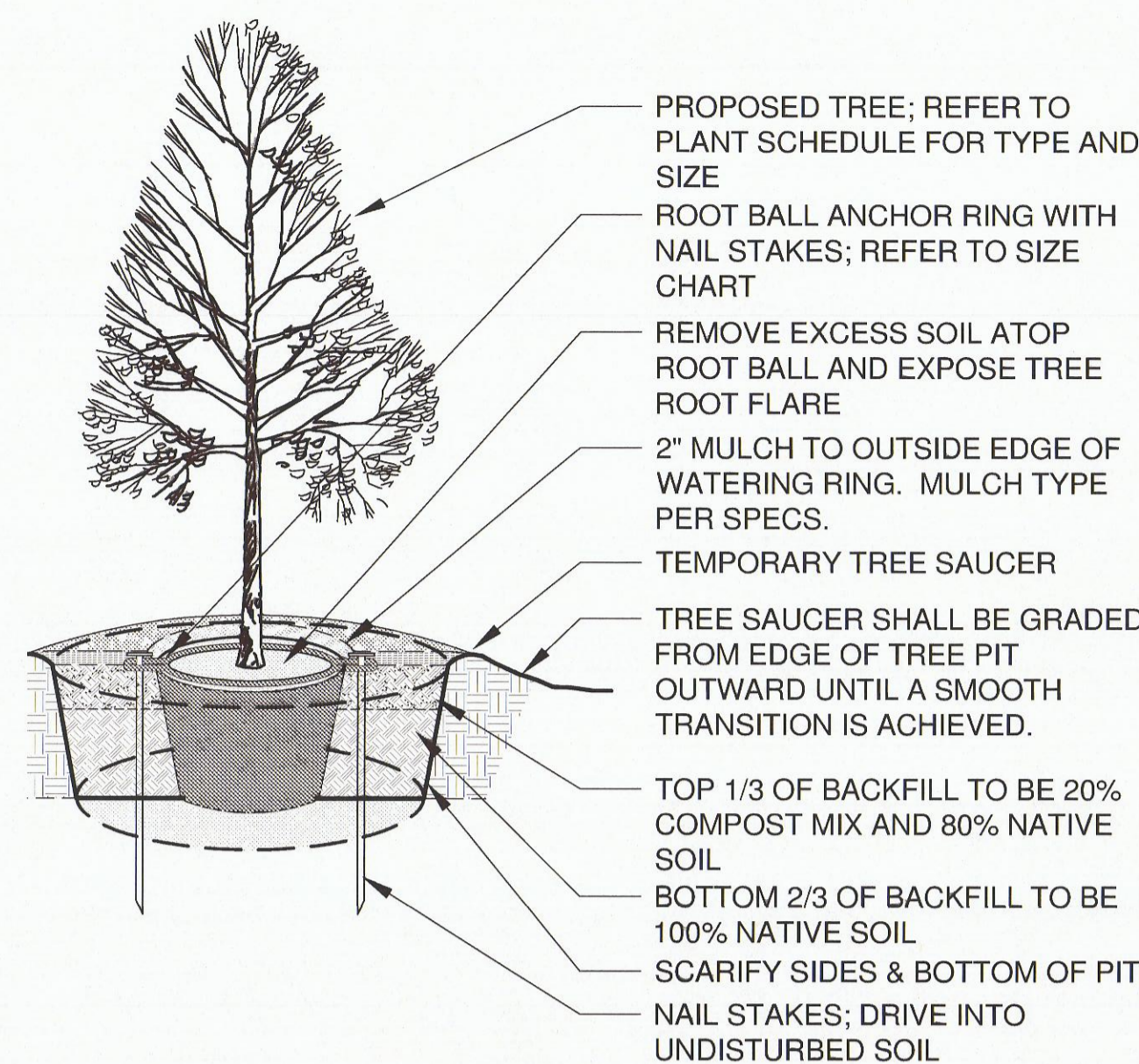

TREE INSTALLATION:

- DIG HOLE 1.5 TIMES LARGER THAN THE DIAMETER OF THE ROOT BALL AND NO DEEPER THAN 24"
- PLACE TREE IN HOLE.
- PLACE ROOTBALL ANCHOR RING ON BASE OF ROOTBALL, TRUNK SHOULD BE IN THE CENTER OF THE RING, INSTALL NAIL STAKE WITH HAMMER OR Mallet FIRMLY INTO UNDISTURBED GROUND.
- DRIVE NAIL STAKES FLUSH WITH "U" BRACKET ADJACENT TO ROOTBALL (DO NOT DISTURB ROOTBALL)
- BACKFILL HOLE AND MULCH.

ANCHOR RING SIZES:

- 30 BG-NS (30 GAL.; 2" - 2 1/2" CALIPER)
ROOT BALL UP TO 22" DIA.
3 - 36" NAIL STAKES
- 45 BG-NS (45 GAL.; 2 1/2" - 3" CALIPER)
ROOT BALL TO 27" DIAMETER
3 - 36" NAIL STAKES
- 65 BG-NS (65 GAL.; 3" - 4" CALIPER)
ROOT BALL TO 30" DIAMETER
3 - 36" NAIL STAKES
- 100 BG-NS (100 GAL.; 4" - 4 1/2" CALIPER)
ROOT BALL TO 36" DIAMETER
3 - 36" NAIL STAKES

LANDSCAPE LEGEND

- BERMUDA SOD
Cynodon dactylon
- RAIN GARDEN
Refer Sheet L5.08

TREE PLANTING DETAIL | A

Scale: 1/2" = 1'-0" | L5.07

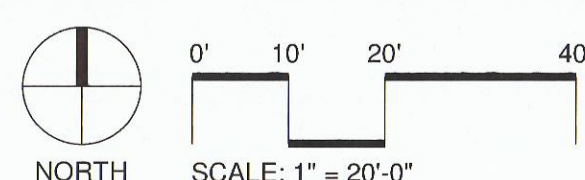
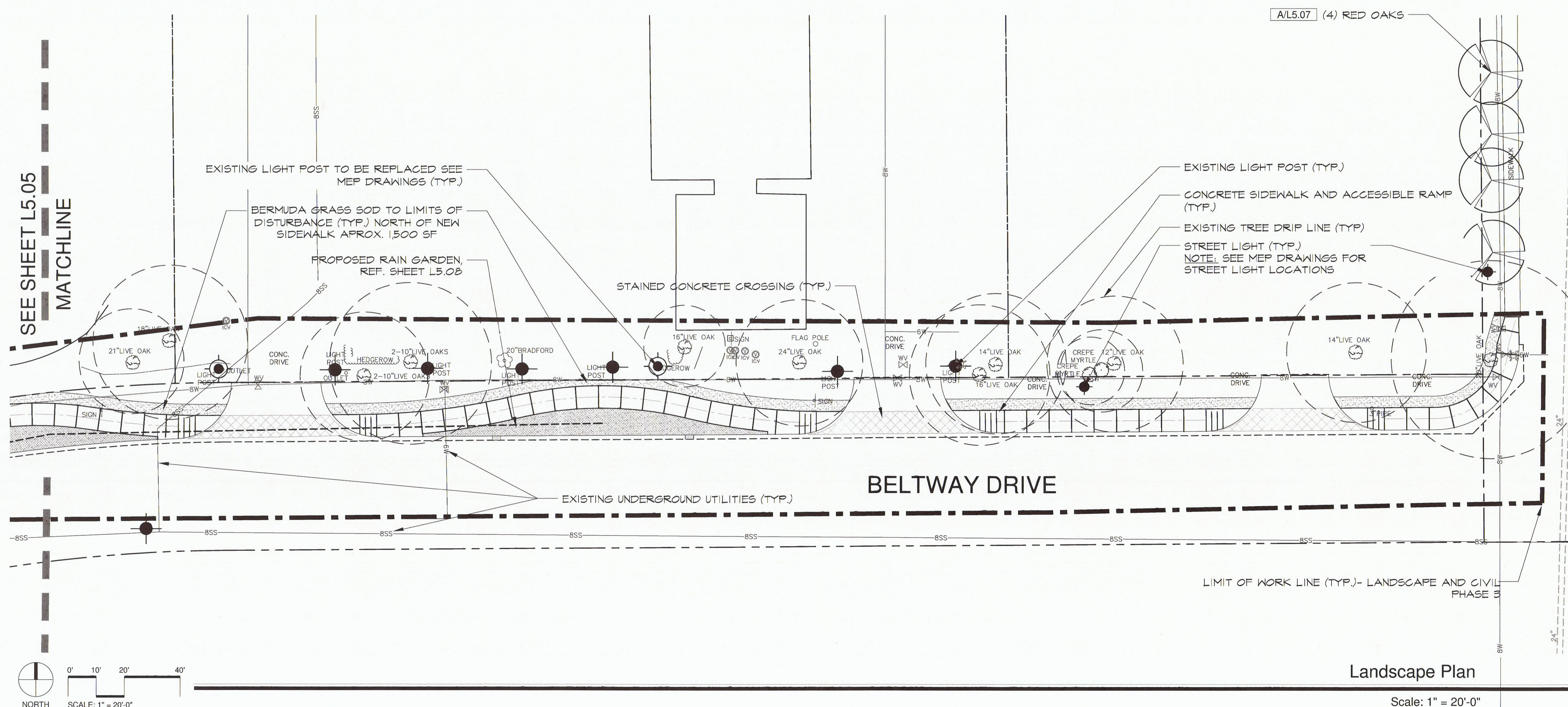

Landscape Plan

Scale: 1" = 20'-0"