

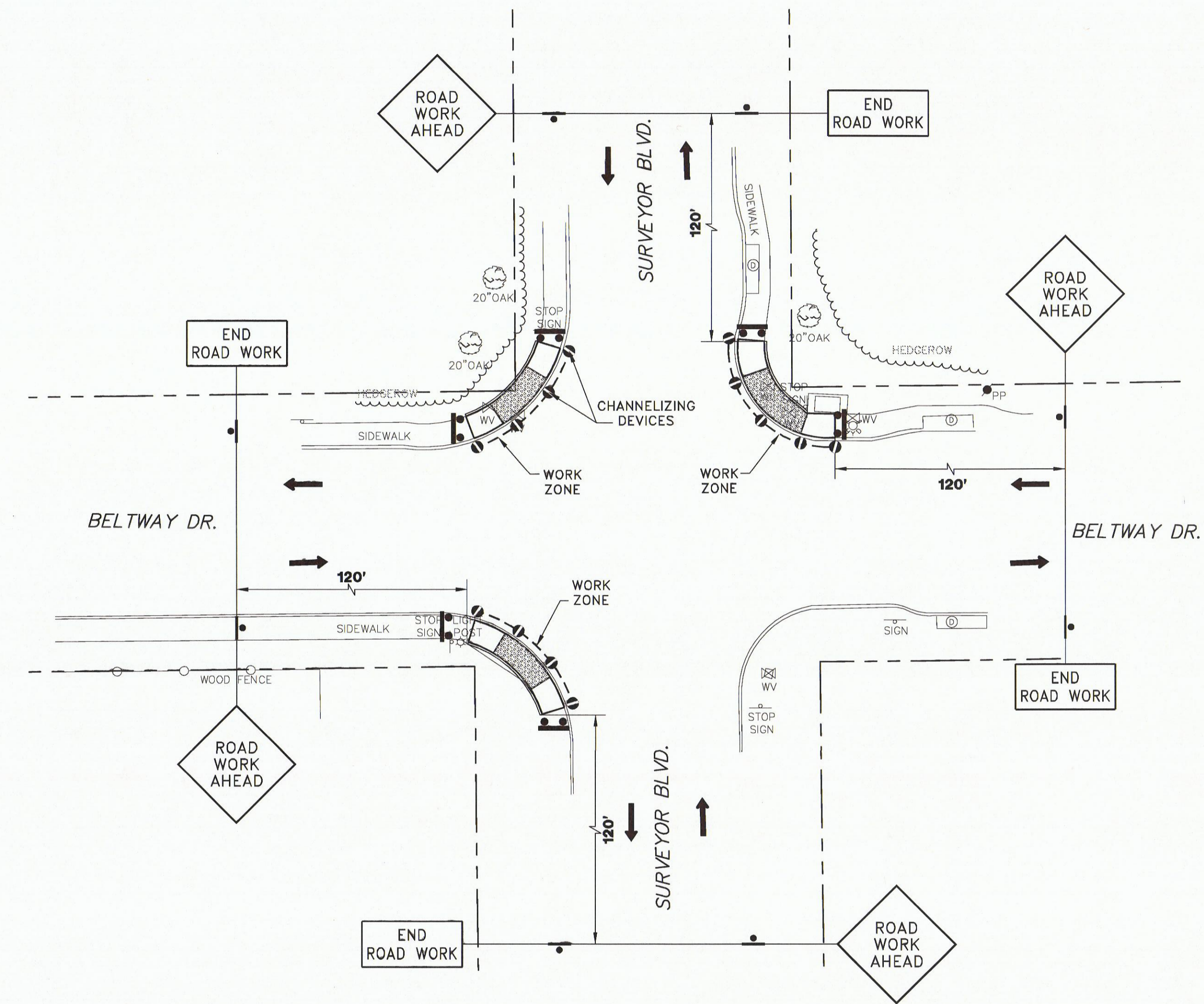

**TYPICAL CLOSURE AT SIDE OF INTERSECTION (TA-27)
(TWO LANE)**



TYPICAL SHOULDER WORK WITH MINOR ENCROACHMENT (TA-6)

LEGEND

-  TYPE III BARRICADE
-  PLASTIC DRUM W/APPROVED CHANNELIZING DEVICE

NOTES:

1. ALL SIGNAGE, BARRICADES, AND PAVEMENT MARKINGS SHALL BE IN ACCORDANCE WITH THE LATEST REVISIONS OF THE TEXAS MANUAL ON UNIFORM TRAFFIC CONTROL DEVICES (2011).
2. LOCATIONS SHOWN FOR SIGNAGE ARE APPROXIMATE; FINAL LOCATIONS MAY CHANGE DUE TO CONSTRUCTION CONDITIONS AND PRESENCE OF OTHER PHYSICAL FEATURES.

NO.	DATE	REVISION	APPROV.
1			
2			
3			
4			
5			
6			

GRANTHAM & ASSOCIATES
F-005438
STATE OF TEXAS
101252
REGISTERED PROFESSIONAL ENGINEER
APPEARING ON THIS DOCUMENT WAS AUTHORIZED BY:
P. CHRISTOPHER ROBINSON
ON 9/29/14
ALTERATION OF A SEALED DOCUMENT WITHOUT PROPER NOTIFICATION TO THE RESPONSIBLE ENGINEER IS AN OFFENSE UNDER THE TEXAS ENGINEERING PRACTICE ACT.

**CROSSWALK IMPROVEMENTS AT
SURVEYOR BLVD. & BELTWAY DRIVE
TRAFFIC CONTROL
TOWN OF ADDISON**

DATE: SEPTEMBER 2014
SCALE:
DRAWN BY: G&A
DESIGN: BRG
REVIEWED: BRG
JOB NO: 1197-14
DWG: 11885SURVEYOR BLVD-TRAF