

VICINITY MAP

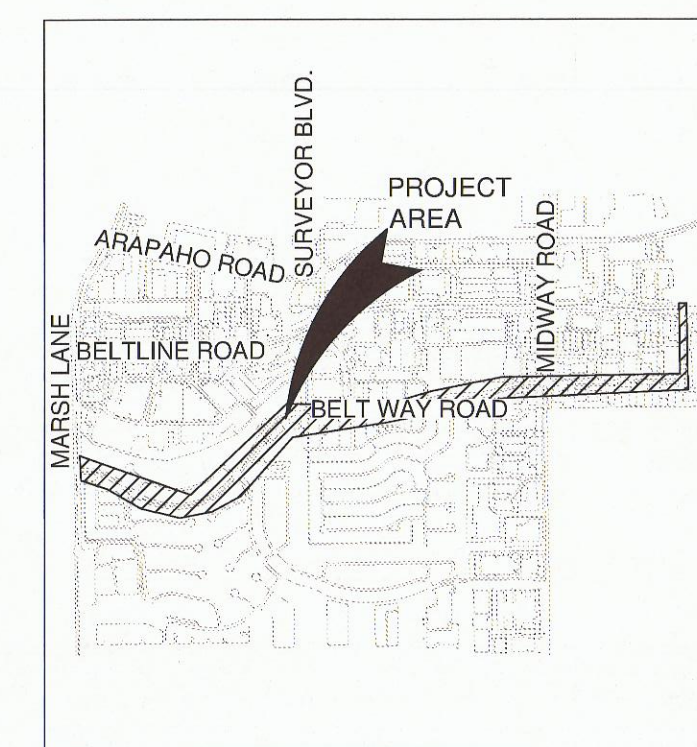

Project Name

Beltway Drive
Parkway Improvements
Addison, Texas

Project No: 14002

Issue Title

Construction Documents

Issue Date: 09.29.2014

Seal



This drawing and the design shown is the property of MESA Design Associates, known also as MESA. The reproduction, copying, or use of this drawing without the written consent of MESA is prohibited and any infringement will be subject to legal action. © Copyright 2012 MESA

Issue / Addenda / Revisions

| Date | Description |
|------------|--------------------|
| 06.25.2014 | 50% Review |
| 07.31.2014 | 90% Review |
| 09.29.2014 | 100% Bid Documents |

Drawing Title

Demolition Plan-
Landscape

Sheet No.

L1.03

NOTES:

1. CLEAN-UP OF DEBRIS FROM DEMOLITION SHALL BE PERFORMED ON A DAILY BASIS AND PER THE DIRECTION OF THE TOWN OF ADDISON.
2. ANY IRRIGATION LINES DAMAGED DURING CONSTRUCTION SHALL BE REPAIRED OR CAPPED PER TOWN OF ADDISON DISCRETION. CONTRACTOR SHALL PROVIDE SCHEDULE 40 SLEEVING OF APPROPRIATE SIZE FOR EXISTING PIPING AND WIRING WHERE SYSTEM CROSSES THE PROPOSED IMPROVEMENTS AND COORDINATE IRRIGATION HEAD RELOCATION WITH THE TOWN. RELOCATION OF VALVES, METERS, & OTHER APPURTENANCES TO BE COORDINATED W/TOWN STAFF.
3. PREPARE ALL DISTURBED AREAS FOR THE INSTALLATION OF SOLID SOD
4. TOWN OF ADDISON CONTACT: MICHAEL KASHUBA, LANDSCAPE ARCHITECT 972.450.2831
5. TOWN OF ADDISON TO HAVE OPPORTUNITY TO TRANSPLANT EXISTING PLANTS WITHIN PLANTER. (COORDINATE W/OWNER)
6. EXISTING UNDERGROUND UTILITIES: CONTRACTOR IS RESPONSIBLE FOR LOCATING AND PROTECTING ALL UTILITIES WITHIN & ADJACENT TO WORK AREA. SEE GENERAL NOTE #2. CONTRACTOR TO NOTIFY 1-800-DIGTESS PRIOR TO ANY EXCAVATION.
7. CONTRACTOR SHALL PROVIDE SIGNS AT EACH SIDEWALK CLOSURE TO STATE: "SIDEWALK CLOSED FOR REPAIRS- PLEASE USE ALTERNATE ROUTE." (OR AS APPROVED BY THE TOWN)

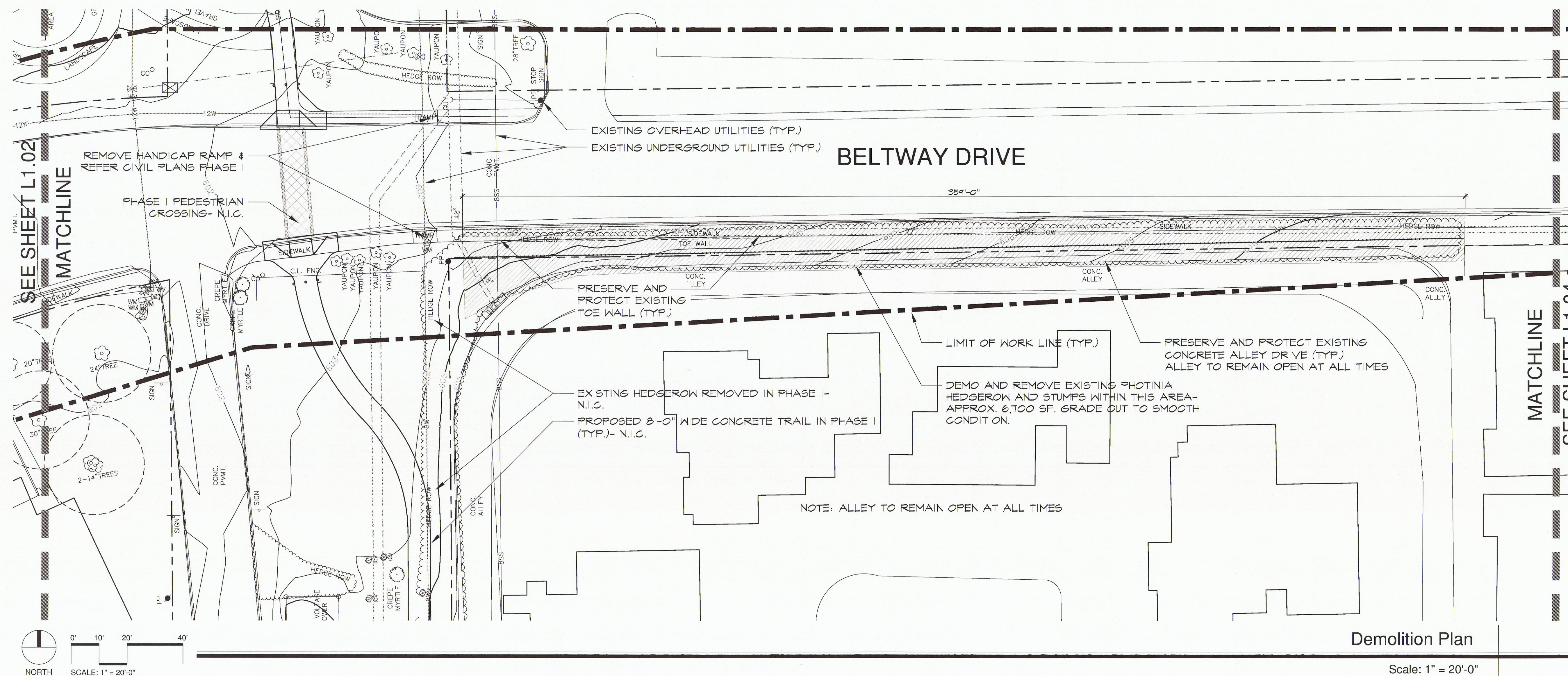
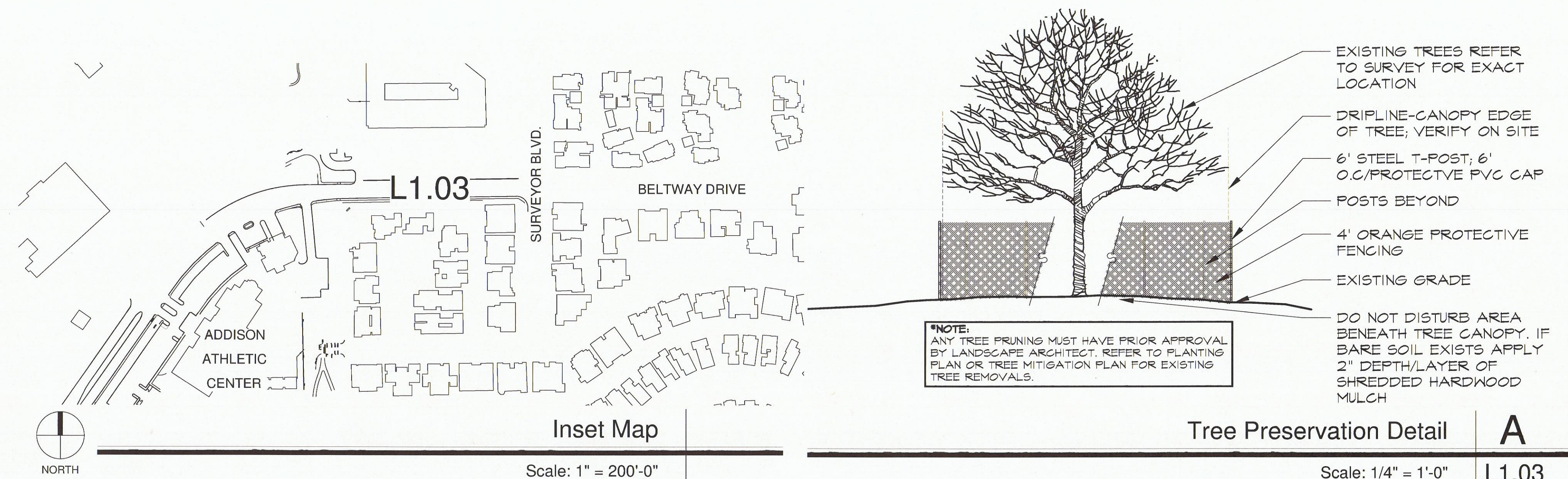

Demolition Plan

Scale: 1" = 20'-0"